

50012-650-26: Purchase and Installation of Gym Dividers for Recreation

Addendum #1

The following information is provided to supplement the original solicitation issued on April 17, 2026. Included in this addendum are photographs of the existing gym divider along with the original floor plan from the construction of the Lambright Sports and Wellness Center.

Vendors are responsible to conduct their own measurements and shall not depend on any diagram, drawing, or floor plan to infer existing measurements.

The provided images and floor plan are the only available supplemental information.

If you wish to have the included images sent in a digital format, please email purchasing@latech.edu and request them. Please include the bid number in the subject line of the email.















HOME VISITOR
BONUS
POSS
PERIOD



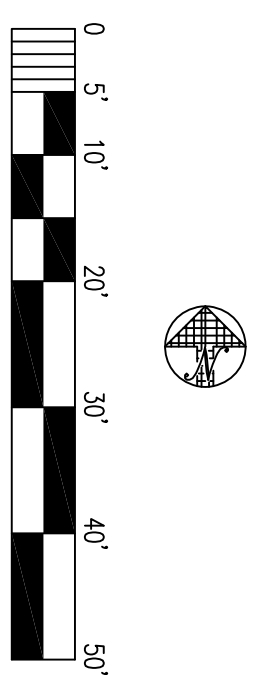
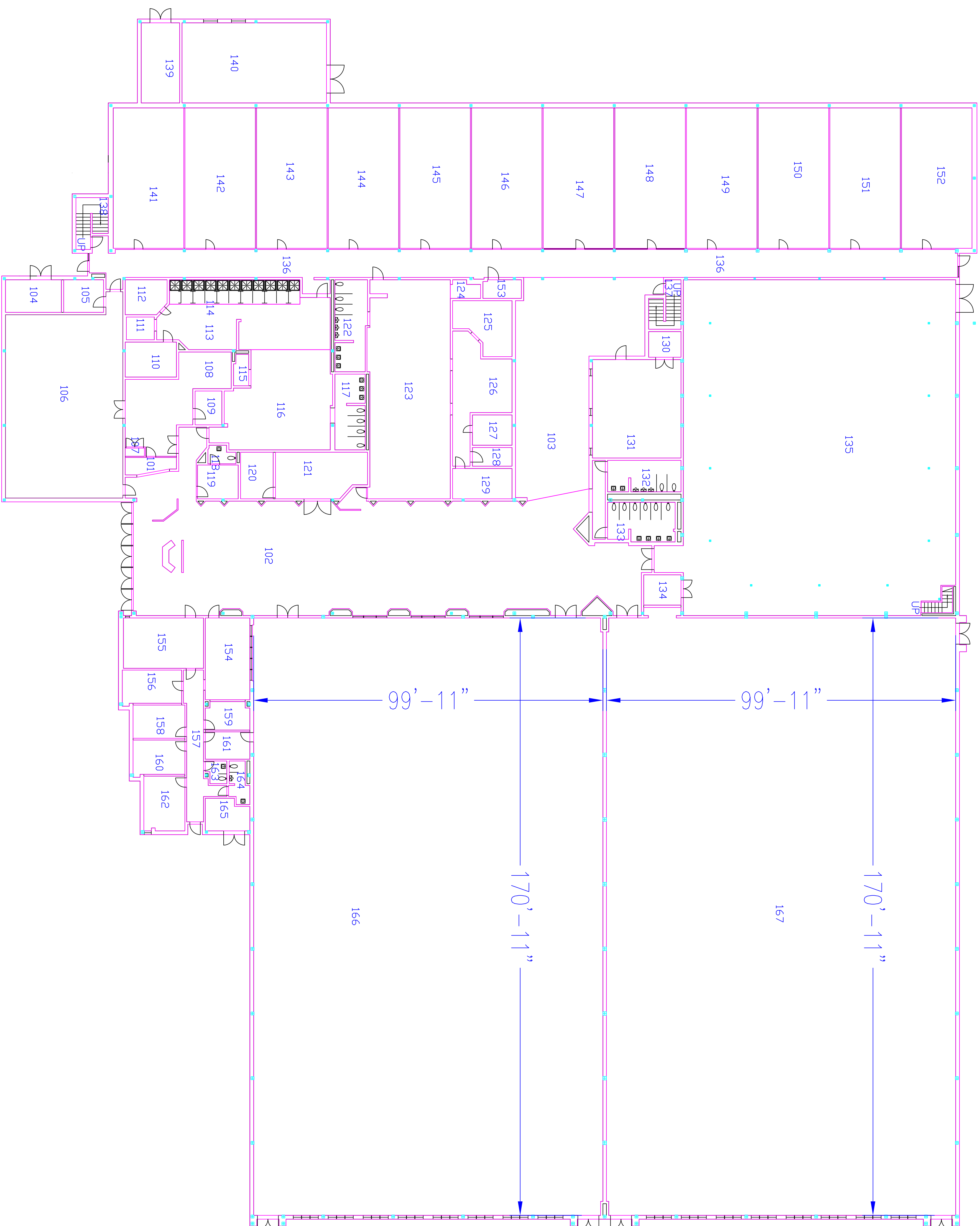

LOUISIANA TECH UNIVERSITY
 PHYSICAL PLANT
 RUSTON, LOUISIANA

LAMBRIGHT INTRAMURAL SPORTS CENTER
 First Floor

SITE CODE: 7-31-002	SCALE: 1" = 16'	DATE: 09-17-01
STATE ID: S07881	DRAWN BY: C. GRANT	SHEET 1 OF 2
GROSS AREA: 76,491 SQ. FT.	REVISED:	DRAWING NO.: S07881-01
FLOOR: 1 OF 2		