

**CITY OF BATON ROUGE
PARISH OF EAST BATON ROUGE**

February 5, 2026

ADDENDUM NO. 5

TO: ALL BIDDERS

**SUBJECT: SCENIC HIGHWAY CORRIDOR ENHANCEMENTS PROJECT
(Harding Boulevard – Swan Avenue) PROJECT #20-EN-HC-0006**

The following revisions shall be incorporated in and take precedence over any conflicting part of the original contract documents.

CONSTRUCTION BID FORM:

1. For paper, sealed and electronic bidders, with reference to page UCBF 1 of 4 of Part 1, Uniform Construction Bid Forms, the Bidder shall indicate receipt of this Addendum in the space provided. Failure to indicate receipt of this addendum shall be cause for the bid to be rejected.
2. Replace Unit Price Form with the attached Revised Unit Price Form (dated 02-05-2026). This revised Unit Price Form **MUST** be used by all Bidders for this project. Failure to submit on the revised Unit Price Form shall be cause for the bid to be rejected.

PART 2-SPECIAL PROVISIONS AND CONTRACT DOCUMENTS:

DRAWINGS:

1. Delete Revision 1 Sheets 3, 3b, 19, 201 – 217, 402 – 404, 406, 410 and replace with Revision 2 Sheets 3, 3b, 19, 201 – 217, 402 – 404, 406, 410.
2. Add New Sheet 213a.

APPROVED:

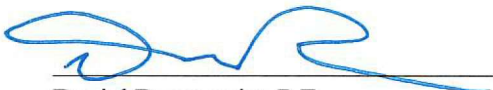

Daniel Rosenquist, P.E.
Chief Design & Construction Engineer

LOUISIANA UNIFORM PUBLIC WORK BID FORM

UNIT PRICE FORM

**To: CITY OF BATON ROUGE
PARISH OF EAST BATON ROUGE
DEPARTMENT OF PUBLIC WORKS**

**BID FOR: SCENIC HIGHWAY (HARDING BLVD. TO SWAN
AVE)**

**Date: 2/5/2026
Project Number: 20-EN-HC-0006**

<i>Description:</i>	Clearing And Grubbing			
REF. NO.	QUANTITY	UNIT OF MEASURE	UNIT PRICE	UNIT PRICE EXTENSION <i>(Quantity X Unit Price)</i>
201-01-00100	0.575	ACRE	\$ _____.	\$ _____.
<i>Description:</i>	Removal Of Asphalt Pavement			
REF. NO.	QUANTITY	UNIT OF MEASURE	UNIT PRICE	UNIT PRICE EXTENSION <i>(Quantity X Unit Price)</i>
202-02-02020	108.9	SY	\$ _____.	\$ _____.
<i>Description:</i>	Removal Of Base - Recycled Pcc Or Stone			
REF. NO.	QUANTITY	UNIT OF MEASURE	UNIT PRICE	UNIT PRICE EXTENSION <i>(Quantity X Unit Price)</i>
202-03-03010	109	SY	\$ _____.	\$ _____.
<i>Description:</i>	Removal Of Structures And Obstructions			
REF. NO.	QUANTITY	UNIT OF MEASURE	UNIT PRICE	UNIT PRICE EXTENSION <i>(Quantity X Unit Price)</i>
202-02-05000	1	LS	\$ _____.	\$ _____.
<i>Description:</i>	Removal Of Concrete Catch Basin			
REF. NO.	QUANTITY	UNIT OF MEASURE	UNIT PRICE	UNIT PRICE EXTENSION <i>(Quantity X Unit Price)</i>
202-02-06060	3	EA	\$ _____.	\$ _____.
<i>Description:</i>	Removal Of Concrete Walks And Drives			
REF. NO.	QUANTITY	UNIT OF MEASURE	UNIT PRICE	UNIT PRICE EXTENSION <i>(Quantity X Unit Price)</i>
202-02-06100	2,120	SY	\$ _____.	\$ _____.

LOUISIANA UNIFORM PUBLIC WORK BID FORM

UNIT PRICE FORM

**To: CITY OF BATON ROUGE
PARISH OF EAST BATON ROUGE
DEPARTMENT OF PUBLIC WORKS**

**BID FOR: SCENIC HIGHWAY (HARDING BLVD. TO SWAN
AVE)**

**Date: 2/5/2026
Project Number: 20-EN-HC-0006**

<i>Description:</i>	Removal Of Curb (Concrete)			
REF. NO.	QUANTITY	UNIT OF MEASURE	UNIT PRICE	UNIT PRICE EXTENSION (Quantity X Unit Price)
202-02-06140	4,900.0	LF	\$ _____.	\$ _____.
<i>Description:</i>	Removal Of Portland Cement Concrete Pavement			
REF. NO.	QUANTITY	UNIT OF MEASURE	UNIT PRICE	UNIT PRICE EXTENSION (Quantity X Unit Price)
202-02-32500	795	SY	\$ _____.	\$ _____.
<i>Description:</i>	Removal Of Signs			
REF. NO.	QUANTITY	UNIT OF MEASURE	UNIT PRICE	UNIT PRICE EXTENSION (Quantity X Unit Price)
202-02-38200	22	EA	\$ _____.	\$ _____.
<i>Description:</i>	Relocation Of Sign			
REF. NO.	QUANTITY	UNIT OF MEASURE	UNIT PRICE	UNIT PRICE EXTENSION (Quantity X Unit Price)
202-03-38000	5	EA	\$ _____.	\$ _____.
<i>Description:</i>	General Excavation			
REF. NO.	QUANTITY	UNIT OF MEASURE	UNIT PRICE	UNIT PRICE EXTENSION (Quantity X Unit Price)
203-01-00100	200	CY	\$ _____.	\$ _____.
<i>Description:</i>	Embankment			
REF. NO.	QUANTITY	UNIT OF MEASURE	UNIT PRICE	UNIT PRICE EXTENSION (Quantity X Unit Price)
203-03-00100	25	CY	\$ _____.	\$ _____.

LOUISIANA UNIFORM PUBLIC WORK BID FORM

UNIT PRICE FORM

**To: CITY OF BATON ROUGE
PARISH OF EAST BATON ROUGE
DEPARTMENT OF PUBLIC WORKS**

**BID FOR: SCENIC HIGHWAY (HARDING BLVD. TO SWAN
AVE)**

**Date: 2/5/2026
Project Number: 20-EN-HC-0006**

<i>Description:</i>	Geotextile Fabric			
REF. NO.	QUANTITY	UNIT OF MEASURE	UNIT PRICE	UNIT PRICE EXTENSION (Quantity X Unit Price)
203-08-00100	50	SY	\$ _____.	\$ _____.
<i>Description:</i>	Temporary Hay Bales			
REF. NO.	QUANTITY	UNIT OF MEASURE	UNIT PRICE	UNIT PRICE EXTENSION (Quantity X Unit Price)
204-02-00100	120	EA	\$ _____.	\$ _____.
<i>Description:</i>	Temporary Sediment Basin			
REF. NO.	QUANTITY	UNIT OF MEASURE	UNIT PRICE	UNIT PRICE EXTENSION (Quantity X Unit Price)
204-04-00100	13	EA	\$ _____.	\$ _____.
<i>Description:</i>	Temporary Sediment Check Dams (Hay)			
REF. NO.	QUANTITY	UNIT OF MEASURE	UNIT PRICE	UNIT PRICE EXTENSION (Quantity X Unit Price)
204-05-00100	10	EA	\$ _____.	\$ _____.
<i>Description:</i>	Temporary Silt Fencing			
REF. NO.	QUANTITY	UNIT OF MEASURE	UNIT PRICE	UNIT PRICE EXTENSION (Quantity X Unit Price)
204-06-00100	3,235	LF	\$ _____.	\$ _____.
<i>Description:</i>	Class II Base Course (8" Thick) (Crushed Stone Or Recycled Portland Cement Concrete)			
REF. NO.	QUANTITY	UNIT OF MEASURE	UNIT PRICE	UNIT PRICE EXTENSION (Quantity X Unit Price)
302-02-08070	32.9	SY	\$ _____.	\$ _____.

LOUISIANA UNIFORM PUBLIC WORK BID FORM

UNIT PRICE FORM

**To: CITY OF BATON ROUGE
PARISH OF EAST BATON ROUGE
DEPARTMENT OF PUBLIC WORKS**

BID FOR: SCENIC HIGHWAY (HARDING BLVD. TO SWAN AVE)

**Date: 2/5/2026
Project Number: 20-EN-HC-0006**

<i>Description:</i>	Class II Base Course (8" Thick) (Portland Cement Concrete)			
REF. NO.	QUANTITY	UNIT OF MEASURE	UNIT PRICE	UNIT PRICE EXTENSION <i>(Quantity X Unit Price)</i>
302-02-08090	681.1	SY	\$ _____	\$ _____
<i>Description:</i>	Traffic Maintenance Surfacing (Aggregate) (Vehicular Measurement)			
REF. NO.	QUANTITY	UNIT OF MEASURE	UNIT PRICE	UNIT PRICE EXTENSION <i>(Quantity X Unit Price)</i>
402-01-00101	200.0	CY	\$ _____	\$ _____
<i>Description:</i>	Asphalt Concrete			
REF. NO.	QUANTITY	UNIT OF MEASURE	UNIT PRICE	UNIT PRICE EXTENSION <i>(Quantity X Unit Price)</i>
502-01-00100	1,680.0	TON	\$ _____	\$ _____
<i>Description:</i>	Milling Asphalt Pavement			
REF. NO.	QUANTITY	UNIT OF MEASURE	UNIT PRICE	UNIT PRICE EXTENSION <i>(Quantity X Unit Price)</i>
509-01-00100	10,800	SY	\$ _____	\$ _____
<i>Description:</i>	Contractor Retained Reclaimed Asphalt Pavement			
REF. NO.	QUANTITY	UNIT OF MEASURE	UNIT PRICE	UNIT PRICE EXTENSION <i>(Quantity X Unit Price)</i>
509-02-00100	-450	CY	\$ _____	\$ _____
<i>Description:</i>	Sawing And Sealing Longitudinal Joints In Asphalt Concrete Overlay			
REF. NO.	QUANTITY	UNIT OF MEASURE	UNIT PRICE	UNIT PRICE EXTENSION <i>(Quantity X Unit Price)</i>
511-02-00100	10,000	LF	\$ _____	\$ _____

LOUISIANA UNIFORM PUBLIC WORK BID FORM

UNIT PRICE FORM

**To: CITY OF BATON ROUGE
PARISH OF EAST BATON ROUGE
DEPARTMENT OF PUBLIC WORKS**

BID FOR: SCENIC HIGHWAY (HARDING BLVD. TO SWAN AVE)

**Date: 2/5/2026
Project Number: 20-EN-HC-0006**

<i>Description:</i>	Sawing And Sealing Transverse Joints In Asphalt Concrete Overlay			
REF. NO.	QUANTITY	UNIT OF MEASURE	UNIT PRICE	UNIT PRICE EXTENSION <i>(Quantity X Unit Price)</i>
511-03-00100	6,200	LF	\$ _____.	\$ _____.
<i>Description:</i>	Portland Cement Concrete Pavement (8" Thick)			
REF. NO.	QUANTITY	UNIT OF MEASURE	UNIT PRICE	UNIT PRICE EXTENSION <i>(Quantity X Unit Price)</i>
601-01-00100	1,450.0	SY	\$ _____.	\$ _____.
<i>Description:</i>	Portland Cement Concrete Pavement Coring			
REF. NO.	QUANTITY	UNIT OF MEASURE	UNIT PRICE	UNIT PRICE EXTENSION <i>(Quantity X Unit Price)</i>
601-04-00100	5	EA	\$ _____.	\$ _____.
<i>Description:</i>	Cleaning And Resealing Existing Longitudinal Pavement Joints			
REF. NO.	QUANTITY	UNIT OF MEASURE	UNIT PRICE	UNIT PRICE EXTENSION <i>(Quantity X Unit Price)</i>
602-02-00200	10,000	LF	\$ _____.	\$ _____.
<i>Description:</i>	Cleaning And Resealing Existing Transverse Pavement Joints			
REF. NO.	QUANTITY	UNIT OF MEASURE	UNIT PRICE	UNIT PRICE EXTENSION <i>(Quantity X Unit Price)</i>
602-02-00300	6,200	LF	\$ _____.	\$ _____.
<i>Description:</i>	Cleaning And Sealing Random Cracks			
REF. NO.	QUANTITY	UNIT OF MEASURE	UNIT PRICE	UNIT PRICE EXTENSION <i>(Quantity X Unit Price)</i>
602-03-00100	1,500	LF	\$ _____.	\$ _____.

LOUISIANA UNIFORM PUBLIC WORK BID FORM

UNIT PRICE FORM

**To: CITY OF BATON ROUGE
PARISH OF EAST BATON ROUGE
DEPARTMENT OF PUBLIC WORKS**

BID FOR: SCENIC HIGHWAY (HARDING BLVD. TO SWAN AVE)

**Date: 2/5/2026
Project Number: 20-EN-HC-0006**

<i>Description:</i>	Full Depth Patching Of Jointed Concrete Pavement (16.0 Sy And Under) (8" Thick)			
REF. NO.	QUANTITY	UNIT OF MEASURE	UNIT PRICE	UNIT PRICE EXTENSION <i>(Quantity X Unit Price)</i>
602-05-01120	500.0	SY	\$ _____.	\$ _____.
<i>Description:</i>	Storm Drain Pipe (15" Rep/Rpvc)			
REF. NO.	QUANTITY	UNIT OF MEASURE	UNIT PRICE	UNIT PRICE EXTENSION <i>(Quantity X Unit Price)</i>
701-03-01002	10	LF	\$ _____.	\$ _____.
<i>Description:</i>	Adjusting Drainage Structures			
REF. NO.	QUANTITY	UNIT OF MEASURE	UNIT PRICE	UNIT PRICE EXTENSION <i>(Quantity X Unit Price)</i>
702-01-00150	3	EA	\$ _____.	\$ _____.
<i>Description:</i>	Manhole (Remove And Replace Frame And Cover)			
REF. NO.	QUANTITY	UNIT OF MEASURE	UNIT PRICE	UNIT PRICE EXTENSION <i>(Quantity X Unit Price)</i>
702-02-00001	2	EA	\$ _____.	\$ _____.
<i>Description:</i>	Manholes (R-Cb-11)			
REF. NO.	QUANTITY	UNIT OF MEASURE	UNIT PRICE	UNIT PRICE EXTENSION <i>(Quantity X Unit Price)</i>
702-02-00200	1	EA	\$ _____.	\$ _____.
<i>Description:</i>	Catch Basin (Cb-02)			
REF. NO.	QUANTITY	UNIT OF MEASURE	UNIT PRICE	UNIT PRICE EXTENSION <i>(Quantity X Unit Price)</i>
702-03-00200	1	EA	\$ _____.	\$ _____.

LOUISIANA UNIFORM PUBLIC WORK BID FORM

UNIT PRICE FORM

**To: CITY OF BATON ROUGE
PARISH OF EAST BATON ROUGE
DEPARTMENT OF PUBLIC WORKS**

**BID FOR: SCENIC HIGHWAY (HARDING BLVD. TO SWAN
AVE)**

**Date: 2/5/2026
Project Number: 20-EN-HC-0006**

<i>Description:</i>	Catch Basin (Cb-06)			
REF. NO.	QUANTITY	UNIT OF MEASURE	UNIT PRICE	UNIT PRICE EXTENSION <i>(Quantity X Unit Price)</i>
702-03-00500	2	EA	\$ _____.	\$ _____.
<i>Description:</i>	Catch Basin (Cb-07)			
REF. NO.	QUANTITY	UNIT OF MEASURE	UNIT PRICE	UNIT PRICE EXTENSION <i>(Quantity X Unit Price)</i>
702-03-00600	3	EA	\$ _____.	\$ _____.
<i>Description:</i>	Catch Basin (Cb-08)			
REF. NO.	QUANTITY	UNIT OF MEASURE	UNIT PRICE	UNIT PRICE EXTENSION <i>(Quantity X Unit Price)</i>
702-03-00700	1	EA	\$ _____.	\$ _____.
<i>Description:</i>	Catch Basin (Cb-09)			
REF. NO.	QUANTITY	UNIT OF MEASURE	UNIT PRICE	UNIT PRICE EXTENSION <i>(Quantity X Unit Price)</i>
702-03-00800	1	EA	\$ _____.	\$ _____.
<i>Description:</i>	Adjusting Manholes			
REF. NO.	QUANTITY	UNIT OF MEASURE	UNIT PRICE	UNIT PRICE EXTENSION <i>(Quantity X Unit Price)</i>
702-04-00100	4	EA	\$ _____.	\$ _____.
<i>Description:</i>	Convert Catch Basins To Manholes			
REF. NO.	QUANTITY	UNIT OF MEASURE	UNIT PRICE	UNIT PRICE EXTENSION <i>(Quantity X Unit Price)</i>
702-04-00210	1	EA	\$ _____.	\$ _____.

LOUISIANA UNIFORM PUBLIC WORK BID FORM

UNIT PRICE FORM

**To: CITY OF BATON ROUGE
PARISH OF EAST BATON ROUGE
DEPARTMENT OF PUBLIC WORKS**

BID FOR: SCENIC HIGHWAY (HARDING BLVD. TO SWAN AVE)

**Date: 2/5/2026
Project Number: 20-EN-HC-0006**

<i>Description:</i>	Concrete Sidewalk (5" Thick)			
REF. NO.	QUANTITY	UNIT OF MEASURE	UNIT PRICE	UNIT PRICE EXTENSION (Quantity X Unit Price)
706-01-00200	2,380.0	SY	\$ _____	\$ _____
<i>Description:</i>	Concrete Drives (8" Thick)			
REF. NO.	QUANTITY	UNIT OF MEASURE	UNIT PRICE	UNIT PRICE EXTENSION (Quantity X Unit Price)
706-02-00300	700.0	SY	\$ _____	\$ _____
<i>Description:</i>	Incidental Concrete Paving (5" Thick)			
REF. NO.	QUANTITY	UNIT OF MEASURE	UNIT PRICE	UNIT PRICE EXTENSION (Quantity X Unit Price)
706-03-00200	340.0	SY	\$ _____	\$ _____
<i>Description:</i>	Curb Ramps			
REF. NO.	QUANTITY	UNIT OF MEASURE	UNIT PRICE	UNIT PRICE EXTENSION (Quantity X Unit Price)
706-04-00110	360.0	SY	\$ _____	\$ _____
<i>Description:</i>	Concrete Curb (6" Barrier)			
REF. NO.	QUANTITY	UNIT OF MEASURE	UNIT PRICE	UNIT PRICE EXTENSION (Quantity X Unit Price)
707-01-00100	330.0	LF	\$ _____	\$ _____
<i>Description:</i>	Combination Concrete Curb And Gutter			
REF. NO.	QUANTITY	UNIT OF MEASURE	UNIT PRICE	UNIT PRICE EXTENSION (Quantity X Unit Price)
707-03-00100	5,320.0	LF	\$ _____	\$ _____

LOUISIANA UNIFORM PUBLIC WORK BID FORM

UNIT PRICE FORM

**To: CITY OF BATON ROUGE
PARISH OF EAST BATON ROUGE
DEPARTMENT OF PUBLIC WORKS**

**BID FOR: SCENIC HIGHWAY (HARDING BLVD. TO SWAN
AVE)**

**Date: 2/5/2026
Project Number: 20-EN-HC-0006**

<i>Description:</i>	Temporary Signs And Barricades			
REF. NO.	QUANTITY	UNIT OF MEASURE	UNIT PRICE	UNIT PRICE EXTENSION (Quantity X Unit Price)
713-01-00100	1	LS	\$ _____.	\$ _____.
<i>Description:</i>	Temporary Pavement Markings (4" Width)			
REF. NO.	QUANTITY	UNIT OF MEASURE	UNIT PRICE	UNIT PRICE EXTENSION (Quantity X Unit Price)
713-02-00100	5,600	LF	\$ _____.	\$ _____.
<i>Description:</i>	Temporary Pavement Markings (24" Width)			
REF. NO.	QUANTITY	UNIT OF MEASURE	UNIT PRICE	UNIT PRICE EXTENSION (Quantity X Unit Price)
713-02-00500	325	LF	\$ _____.	\$ _____.
<i>Description:</i>	Slab Sodding (Centipede)			
REF. NO.	QUANTITY	UNIT OF MEASURE	UNIT PRICE	UNIT PRICE EXTENSION (Quantity X Unit Price)
714-01-00700	1,050	SY	\$ _____.	\$ _____.
<i>Description:</i>	Topsoil			
REF. NO.	QUANTITY	UNIT OF MEASURE	UNIT PRICE	UNIT PRICE EXTENSION (Quantity X Unit Price)
715-01-00100	125	CY	\$ _____.	\$ _____.
<i>Description:</i>	Bedding Material			
REF. NO.	QUANTITY	UNIT OF MEASURE	UNIT PRICE	UNIT PRICE EXTENSION (Quantity X Unit Price)
726-01-00100	15.00	CY	\$ _____.	\$ _____.

LOUISIANA UNIFORM PUBLIC WORK BID FORM

UNIT PRICE FORM

**To: CITY OF BATON ROUGE
PARISH OF EAST BATON ROUGE
DEPARTMENT OF PUBLIC WORKS**

**BID FOR: SCENIC HIGHWAY (HARDING BLVD. TO SWAN
AVE)**

**Date: 2/5/2026
Project Number: 20-EN-HC-0006**

<i>Description:</i>	Mobilization			
REF. NO.	QUANTITY	UNIT OF MEASURE	UNIT PRICE	UNIT PRICE EXTENSION (Quantity X Unit Price)
727-01-00100	1	LS	\$ _____.	\$ _____.
<i>Description:</i>	Sign (Type A)			
REF. NO.	QUANTITY	UNIT OF MEASURE	UNIT PRICE	UNIT PRICE EXTENSION (Quantity X Unit Price)
729-01-00100	405.3	SF	\$ _____.	\$ _____.
<i>Description:</i>	Sign (Type B)			
REF. NO.	QUANTITY	UNIT OF MEASURE	UNIT PRICE	UNIT PRICE EXTENSION (Quantity X Unit Price)
729-02-00100	144.0	SF	\$ _____.	\$ _____.
<i>Description:</i>	Sign (Type D)			
REF. NO.	QUANTITY	UNIT OF MEASURE	UNIT PRICE	UNIT PRICE EXTENSION (Quantity X Unit Price)
729-04-00100	28	SF	\$ _____.	\$ _____.
<i>Description:</i>	Mounting (2 1/2" Size Post)			
REF. NO.	QUANTITY	UNIT OF MEASURE	UNIT PRICE	UNIT PRICE EXTENSION (Quantity X Unit Price)
729-08-00100	40	EA	\$ _____.	\$ _____.

LOUISIANA UNIFORM PUBLIC WORK BID FORM

UNIT PRICE FORM

**To: CITY OF BATON ROUGE
PARISH OF EAST BATON ROUGE
DEPARTMENT OF PUBLIC WORKS**

BID FOR: SCENIC HIGHWAY (HARDING BLVD. TO SWAN AVE)

**Date: 2/5/2026
Project Number: 20-EN-HC-0006**

<i>Description:</i>	Dead End Road Installations (Type A)			
REF. NO.	QUANTITY	UNIT OF MEASURE	UNIT PRICE	UNIT PRICE EXTENSION (Quantity X Unit Price)
729-19-00100	1	EA	\$ _____.	\$ _____.
<i>Description:</i>	Reflectorized Raised Pavement Markers			
REF. NO.	QUANTITY	UNIT OF MEASURE	UNIT PRICE	UNIT PRICE EXTENSION (Quantity X Unit Price)
731-02-00100	130	EA	\$ _____.	\$ _____.
<i>Description:</i>	Plastic Pavement Striping (4" Width) (Thermoplastic 90 Mil)			
REF. NO.	QUANTITY	UNIT OF MEASURE	UNIT PRICE	UNIT PRICE EXTENSION (Quantity X Unit Price)
732-01-01000	7,190	LF	\$ _____.	\$ _____.
<i>Description:</i>	Plastic Pavement Striping (8" Width) (Thermoplastic 125Mil)			
REF. NO.	QUANTITY	UNIT OF MEASURE	UNIT PRICE	UNIT PRICE EXTENSION (Quantity X Unit Price)
732-01-02040	712	LF	\$ _____.	\$ _____.
<i>Description:</i>	Plastic Pavement Striping (24" Width) (Thermoplastic 125 Mil)			
REF. NO.	QUANTITY	UNIT OF MEASURE	UNIT PRICE	UNIT PRICE EXTENSION (Quantity X Unit Price)
732-01-02080	1,754	LF	\$ _____.	\$ _____.
<i>Description:</i>	Plastic Pavement Striping (Broken Line) (4" Width) (Thermoplastic 90 Mil)			
REF. NO.	QUANTITY	UNIT OF MEASURE	UNIT PRICE	UNIT PRICE EXTENSION (Quantity X Unit Price)
732-03-02000	0.143	MILE	\$ _____.	\$ _____.

LOUISIANA UNIFORM PUBLIC WORK BID FORM

UNIT PRICE FORM

**To: CITY OF BATON ROUGE
PARISH OF EAST BATON ROUGE
DEPARTMENT OF PUBLIC WORKS**

**BID FOR: SCENIC HIGHWAY (HARDING BLVD. TO SWAN
AVE)**

**Date: 2/5/2026
Project Number: 20-EN-HC-0006**

<i>Description:</i>	Plastic Pavement Legends And Symbols (Arrow - Straight)			
REF. NO.	QUANTITY	UNIT OF MEASURE	UNIT PRICE	UNIT PRICE EXTENSION <i>(Quantity X Unit Price)</i>
732-04-01020	6	EA	\$ _____.	\$ _____.
<i>Description:</i>	Plastic Pavement Legends And Symbols (Arrow - Double)			
REF. NO.	QUANTITY	UNIT OF MEASURE	UNIT PRICE	UNIT PRICE EXTENSION <i>(Quantity X Unit Price)</i>
732-04-01040	6	EA	\$ _____.	\$ _____.
<i>Description:</i>	Plastic Pavement Legends And Symbols (Arrow - Left Turn)			
REF. NO.	QUANTITY	UNIT OF MEASURE	UNIT PRICE	UNIT PRICE EXTENSION <i>(Quantity X Unit Price)</i>
732-04-01080	11	EA	\$ _____.	\$ _____.
<i>Description:</i>	Plastic Pavement Legends And Symbols (Arrow - Right Turn)			
REF. NO.	QUANTITY	UNIT OF MEASURE	UNIT PRICE	UNIT PRICE EXTENSION <i>(Quantity X Unit Price)</i>
732-04-01100	5	EA	\$ _____.	\$ _____.
<i>Description:</i>	Plastic Pavement Legends And Symbols (Rr Crossing)			
REF. NO.	QUANTITY	UNIT OF MEASURE	UNIT PRICE	UNIT PRICE EXTENSION <i>(Quantity X Unit Price)</i>
732-04-18000	4	EA	\$ _____.	\$ _____.
<i>Description:</i>	Removal Of Existing Markings			
REF. NO.	QUANTITY	UNIT OF MEASURE	UNIT PRICE	UNIT PRICE EXTENSION <i>(Quantity X Unit Price)</i>
732-05-00100	0.750	MILE	\$ _____.	\$ _____.

LOUISIANA UNIFORM PUBLIC WORK BID FORM

UNIT PRICE FORM

**To: CITY OF BATON ROUGE
PARISH OF EAST BATON ROUGE
DEPARTMENT OF PUBLIC WORKS**

**BID FOR: SCENIC HIGHWAY (HARDING BLVD. TO SWAN
AVE)**

**Date: 2/5/2026
Project Number: 20-EN-HC-0006**

<i>Description:</i>	Construction Layout			
REF. NO.	QUANTITY	UNIT OF MEASURE	UNIT PRICE	UNIT PRICE EXTENSION (Quantity X Unit Price)
740-01-00100	1	LS	\$ _____.	\$ _____.
<i>Description:</i>	Traffic Maintenance Asphalt Concrete			
REF. NO.	QUANTITY	UNIT OF MEASURE	UNIT PRICE	UNIT PRICE EXTENSION (Quantity X Unit Price)
NS-500-00300	60.0	TON	\$ _____.	\$ _____.
<i>Description:</i>	Saw Cutting Asphalt Concrete Pavement			
REF. NO.	QUANTITY	UNIT OF MEASURE	UNIT PRICE	UNIT PRICE EXTENSION (Quantity X Unit Price)
NS-500-00340	3,545	INLF	\$ _____.	\$ _____.
<i>Description:</i>	Saw Cutting Asphalt Conc. Pavement Over Portland Cement Concrete Pavement			
REF. NO.	QUANTITY	UNIT OF MEASURE	UNIT PRICE	UNIT PRICE EXTENSION (Quantity X Unit Price)
NS-500-00360	3,732	INLF	\$ _____.	\$ _____.
<i>Description:</i>	Adjusting Gas Valves And Boxes			
REF. NO.	QUANTITY	UNIT OF MEASURE	UNIT PRICE	UNIT PRICE EXTENSION (Quantity X Unit Price)
TS-MSC-00280	1	EA	\$ _____.	\$ _____.
<i>Description:</i>	Adjusting Utility Boxes			
REF. NO.	QUANTITY	UNIT OF MEASURE	UNIT PRICE	UNIT PRICE EXTENSION (Quantity X Unit Price)
TS-MSC-01040	2	EA	\$ _____.	\$ _____.

LOUISIANA UNIFORM PUBLIC WORK BID FORM

UNIT PRICE FORM

**To: CITY OF BATON ROUGE
PARISH OF EAST BATON ROUGE
DEPARTMENT OF PUBLIC WORKS**

BID FOR: SCENIC HIGHWAY (HARDING BLVD. TO SWAN AVE)

**Date: 2/5/2026
Project Number: 20-EN-HC-0006**

<i>Description:</i>	Trenching And Backfilling			
REF. NO.	QUANTITY	UNIT OF MEASURE	UNIT PRICE	UNIT PRICE EXTENSION <i>(Quantity X Unit Price)</i>
736-01-00100	1,695.0	LNFT	\$ _____.	\$ _____.
<i>Description:</i>	Jacking Or Boring			
REF. NO.	QUANTITY	UNIT OF MEASURE	UNIT PRICE	UNIT PRICE EXTENSION <i>(Quantity X Unit Price)</i>
736-03-00100	3,610.0	LNFT	\$ _____.	\$ _____.
<i>Description:</i>	Signal Pole (Pedestal Pole)			
REF. NO.	QUANTITY	UNIT OF MEASURE	UNIT PRICE	UNIT PRICE EXTENSION <i>(Quantity X Unit Price)</i>
736-04-00001	24	EACH	\$ _____.	\$ _____.
<i>Description:</i>	Signal Support (Mast Arm Standard W/ 35 Ft Arm)			
REF. NO.	QUANTITY	UNIT OF MEASURE	UNIT PRICE	UNIT PRICE EXTENSION <i>(Quantity X Unit Price)</i>
TS-736-10350	2	EACH	\$ _____.	\$ _____.

LOUISIANA UNIFORM PUBLIC WORK BID FORM

UNIT PRICE FORM

**To: CITY OF BATON ROUGE
PARISH OF EAST BATON ROUGE
DEPARTMENT OF PUBLIC WORKS**

BID FOR: SCENIC HIGHWAY (HARDING BLVD. TO SWAN AVE)

**Date: 2/5/2026
Project Number: 20-EN-HC-0006**

<i>Description:</i>	Signal Support (Mast Arm Standard W/ 40 Ft Arm)			
REF. NO.	QUANTITY	UNIT OF MEASURE	UNIT PRICE	UNIT PRICE EXTENSION (Quantity X Unit Price)
TS-736-10400	2	EACH	\$ _____.	\$ _____.
<i>Description:</i>	Signal Support (Mast Arm Standard W/ 45 Ft Arm)			
REF. NO.	QUANTITY	UNIT OF MEASURE	UNIT PRICE	UNIT PRICE EXTENSION (Quantity X Unit Price)
TS-736-10450	1	EACH	\$ _____.	\$ _____.
<i>Description:</i>	Signal Support (Mast Arm Standard W/ 50 Ft Arm)			
REF. NO.	QUANTITY	UNIT OF MEASURE	UNIT PRICE	UNIT PRICE EXTENSION (Quantity X Unit Price)
TS-736-10500	2	EACH	\$ _____.	\$ _____.
<i>Description:</i>	Signal Support (Mast Arm Standard W/ 55 Ft Arm)			
REF. NO.	QUANTITY	UNIT OF MEASURE	UNIT PRICE	UNIT PRICE EXTENSION (Quantity X Unit Price)
TS-736-10550	1	EACH	\$ _____.	\$ _____.
<i>Description:</i>	Additional Mast Arm (35 Ft. Arm)			
REF. NO.	QUANTITY	UNIT OF MEASURE	UNIT PRICE	UNIT PRICE EXTENSION (Quantity X Unit Price)
TS-736-11350	1	EACH	\$ _____.	\$ _____.
<i>Description:</i>	Additional Mast Arm (40 Ft. Arm)			
REF. NO.	QUANTITY	UNIT OF MEASURE	UNIT PRICE	UNIT PRICE EXTENSION (Quantity X Unit Price)
TS-736-11400	2	EACH	\$ _____.	\$ _____.

LOUISIANA UNIFORM PUBLIC WORK BID FORM

UNIT PRICE FORM

**To: CITY OF BATON ROUGE
PARISH OF EAST BATON ROUGE
DEPARTMENT OF PUBLIC WORKS**

**BID FOR: SCENIC HIGHWAY (HARDING BLVD. TO SWAN
AVE)**

**Date: 2/5/2026
Project Number: 20-EN-HC-0006**

<i>Description:</i>	Signal Heads (3 Section, 12 Inch Led Lens, R, Y, G)			
REF. NO.	QUANTITY	UNIT OF MEASURE	UNIT PRICE	UNIT PRICE EXTENSION <i>(Quantity X Unit Price)</i>
736-05-30000	10	EACH	\$ _____.	\$ _____.
<i>Description:</i>	Signal Heads (3 Section, 12 Inch Optically Programmed Lens, R, Y, G)			
REF. NO.	QUANTITY	UNIT OF MEASURE	UNIT PRICE	UNIT PRICE EXTENSION <i>(Quantity X Unit Price)</i>
736-05-30002	4	EACH	\$ _____.	\$ _____.
<i>Description:</i>	Signal Heads (3 Section, 12 Inch Led Lens, R, R, Y)			
REF. NO.	QUANTITY	UNIT OF MEASURE	UNIT PRICE	UNIT PRICE EXTENSION <i>(Quantity X Unit Price)</i>
736-05-30004	6	EACH	\$ _____.	\$ _____.
<i>Description:</i>	Signal Heads (3 Sec, 12 Inch Led Lens, Lt. R, Lt. Y, Lt. G)			
REF. NO.	QUANTITY	UNIT OF MEASURE	UNIT PRICE	UNIT PRICE EXTENSION <i>(Quantity X Unit Price)</i>
736-05-31001	3	EACH	\$ _____.	\$ _____.
<i>Description:</i>	Signal Heads (3 Sec, 12 Inch Led Lens, Lt. R, Lt. Y, Flt. Y)			
REF. NO.	QUANTITY	UNIT OF MEASURE	UNIT PRICE	UNIT PRICE EXTENSION <i>(Quantity X Unit Price)</i>
736-05-31200	1	EACH	\$ _____.	\$ _____.
<i>Description:</i>	Signal Heads (3 Sec, 12 Inch Led Lens, Rt. R, Rt. Y, Rt. G)			
REF. NO.	QUANTITY	UNIT OF MEASURE	UNIT PRICE	UNIT PRICE EXTENSION <i>(Quantity X Unit Price)</i>
736-05-35001	3	EACH	\$ _____.	\$ _____.

LOUISIANA UNIFORM PUBLIC WORK BID FORM

UNIT PRICE FORM

**To: CITY OF BATON ROUGE
PARISH OF EAST BATON ROUGE
DEPARTMENT OF PUBLIC WORKS**

BID FOR: SCENIC HIGHWAY (HARDING BLVD. TO SWAN AVE)

**Date: 2/5/2026
Project Number: 20-EN-HC-0006**

<i>Description:</i>	Signal Heads (5 Section, 12 Inch Led Lens, R, Y, Rt. Y, G, Rt. G)			
REF. NO.	QUANTITY	UNIT OF MEASURE	UNIT PRICE	UNIT PRICE EXTENSION <i>(Quantity X Unit Price)</i>
736-05-55000	1	EACH	\$ _____.	\$ _____.
<i>Description:</i>	Signal Service With Separate Disconnect For Street Lights			
REF. NO.	QUANTITY	UNIT OF MEASURE	UNIT PRICE	UNIT PRICE EXTENSION <i>(Quantity X Unit Price)</i>
736-06-00300	2	EACH	\$ _____.	\$ _____.
<i>Description:</i>	Signal Service Pedestal Disconnect			
REF. NO.	QUANTITY	UNIT OF MEASURE	UNIT PRICE	UNIT PRICE EXTENSION <i>(Quantity X Unit Price)</i>
736-06-00500	2	EACH	\$ _____.	\$ _____.
<i>Description:</i>	Signal Controller (980 Atc, Type 2)(Furnish & Install)			
REF. NO.	QUANTITY	UNIT OF MEASURE	UNIT PRICE	UNIT PRICE EXTENSION <i>(Quantity X Unit Price)</i>
736-06-00102	1	EACH	\$ _____.	\$ _____.
<i>Description:</i>	Signal Controller (Atc 32 Phase Shelf Mount)(Furnish & Install)			
REF. NO.	QUANTITY	UNIT OF MEASURE	UNIT PRICE	UNIT PRICE EXTENSION <i>(Quantity X Unit Price)</i>
9060813	1	EACH	\$ _____.	\$ _____.
<i>Description:</i>	Signal Controller (Atc 32 Phase Shelf Mount)(Furnish)			
REF. NO.	QUANTITY	UNIT OF MEASURE	UNIT PRICE	UNIT PRICE EXTENSION <i>(Quantity X Unit Price)</i>
9060814	1	EACH	\$ _____.	\$ _____.

LOUISIANA UNIFORM PUBLIC WORK BID FORM

UNIT PRICE FORM

**To: CITY OF BATON ROUGE
PARISH OF EAST BATON ROUGE
DEPARTMENT OF PUBLIC WORKS**

BID FOR: SCENIC HIGHWAY (HARDING BLVD. TO SWAN AVE)

**Date: 2/5/2026
Project Number: 20-EN-HC-0006**

<i>Description:</i>	Underground Junction Box (Type E)			
REF. NO.	QUANTITY	UNIT OF MEASURE	UNIT PRICE	UNIT PRICE EXTENSION (Quantity X Unit Price)
736-10-00200	4	EACH	\$ _____.	\$ _____.
<i>Description:</i>	Underground Junction Box (Type F)			
REF. NO.	QUANTITY	UNIT OF MEASURE	UNIT PRICE	UNIT PRICE EXTENSION (Quantity X Unit Price)
736-10-00300	30	EACH	\$ _____.	\$ _____.
<i>Description:</i>	Underground Junction Box (Type G)			
REF. NO.	QUANTITY	UNIT OF MEASURE	UNIT PRICE	UNIT PRICE EXTENSION (Quantity X Unit Price)
736-10-00400	2	EACH	\$ _____.	\$ _____.
<i>Description:</i>	Underground Junction Box (Type I)			
REF. NO.	QUANTITY	UNIT OF MEASURE	UNIT PRICE	UNIT PRICE EXTENSION (Quantity X Unit Price)
736-10-00600	1	EACH	\$ _____.	\$ _____.
<i>Description:</i>	Underground Junction Box (Type J)			
REF. NO.	QUANTITY	UNIT OF MEASURE	UNIT PRICE	UNIT PRICE EXTENSION (Quantity X Unit Price)
736-10-00700	1	EACH	\$ _____.	\$ _____.
<i>Description:</i>	Conduit (2" Hdpe, Schedule 80)			
REF. NO.	QUANTITY	UNIT OF MEASURE	UNIT PRICE	UNIT PRICE EXTENSION (Quantity X Unit Price)
736-11-00200	1,940.0	LNFT	\$ _____.	\$ _____.

LOUISIANA UNIFORM PUBLIC WORK BID FORM

UNIT PRICE FORM

**To: CITY OF BATON ROUGE
PARISH OF EAST BATON ROUGE
DEPARTMENT OF PUBLIC WORKS**

BID FOR: SCENIC HIGHWAY (HARDING BLVD. TO SWAN AVE)

**Date: 2/5/2026
Project Number: 20-EN-HC-0006**

<i>Description:</i>	Conduit (3" Hdpe, Schedule 80)			
REF. NO.	QUANTITY	UNIT OF MEASURE	UNIT PRICE	UNIT PRICE EXTENSION <i>(Quantity X Unit Price)</i>
736-11-00300	6,980.0	LNFT	\$ _____.	\$ _____.
<i>Description:</i>	Conductor (2C, #6 Awg)			
REF. NO.	QUANTITY	UNIT OF MEASURE	UNIT PRICE	UNIT PRICE EXTENSION <i>(Quantity X Unit Price)</i>
736-12-02006	1,965.0	LNFT	\$ _____.	\$ _____.
<i>Description:</i>	Conductor (2C, #14 Awg)			
REF. NO.	QUANTITY	UNIT OF MEASURE	UNIT PRICE	UNIT PRICE EXTENSION <i>(Quantity X Unit Price)</i>
736-12-02014	10,760.0	LNFT	\$ _____.	\$ _____.
<i>Description:</i>	Conductor (3C, 6 Gauge / #6 Awg)			
REF. NO.	QUANTITY	UNIT OF MEASURE	UNIT PRICE	UNIT PRICE EXTENSION <i>(Quantity X Unit Price)</i>
736-12-03006	600.0	LNFT	\$ _____.	\$ _____.
<i>Description:</i>	Conductor (3C, #14 Awg)			
REF. NO.	QUANTITY	UNIT OF MEASURE	UNIT PRICE	UNIT PRICE EXTENSION <i>(Quantity X Unit Price)</i>
736-12-03014	2,145.0	LNFT	\$ _____.	\$ _____.
<i>Description:</i>	Conductor (6C, #14 Awg)			
REF. NO.	QUANTITY	UNIT OF MEASURE	UNIT PRICE	UNIT PRICE EXTENSION <i>(Quantity X Unit Price)</i>
736-12-06014	11,635.0	LNFT	\$ _____.	\$ _____.

LOUISIANA UNIFORM PUBLIC WORK BID FORM

UNIT PRICE FORM

**To: CITY OF BATON ROUGE
PARISH OF EAST BATON ROUGE
DEPARTMENT OF PUBLIC WORKS**

BID FOR: SCENIC HIGHWAY (HARDING BLVD. TO SWAN AVE)

**Date: 2/5/2026
Project Number: 20-EN-HC-0006**

<i>Description:</i>	Conductor (10C, #14 Awg)			
REF. NO.	QUANTITY	UNIT OF MEASURE	UNIT PRICE	UNIT PRICE EXTENSION (Quantity X Unit Price)
736-12-10014	9,785.0	LNFT	\$ _____	\$ _____
<i>Description:</i>	Signal Support (Foundation, 24 Inch Minimum Diameter)			
REF. NO.	QUANTITY	UNIT OF MEASURE	UNIT PRICE	UNIT PRICE EXTENSION (Quantity X Unit Price)
736-15-02400	26	EACH	\$ _____	\$ _____
<i>Description:</i>	Video Detection Cabinet Components			
REF. NO.	QUANTITY	UNIT OF MEASURE	UNIT PRICE	UNIT PRICE EXTENSION (Quantity X Unit Price)
736-17-00000	2	EACH	\$ _____	\$ _____
<i>Description:</i>	Video Detection Camera (Sensor)			
REF. NO.	QUANTITY	UNIT OF MEASURE	UNIT PRICE	UNIT PRICE EXTENSION (Quantity X Unit Price)
TS-736-36203	6	EACH	\$ _____	\$ _____
<i>Description:</i>	Integrated Radar Unit & Video Detection Camera (Sensor)			
REF. NO.	QUANTITY	UNIT OF MEASURE	UNIT PRICE	UNIT PRICE EXTENSION (Quantity X Unit Price)
TS-736-36202	6	EACH	\$ _____	\$ _____
<i>Description:</i>	Video Detection Cable			
REF. NO.	QUANTITY	UNIT OF MEASURE	UNIT PRICE	UNIT PRICE EXTENSION (Quantity X Unit Price)
TS-736-36204	6,745.0	LNFT	\$ _____	\$ _____

LOUISIANA UNIFORM PUBLIC WORK BID FORM

UNIT PRICE FORM

**To: CITY OF BATON ROUGE
PARISH OF EAST BATON ROUGE
DEPARTMENT OF PUBLIC WORKS**

**BID FOR: SCENIC HIGHWAY (HARDING BLVD. TO SWAN
AVE)**

**Date: 2/5/2026
Project Number: 20-EN-HC-0006**

<i>Description:</i>	Led Pedestrian Countdown Signal Head			
REF. NO.	QUANTITY	UNIT OF MEASURE	UNIT PRICE	UNIT PRICE EXTENSION (Quantity X Unit Price)
736-21-00000	24	EACH	\$ _____.	\$ _____.
<i>Description:</i>	Led Blank Out Sign			
REF. NO.	QUANTITY	UNIT OF MEASURE	UNIT PRICE	UNIT PRICE EXTENSION (Quantity X Unit Price)
736-23-00000	2	EACH	\$ _____.	\$ _____.
<i>Description:</i>	Ts-2 Traffic Signal Cabinet (Ground Mounted)			
REF. NO.	QUANTITY	UNIT OF MEASURE	UNIT PRICE	UNIT PRICE EXTENSION (Quantity X Unit Price)
NS-736-00130	1	EACH	\$ _____.	\$ _____.
<i>Description:</i>	Ate Signal Cabinet (Ground Mounted) (Furnish & Install)			
REF. NO.	QUANTITY	UNIT OF MEASURE	UNIT PRICE	UNIT PRICE EXTENSION (Quantity X Unit Price)
9060710	1	EACH	\$ _____.	\$ _____.
<i>Description:</i>	Ate Signal Cabinet (Ground Mounted) (Furnish)			
REF. NO.	QUANTITY	UNIT OF MEASURE	UNIT PRICE	UNIT PRICE EXTENSION (Quantity X Unit Price)
9060711	1	EACH	\$ _____.	\$ _____.
<i>Description:</i>	Battery Back-Up System For Traffic Signals			
REF. NO.	QUANTITY	UNIT OF MEASURE	UNIT PRICE	UNIT PRICE EXTENSION (Quantity X Unit Price)
NS-736-00133	3	EACH	\$ _____.	\$ _____.

LOUISIANA UNIFORM PUBLIC WORK BID FORM

UNIT PRICE FORM

**To: CITY OF BATON ROUGE
PARISH OF EAST BATON ROUGE
DEPARTMENT OF PUBLIC WORKS**

**BID FOR: SCENIC HIGHWAY (HARDING BLVD. TO SWAN
AVE)**

**Date: 2/5/2026
Project Number: 20-EN-HC-0006**

<i>Description:</i>	2-Wire Accessible Pedestrian Pushbutton Detectors			
REF. NO.	QUANTITY	UNIT OF MEASURE	UNIT PRICE	UNIT PRICE EXTENSION (Quantity X Unit Price)
NS-736-00135	24	EACH	\$ _____.	\$ _____.
<i>Description:</i>	2-Wire Accessible Pedestrian Pushbutton Cabinet Control			
REF. NO.	QUANTITY	UNIT OF MEASURE	UNIT PRICE	UNIT PRICE EXTENSION (Quantity X Unit Price)
NS-736-00136	3	EACH	\$ _____.	\$ _____.
<i>Description:</i>	Luminaire Arm W/Led Luminaire (15 Ft. Arm)			
REF. NO.	QUANTITY	UNIT OF MEASURE	UNIT PRICE	UNIT PRICE EXTENSION (Quantity X Unit Price)
TS-736-12015	8	EACH	\$ _____.	\$ _____.
<i>Description:</i>	Gps Based Traffic Signal Preemption System (With Existing Fiber Communication)			
REF. NO.	QUANTITY	UNIT OF MEASURE	UNIT PRICE	UNIT PRICE EXTENSION (Quantity X Unit Price)
TS-736-15002	2	EACH	\$ _____.	\$ _____.
<i>Description:</i>	Fiber Optic Marker			
REF. NO.	QUANTITY	UNIT OF MEASURE	UNIT PRICE	UNIT PRICE EXTENSION (Quantity X Unit Price)
NS-ITS-04000	2	EACH	\$ _____.	\$ _____.
<i>Description:</i>	Fiber Optic Fan Out Kits, Sm, 12 Strand, Furnish & Install			
REF. NO.	QUANTITY	UNIT OF MEASURE	UNIT PRICE	UNIT PRICE EXTENSION (Quantity X Unit Price)
NS-ITS-04035	2	EACH	\$ _____.	\$ _____.

LOUISIANA UNIFORM PUBLIC WORK BID FORM

UNIT PRICE FORM

**To: CITY OF BATON ROUGE
PARISH OF EAST BATON ROUGE
DEPARTMENT OF PUBLIC WORKS**

BID FOR: SCENIC HIGHWAY (HARDING BLVD. TO SWAN AVE)

**Date: 2/5/2026
Project Number: 20-EN-HC-0006**

<i>Description:</i>	Fiber Optic Connection, Install, Splice			
REF. NO.	QUANTITY	UNIT OF MEASURE	UNIT PRICE	UNIT PRICE EXTENSION (Quantity X Unit Price)
NS-ITS-04180	8	EACH	\$ _____.	\$ _____.
<i>Description:</i>	Fiber Optic Connection, Termination, Furnish & Install			
REF. NO.	QUANTITY	UNIT OF MEASURE	UNIT PRICE	UNIT PRICE EXTENSION (Quantity X Unit Price)
NS-ITS-04200	24	EACH	\$ _____.	\$ _____.
<i>Description:</i>	Fiber Optic Drop Cable, Sm, 12 Strand, Furnish & Install			
REF. NO.	QUANTITY	UNIT OF MEASURE	UNIT PRICE	UNIT PRICE EXTENSION (Quantity X Unit Price)
NS-ITS-04250	925.0	LNFT	\$ _____.	\$ _____.
<i>Description:</i>	Fiber Optic Patch Cord, Sm, 2 Strand, Furnish & Install			
REF. NO.	QUANTITY	UNIT OF MEASURE	UNIT PRICE	UNIT PRICE EXTENSION (Quantity X Unit Price)
NS-ITS-04290	4	EACH	\$ _____.	\$ _____.
<i>Description:</i>	Fiber Optic Connection Patch Panel, Outdoor, Furnish & Install			
REF. NO.	QUANTITY	UNIT OF MEASURE	UNIT PRICE	UNIT PRICE EXTENSION (Quantity X Unit Price)
NS-ITS-04425	2	EACH	\$ _____.	\$ _____.
<i>Description:</i>	Local Ethernet Switch, Furnish & Install			
REF. NO.	QUANTITY	UNIT OF MEASURE	UNIT PRICE	UNIT PRICE EXTENSION (Quantity X Unit Price)
NS-ITS-09080	1	EACH	\$ _____.	\$ _____.

LOUISIANA UNIFORM PUBLIC WORK BID FORM

UNIT PRICE FORM

**To: CITY OF BATON ROUGE
PARISH OF EAST BATON ROUGE
DEPARTMENT OF PUBLIC WORKS**

**BID FOR: SCENIC HIGHWAY (HARDING BLVD. TO SWAN
AVE)**

**Date: 2/5/2026
Project Number: 20-EN-HC-0006**

<i>Description:</i>	Cctv Camera Assembly, Furnish And Install With Ptz, Digital			
REF. NO.	QUANTITY	UNIT OF MEASURE	UNIT PRICE	UNIT PRICE EXTENSION <i>(Quantity X Unit Price)</i>
NS-ITS-01121	2	EACH	\$ _____.	\$ _____.
<i>Description:</i>	Ptz Cable			
REF. NO.	QUANTITY	UNIT OF MEASURE	UNIT PRICE	UNIT PRICE EXTENSION <i>(Quantity X Unit Price)</i>
9061202	1,145.0	LNFT	\$ _____.	\$ _____.
<i>Description:</i>	Removal Of Existing Traffic Signal / Related Equipment			
REF. NO.	QUANTITY	UNIT OF MEASURE	UNIT PRICE	UNIT PRICE EXTENSION <i>(Quantity X Unit Price)</i>
202-02-40100	1	LS	\$ _____.	\$ _____.
<i>Description:</i>	Traffic Signal Controller Training			
REF. NO.	QUANTITY	UNIT OF MEASURE	UNIT PRICE	UNIT PRICE EXTENSION <i>(Quantity X Unit Price)</i>
9060898	1	LS	\$ _____.	\$ _____.

1. GENERAL NOTES

- 1.1. ALL WORK SHALL CONFORM TO LA DOTD STANDARD SPECIFICATIONS AND MEASURE REQUIREMENTS WITH LA DOTD REQUIREMENTS TO COVER.
- 1.2. THE CONTRACTOR SHALL PROVIDE FUR AND MAINTAIN THROUGH AND LOCAL TRAFFIC AT ALL TIMES AND SHALL CONDUCT OPERATIONS IN SUCH A MANNER AS TO CAUSE THE LEAST POSSIBLE INTERFERENCE WITH TRAFFIC AND BUSINESS. ALL COSTS OF MAINTAINING TRAFFIC SHALL BE INCLUDED IN THE PRICE FOR ITEM 713-01-00100.
- 1.3. CONTRACTOR SHALL KEEP THE PROJECT AREA FREE OF DEBRIS. CONTRACTOR SHALL BE RESPONSIBLE FOR CLEANING THE ROADWAY AND PAVED SIDEWALK AREAS WITHIN THE PROJECT LIMITS TO THE SATISFACTION OF THE PROJECT ENGINEER THROUGH THE CONSTRUCTION PROCESS.
- 1.4. CONTRACTOR IS RESPONSIBLE FOR REPAIRING AND/OR REPLACING ADJOINING PAVEMENT AND SUBSURFACE UTILITIES THAT WERE DAMAGED BY THEIR CONSTRUCTION ACTIVITIES AT NO DIRECT PAY.
- 1.5. THE CONTRACTOR SHALL BE RESPONSIBLE FOR LAYING OUT THE WORK AND VERIFYING ALL MEASUREMENTS AND GRADES PRIOR TO THE BEGINNING OF CONSTRUCTION. IT SHALL BE THE RESPONSIBILITY OF THE CONTRACTOR TO ESTABLISH THE PROJECT CENTERLINE AND ANY NECESSARY TEMPORARY BENCHMARKS FOR CONSTRUCTION PURPOSES PRIOR TO THE START OF CONSTRUCTION. TO BE PAID FOR UNDER CONSTRUCTION LAYOUT - ITEM 740-01-00100.
- 1.6. PRIOR TO BEGINNING OF ANY CONSTRUCTION, THE CONTRACTOR SHALL PERFORM AN AUDIO-VIDEO SURVEY OF THE PROJECT SITE. THE ELECTRONIC FILE OF THE AUDIO-VIDEO SURVEY SHALL BE PROVIDED TO THE PROJECT ENGINEER. TO BE PAID FOR UNDER 727-01-00100.
- 1.7. UNLESS SPECIFIED OTHERWISE, ALL SEWER CLEANOUTS, WATER METER BOXES, VALVE BOXES, JUNCTION BOXES, ETC. SHALL BE ADJUSTED FLUSH WITH THE SIDEWALK. THIS WORK SHALL BE PERFORMED AND COORDINATED WITH THE APPROPRIATE UTILITY OWNER. TO BE PAID FOR UNDER ITEM 75-MSC-01040.
- 1.8. ALL CULVERT ENTRANCES/EXITS SHALL BE CLEARED OF DEBRIS/STOCK, AND, IF BLOCKED, THE OPEN DITCHES SHALL BE GRADED TO DRAIN AT NO DIRECT PAY.
- 1.9. DURING CONSTRUCTION, THE ENTIRE RIGHT-OF-WAY WIDTH SHALL BE CLEARED OF ANY TRASH, DEBRIS, VEGETATION, ETC. IN THE CASE OF VEGETATION, AN EIGHT FOOT MINIMUM "HEAD SPACE" SHALL BE PROVIDED. AT THE COMPLETION OF THE PROJECT, THE ENTIRE PROJECT LENGTH SHALL BE RE-CLEARED WITHIN THE RIGHT-OF-WAY. ALL COSTS SHALL BE INCLUDED IN THE BID ITEM FOR CLEARING AND GRUBBING (ITEM 201-01-00100). THE CONTRACTOR SHALL NOTIFY THE ADJACENT PROPERTY OWNER 14 DAYS PRIOR TO THE REMOVAL OF TREES, SHRUBS, ETC. THE CONTRACTOR SHALL REPLACE, IN KIND, ALL DISTURBED TREES, SHRUBBERY, FLOWERS AND LANDSCAPING OUTSIDE OF THE FOOTPRINT OF THE SIDEWALK WITH PLANT MATERIAL OF SIMILAR SIZE AND TYPE.
- 1.10. EXISTING RAISED PAVEMENT MARKERS SHALL BE REMOVED AS DIRECTED BY THE PROJECT ENGINEER. SHALL BE INCLUDED IN PRICE BID FOR ITEM 731-02-00100. CONTRACTOR SHALL INSTALL BLUE RAISED PAVEMENT MARKERS ADJACENT TO EACH FIRE HYDRANT LOCATION. MARKERS ARE TO BE PLACED IN CENTER OF OUTSIDE LANE. PAY ITEM 731-02-00100.
- 1.11. CONTRACTOR TO NOTIFY ADJACENT RESIDENTS OF CONSTRUCTION A MINIMUM OF 7 DAYS PRIOR TO START OF CONSTRUCTION.
- 1.12. NOISE CONTROL - CONTRACTOR SHALL TAKE REASONABLE MEASURES TO AVOID UNNECESSARY NOISE APPROPRIATE FOR THE AMBIENT SOUND LEVELS ON THE AREA DURING WORKING HOURS. ALL CONSTRUCTION MACHINERY AND VEHICLES SHALL BE EQUIPPED WITH PRACTICAL SOUND MUFFLING DEVICES, AND OPERATED IN A MANNER TO CAUSE THE LEAST NOISE, CONSISTENT WITH EFFICIENT PERFORMANCE OF THE WORK (NO DIRECT PAYMENT PER LOCAL NOISE ORDINANCE).
- 1.13. CONTRACTOR IS RESPONSIBLE FOR COORDINATING CONSTRUCTION ACTIVITIES WITH PROPERTY OWNERS, DEPARTMENT OF PUBLIC WORKS, LA DOTD, AND UTILITY COMPANIES.

2. ROADWAY

- 2.1. REMOVAL OF EXISTING DRAINAGE STRUCTURES AND OTHER ITEMS NOT SPECIFICALLY QUANTIFIED TO BE PAID FOR UNDER ITEM 202-02-05000 REMOVAL OF STRUCTURES AND OBSTRUCTIONS.
- 2.2. EXISTING DRAINAGE STRUCTURES TO REMAIN UNLESS OTHERWISE NOTED.
- 2.3. CONTRACTOR SHALL FIELD VERIFY ELEVATIONS OF ALL DITCH BASIN INLETS AND MANHOLE TOPS.
- 2.4. **ADJUSTMENTS FOLLOWING ALL OVERLAY OPERATIONS AT NO DIRECT PAY**
- 2.5. ADJUSTING DRAINAGE STRUCTURES TO BE PAID FOR UNDER PAY ITEM 702-01-00100. CONNECTION OF PROPOSED PIPES TO EXIST. INLETS TO BE PAID FOR UNDER THE PIPE ITEM.
- 2.6. EXISTING PPC PAVEMENT TO BE PATCHED IN AREAS AS DIRECTED BY THE PROJECT ENGINEER.
- 2.7. LONGITUDINAL AND TRANSVERSE JOINTS IN THE EXISTING PPC PAVEMENT SHALL BE CLEANED AND RESEALED PRIOR TO THE ASPHALT OVERLAY.
- 2.8. RANDOM CRACKS IN THE EXISTING PPC PAVEMENT SHALL BE CLEANED AND SEALED PRIOR TO THE ASPHALT OVERLAY AS DIRECTED BY THE PROJECT ENGINEER.

3. DRIVEWAYS, SIDEWALKS AND CURB RAMPS

- 3.1. FULL-DEPTH SAWCUTTING IS REQUIRED AT ALL AREAS OF PAVEMENT, PARKING, DRIVEWAY AND CURB REMOVAL.
- 3.2. SIDEWALKS REPLACED THROUGH DRIVEWAY LIMITS SHALL BE 8" IN DEPTH UNLESS OTHERWISE SPECIFIED.
- 3.3. UNLESS NOTED OTHERWISE, ALL SIDEWALKS SHALL MATCH ADJACENT DRIVEWAY ELEVATIONS AT A 2% MAX CROSS SLOPE, OR GO THROUGH DRIVEWAYS WITH A 2% MAX CROSS SLOPE.
- 3.4. SIDEWALK RAMPS SHALL BE LAID OUT AND BUILT PER LADDO STD. PLANS PED-01 (SHTS. 1-5).

4. HORTICULTURE REQUIREMENTS

- 4.1. THE CONTRACTOR SHALL ONLY REMOVE TREES, SHRUBS, ETC. LOCATED WITHIN THE EXISTING RIGHT-OF-WAY THAT ARE IN CONFLICT WITH THE PROPOSED IMPROVEMENTS UNLESS OTHERWISE NOTED. ALL COST SHALL BE INCLUDED IN THE BID ITEM FOR CLEARING AND GRUBBING INCLUDING BACKFILLING & COMPACTION AS NEEDED (ITEM 201-01-00100). CONTRACTOR SHALL BE AT LEAST TO THE DENSITY OF THE SURROUNDING GROUND. THE CONTRACTOR SHALL NOTIFY THE ADJACENT PROPERTY OWNER 14 DAYS PRIOR TO REMOVAL OF TREES, SHRUBS, ETC.
- 4.2. ANY TRIMMING REQUIRED SHALL BE DONE IN ACCORDANCE WITH STANDARD HORTICULTURE AND ARBORICULTURAL PRACTICES UNDER ITEM 201-01-00100.
- 4.3. THE CONTRACTOR SHALL REPLACE, IN KIND, ALL DISTURBED TREES, SHRUBBERY, FLOWERS AND LANDSCAPING TO REMAIN OUTSIDE OF THE FOOTPRINT OF THE SIDEWALK WITH PLANT MATERIAL OF SIMILAR SIZE AND TYPE.
- 4.4. THE US POSTAL SERVICE, GARBAGE SERVICES, RECYCLING SERVICES AND OTHER MAIL AND OTHER DELIVERY SERVICES SHALL HAVE ACCESS TO THE PROPERTIES. IT SHALL BE THE CONTRACTOR'S RESPONSIBILITY TO COORDINATE THIS WITH THE APPROPRIATE AGENCY OR GROUP. THIS WORK IS CONSIDERED INCIDENTAL TO CONSTRUCTION AND SHALL BE AT NO DIRECT PAY.
- 4.5. REQUIRED SODDING SHOULD NOT BE PLACED WITHIN THE MULCH LIMITS OF THE PROPOSED AND EXISTING TREES.

5. UTILITY

- 5.1. CONTRACTOR SHALL CONTACT THE FOLLOWING, NOT ALL-INCLUSIVE LIST, AT LEAST THREE (3) WORKING DAYS PRIOR TO THE START OF CONSTRUCTION AROUND THEIR RESPECTIVE UTILITIES AND THE CONTRACTOR SHALL COORDINATE WITH UTILITY OWNERS REGARDING ANY NECESSARY UTILITY ADJUSTMENTS:

DEPARTMENT NAME	CONTACT	PHONE NUMBER	DEPARTMENT NAME	CONTACT	PHONE NUMBER
EXXON MOBILE PIPELINE	BRANDON GRAVES	225-268-0483	AT&T DISTRIBUTION	ERIN FRANCE	225-367-0678
VERIZON	JOHN CRUZ	845-608-1424	BATON ROUGE WATER CO.	TREY SAVOIE	225-231-0319
UNITY FIBER	COLBY MATHIERNE	225-445-2875	LUMEN (FORMERLY CENTURY LINK)	FRED WILKES	225-454-9519
EXXON MOBILE R&S (FORMERLY EATEL)	CHARLE BROWN JR	225-877-7618	EDR CITY PARISH SEWER	ADAM SMITH	225-389-4865
REV	BOYD BOURQUE	225-621-4255			
COX	NICK HILLIARD	225-237-5106			
ENERGY GAS	CLINT MILLICAN	225-301-1684			
ENERGY ELECTRIC	JOSH CLAYTON	225-354-3060			

- 5.2. CONTRACTOR SHALL CONTACT LA ONE CALL, THE APPROPRIATE UTILITY COMPANY, THE CITY PARISH DEPARTMENT OF TRANSPORTATION AND DRAINAGE - TRAFFIC DIV. (338-2346) AND SANITARY SEWER DIV. (338-4845), PRIOR TO THE START OF CONSTRUCTION FOR CONFIRMATION OF EXISTING UTILITIES. LOCATION OF EXISTING UTILITIES HAS BEEN PREPARED FROM THE MOST RELIABLE INFORMATION AVAILABLE. THE CONTRACTOR SHALL BE RESPONSIBLE FOR VERIFYING THE LOCATION, SIZE, AND DEPTH OF ALL UTILITIES, PIPELINES AND STRUCTURES. THE CONTRACTOR SHALL BE LIABLE FOR ANY DAMAGES CAUSED BY FAILURE TO COMPLY.
- 5.3. THE CONTRACTOR SHALL IMMEDIATELY NOTIFY THE PROJECT ENGINEER IF EXISTING UNMARKED DRAINAGE STRUCTURES OR FACILITIES ARE UNCOVERED. THE PROJECT ENGINEER WILL DETERMINE WHETHER TO REMOVE, REPLACE AND/OR CONNECT THE FACILITY TO THE PROPOSED DRAINAGE SYSTEM. CONNECTION TO A PROPOSED ADJACENT MANHOLE SHALL BE MADE AT NO DIRECT PAY.

6. TRAFFIC CONTROL

- 6.1. CONTRACTOR SHALL PROVIDE A TEMPORARY TRAFFIC CONTROL PLAN PREPARED IN ACCORDANCE WITH SECTION 713 OF THE STANDARD SPECIFICATIONS FOR PROJECT ENGINEER'S APPROVAL PRIOR TO CLOSING ANY PORTION OF THE ROADWAY.
- 6.2. UNLESS SPECIFIED OTHERWISE, CONTRACTOR SHALL PERMANENTLY ADJUST OR RELOCATE EXISTING SIGNAGE, AS INDICATED ON THE PLANS, OUTSIDE THE LIMITS OF THE PROPOSED SIDEWALK AND WITHIN THE EXISTING RIGHT-OF-WAY, AT NO DIRECT PAY.
- 6.3. CONTRACTOR SHALL PROVIDE, ERECT, AND MAINTAIN ALL NECESSARY BARRICADES, SUITABLE LIGHTS AND DANGER SIGNALS AND SHALL TAKE ALL THE NECESSARY PRECAUTIONS FOR THE PROTECTION OF WORK AND SAFETY OF THE GENERAL PUBLIC. ALL SAFETY LIGHTING AND MARKING SHALL MEET OR EXCEED THE REQUIREMENTS AS DESCRIBED IN THE MANUAL ON UNIFORM TRAFFIC CONTROL DEVICES PUBLISHED BY THE FEDERAL HIGHWAY ADMINISTRATION.
- 6.4. ALL EXISTING TRAFFIC CONTROL DEVICES THAT ARE IN CONFLICT WITH THE CONSTRUCTION OR WORK TRAFFIC CONTROL PLAN SHALL BE RELOCATED BY THE CONTRACTOR. CONTRACTOR TO COORDINATE RELOCATION WITH THE CITY/PARISH.
- 6.5. ANY DAMAGE CAUSED BY THE CONTRACTOR'S WORK SHALL BE IMMEDIATELY REPORTED BY THE CONTRACTOR TO THE PROJECT ENGINEER. REPAIRS SHALL BE PERFORMED BY THE CONTRACTOR OR BY THE CITY-PARISH, AT THE DISCRETION OF THE CITY-PARISH TRAFFIC ENGINEER, WITH ALL ASSOCIATED COSTS BEING PAID BY THE CONTRACTOR.
- 6.6. **CONTRACTOR TO MAINTAIN BOTH VEHICULAR AND PEDESTRIAN ACCESS TO BUSINESSES ON BOTH EAST AND WEST SIDES OF SCENIC HIGHWAY DURING ALL PHASES OF CONSTRUCTION.**
- 6.7. **ANY EXISTING PEDESTRIAN FACILITY SHALL NOT BE CLOSED FOR CONSTRUCTION WITHOUT AN ALTERNATE PATH. ON-SITE WORK ZONE ACCOMMODATION, OR DETOUR OPEN THROUGHOUT ALL PHASES OF CONSTRUCTION.**
- 6.8. **THE COST OF TEMPORARY CURB RAMPS, SIDEWALK MATS, SIDEWALK DEVICES, AND OTHER ITEMS RELATING TO TEMPORARY PEDESTRIAN DETOURS TO BE PAID FOR UNDER PAY ITEM NO. 713-01-00100.**

SHEET NUMBER		3
PROJECT NAME		EAST BATON ROUGE PARISH
JOB NO.		20-IN-HC-0008
DESIGNED BY	DATE	11/27/2023
CHECKED BY	DATE	
NOTED BY	DATE	
APPROVED BY	DATE	
GENERAL NOTES		
SCENIC HWY. - HARDING BLVD. TO SWAN AVE.		
DATE: 12/05/2023		

2

DOTD ITEM NO.	ITEM	UNIT	QUANTITY
736-01-00100	TRENCHING AND BACKFILLING	LF	1695
736-03-00100	JACKING OR BORING	LF	3610
736-04-00001	SIGNAL POLE (PEDESTAL POLE)	EA	24
736-05-30000	SIGNAL HEADS (3 SECTION, 12 INCH LED LENS, R, Y, G)	FA	10
736-05-30002	SIGNAL HEADS (3 SECTION, 12 INCH OPTICALLY PROGRAMMED LENS, R, Y, G)	EA	4
736-05-30004	SIGNAL HEADS (3 SECTION, 12 INCH LED LENS, R, R, Y)	EA	6
736-05-31001	SIGNAL HEADS (3 SEC, 12 INCH LED LENS, LT, R, LT, Y, LT, G)	EA	3
736-05-31200	SIGNAL HEADS (3 SEC, 12 INCH LED LENS, LT, R, LT, Y, LT, Y)	EA	1
736-05-35001	SIGNAL HEADS (3 SEC, 12 INCH LED LENS, RT, R, RT, Y, RT, G)	EA	3
736-05-55000	SIGNAL HEADS (5 SECTION, 12 INCH LED LENS, R, Y, RT, Y, G, RT, G)	EA	1
736-06-00300	SIGNAL SERVICE WITH SEPARATE DISCONNECT FOR STREET LIGHTS	FA	2
736-06-00500	SIGNAL SERVICE PEDESTAL DISCONNECT	EA	2
736-08-00102	SIGNAL CONTROLLER (980 ATC, TYPE 2)(FURNISH & INSTALL)	EA	1
736-10-00200	UNDERGROUND JUNCTION BOX (TYPE E)	EA	4
736-10-00300	UNDERGROUND JUNCTION BOX (TYPE F)	EA	30
736-10-00400	UNDERGROUND JUNCTION BOX (TYPE G)	EA	2
736-10-00600	UNDERGROUND JUNCTION BOX (TYPE I)	EA	1
736-10-00700	UNDERGROUND JUNCTION BOX (TYPE J)	EA	1
736-11-00200	CONDUIT (2" HDPE, SCHEDULE 80)	LF	1940
736-11-00300	CONDUIT (3" HDPE, SCHEDULE 80)	LF	6980
736-12-02300	CONDUCTOR (20, #6 AWG)	LF	1965
736-12-02014	CONDUCTOR (20, #14 AWG)	LF	10760
736-12-03000	CONDUCTOR (30, 6 GAUGE / #6 AWG)	LF	600
736-12-03014	CONDUCTOR (30, #14 AWG)	LF	2145
736-12-06014	CONDUCTOR (60, #14 AWG)	LF	11635
736-12-10014	CONDUCTOR (100, #14 AWG)	LF	9785
736-15-02400	SIGNAL SUPPORT (FOUNDATION, 24 INCH MINIMUM DIAMETER)	EA	26
736-17-00000	VIDEO DETECTION CABINET COMPONENTS	EA	2
736-21-00000	LED PEDESTRIAN COUNTDOWN SIGNAL HEAD	EA	24
736-23-00000	LED BLANK OUT SIGN	EA	2
740-01-00100	CONSTRUCTION LAYOUT	LS	1
NS-500-00300	TRAFFIC MAINTENANCE ASPHALT CONCRETE	TON	60
NS-500-00340	SAW CUTTING ASPHALT CONCRETE PAVEMENT	INLF	3545
NS-500-00360	SAW CUTTING ASPHALT CONC. PAVEMENT OVER PORTLAND CEMENT CONCRETE PAVEMENT	INLF	3,732
NS-736-00130	TS-2 TRAFFIC SIGNAL CABINET (GROUND MOUNTED)	EA	1
NS-736-00135	BATTERY BACK-UP SYSTEM FOR TRAFFIC SIGNALS	EA	3
NS-736-00136	2-WIRE ACCESSIBLE PEDESTRIAN PUSHBUTTON DETECTORS	EA	24
NS-736-00136	2-WIRE ACCESSIBLE PEDESTRIAN PUSHBUTTON CABINET CONTROL	EA	3
NS-ITS-01121	CCTV CAMERA ASSEMBLY, FURNISH AND INSTALL WITH PTZ, DIGITAL	EA	2
NS-ITS-04000	FIBER OPTIC MARKER	EA	2
NS-ITS-04035	FIBER OPTIC FAN CUT KITS, SM, 12 STRAND, FURNISH & INSTALL	EA	2
NS-ITS-04180	FIBER OPTIC CONNECTION, INSTALL, SPUCE	EA	6
NS-ITS-04200	FIBER OPTIC CONNECTION, TERMINATION, FURNISH & INSTALL	EA	24
NS-ITS-04250	FIBER OPTIC DROP CABLE, SM, 12 STRAND, FURNISH & INSTALL	LF	925
NS-ITS-04260	FIBER OPTIC PATCH CORD, SM, 2 STRAND, FURNISH & INSTALL	EA	4
NS-ITS-04425	FIBER OPTIC CONNECTION PATCH PANEL, OUTDOOR, FURNISH & INSTALL	EA	2

DATE: 01/18/2025
 DRAWN BY: J. J. J. J. J.
 CHECKED BY: J. J. J. J. J.
 12-45-2025

\\products\as - english - Swede Hay feeding to farm\SWANES\SWANS\ Swedehay_Summary of Estimated Questions.doc Feb 04, 2008 - 2:03pm

[illegible]

1. MINIMUM CONSTRUCTION SIGNING: ANY ADDITIONAL SIGNS SHOWN IN THE "MANUAL OF UNIFORM TRAFFIC CONTROL DEVICES" AND REQUIRED BY THE PROJECT ENGINEER SHALL BE INSTALLED AT NO ADDITIONAL COST TO THE DEPARTMENT.
2. FOR ADDITIONAL INFORMATION SEE LADOTD STANDARD PLANS TTC-00 (A THRU D) & TTC-10, 11, AND 16.
3. EROSION PROTECTION FOR THE PROPOSED DRAINAGE INLETS SHALL BE INSTALLED IMMEDIATELY AFTER THE NEW INLETS ARE IN PLACE.
4. TEMPORARY EROSION CONTROL MEASURES SHALL BE PLACED IN ACCORDANCE WITH LADOTD STANDARD PLAN EC-01.
5. THE CONTRACTOR SHALL BE RESPONSIBLE FOR MAINTAINING POSITIVE DRAINAGE DURING CONSTRUCTION.
6. CONTRACTOR SHALL COORDINATE ROADWAY WORK WITH UTILITY RELOCATION WORK AND OTHER CONSTRUCTION ACTIVITIES.
7. CONTRACTOR TO MAINTAIN BOTH VEHICULAR AND PEDESTRIAN ACCESS TO BUSINESSES ON BOTH EAST AND WEST SIDES OF SCENIC HIGHWAY DURING ALL PHASES OF CONSTRUCTION.
8. TEMPORARY CURB RAMPS, SIDEWALK MATS, SIDEWALK DEVICES, AND OTHER ITEMS RELATING TO TEMPORARY PEDESTRIAN DETOURS TO BE PAID FOR UNDER PAY ITEM NO. 713-01-00100.

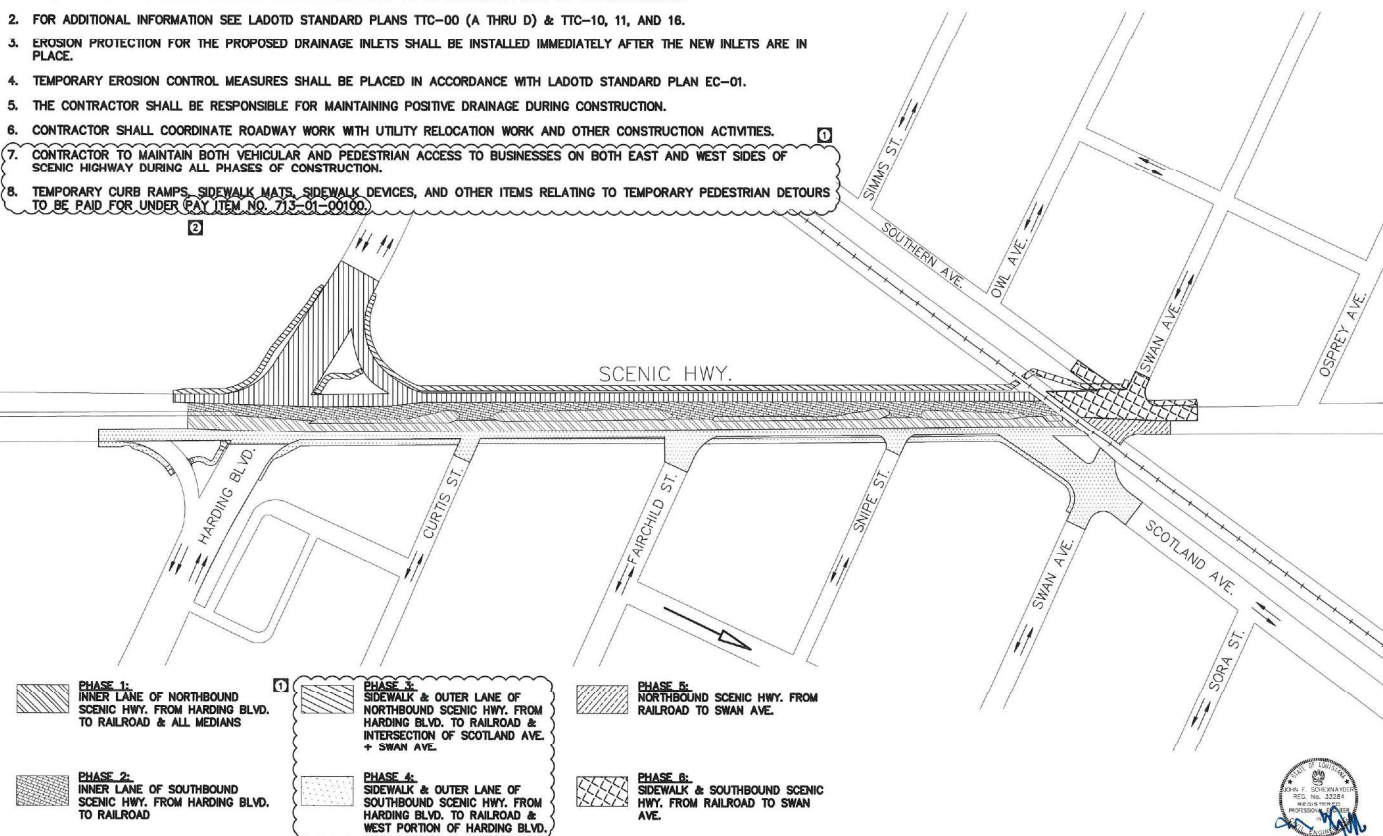

NOTE: WORK TO BE RESTRICTED BETWEEN SNIPE ST. AND SWAN AVE. FOR THE DURATION OF RAILROAD CONSTRUCTION.

 GOTTSCHALK, INC. 10000 W. 10th Ave., Suite 100 Denver, CO 80202 Phone: (303) 750-1000 Fax: (303) 750-1001 Email: info@gottschalk.com	TRAFFIC & CONSTRUCTION SIGNING		 Mowbray 10000 W. 10th Ave., Suite 100 Denver, CO 80202 Phone: (303) 750-1000 Fax: (303) 750-1001 Email: info@mowbray.com		EAST BYTON ROUTE PHASE- 20-10-1C-006		SHEET NUMBER 13
	SCENE HWY. - HARDING BLVD. TO SWAN AVE.		01 02/09/2023 02 02/09/2023 03 02/09/2023 04 02/09/2023 05 02/09/2023 06 02/09/2023 07 02/09/2023 08 02/09/2023 09 02/09/2023 10 02/09/2023 11 02/09/2023 12 02/09/2023 13 02/09/2023 14 02/09/2023 15 02/09/2023 16 02/09/2023 17 02/09/2023 18 02/09/2023 19 02/09/2023 20 02/09/2023 21 02/09/2023 22 02/09/2023 23 02/09/2023 24 02/09/2023 25 02/09/2023 26 02/09/2023 27 02/09/2023 28 02/09/2023 29 02/09/2023 30 02/09/2023 31 02/09/2023 32 02/09/2023 33 02/09/2023 34 02/09/2023 35 02/09/2023 36 02/09/2023 37 02/09/2023 38 02/09/2023 39 02/09/2023 40 02/09/2023 41 02/09/2023 42 02/09/2023 43 02/09/2023 44 02/09/2023 45 02/09/2023 46 02/09/2023 47 02/09/2023 48 02/09/2023 49 02/09/2023 50 02/09/2023 51 02/09/2023 52 02/09/2023 53 02/09/2023 54 02/09/2023 55 02/09/2023 56 02/09/2023 57 02/09/2023 58 02/09/2023 59 02/09/2023 60 02/09/2023 61 02/09/2023 62 02/09/2023 63 02/09/2023 64 02/09/2023 65 02/09/2023 66 02/09/2023 67 02/09/2023 68 02/09/2023 69 02/09/2023 70 02/09/2023 71 02/09/2023 72 02/09/2023 73 02/09/2023 74 02/09/2023 75 02/09/2023 76 02/09/2023 77 02/09/2023 78 02/09/2023 79 02/09/2023 80 02/09/2023 81 02/09/2023 82 02/09/2023 83 02/09/2023 84 02/09/2023 85 02/09/2023 86 02/09/2023 87 02/09/2023 88 02/09/2023 89 02/09/2023 90 02/09/2023 91 02/09/2023 92 02/09/2023 93 02/09/2023 94 02/09/2023 95 02/09/2023 96 02/09/2023 97 02/09/2023 98 02/09/2023 99 02/09/2023 100 02/09/2023 101 02/09/2023 102 02/09/2023 103 02/09/2023 104 02/09/2023 105 02/09/2023 106 02/09/2023 107 02/09/2023 108 02/09/2023 109 02/09/2023 110 02/09/2023 111 02/09/2023 112 02/09/2023 113 02/09/2023 114 02/09/2023 115 02/09/2023 116 02/09/2023 117 02/09/2023 118 02/09/2023 119 02/09/2023 120 02/09/2023 121 02/09/2023 122 02/09/2023 123 02/09/2023 124 02/09/2023 125 02/09/2023 126 02/09/2023 127 02/09/2023 128 02/09/2023 129 02/09/2023 130 02/09/2023 131 02/09/2023 132 02/09/2023 133 02/09/2023 134 02/09/2023 135 02/09/2023 136 02/09/2023 137 02/09/2023 138 02/09/2023 139 02/09/2023 140 02/09/2023 141 02/09/2023 142 02/09/2023 143 02/09/2023 144 02/09/2023 145 02/09/2023 146 02/09/2023 147 02/09/2023 148 02/09/2023 149 02/09/2023 150 02/09/2023 151 02/09/2023 152 02/09/2023 153 02/09/2023 154 02/09/2023 155 02/09/2023 156 02/09/2023 157 02/09/2023 158 02/09/2023 159 02/09/2023 160 02/09/2023 161 02/09/2023 162 02/09/2023 163 02/09/2023 164 02/09/2023 165 02/09/2023 166 02/09/2023 167 02/09/2023 168 02/09/2023 169 02/09/2023 170 02/09/2023 171 02/09/2023 172 02/09/2023 173 02/09/2023 174 02/09/2023 175 02/09/2023 176 02/09/2023 177 02/09/2023 178 02/09/2023 179 02/09/2023 180 02/09/2023 181 02/09/2023 182 02/09/2023 183 02/09/2023 184 02/09/2023 185 02/09/2023 186 02/09/2023 187 02/09/2023 188 02/09/2023 189 02/09/2023 190 02/09/2023 191 02/09/2023 192 02/09/2023 193 02/09/2023 194 02/09/2023 195 02/09/2023 196 02/09/2023 197 02/09/2023 198 02/09/2023 199 02/09/2023 200 02/0				

100% FINAL

CONTRACTOR WILL BE REQUIRED TO PROVIDE A COST BREAKDOWN OF LUMP SUM PAY ITEM TRAFFIC SIGNAL SYSTEM SUB PAY ITEMS UPON AWARD OF CONTRACT TO BE USED FOR MONTHLY PAYMENT PURPOSES. THE BREAKDOWN WILL INCLUDE SUB-ITEM QUANTITIES AND UNIT PRICES WHICH IN SUM WILL TOTAL THE LUMP SUM COST.



[illegible]

TRAFFIC SIGNAL INVENTORY (v3.2)										TSI NO. 17-126	
LOUISIANA DEPARTMENT OF TRANSPORTATION AND DEVELOPMENT										PAGE 3 OF 8	
Intersection: US 61 Business (Scenic Hwy) @ LA 408 (Harding Blvd)											
Phasing Parameters											
Phase Mode	Force Off	Phase #	1	2	3	4	5	6	7	8	
STDS	Float	Movement									
PARAMETER		RANGE(sec)									
MIN GREEN (MIN I)	0 - 99	5.0	10.0	5.0	10.0	5.0	10.0	5.0	10.0		
GAP EXTENSION	0 - 10	1.5	4.3	1.5	3.5	1.5	4.3	1.5	3.5		
MAX GREEN I (MAX I)	0 - 255	30.0	45.0	20.0	35.0	30.0	45.0	10.0	35.0		
MAX GREEN II (MAX II)	0 - 255	30.0	45.0	20.0	35.0	30.0	45.0	20.0	35.0		
YELLOW CLEARANCE (YEL)	3 - 7	5.0	5.0	5.0	5.0	5.0	5.0	5.0	5.0		
RED CLEARANCE (RED)	1 - 4	1.5	1.5	1.3	1.3	1.5	1.5	1.3	1.3		
WALK (WALK)	0 - 100		7		7		7		7		
RED CLEARANCE (P CLR)	0 - 100		20		17		20		17		
ADDED INITIAL GREEN	0 - 10		2.8		2.8		2.8		2.8		
MAXIMUM INITIAL	0 - 255										
TIME BEFORE REDUCTION	0 - 255		20.0		15.0		20.0		15.0		
TIME TO REDUCE	0 - 255		10.0		10.0		10.0		10.0		
REDUCE BY	0 - 99										
MINIMUM GAP	0 - 10		2.0		2.0		2.0		2.0		
DYNAMIC MAX LIMIT	0 - 255										
DYNAMIC MAX STEP	0 - 25										
RECALL	MIN/MAX		MIN						MIN		
PEDESTRIAN CALL	ON/OFF										
LOOK CALLS	ON/OFF										
SOFT RECALLS	ON/OFF										
REST IN WALK	ON/OFF										
DUAL ENTRY	ON/OFF										
ADDITIONAL SIGNAL CONTROLLER SETTINGS											
TRAFFIC SIGNAL FREE OPERATION PHASING WHEN ALL PHASES ARE CALLED											
Ring 1	01	Thru	<G	<BY	<R	<FY	<BY	<R			6.7
	02	Thru				G	Y	R			6.7
	03	Thru				<G	<BY	<R	<FY	<BY	<R
	04	Thru							G	Y	R
Ring 2	05	Thru	DW	DW	DW	DW	DW	DW	DW	DW	17.12
	06	Thru	DW	DW	DW	DW	DW	DW	DW	DW	17.12
	07	Thru	DW	DW	DW	DW	DW	DW	DW	DW	17.12
	08	Thru	DW	DW	DW	DW	DW	DW	DW	DW	17.12
Ring 3	09	Thru	<G	<BY	<R	<FY	<BY	<R			2.3
	10	Thru				G	Y	R			2.3
	11	Thru	<G	<BY	<R	<FY	<BY	<R			2.3
	12	Thru				G	Y	R			2.3
Ring 4	13	Thru	DW	DW	DW	DW	DW	DW	DW	DW	14.21
	14	Thru	DW	DW	DW	DW	DW	DW	DW	DW	14.21
	15	Thru	DW	DW	DW	DW	DW	DW	DW	DW	14.21
	16	Thru	DW	DW	DW	DW	DW	DW	DW	DW	14.21
Ring 5	17	Thru	<G	<BY	<R	<FY	<BY	<R			15.16
	18	Thru				G	Y	R			15.16
	19	Thru	<G	<BY	<R	<FY	<BY	<R			15.16
	20	Thru				G	Y	R			15.16
Ring 6	21	Thru	DW	DW	DW	DW	DW	DW	DW	DW	4.1
	22	Thru	DW	DW	DW	DW	DW	DW	DW	DW	4.1
	23	Thru	DW	DW	DW	DW	DW	DW	DW	DW	4.1
	24	Thru	DW	DW	DW	DW	DW	DW	DW	DW	4.1
Ring 7	25	Thru	<G	<BY	<R	<FY	<BY	<R			4.1
	26	Thru				G	Y	R			4.1
	27	Thru	<G	<BY	<R	<FY	<BY	<R			4.1
	28	Thru				G	Y	R			4.1
Ring 8	29	Thru	DW	DW	DW	DW	DW	DW	DW	DW	4.1
	30	Thru	DW	DW	DW	DW	DW	DW	DW	DW	4.1
	31	Thru	DW	DW	DW	DW	DW	DW	DW	DW	4.1
	32	Thru	DW	DW	DW	DW	DW	DW	DW	DW	4.1
Ring 9	33	Thru	<G	<BY	<R	<FY	<BY	<R			4.1
	34	Thru				G	Y	R			4.1
	35	Thru	<G	<BY	<R	<FY	<BY	<R			4.1
	36	Thru				G	Y	R			4.1
Ring 10	37	Thru	DW	DW	DW	DW	DW	DW	DW	DW	4.1
	38	Thru	DW	DW	DW	DW	DW	DW	DW	DW	4.1
	39	Thru	DW	DW	DW	DW	DW	DW	DW	DW	4.1
	40	Thru	DW	DW	DW	DW	DW	DW	DW	DW	4.1
Ring 11	41	Thru	<G	<BY	<R	<FY	<BY	<R			4.1
	42	Thru				G	Y	R			4.1
	43	Thru	<G	<BY	<R	<FY	<BY	<R			4.1
	44	Thru				G	Y	R			4.1
Ring 12	45	Thru	DW	DW	DW	DW	DW	DW	DW	DW	4.1
	46	Thru	DW	DW	DW	DW	DW	DW	DW	DW	4.1
	47	Thru	DW	DW	DW	DW	DW	DW	DW	DW	4.1
	48	Thru	DW	DW	DW	DW	DW	DW	DW	DW	4.1
Ring 13	49	Thru	<G	<BY	<R	<FY	<BY	<R			4.1
	50	Thru				G	Y	R			4.1
	51	Thru	<G	<BY	<R	<FY	<BY	<R			4.1
	52	Thru				G	Y	R			4.1
Ring 14	53	Thru	DW	DW	DW	DW	DW	DW	DW	DW	4.1
	54	Thru	DW	DW	DW	DW	DW	DW	DW	DW	4.1
	55	Thru	DW	DW	DW	DW	DW	DW	DW	DW	4.1
	56	Thru	DW	DW	DW	DW	DW	DW	DW	DW	4.1
Ring 15	57	Thru	<G	<BY	<R	<FY	<BY	<R			4.1
	58	Thru				G	Y	R			4.1
	59	Thru	<G	<BY	<R	<FY	<BY	<R			4.1
	60	Thru				G	Y	R			4.1
Ring 16	61	Thru	DW	DW	DW	DW	DW	DW	DW	DW	4.1
	62	Thru	DW	DW	DW	DW	DW	DW	DW	DW	4.1
	63	Thru	DW	DW	DW	DW	DW	DW	DW	DW	4.1
	64	Thru	DW	DW	DW	DW	DW	DW	DW	DW	4.1
Ring 17	65	Thru	<G	<BY	<R	<FY	<BY	<R			4.1
	66	Thru				G	Y	R			4.1
	67	Thru	<G	<BY	<R	<FY	<BY	<R			4.1
	68	Thru				G	Y	R			4.1
Ring 18	69	Thru	DW	DW	DW	DW	DW	DW	DW	DW	4.1
	70	Thru	DW	DW	DW	DW	DW	DW	DW	DW	4.1
	71	Thru	DW	DW	DW	DW	DW	DW	DW	DW	4.1
	72	Thru	DW	DW	DW	DW	DW	DW	DW	DW	4.1
Ring 19	73	Thru	<G	<BY	<R	<FY	<BY	<R			4.1
	74	Thru				G	Y	R			4.1
	75	Thru	<G	<BY	<R	<FY	<BY	<R			4.1
	76	Thru				G	Y	R			4.1
Ring 20	77	Thru	DW	DW	DW	DW	DW	DW	DW	DW	4.1
	78	Thru	DW	DW	DW	DW	DW	DW	DW	DW	4.1
	79	Thru	DW	DW	DW	DW	DW	DW	DW	DW	4.1
	80	Thru	DW	DW	DW	DW	DW	DW	DW	DW	4.1
Ring 21	81	Thru	<G	<BY	<R	<FY	<BY	<R			4.1
	82	Thru				G	Y	R			4.1
	83	Thru	<G	<BY	<R	<FY	<BY	<R			4.1
	84	Thru				G	Y	R			4.1
Ring 22	85	Thru	DW	DW	DW	DW	DW	DW	DW	DW	4.1
	86	Thru	DW	DW	DW	DW	DW	DW	DW	DW	4.1
	87	Thru	DW	DW	DW	DW	DW	DW	DW	DW	4.1
	88	Thru	DW	DW	DW	DW	DW	DW	DW	DW	4.1
Ring 23	89	Thru	<G	<BY	<R	<FY	<BY	<R			4.1
	90	Thru				G	Y	R			4.1
	91	Thru	<G	<BY	<R	<FY	<BY	<R			4.1
	92	Thru				G	Y	R			4.1
Ring 24	93	Thru	DW	DW	DW	DW	DW	DW	DW	DW	4.1
	94	Thru	DW	DW	DW	DW	DW	DW	DW	DW	4.1
	95	Thru	DW	DW	DW	DW	DW	DW	DW	DW	4.1
	96	Thru	DW	DW	DW	DW	DW	DW	DW	DW	4.1
Ring 25	97	Thru	<G	<BY	<R	<FY	<BY	<R			4.1
	98	Thru				G	Y	R			4.1
	99	Thru	<G	<BY	<R	<FY	<BY	<R			4.1
	100	Thru				G	Y	R			4.1
Ring 26	101	Thru	DW	DW	DW	DW	DW	DW	DW	DW	4.1
	102	Thru	DW	DW	DW	DW	DW	DW	DW	DW	4.1
	103	Thru	DW	DW	DW	DW	DW	DW	DW	DW	4.1
	104	Thru	DW	DW	DW	DW	DW	DW	DW	DW	4.1
Ring 27	105	Thru	<G	<BY	<R	<FY	<BY	<R			4.1
	106	Thru				G	Y	R			4.1

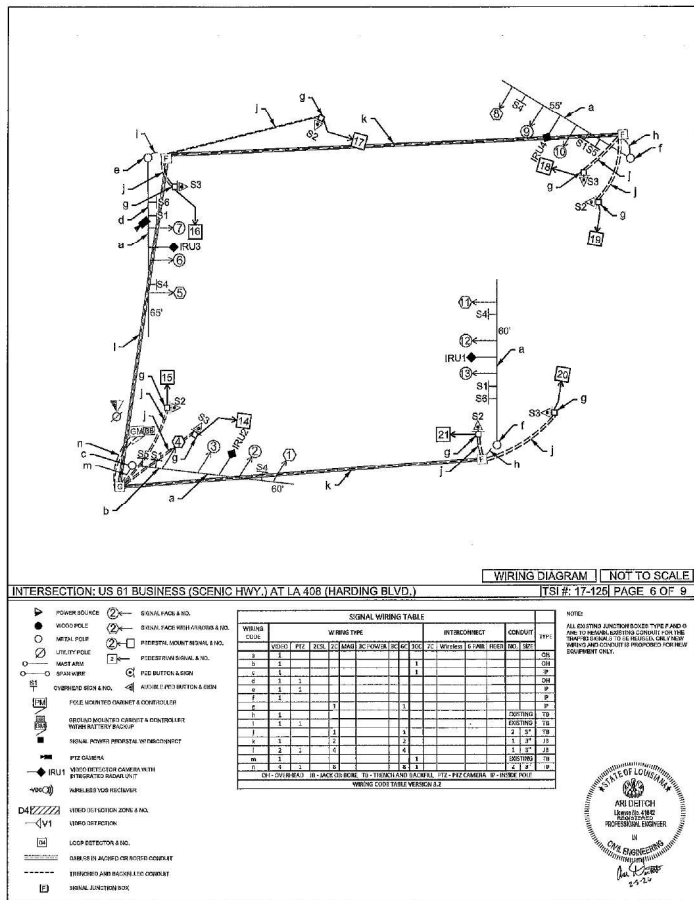
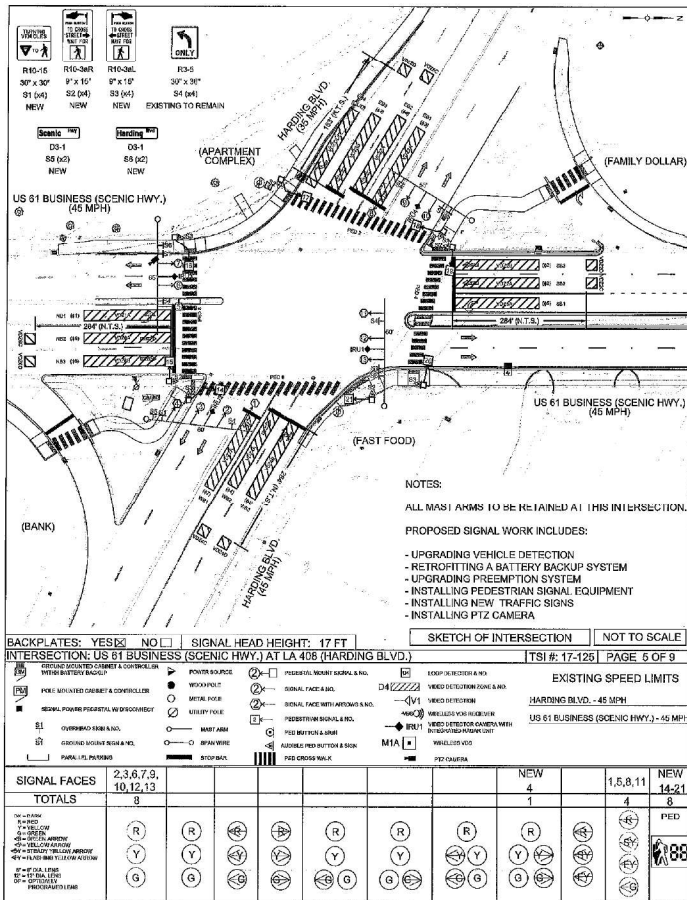

STAFF SIGNAL INVENTORY (v3.2)					TSI NO. 17-125	
LOUISIANA DEPARTMENT OF TRANSPORTATION AND DEVELOPMENT					PAGE: 7 OF 9	
Intersection:		US 61 Business (Scenic Hwy) @ LA 406 (Harding Blvd)				
[TRAFFIC VOLUMES - VPH]						
AM PEAK HOUR: <u>7:30:00 AM</u> to <u>8:30:00 AM</u>						
Count Date: <u>Design Year 2043</u> PHF: _____						
MIDDAY PEAK HOUR: _____ to _____						
Count Date: _____ PHF: _____						
PM PEAK HOUR: <u>2:30:00 PM</u> to <u>3:30:00 PM</u>						
Count Date: <u>Design Year 2043</u> PHF: _____						

Detector #	Delay (s)	Extend (s)	Phase	Equipment	Lane #	Size	Type
VDZ1A	3		01	Video	NB1	1-6x50	Stopbar
VDZ2A, VDZ2B			02	Video	SB2, SB3	2-6x50	Stopbar
VDZ2C, VDZ2D			02	Radar	SB2, SB3	2-6x6	Selback
VDZ3A	3		03	Video	EB1	1-6x50	Stopbar
VDZ4A, VDZ4B			04	Video	WB2, WB3	2-6x50	Stopbar
VDZ4C, VDZ4D			04	Radar	WB2, WB3	2-6x6	Selback
VDZ5A	3		05	Video	SB1	1-6x50	Stopbar
VDZ8A, VDZ8B			06	Video	NB2, NB3	2-6x50	Stopbar
VDZ8C, VDZ8D			06	Radar	NB2, NB3	2-6x6	Selback
VDZ7A	3		07	Video	WB1	1-6x50	Stopbar
VDZ7B, VDZ7B			08	Video	EB2, EB3	2-6x50	Stopbar
VDZ9C, VDZ8D			08	Radar	EB2, EB3	2-6x6	Selback
VDZ0LD			01 + 08	Video	EB4	1-6x50	Stopbar



- 3) TRAFFIC SIGNAL CONTROLLER AND CABINET SHALL BE RETAINED AT THIS INTERSECTION.
- 2) ALL OVERHEAD MAST ARMS SHALL BE RETAINED AT THIS INTERSECTION.
- 3) SIGNAL HEADS SHALL BE ADJUSTED AS NEEDED BASED ON PROPOSED LANE CONFIGURATION. SOME EXISTING SIGNAL HEADS MAY REQUIRE ADJUSTMENT BASED ON THE FINAL LANE CONFIGURATION.
- 4) FLASHING YELLOW ARROW (FYA) SHALL HAVE A 3 SECOND DELAY.
- 5) PROPOSED BATTERY BACKUP SHALL BE RETROFITTED TO EXISTING SIGNAL CABINET.
- 6) VEHICLE DETECTION IS BEING UPGRADED TO VIDEO AND RADAR DETECTION AS SHOWN ON THE PLANS. REMOVE ALL CABINET COMPONENTS AND EQUIPMENT FOR MAGNETOMETER DETECTION. SALVAGED EQUIPMENT SHALL BE RETURNED TO SECTION 45 AT 7696 TOW DRIVE, BATON ROUGE, LA 70806.
- 7) EXISTING CONDUIT BETWEEN EXISTING MAST ARMS AND NEAREST JUNCTION BOX MAY BE RETAINED AT THE DISCRETION OF THE PE AND DTCE. CONTRACTOR SHALL VERIFY THAT SUFFICIENT CAPACITY IS AVAILABLE PRIOR TO INSTALLATION OF WIRING
- 8) NEW PREEMPTION SYSTEM TO BE INSTALLED IN ACCORDANCE WITH PROJECT SPECIFICATIONS.
- 9) CONTRACTOR SHALL BE CERTIFIED BY THE RADAR MANUFACTURER IN THE INSTALLATION AND PROGRAMMING OF THE EQUIPMENT.
- 10) A MINIMUM OF ONE PERSON WITH A LEVEL I MSA CERTIFICATION IS REQUIRED ON SITE AT ALL TIMES FOR ALL WORK OUTSIDE OF A TRAFFIC SIGNAL CABINET.
- 11) A LEVEL II MSA CERTIFICATION IS REQUIRED FOR ALL WORK INSIDE A TRAFFIC SIGNAL CABINET.
- 12) ALL ACCESSIBLE PEDESTRIAN PUSHBUTTONS INSTALLED WITHIN 10 FEET OF EACH OTHER ARE TO USE AUDIBLE MESSAGES.
- 13) ACCESSIBLE PEDESTRIAN PUSHBUTTONS WITH AUDIBLE MESSAGES SHALL HAVE AUDIBLE MESSAGES THAT FOLLOW THE GUIDELINES BELOW:

FUNCTIONS	SPEECH MESSAGE / SOUND DETAILS
BUTTON PUSH ON PAV	WALK TO CROSS HARDING BLVD. AT US 61 BUSINESS (SCENIC HWY)
EXTENDED BUTTON PUSH	WALK TO CROSS HARDING BLVD AT US 61 BUSINESS (SCENIC HWY)
LOCATOR TONE	SLOW TONE
WALK PULSATION	HARDING BLVD; WALK LIGHT IS ON TO CROSS HARDING BLVD.
- * STREET NAMES SHOWN ARE FOR EXAMPLE ONLY. STREET NAMES IN AUDIBLE MESSAGES SHOULD MATCH WHAT IS LISTED ON THE TSI. ANY QUESTIONS ON NAMING CONVENTION SHALL BE GIVEN TO THE PE TO CONFIRM WITH THE DTCE.

SPEC	QTY	DESCRIPTION	UNITS	17-225
773-01-0000	1	Sign Type A/H/Fish and Inland	SOFT	56.5
736-01-00100		Tranching and Borefilling	LNFT	850.0
736-01-00100		backing or drilling	LNFT	400.0
736-04-00001		Signal Pole (Pedestrian Pole)	EACH	8
736-05-00100		Sign 14 Hx16, 1.5" Thick, 12" High and 14mm 1/2" x 1/2" x 5/8" G. Bt.	EACH	8
736-05-00100		Conduit 1" x 16mm, Set in 40'	LNFT	1215.0
736-12-00101		Conductor (2c #14 AWG)	LNFT	1500.0
736-12-00104		Conductor (2c #14 AWG)	LNFT	1790.0
736-12-00104		Conductor (10c #14 AWG)	LNFT	106.0
736-15-02400		Signal Support (Foundation, 24 inch Minimum Diameter)	EACH	8
736-15-03000		Video Detection Cabinet (Control Console)	EACH	8
736-15-03200		Integrated Radar Unit & Video Detection Camera (Sensor)	EACH	8
736-15-03204		Video Detection Cable	LNFT	1140.0
736-21-00000		LED Pedestrian Countdown Signal Head	EACH	8
NS-736-00134		Battery Backup System for Traffic Signals	EACH	1
NS-736-00139		2-Wire Accessible Pedestrian Pushbutton Detectors	EACH	8
NS-736-00139		2-Wire Accessible Pedestrian Pushbutton Detectors	EACH	8
NS-736-00139		NSP Based Traffic Signal Preemption System (MRA Existing Fiber Communication)	EACH	1
NS-736-00139		NSP Camera Assembly, Furnish and Install with PTZ, Digital	EACH	1
9061020		PTZ Camera	LNFT	250.0

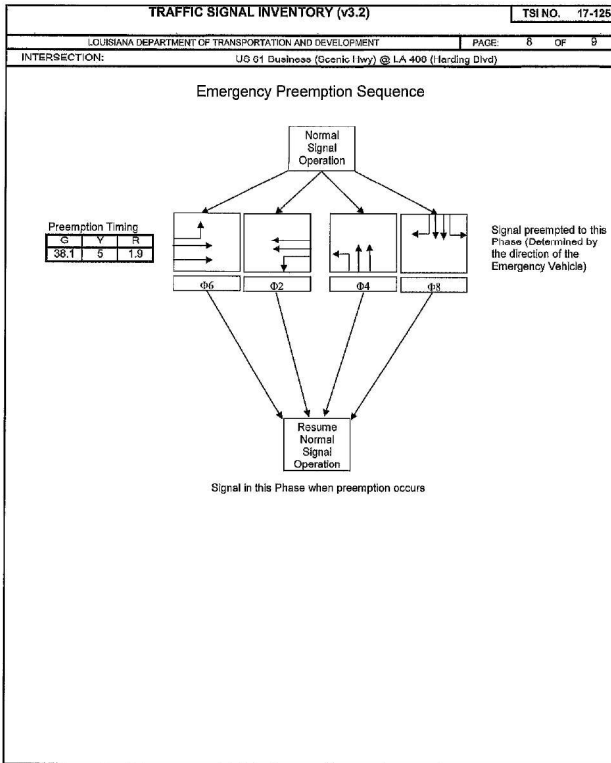

SHEET NO. 206	
PROJECT: EAST BAYOU BOULEVARD	DATE: 10/1/2018
DESIGNED BY: [Signature]	CHECKED BY: [Signature]
DATE: 10/1/2018	DATE: 10/1/2018
BY: [Signature]	BY: [Signature]
REVISIONS: 1. 10/1/2018, REVISED PLAN SHEET, REVISION 1.0	
MS&E	
TRAFFIC SIGNAL PLAN: SCENIC HWY AT LA 400 (HARDING BLVD.)	
SCENIC HIGHWAY (HARDING BLVD. TO SWAN AVE.)	
BR	ARCADIS

STATE OF LOUISIANA
 ARI DEITCH
 License No. 5192
 MECHANICAL ENGINEERING
 PROFESSIONAL ENGINEER
 IN
 CIVIL ENGINEERING
 12-24

[illegible]

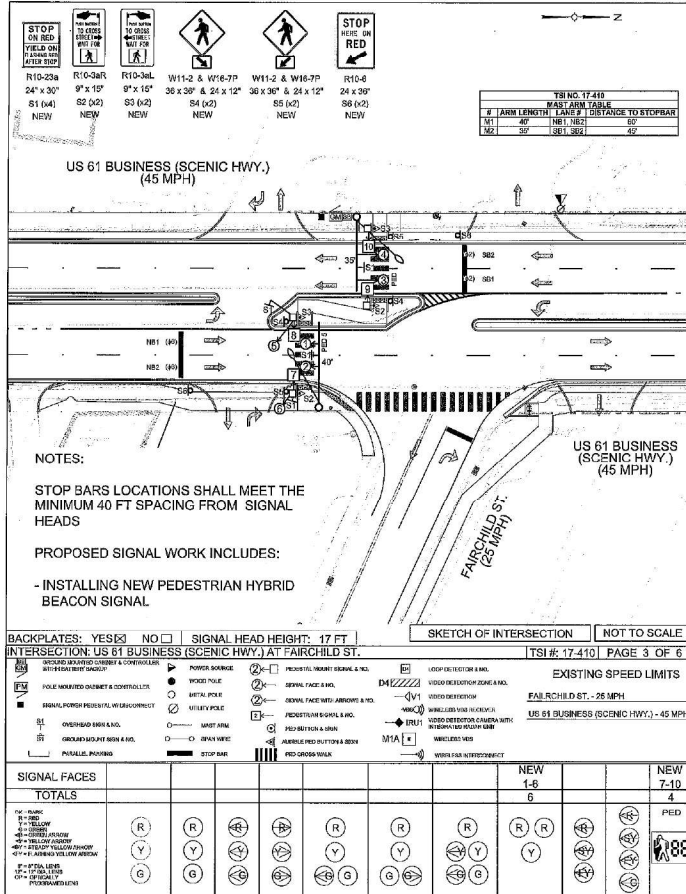



[illegible]

- 1) CONTRACTOR SHALL CONTACT SECTION 45 SIGNAL INSPECTORS AND SCHEDULE A BENCH TEST FOR THE FULLY FUNCTIONAL CABINET INCLUDING CONTROLLER AND MMU UNIT, AT THE SECTION 45 SIGNAL SHOP (7668 TOM DRIVE, DATON ROAD 70606) A MINIMUM OF 7 DAYS BEFORE SIGNAL ACTIVATION, APPROVED TO; PLAN SHALL BE PROVIDED IN THE SIGNAL CABINET, AT LEAST ONE TECHNICAL CONTRACTOR REP MAY BE REQUIRED TO BE PRESENT FOR THE BENCH TESTING.
- 2) CONTRACTOR TO PROVIDE CERTIFIED 980 ATC CONTROLLER.
SEE CERTIFICATION:
<https://www.deld.io.gov/media/pjzdy2lk/rf1lo-signal-controller-certification-2016.pdf>
- 3) A MINIMUM OF ONE PERSON WITH A LEVEL I MSA CERTIFICATION IS REQUIRED ON SITE AT ALL TIMES FOR ALL WORK OUTSIDE OF A TRAFFIC SIGNAL CABINET.
- 4) A LEVEL II MSA CERTIFICATION IS REQUIRED FOR ALL WORK INSIDE A TRAFFIC SIGNAL CABINET.
- 5) ALL ACCESSIBLE PEDESTRIAN PUSHBUTTONS INSTALLED WITHIN 10 FEET OF EACH OTHER ARE TO USE AUDIBLE MESSAGES.
- 6) ACCESSIBLE PEDESTRIAN PUSHBUTTONS WITH AUDIBLE MESSAGES SHALL HAVE AUDIBLE MESSAGES THAT FOLLOW THE GUIDELINES BELOW:

FUNCTIONS	SPEECH MESSAGE / SOUND DETAILS
* BUTTON PUSH ON DW	WAIT TO CROSS US 61 BUSINESS (SCENIC HWY* AT FAIRCHILD ST*)
* EXTENDED BUTTON PUSH LOCATOR TONE	WAIT TO CROSS US 61 BUSINESS (SCENIC HWY* AT FAIRCHILD ST*) SLOW TICK
* WALK INDICATION	US 61 BUSINESS (SCENIC HWY*), WALK LIGHT IS ON TO CROSS US 61 BUSINESS (SCENIC HWY*)

* STREET NAMES SHOWN ARE FOR EXAMPLE ONLY. STREET NAMES IN AUDIBLE MESSAGES SHOULD MATCH WHAT IS LISTED ON THE TSI. ANY QUESTIONS ON NAMING CONVENTION SHALL BE GIVEN TO THE PE TO CONFIRM WITH THE DTOE.

[illegible]

		TRITE SIGNAL PLANS SCENIC HWY AT FASCHOLD ST				GEORGE WA UNCLD 1A		EAST MAIN BRIDGE		2039	
CITY OF PEARCE 1000 S. 1ST ST. PEARCE, MT 59039		12/23/2020 UNCLD P.A.M. DIST. 12/23/2020 UNCLD P.A.M. DIST.		12/23/2020 UNCLD P.A.M. DIST. 12/23/2020 UNCLD P.A.M. DIST.		MA MA		CITY 20-10-K-1050		2039	
12/23/2020 UNCLD P.A.M. DIST. 12/23/2020 UNCLD P.A.M. DIST.		12/23/2020 UNCLD P.A.M. DIST. 12/23/2020 UNCLD P.A.M. DIST.		12/23/2020 UNCLD P.A.M. DIST. 12/23/2020 UNCLD P.A.M. DIST.		MA MA		CITY 20-10-K-1050		2039	
12/23/2020 UNCLD P.A.M. DIST. 12/23/2020 UNCLD P.A.M. DIST.		12/23/2020 UNCLD P.A.M. DIST. 12/23/2020 UNCLD P.A.M. DIST.		12/23/2020 UNCLD P.A.M. DIST. 12/23/2020 UNCLD P.A.M. DIST.		MA MA		CITY 20-10-K-1050		2039	

[illegible]

- NOTES:
- OVERLAP B CANNOT RUN WITH PHASE 8
 - OVERLAP C CAN RUN WITH PHASE 6, BUT CANNOT RUN WITH PHASE 11 AND PHASE 12
 - OVERLAP D CANNOT RUN WITH PHASE 6



TRAFFIC SIGNAL INVENTORY (v3.2)															TS# NO. 5-112					
LOUISIANA DEPARTMENT OF TRANSPORTATION AND DEVELOPMENT															PAGE 2 OF 12					
INTERSECTION:		US 61 Business (Scenic Hwy) @ LA 18 / Swan Ave													CYCL SEC:		TWR#1		LOGMILE:	
		PARISH: East Baton Rouge													LAI: 30.83663		LONE: 91.8809		4.724	
SIGNAL TYPE:		Baton Rouge			Volume Density			INTERSECTION TYPE:			Fiber			REV. DATE:		8/5/2024		INSTALL DATE:		
MAINTAINED BY:		MAINTAINED BY:			COTD			COTM MANUF:			BY:			17-416, 17-123		Corvette 09				
MAINTAINED BY:		DOTD			CORONATED WITH TS# 176:															
TRAFFIC SIGNAL COORDINATION PLANS (PHASING MAY VARY FROM FREE OPERATION)																				
Phase Run	01	Thru	G	G	G	G	G	G	Y	R									20.21	
	02	Thru	G	G	G	G	G	G	Y	R									20.21	
	03	FEU4	DW	DW	DW	DW	DW	DW	DW	DW	WA	DW	DW	DW	DW	DW	DW	DW	20.21	
	04	Thru	G	G	Y	R													7.8	
	05	Thru	G	G	Y	R													1.2	
	06	FEU4	WA	FDW	DW	DW	DW	DW	DW	DW	DW	WA	DW	DW	DW	DW	WA	WA	WA	22.23
	07	FEU3	WA	FDW	DW	DW	DW	DW	DW	DW	WA	WA	WA	WA	WA	WA	WA	DW	21.25	
	08	Thru	G	G	Y	R													8.13	
	09	Thru	G	G	Y	R													1.0	
	Phase Run	10	FEU3	DW	DW	DW	DW	DW	DW	DW	DW	DW	DW	DW	DW	DW	WA	FDW	DW	28.27
11		FEU3	DW	DW	DW	DW	DW	DW	DW	DW	DW	DW	DW	DW	DW	WA	FDW	DW	28.27	
12		0L6	G	G	Y	R													3.4	
13		0L6	G	G	Y	R													16.17	
14		0L6	G	G	Y	R													14.15	
15		0L6	G	G	Y	R													5.6	
16		0L6	G	G	Y	R													11.12	
17		FEU4	WA	WA	WA	WA	WA	WA	WA	WA	WA	FDW	DW	DW	DW	DW	DW	DW	11.12	
18		FEU4	WA	WA	WA	WA	WA	WA	WA	WA	WA	FDW	DW	DW	DW	DW	DW	DW	11.12	
Inf. Tm		Phasing		01 - 06		07 - 08 + 09		PED4 - 03 + 09		01 - 04 + 010		02 - 03 - PED11						Signal Heads		
Coord. #		02		02		02		02		02		02						Offset = 101 sec		
Max. Cycle		3		3		3		3		3		3								
Permit/Spill		3		3		3		3		3		3								
Action		3		3		3		3		3		3								
Times of Operation		Mon - Fri		Mon - Fri		Mon - Fri		Mon - Fri		Mon - Fri		Mon - Fri						Cycle Length: 134		
Notes:																				

- NOTES:
- OVERLAP B CANNOT RUN WITH PHASE 6
 - OVERLAP C CAN RUN WITH PHASE 6, BUT CANNOT RUN WITH PHASE 11 AND PHASE 12
 - OVERLAP D CANNOT RUN WITH PHASE 6

NOTES:

- OVERLAP B CANNOT RUN WITH PHASE 8
- OVERLAP C CAN RUN WITH PHASE 6, BUT CANNOT RUN WITH PHASE 11 AND PHASE 12
- OVERLAP D CANNOT RUN WITH PHASE 8

NOTES:

- OVERLAP B CANNOT RUN WITH PHASE 8
- OVERLAP C CAN RUN WITH PHASE 8, BUT CANNOT RUN WITH PHASE 11 AND PHASE 12
- OVERLAP D CANNOT RUN WITH PHASE 6



SIGNAL WIRING TABLE																
WIRING CODE	WIRING TYPE										INTERFACE				CONCAT	TYPE
	VIDEO	BU	PZT	SCD	25%	25%	CMG	SC PRGRSS	NC	CE	DC	25%	25%	25%		
A															CH	
B															CH	
C			1							1					CH	
D											1				CH	
E												1			CH	
F				1									2		CH	
G				1										2	CH	
H													1	2	CH	
I															CH	
J															CH	
K															CH	
L															CH	
M													2	1	CH	
N													1	1	CH	
O															CH	
P															CH	
Q															CH	
R															CH	
S															CH	
T															CH	
U															CH	
V															CH	
W															CH	
X															CH	
Y															CH	
Z															CH	
aa															CH	
bb															CH	
cc															CH	
dd															CH	
ee															CH	
ff															CH	
gg															CH	
hh															CH	
ii															CH	
jj															CH	
kk															CH	
ll															CH	
mm															CH	
nn															CH	
oo															CH	
pp															CH	
qq															CH	
rr															CH	
ss															CH	
tt															CH	
uu															CH	
vv															CH	
ww															CH	
xx															CH	
yy															CH	
zz															CH	
aaa															CH	
bbb															CH	
ccc															CH	
ddd															CH	
eee															CH	
fff															CH	
ggg															CH	
hhh															CH	
iii															CH	
jjj															CH	
kkk															CH	
lll															CH	
mmm															CH	
nnn															CH	
ooo															CH	
ppp															CH	
qqq															CH	
rrr															CH	
sss															CH	
ttt															CH	
uuu															CH	
vvv															CH	
www															CH	
xxx															CH	
yyy															CH	
zzz															CH	
aaa															CH	
bbb															CH	
ccc															CH	
ddd															CH	
eee															CH	
fff															CH	
ggg															CH	
hhh															CH	
iii															CH	
jjj															CH	
kkk															CH	
lll															CH	
mmm															CH	
nnn															CH	
ooo															CH	
ppp															CH	
qqq															CH	
rrr															CH	
sss															CH	
ttt															CH	
uuu															CH	
vvv															CH	
www															CH	
xxx															CH	
yyy															CH	
zzz															CH	
aaa															CH	
bbb															CH	
ccc															CH	
ddd															CH	
eee															CH	
fff															CH	
ggg															CH	
hhh															CH	
iii															CH	
jjj															CH	
kkk															CH	
lll															CH	
mmm															CH	
nnn															CH	
ooo															CH	
ppp															CH	
qqq															CH	
rrr															CH	
sss															CH	
ttt															CH	
uuu															CH	
vvv															CH	
www															CH	
xxx															CH	
yyy															CH	
zzz															CH	
aaa															CH	
bbb															CH	
ccc															CH	
ddd															CH	
eee															CH	
fff															CH	
ggg															CH	
hhh															CH	
iii															CH	
jjj															CH	
kkk											</					

NOTES:

- JUNCTION BOXES AND CONDUITS FOR LUMINAIRES SHALL BE SEPARATE FROM THOSE USED FOR SIGNAL EQUIPMENT.
- THE FINAL WIRING CONNECTION TO THE RAILROAD CABINET WILL BE PERFORMED BY THE RAILROAD COMPANY.

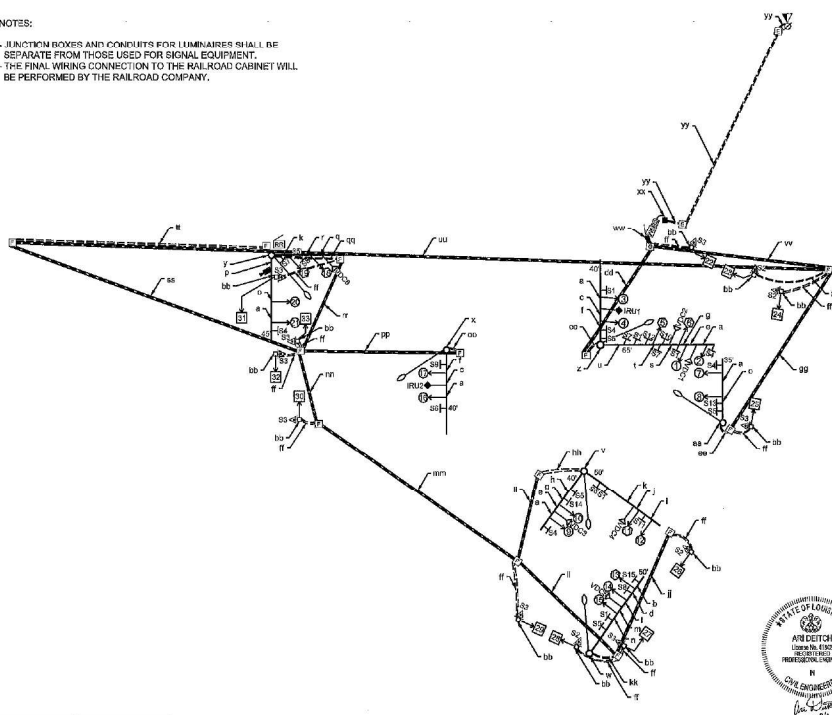

SKETCH OF INTERSECTION NOT TO SCALE

TSL#: S-112	PAGE 6 OF 12
-------------	--------------

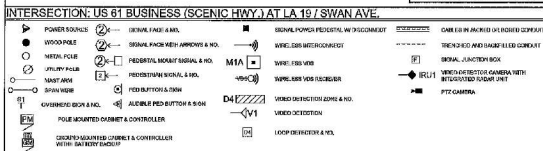

- JUNCTION BOXES AND CONDUITS FOR LUMINAIRES SHALL BE SEPARATE FROM THOSE USED FOR SIGNAL EQUIPMENT.
- THE FINAL WIRING CONNECTION TO THE RAILROAD CABINET WILL BE PERFORMED BY THE RAILROAD COMPANY.

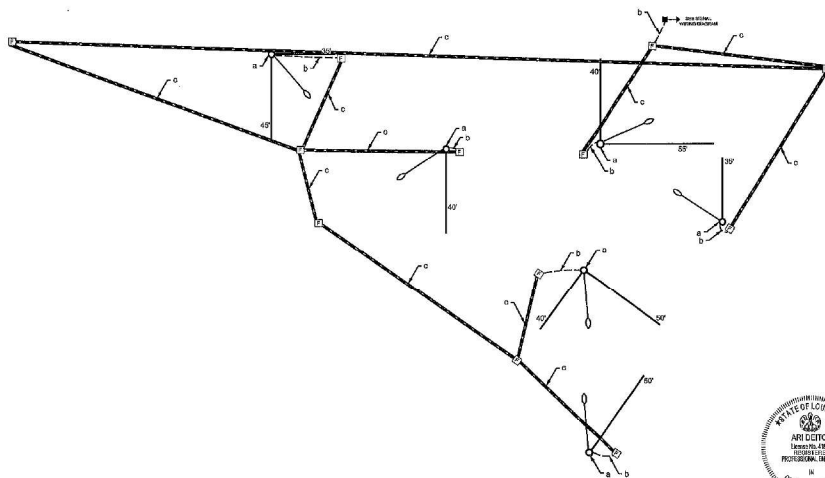

SKETCH OF INTERSECTION NOT TO SCALE

INTERSECTION: US 61 BUSINESS (SCENIC HWY.) AT LA 19 / SWAN AVE.

TSL#: S-112	PAGE 7 OF 12
-------------	--------------



TRAFFIC SIGNAL INVENTORY (v3.2)						TSI NO. 8-112																																																																																																	
LOUISIANA DEPARTMENT OF TRANSPORTATION AND DEVELOPMENT						PAGE: 8 OF 12																																																																																																	
Intersection: US 61 Business (Scenic Hwy) @ LA 19 / Swan Ave TRAFFIC VOLUMES - SCENIC HWY @ LA 19																																																																																																							
AM PEAK HOUR: 7:30:00 AM to 8:30:00 AM Count Date: Design Year 2043 PHF: _____																																																																																																							
MIDDAY PEAK HOUR: _____ to _____ Count Date: _____ PHF: _____																																																																																																							
PM PEAK HOUR: 2:30:00 PM to 3:30:00 PM Count Date: Design Year 2043 PHF: _____																																																																																																							
<table border="1" style="width: 100%; border-collapse: collapse;"> <thead> <tr> <th>Detector #</th> <th>Delay(s)</th> <th>Extend(s)</th> <th>Phase</th> <th>Equipment</th> <th>Face #</th> <th>Size</th> <th>Type</th> </tr> </thead> <tbody> <tr> <td>VDZOLB A, VDZOLB B</td> <td></td> <td></td> <td>02</td> <td>Video</td> <td>SB1, SB2</td> <td>2-0x50</td> <td>Stopbar</td> </tr> <tr> <td>VDZOLB C, VDZOLB D</td> <td></td> <td></td> <td>03</td> <td>Video</td> <td>SB1, SB2</td> <td>2-0x50</td> <td>Stopbar</td> </tr> <tr> <td>VDZ3</td> <td></td> <td></td> <td>05</td> <td>Video</td> <td>SB4</td> <td>1-0x50</td> <td>Stopbar</td> </tr> <tr> <td>VDZOLB A, VDZOLB B</td> <td></td> <td></td> <td>06</td> <td>Video</td> <td>NB1, NB2</td> <td>2-0x50</td> <td>Stopbar</td> </tr> <tr> <td>VDZOLB C, VDZOLB D</td> <td></td> <td></td> <td>06</td> <td>Video</td> <td>NB1, NB2</td> <td>2-0x50</td> <td>Stopbar</td> </tr> <tr> <td>VDZ3</td> <td></td> <td></td> <td>08</td> <td>Video</td> <td>WB2</td> <td>1-0x25</td> <td>Stopbar</td> </tr> <tr> <td>VDZ3</td> <td></td> <td></td> <td>09</td> <td>Video</td> <td>NB3</td> <td>1-0x50</td> <td>Stopbar</td> </tr> <tr> <td>VDZ10</td> <td></td> <td></td> <td>010</td> <td>Video</td> <td>SB3</td> <td>1-0x50</td> <td>Stopbar</td> </tr> <tr> <td>VDZOLC</td> <td></td> <td></td> <td>09</td> <td>Video</td> <td>NB4</td> <td>1-0x50</td> <td>Stopbar</td> </tr> <tr> <td>VDZOLD</td> <td></td> <td></td> <td>02</td> <td>Video</td> <td>EB1</td> <td>1-0x50</td> <td>Stopbar</td> </tr> <tr> <td>VDZOLE</td> <td></td> <td></td> <td>010</td> <td>Video</td> <td>WB1</td> <td>1-0x50</td> <td>Stopbar</td> </tr> </tbody> </table>								Detector #	Delay(s)	Extend(s)	Phase	Equipment	Face #	Size	Type	VDZOLB A, VDZOLB B			02	Video	SB1, SB2	2-0x50	Stopbar	VDZOLB C, VDZOLB D			03	Video	SB1, SB2	2-0x50	Stopbar	VDZ3			05	Video	SB4	1-0x50	Stopbar	VDZOLB A, VDZOLB B			06	Video	NB1, NB2	2-0x50	Stopbar	VDZOLB C, VDZOLB D			06	Video	NB1, NB2	2-0x50	Stopbar	VDZ3			08	Video	WB2	1-0x25	Stopbar	VDZ3			09	Video	NB3	1-0x50	Stopbar	VDZ10			010	Video	SB3	1-0x50	Stopbar	VDZOLC			09	Video	NB4	1-0x50	Stopbar	VDZOLD			02	Video	EB1	1-0x50	Stopbar	VDZOLE			010	Video	WB1	1-0x50	Stopbar
Detector #	Delay(s)	Extend(s)	Phase	Equipment	Face #	Size	Type																																																																																																
VDZOLB A, VDZOLB B			02	Video	SB1, SB2	2-0x50	Stopbar																																																																																																
VDZOLB C, VDZOLB D			03	Video	SB1, SB2	2-0x50	Stopbar																																																																																																
VDZ3			05	Video	SB4	1-0x50	Stopbar																																																																																																
VDZOLB A, VDZOLB B			06	Video	NB1, NB2	2-0x50	Stopbar																																																																																																
VDZOLB C, VDZOLB D			06	Video	NB1, NB2	2-0x50	Stopbar																																																																																																
VDZ3			08	Video	WB2	1-0x25	Stopbar																																																																																																
VDZ3			09	Video	NB3	1-0x50	Stopbar																																																																																																
VDZ10			010	Video	SB3	1-0x50	Stopbar																																																																																																
VDZOLC			09	Video	NB4	1-0x50	Stopbar																																																																																																
VDZOLD			02	Video	EB1	1-0x50	Stopbar																																																																																																
VDZOLE			010	Video	WB1	1-0x50	Stopbar																																																																																																

NOTES:

- OVERLAP B CANNOT RUN WITH PHASE 8
- OVERLAP C CAN RUN WITH PHASE 6, BUT CANNOT RUN WITH PHASE 11 AND PHASE 12
- OVERLAP D CANNOT RUN WITH PHASE 6

TRAFFIC SIGNAL INVENTORY (v3.2)						TSI NO. 8-112	
LOUISIANA DEPARTMENT OF TRANSPORTATION AND DEVELOPMENT						PAGE: 9 OF 12	
Intersection: US 61 Business (Scenic Hwy) @ LA 19 / Swan Ave TRAFFIC VOLUMES - LA 19 @ Swan Ave							
AM PEAK HOUR: 7:30:00 AM to 8:30:00 AM Count Date: Design Year 2043 PHF: _____							
PM PEAK HOUR: 2:30:00 PM to 3:30:00 PM Count Date: Design Year 2043 PHF: _____							
TRAFFIC VOLUMES - Scenic Hwy @ Swan Ave							
AM PEAK HOUR: 7:30:00 AM to 8:30:00 AM Count Date: Design Year 2043 PHF: _____							
PM PEAK HOUR: 2:30:00 PM to 3:30:00 PM Count Date: Design Year 2043 PHF: _____							



SHEET NUMBER: 214	
PROJECT: EAST BAY BRIDGE	DATE: 10-10-2023
DESIGNED BY: [Signature]	CHECKED BY: [Signature]
INVESTIGATED BY: [Signature]	APPROVED BY: [Signature]
TYPING SIGNAL PLANS SCENIC HWY AT LA 19 / SWAN AVE. SCENIC HIGHWAY (PARALLEL BLVD. TO SWAN AVE.)	

- 1) CONTRACTOR SHALL CONTACT SECTION 45 SIGNAL INSPECTORS AND SCHEDULE A BENCH TEST FOR THE FULLY FUNCTIONAL CABINET INCLUDING CONTROLLER AND MMU UNIT, AT THE SECTION 45 SIGNAL SHOP (769610M DRIVE, BATON ROUGE 70806) A MINIMUM OF 7 DAYS BEFORE SIGNAL ACTIVATION. APPROVED TSI PLAN SHALL BE PROVIDED IN THE SIGNAL CABINET. AT LEAST ONE TECHNICAL CONTRACTOR REP MAY BE REQUIRED TO BE PRESENT FOR THE BENCH TESTING.
- 2) CONTRACTOR TO PROVIDE CERTIFIED 980 ATC CONTROLLER.
SEE CERTIFICATION:
<https://www.ctrdt.in.gov/media/entry/26/traffic-signal-controller-certification-2018.pdf>
- 3) SIGNAL HEADS #3 AND #4 SHOULD HAVE A MINIMUM HEIGHT OF 19 FT FROM THE GROUND LEVEL TO HAVE AN ADEQUATE LINE OF SIGHT OF RAILROAD GATES.
- 4) SIGNAL HEADS #16 AND #17 SHOULD HAVE A MINIMUM HEIGHT OF 18.5 FT FROM THE GROUND LEVEL TO HAVE AN ADEQUATE LINE OF SIGHT OF RAILROAD GATES.
- 5) CONTRACTOR SHALL BE CERTIFIED BY THE RADAR MANUFACTURER IN THE INSTALLATION AND PROGRAMMING OF THE EQUIPMENT.
- 6) A MINIMUM OF ONE PERSON WITH A LEVEL 1 MSA CERTIFICATION IS REQUIRED ON SITE AT ALL TIMES FOR ALL WORK OUTSIDE OF A TRAFFIC SIGNAL CABINET.
- 7) A LEVEL 1 MSA CERTIFICATION IS REQUIRED FOR ALL WORK INSIDE A TRAFFIC SIGNAL CABINET.
- 8) ALL ACCESSIBLE PEDESTRIAN PUSHBUTTONS INSTALLED WITHIN 10 FEET OF EACH OTHER ARE TO USE AUDIBLE MESSAGES.
- 9) ACCESSIBLE PEDESTRIAN PUSHBUTTONS WITH AUDIBLE MESSAGES SHALL HAVE AUDIBLE MESSAGES THAT FOLLOW THE GUIDELINES BELOW:

FUNCTIONS	SPEECH MESSAGE / SOUND DETAILS
* BUTTON PUSH ON DW	WAIT TO CROSS SWAN AVE AT US 61 BUSINESS (SCENIC HWY)
* EXTENDED BUTTON PUSH	WAIT TO CROSS SWAN AVE AT US 61 BUSINESS (SCENIC HWY)
* LOCATOR TONE	SLOW TONE
* WALK INDICATION	SWAN AVE, WALK RIGHT AHEAD TO CROSS SWAN AVE

- * STREET NAMES SHOWN ARE FOR EXAMPLE ONLY. STREET NAMES IN AUDIBLE MESSAGES SHOULD MATCH WHAT IS LISTED ON THE TSI. ANY QUESTIONS ON NAMING CONVENTION SHALL BE GIVEN TO THE PE TO CONFIRM WITH THE DTCE.

SPEC.	NUMBER	DESCRIPTION	UNITS	5-112
725-01-07100		Sign (Type A) (Furnish and Install)	SOFT	196.0
736-01-00100		Trenching and Backfilling	UNIT	890.0
736-03-00100		Jacking or Bolting	UNIT	238.0
736-04-00001		Signal Pole (Pedestal Pole)	EACH	12
736-796-10350		Signal Support (West Arm Standard w/ 33 ft arm)	EACH	1
736-736-10400		Signal Support (West Arm Standard w/ 40 ft arm)	EACH	1
736-736-10450		Signal Support (West Arm Standard w/ 45 ft arm)	EACH	1
736-736-10500		Signal Support (West Arm Standard w/ 50 ft arm)	EACH	1
736-736-10550		Signal Support (West Arm Standard w/ 55 ft arm)	EACH	1
736-736-14350		Additional Mast Arm (35 ft arm)	EACH	1
736-736-14400		Additional Mast Arm (40 ft arm)	EACH	1
736-05-30000		Signal Heads (3 Section, 12 inch Lens, R, Y, G)	EACH	10
736-05-30002		Signal Heads (3 Section, 12 inch Optically Programmed Lens, R, Y, G)	EACH	4
736-05-31001		Signal Heads (3 Sec, 12 inch Lens, LT, R, LT, Y, LT, G)	EACH	3
736-05-31002		Signal Heads (3 Sec, 12 inch Lens, LT, R, LT, Y, LT, G)	EACH	1
736-05-31003		Signal Heads (3 Sec, 12 inch Lens, LT, R, LT, Y, LT, G)	EACH	3
736-00-00300		Signal Service with Separate Disconnector for Street Lights	EACH	1
736-00-00500		Signal Service Pedestal Disconnector	EACH	1
8000613		Signal Controller (ATC 32 Phase Shelf Mount (Furnish & Install))	EACH	1
8000614		Signal Controller (ATC 32 Phase Shelf Mount (Furnish))	EACH	1
736-10-30000		Underground Junction Box (Type E)	EACH	1
736-10-00300		Underground Junction Box (Type F)	EACH	25
736-10-00400		Underground Junction Box (Type G)	EACH	1
736-11-00000		Conductor (2" x 1/8" Schedule 80)	UNIT	890.0
736-11-00001		Conductor (2" x 1/8" Schedule 80)	UNIT	890.0
736-11-00002		Conductor (2" x 1/8" Schedule 80)	UNIT	890.0
736-11-00003		Conductor (2" x 1/8" Schedule 80)	UNIT	890.0
736-11-00004		Conductor (2" x 1/8" Schedule 80)	UNIT	890.0
736-11-00005		Conductor (2" x 1/8" Schedule 80)	UNIT	890.0
736-11-00006		Conductor (2" x 1/8" Schedule 80)	UNIT	890.0
736-11-00007		Conductor (2" x 1/8" Schedule 80)	UNIT	890.0
736-11-00008		Conductor (2" x 1/8" Schedule 80)	UNIT	890.0
736-11-00009		Conductor (2" x 1/8" Schedule 80)	UNIT	890.0
736-11-00010		Conductor (2" x 1/8" Schedule 80)	UNIT	890.0
736-11-00011		Conductor (2" x 1/8" Schedule 80)	UNIT	890.0
736-11-00012		Conductor (2" x 1/8" Schedule 80)	UNIT	890.0
736-11-00013		Conductor (2" x 1/8" Schedule 80)	UNIT	890.0
736-11-00014		Conductor (2" x 1/8" Schedule 80)	UNIT	890.0
736-11-00015		Conductor (2" x 1/8" Schedule 80)	UNIT	890.0
736-11-00016		Conductor (2" x 1/8" Schedule 80)	UNIT	890.0
736-11-00017		Conductor (2" x 1/8" Schedule 80)	UNIT	890.0
736-11-00018		Conductor (2" x 1/8" Schedule 80)	UNIT	890.0
736-11-00019		Conductor (2" x 1/8" Schedule 80)	UNIT	890.0
736-11-00020		Conductor (2" x 1/8" Schedule 80)	UNIT	890.0
736-11-00021		Conductor (2" x 1/8" Schedule 80)	UNIT	890.0
736-11-00022		Conductor (2" x 1/8" Schedule 80)	UNIT	890.0
736-11-00023		Conductor (2" x 1/8" Schedule 80)	UNIT	890.0
736-11-00024		Conductor (2" x 1/8" Schedule 80)	UNIT	890.0
736-11-00025		Conductor (2" x 1/8" Schedule 80)	UNIT	890.0
736-11-00026		Conductor (2" x 1/8" Schedule 80)	UNIT	890.0
736-11-00027		Conductor (2" x 1/8" Schedule 80)	UNIT	890.0
736-11-00028		Conductor (2" x 1/8" Schedule 80)	UNIT	890.0
736-11-00029		Conductor (2" x 1/8" Schedule 80)	UNIT	890.0
736-11-00030		Conductor (2" x 1/8" Schedule 80)	UNIT	890.0
736-11-00031		Conductor (2" x 1/8" Schedule 80)	UNIT	890.0
736-11-00032		Conductor (2" x 1/8" Schedule 80)	UNIT	890.0
736-11-00033		Conductor (2" x 1/8" Schedule 80)	UNIT	890.0
736-11-00034		Conductor (2" x 1/8" Schedule 80)	UNIT	890.0
736-11-00035		Conductor (2" x 1/8" Schedule 80)	UNIT	890.0
736-11-00036		Conductor (2" x 1/8" Schedule 80)	UNIT	890.0
736-11-00037		Conductor (2" x 1/8" Schedule 80)	UNIT	890.0
736-11-00038		Conductor (2" x 1/8" Schedule 80)	UNIT	890.0
736-11-00039		Conductor (2" x 1/8" Schedule 80)	UNIT	890.0
736-11-00040		Conductor (2" x 1/8" Schedule 80)	UNIT	890.0
736-11-00041		Conductor (2" x 1/8" Schedule 80)	UNIT	890.0
736-11-00042		Conductor (2" x 1/8" Schedule 80)	UNIT	890.0
736-11-00043		Conductor (2" x 1/8" Schedule 80)	UNIT	890.0
736-11-00044		Conductor (2" x 1/8" Schedule 80)	UNIT	890.0
736-11-00045		Conductor (2" x 1/8" Schedule 80)	UNIT	890.0
736-11-00046		Conductor (2" x 1/8" Schedule 80)	UNIT	890.0
736-11-00047		Conductor (2" x 1/8" Schedule 80)	UNIT	890.0
736-11-00048		Conductor (2" x 1/8" Schedule 80)	UNIT	890.0
736-11-00049		Conductor (2" x 1/8" Schedule 80)	UNIT	890.0
736-11-00050		Conductor (2" x 1/8" Schedule 80)	UNIT	890.0
736-11-00051		Conductor (2" x 1/8" Schedule 80)	UNIT	890.0
736-11-00052		Conductor (2" x 1/8" Schedule 80)	UNIT	890.0
736-11-00053		Conductor (2" x 1/8" Schedule 80)	UNIT	890.0
736-11-00054		Conductor (2" x 1/8" Schedule 80)	UNIT	890.0
736-11-00055		Conductor (2" x 1/8" Schedule 80)	UNIT	890.0
736-11-00056		Conductor (2" x 1/8" Schedule 80)	UNIT	890.0
736-11-00057		Conductor (2" x 1/8" Schedule 80)	UNIT	890.0
736-11-00058		Conductor (2" x 1/8" Schedule 80)	UNIT	890.0
736-11-00059		Conductor (2" x 1/8" Schedule 80)	UNIT	890.0
736-11-00060		Conductor (2" x 1/8" Schedule 80)	UNIT	890.0
736-11-00061		Conductor (2" x 1/8" Schedule 80)	UNIT	890.0
736-11-00062		Conductor (2" x 1/8" Schedule 80)	UNIT	890.0
736-11-00063		Conductor (2" x 1/8" Schedule 80)	UNIT	890.0
736-11-00064		Conductor (2" x 1/8" Schedule 80)	UNIT	890.0
736-11-00065		Conductor (2" x 1/8" Schedule 80)	UNIT	890.0
736-11-00066		Conductor (2" x 1/8" Schedule 80)	UNIT	890.0
736-11-00067		Conductor (2" x 1/8" Schedule 80)	UNIT	890.0
736-11-00068		Conductor (2" x 1/8" Schedule 80)	UNIT	890.0
736-11-00069		Conductor (2" x 1/8" Schedule 80)	UNIT	890.0
736-11-00070		Conductor (2" x 1/8" Schedule 80)	UNIT	890.0
736-11-00071		Conductor (2" x 1/8" Schedule 80)	UNIT	890.0
736-11-00072		Conductor (2" x 1/8" Schedule 80)	UNIT	890.0
736-11-00073		Conductor (2" x 1/8" Schedule 80)	UNIT	890.0
736-11-00074		Conductor (2" x 1/8" Schedule 80)	UNIT	890.0
736-11-00075		Conductor (2" x 1/8" Schedule 80)	UNIT	890.0
736-11-00076		Conductor (2" x 1/8" Schedule 80)	UNIT	890.0
736-11-00077		Conductor (2" x 1/8" Schedule 80)	UNIT	890.0
736-11-00078		Conductor (2" x 1/8" Schedule 80)	UNIT	890.0
736-11-00079		Conductor (2" x 1/8" Schedule 80)	UNIT	890.0
736-11-00080		Conductor (2" x 1/8" Schedule 80)	UNIT	890.0
736-11-00081		Conductor (2" x 1/8" Schedule 80)	UNIT	890.0
736-11-00082		Conductor (2" x 1/8" Schedule 80)	UNIT	890.0
736-11-00083		Conductor (2" x 1/8" Schedule 80)	UNIT	890.0
736-11-00084		Conductor (2" x 1/8" Schedule 80)	UNIT	890.0
736-11-00085		Conductor (2" x 1/8" Schedule 80)	UNIT	890.0
736-11-00086		Conductor (2" x 1/8" Schedule 80)	UNIT	890.0
736-11-00087		Conductor (2" x 1/8" Schedule 80)	UNIT	890.0
736-11-00088		Conductor (2" x 1/8" Schedule 80)	UNIT	890.0
736-11-00089		Conductor (2" x 1/8" Schedule 80)	UNIT	890.0
736-11-00090		Conductor (2" x 1/8" Schedule 80)	UNIT	890.0
736-11-00091		Conductor (2" x 1/8" Schedule 80)	UNIT	890.0
736-11-00092		Conductor (2" x 1/8" Schedule 80)	UNIT	890.0
736-11-00093		Conductor (2" x 1/8" Schedule 80)	UNIT	890.0
736-11-00094		Conductor (2" x 1/8" Schedule 80)	UNIT	890.0
736-11-00095		Conductor (2" x 1/8" Schedule 80)	UNIT	890.0
736-11-00096		Conductor (2" x 1/8" Schedule 80)	UNIT	890.0
736-11-00097		Conductor (2" x 1/8" Schedule 80)	UNIT	890.0
736-11-00098		Conductor (2" x 1/8" Schedule 80)	UNIT	890.0
736-11-00099		Conductor (2" x 1/8" Schedule 80)	UNIT	890.0
736-11-00100		Conductor (2" x 1/8" Schedule 80)	UNIT	890.0
736-11-00101		Conductor (2" x 1/8" Schedule 80)	UNIT	890.0
736-11-00102		Conductor (2" x 1/8" Schedule 80)	UNIT	890.0
736-11-00103		Conductor (2" x 1/8" Schedule 80)	UNIT	890.0
736-11-00104		Conductor (2" x 1/8" Schedule 80)	UNIT	890.0
736-11-00105		Conductor (2" x 1/8" Schedule 80)	UNIT	890.0
736-11-00106		Conductor (2" x 1/8" Schedule 80)	UNIT	890.0
736-11-00107		Conductor (2" x 1/8" Schedule 80)	UNIT	890.0
736-11-00108		Conductor (2" x 1/8" Schedule 80)	UNIT	890.0
736-11-00109		Conductor (2" x 1/8" Schedule 80)	UNIT	890.0
736-11-00110		Conductor (2" x 1/8" Schedule 80)	UNIT	890.0
736-11-00111		Conductor (2" x 1/8" Schedule 80)	UNIT	890.0
736-11-00112		Conductor (2" x 1/8" Schedule 80)	UNIT	890.0
736-11-00113		Conductor (2" x 1/8" Schedule 80)	UNIT	890.0
736-11-00114		Conductor (2" x 1/8" Schedule 80)	UNIT	890.0
736-11-00115		Conductor (2" x 1/8" Schedule 80)	UNIT	890.0
736-11-00116		Conductor (2" x 1/8" Schedule 80)	UNIT	890.0
736-11-00117		Conductor (2" x 1/8" Schedule 80)	UNIT	890.0
736-11-00118		Conductor (2" x 1/8" Schedule 80)	UNIT	890.0
736-11-00119		Conductor (2" x 1/8" Schedule 80)	UNIT	890.0
736-11-00120		Conductor (2" x 1/8" Schedule 80)	UNIT	890.0
736-11-00121		Conductor (2" x 1/8" Schedule 80)	UNIT	890.0
736-11-00122		Conductor (2" x 1/8" Schedule 80)	UNIT	890.0
736-11-00123		Conductor (2" x 1/8" Schedule 80)	UNIT	890.0
736-11-00124		Conductor (2" x 1/8" Schedule 80)	UNIT	890.0
736-11-00125		Conductor (2" x 1/8" Schedule 80)	UNIT	890.0
736-11-00126		Conductor (2" x 1/8" Schedule 80)	UNIT	890.0
736-11-00127		Conductor (2" x 1/8" Schedule 80)	UNIT	890.0
736-11-00128		Conductor (2" x 1/8" Schedule 80)	UNIT	890.0
736-11-00129		Conductor (2" x 1/8" Schedule 80)	UNIT	890.0
736-11-00130		Conductor (2" x 1/8" Schedule 80)	UNIT	890.0
736-11-00131		Conductor (2" x 1/8" Schedule 80)	UNIT	890.0
736-11-00132		Conductor (2" x 1/8" Schedule 80)	UNIT	890.0
736-11-00133		Conductor (2" x 1/8" Schedule 80)	UNIT	890.0
736-11-00134		Conductor (2" x 1/8" Schedule 80)	UNIT	890.0
736-11-00135		Conductor (2" x 1/8" Schedule 80)	UNIT	890.0
736-11-00136		Conductor (2" x 1/8" Schedule 80)	UNIT	890.0
736-11-00137		Conductor (2" x 1/8" Schedule 80)	UNIT	890.0
736-11-00138		Conductor (2" x 1/8" Schedule 80)	UNIT	890.0
736-11-00139		Conductor (2" x 1/8" Schedule 80)	UNIT	890.0
736-11-00140		Conductor (2" x 1/8" Schedule 80)	UNIT	890.0
736-11-00141		Conductor (2" x 1/8" Schedule 80)	UNIT	890.0
736-11-00142		Conductor (2" x 1/8" Schedule 80)	UNIT	890.0
736-11-00143		Conductor (2" x 1/8" Schedule 80)	UNIT	890.0
736-11-00144		Conductor (2" x 1/8" Schedule 80)	UNIT	890.0
736-11-00145		Conductor (2" x 1/8" Schedule 80)	UNIT	890.0
736-11-00146		Conductor (2" x 1/8" Schedule 80)	UNIT	890.0
736-11-00147		Conductor (2" x 1/8" Schedule 80)	UNIT	890.0
736-11-00148		Conductor (2" x 1/8" Schedule 80)	UNIT	890.0
736-11-00149		Conductor (2" x 1/8" Schedule 80)	UNIT	890.0
736-11-00150		Conductor (2" x 1/8" Schedule 80)	UNIT	890.0
736-11-00151		Conductor (2" x 1/8" Schedule 80)	UNIT	890.0
736-11-00152		Conductor (2" x 1/8" Schedule 80)	UNIT	890.0
736-11-00153		Conductor (2" x 1/8" Schedule 80)	UNIT	890.0
736-11-00154		Conductor (2" x 1/8" Schedule 80)	UNIT	890.0
736-11-00155		Conductor (2" x 1/8" Schedule 80)	UNIT	890.0
736-11-00156		Conductor (2" x 1/8" Schedule 80)	UNIT	890.0
736-11-00157		Conductor (2" x 1/8" Schedule 80)	UNIT	890.0
736-11-00158		Conductor (2" x 1/8" Schedule 80)	UNIT	890.0
736-11-00159		Conductor (2" x 1/8" Schedule 80)	UNIT	890.0
736-11-00160		Conductor (2" x 1/8" Schedule 80)	UNIT	890.0
736-11-001				

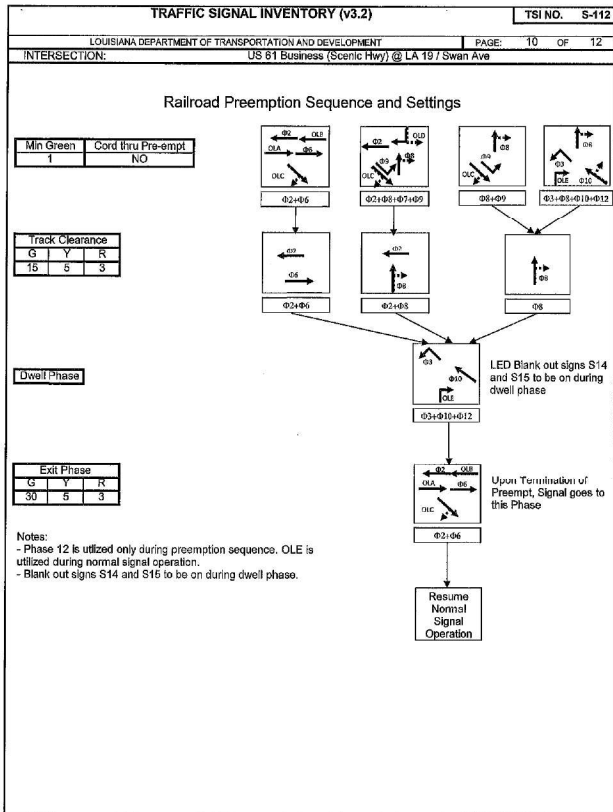

NOTES:

- OVERLAP B CANNOT RUN WITH PHASE 8
- OVERLAP C CAN RUN WITH PHASE 6, BUT CANNOT RUN WITH PHASE 11 AND PHASE 12
- OVERLAP D CANNOT RUN WITH PHASE 6

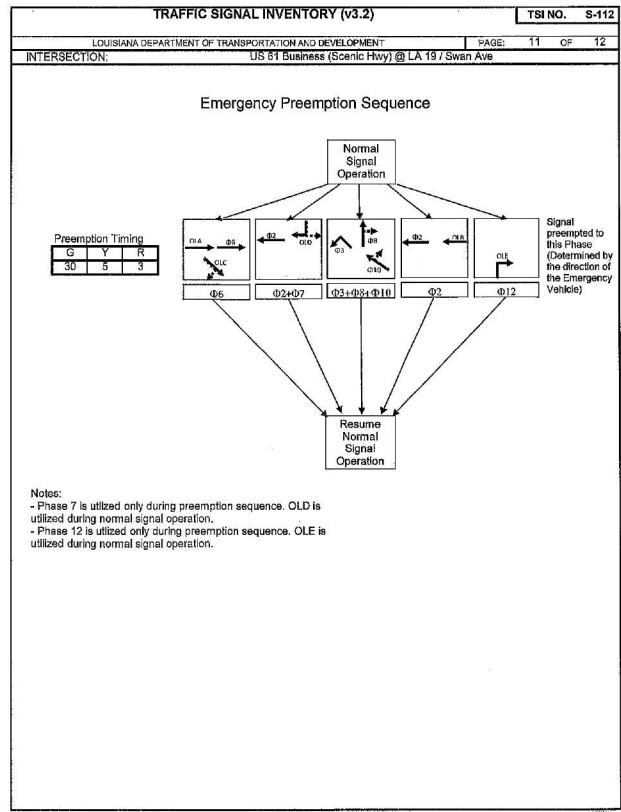

NOTES:

- OVERLAP B CANNOT RUN WITH PHASE 8
- OVERLAP C CAN RUN WITH PHASE 6, BUT CANNOT RUN WITH PHASE 11 AND PHASE 12
- OVERLAP D CANNOT RUN WITH PHASE 6



SHEET NUMBER	218
DESIGNED BY	JUST BARRY POORE
CHECKED BY	JUST BARRY POORE
DATE	07/12/2020
PROJECT NAME	US 51 BUSINESS (SCENIC HWY) @ LA 19 / SWAN AVE
PROJECT LOCATION	SCENIC HWY @ LA 19 / SWAN AVE
PROJECT TYPE	TRAFFIC SIGNAL PLAN
PROJECT STATUS	100% FINAL
PROJECT OWNER	LOUISIANA DEPARTMENT OF TRANSPORTATION AND DEVELOPMENT
PROJECT FUNDING	STATE FUNDING
PROJECT BUDGET	\$0.00
PROJECT COST	\$0.00
PROJECT REVENUE	\$0.00
PROJECT PROFIT	\$0.00
PROJECT LOSS	\$0.00
PROJECT NET	\$0.00
PROJECT TOTAL	\$0.00

NOTES

- CONTRACTOR SHALL INSTALL 870 LINEAR FEET OF JACKED OR BORED HDPE CONDUIT, 106 LINEAR FEET OF TRENCHED HDPE CONDUIT, 1 UNDERGROUND TYPE I JUNCTION BOX, AND 1 UNDERGROUND TYPE J JUNCTION BOX.
- CONDUIT REQUIRED FOR FIBER OPTIC COMMUNICATION CABLE SHALL BE HIGH DENSITY POLYETHYLENE CONDUIT (HDPE) IN ACCORDANCE WITH CITY SPECIFICATIONS AND APPROVED BY THE CITY CHIEF TRAFFIC ENGINEER. UNLESS NOTED OTHERWISE ON THE PLANS, HDPE CONDUIT FOR FIBER OPTIC COMMUNICATION CABLE SHALL BE JACKED OR BORED.
- CONTRACTOR SHALL INSTALL NEW TYPE I JUNCTION BOXES WITH 50 LINEAR FEET OF SPARE FIBER COMMUNICATION CABLE AS SHOWN IN THE PLANS.
- CONTRACTOR SHALL INSTALL NEW TYPE J JUNCTION BOXES AT THE PROPOSED CONTROLLER LOCATIONS WITH 100 LINEAR FEET OF SPARE FIBER COMMUNICATION CABLE.
- NEW FIBER OPTIC PATCH PANELS, PATCH CORDS, ETHERNET SWITCHES, AND SPLICE TRAYS WILL BE PROVIDED IN NEW CONTROLLER CABINETS.
- THE FIBER OPTIC COMMUNICATION CABLE QUANTITY SHOWN ON THIS SHEET INCLUDES THE SPARE CABLE TO BE INSTALLED IN JUNCTION BOXES.
- JUNCTION BOX LOCATIONS SHALL BE APPROVED BY DOTD TRAFFIC ENGINEERING.
- CONTRACTOR SHALL COORDINATE WITH DOTD TRAFFIC ENGINEERING AND PRIME CONTRACTOR PRIOR TO INSTALLING NEW COMMUNICATION CONDUIT FOR EXACT DEPTH AND LOCATION OF INSTALLATION.
- CONTRACTOR SHALL INSTALL FIBER WARNING SIGNS AND TRACING WIRE AS DIRECTED AND APPROVED BY THE CITY CHIEF TRAFFIC ENGINEER. FIBER INSTALLATION AND SPLICING SHALL MEET ALL CITY STANDARDS. SIGNS SHALL BE APPROVED BY THE PROJECT ENGINEER AND SHALL BE LOCATED ALONG THE FIBER OPTIC ROUTE ON THE CONCRETE COLLAR OF EACH JUNCTION BOX. CONTRACTOR SHALL INSTALL 10 AWG OR APPROVED EQUAL TRACING WIRE IN ALL CONDUIT TO BE USED FOR INSTALLED AND FUTURE FIBER CABLE.
- THE LOCATIONS OF UNDERGROUND UTILITIES AS SHOWN HEREIN ARE BASED ON ABOVEGROUND VISIBLE STRUCTURES AND RECORD DRAWINGS. LOCATIONS OF UNDERGROUND UTILITIES/STRUCTURES MAY VARY FROM LOCATIONS SHOWN HEREIN. ADDITIONAL BURIED UTILITIES MAY BE ENCOUNTERED. NO EXCAVATIONS WERE MADE TO LOCATE BURIED UTILITIES/STRUCTURES. IT IS THE CONTRACTOR'S RESPONSIBILITY TO LOCATE ALL UTILITIES PRIOR TO INSTALLATION OF ANY SIGNAL EQUIPMENT. CONTRACTOR SHALL COORDINATE WITH RAILROAD COMPANY TO IDENTIFY RAILROAD UTILITIES.
- CONTRACTOR SHALL COORDINATE WITH THE DOTD TRAFFIC ENGINEER FOR TRAFFIC SIGNAL CONTROLLER AND ETHERNET SWITCH COMMUNICATION CONFIGURATIONS.

LEGEND

- EXISTING PROPOSED
- () JUNCTION BOX
 - () JUNCTION BOX
 - GROUND MOUNTED CABINET AND CONTROLLER WITH BATTERY BACKUP
 - GROUND MOUNTED CABINET AND CONTROLLER
 - TRENCHED UNDERGROUND CONDUIT WITH F.O. CABLE
 - JACKED OR BORED CONDUIT WITH F.O. CABLE



ITEM	QUANTITY	DESCRIPTION	UNIT	AMOUNT
736-01-0010	1	Shoring and Boring	UNIT	1050.0
736-03-0010	1	Jacking or Boring	UNIT	670.0
736-03-0010	1	Underground Junction Box (Type I)	EACH	1
736-03-0010	1	Underground Junction Box (Type J)	EACH	1
736-03-0010	1	Conduit (12" HDPE, Schedule 80)	LINEAR FEET	770.0
NS-ITS-04000	1	Fiber Cable Material	EACH	2
NS-ITS-04000	1	Fiber Cable (12" HDPE, 12 Strand, Plenum & Install)	EACH	2
NS-ITS-04000	1	Fiber Cable Connection, Termination, Patch & Install	EACH	24
NS-ITS-04000	1	Fiber Cable (12" HDPE, 12 Strand, Plenum & Install)	LINEAR FEET	770.0
NS-ITS-04000	1	Fiber Cable Patch Cord, 20' Standard, Plenum & Install	EACH	4
NS-ITS-04000	1	Fiber Cable Connection Patch Panel, Outdoor, Plenum & Install	EACH	1
NS-ITS-04000	1	Fiber Cable Connection Patch Panel, Indoor, Plenum & Install	EACH	1
NS-ITS-04000	1	Fiber Cable Connection Patch Panel, Indoor, Plenum & Install	EACH	1

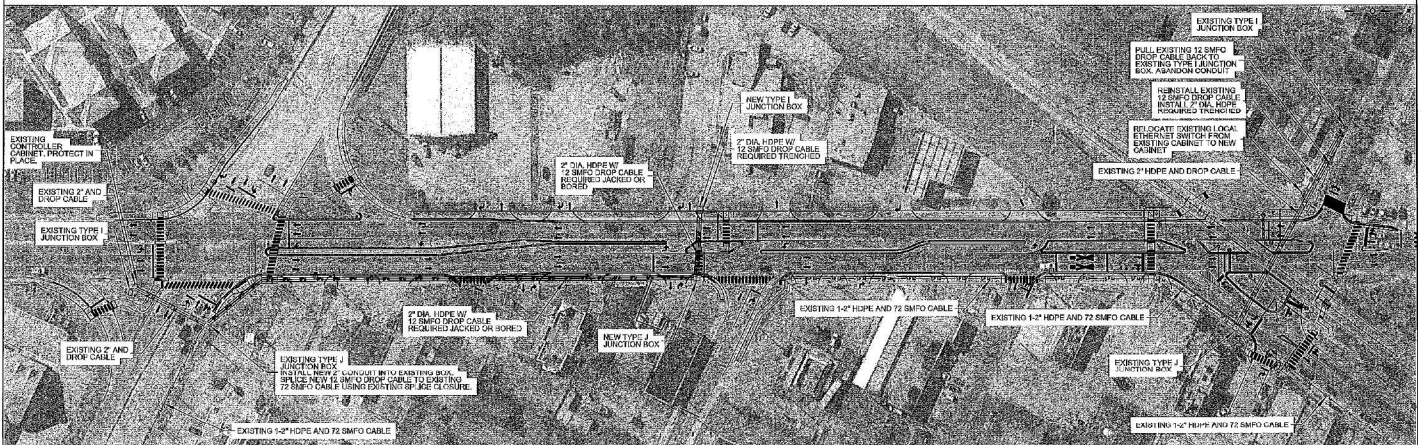

0 55' 10'

SCALE=1\"/>

SHEET NUMBER		217
PROJECT NAME		EAST BAYOU POLICE
DESIGNED BY	CHECKED BY	DATE
DRAWN BY	APPROVED BY	DATE
TRAFFIC SIGNAL PLAN'S SIGNAL INTERCONNECT		DATE
SCENIC HIGHWAY (HARDING BLVD. TO SWAN AVE.)		DATE
BR		DATE
ARCADIS		DATE

SCALE: 1"=5'

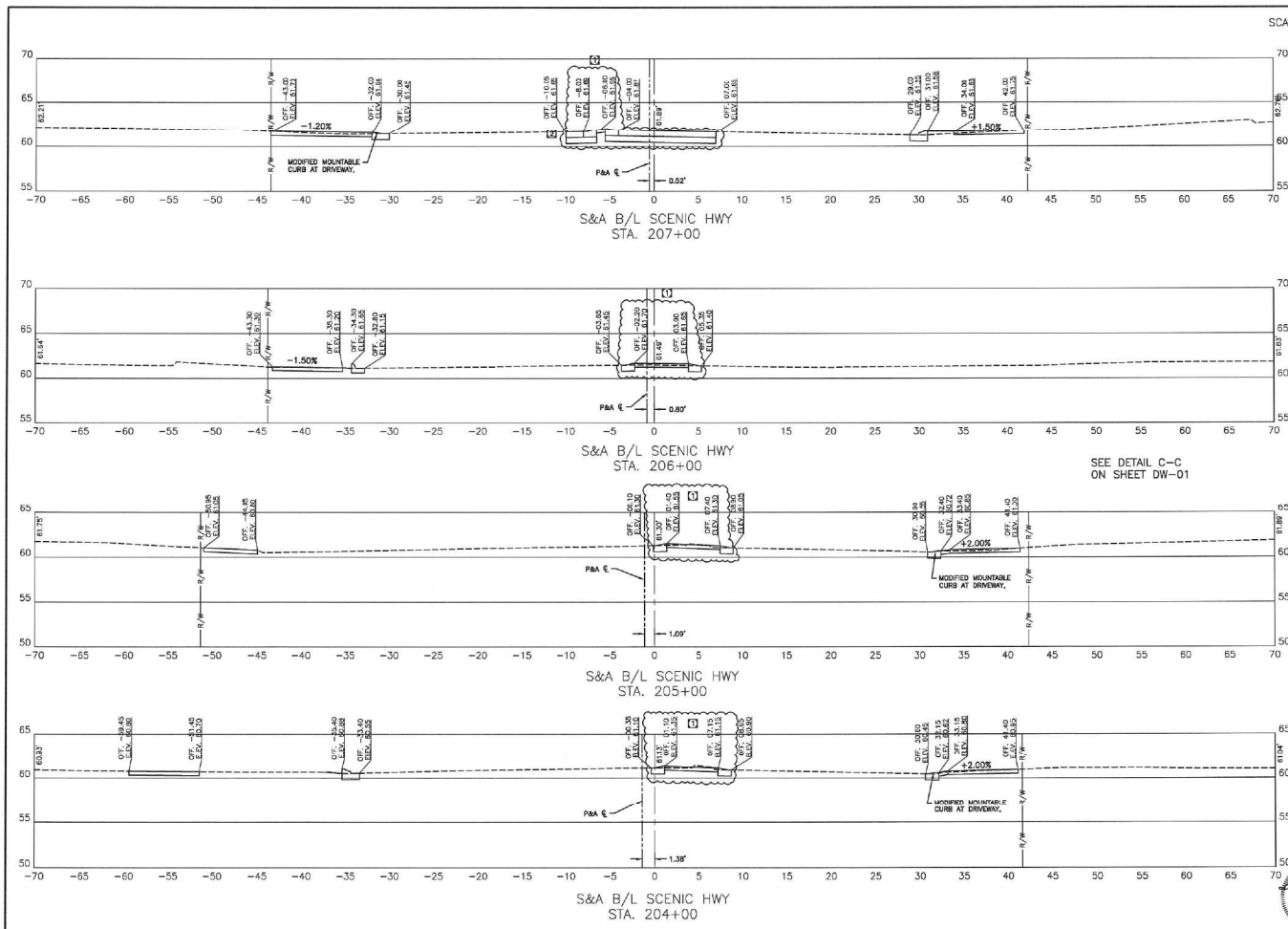

SHEET NUMBER		402
PROJECT		EAST BAYON ROUGE PARISH
DRAWN		20-DH-0006
DESIGNED	DATE	12-20-2003
CHECKED	DATE	12-20-2003
APPROVED	DATE	12-20-2003
CROSS SECTIONS - SCENIC		
SCENIC HIGHWAY (HARDING TO SWAN) CORRIDOR		
MEYER ENGINEERS, LTD.		

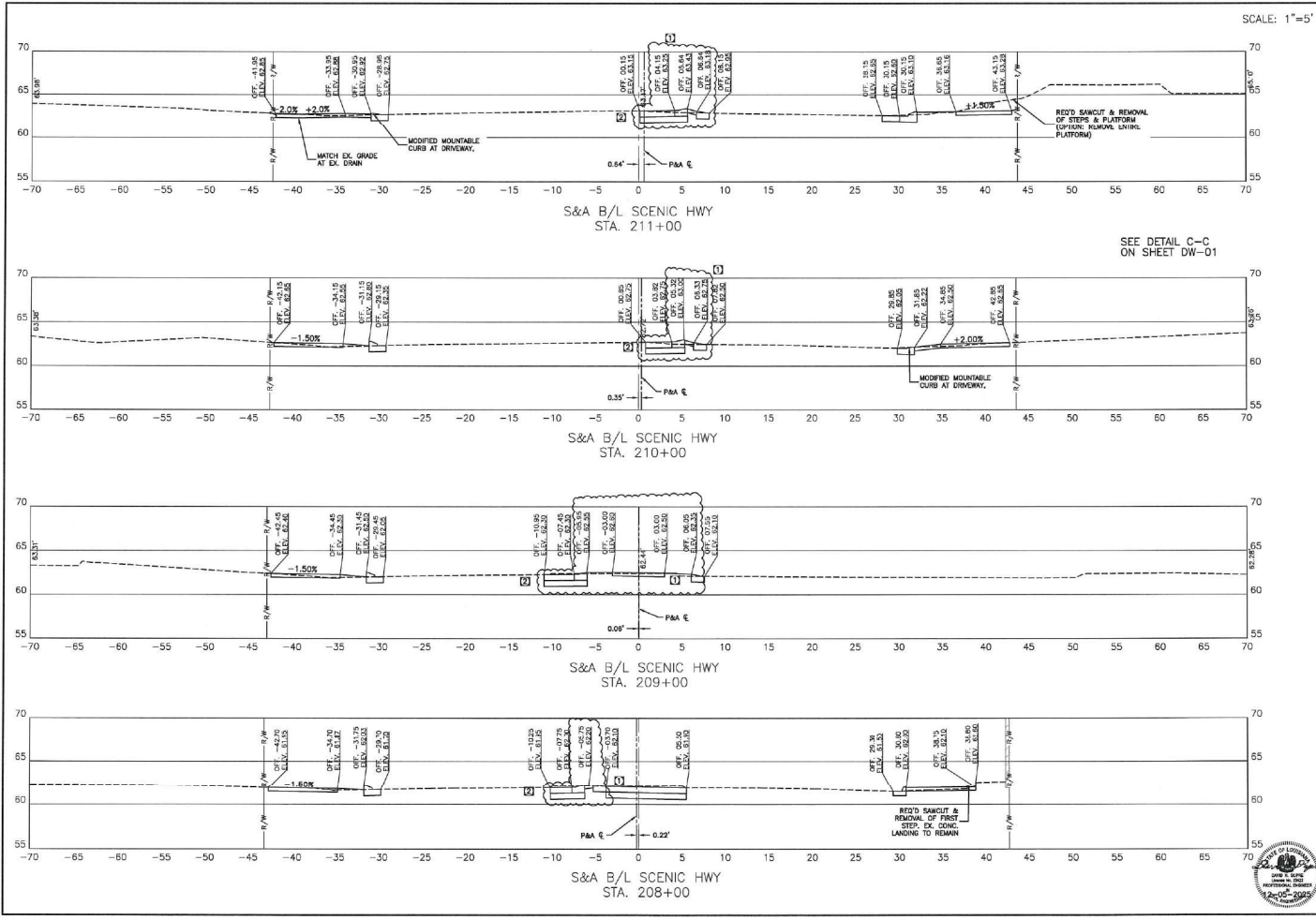

SHEET NUMBER		403
PROJECT		EAST BAYVIEW HOUSE PARISH
SHEET		20-IN-HC-0006
DATE		12-20-2023
DRAWN BY		N/A
CHECKED BY		N/A
DESIGNED BY		N/A
APPROVED BY		N/A
CROSS SECTIONS - SCENIC		
SCENIC HIGHWAY (HARDING TO SWAN) CORRIDOR		
BR		
MEYER ENGINEERS, LTD.		

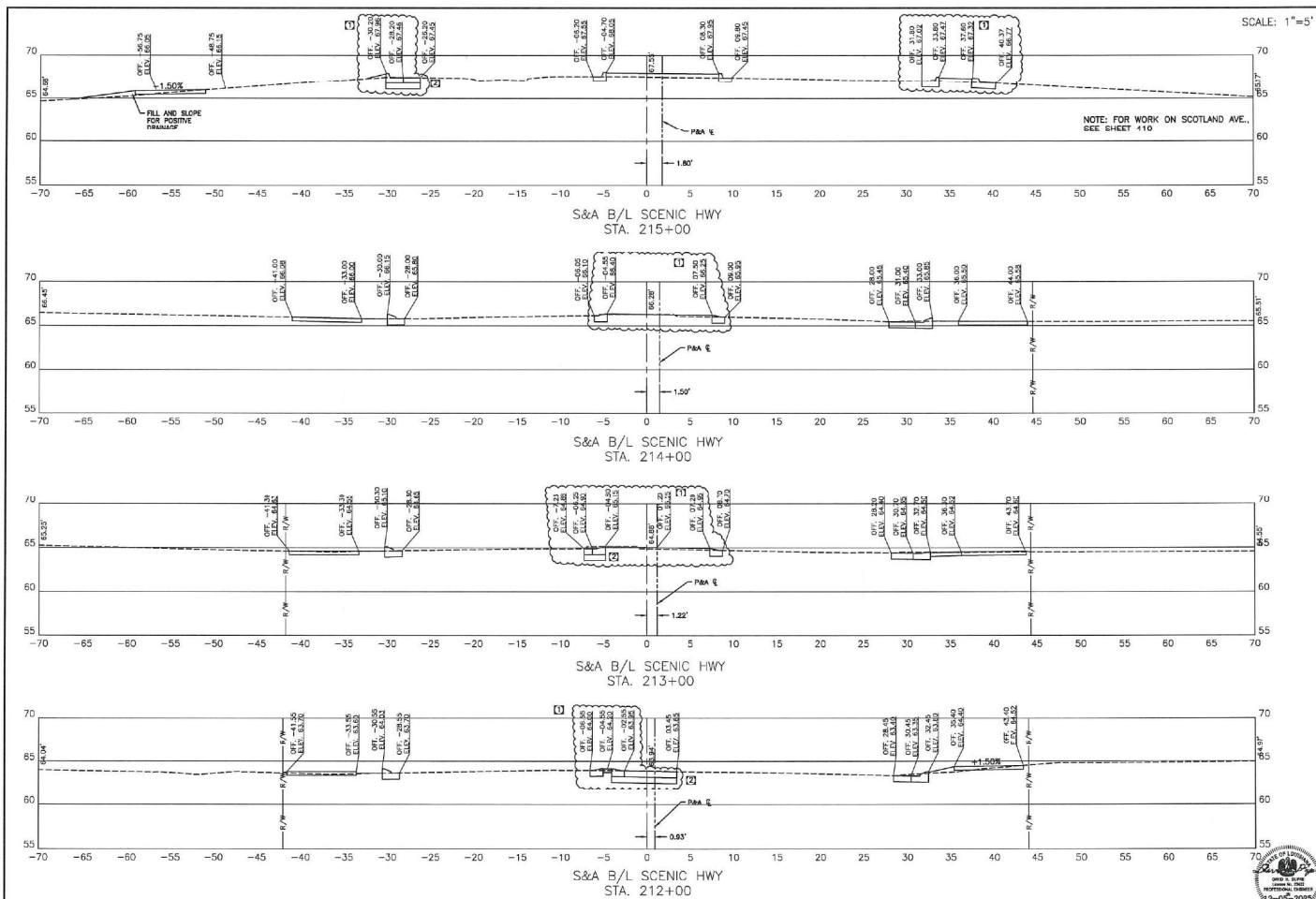

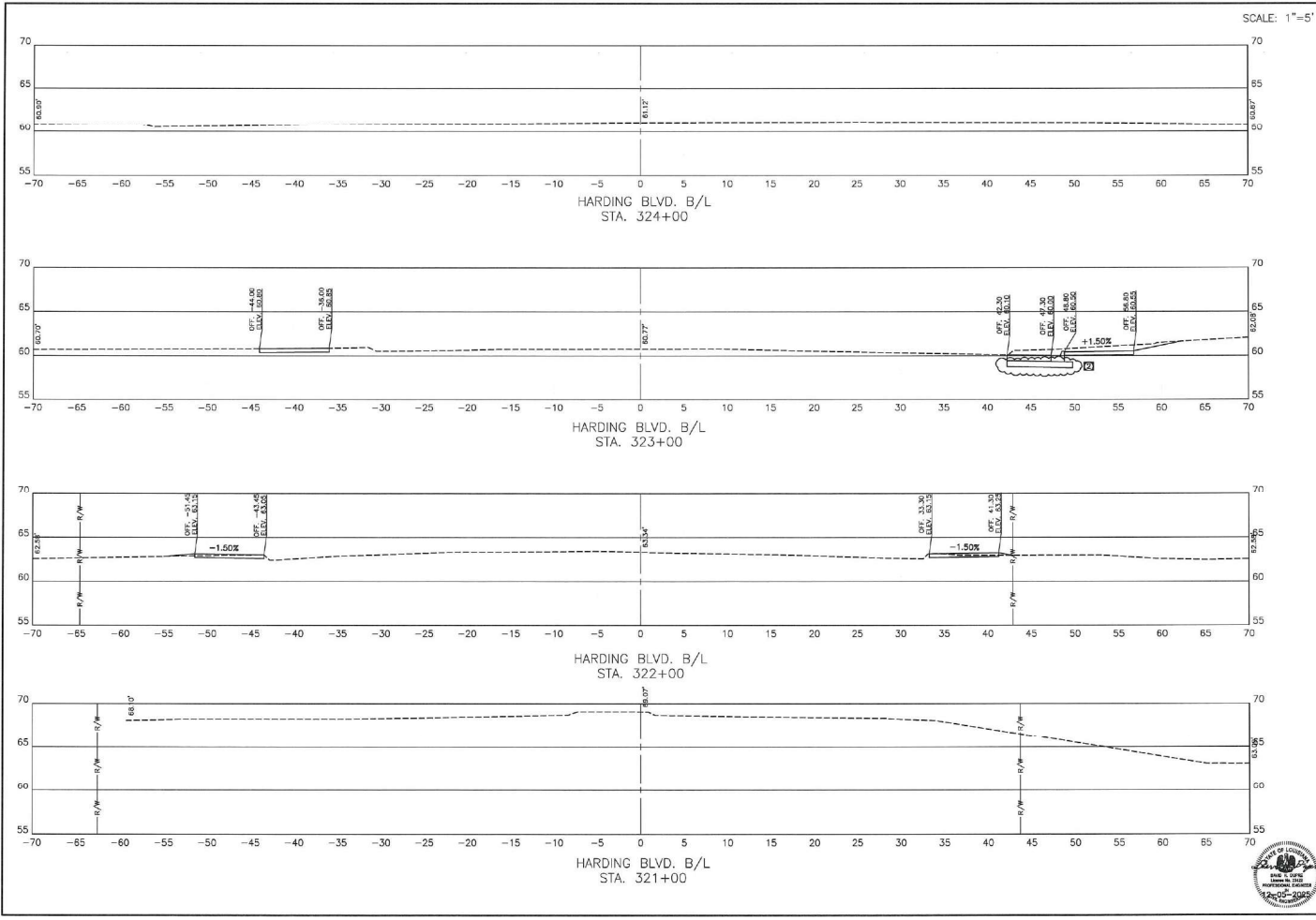

SHEET NUMBER		406
PROJECT		EAST RIVER RIDGE PARKWAY
CITY		20-DH-0006
DATE		11-29-2013
DRAWN BY		N/A
CHECKED BY		
APPROVED BY		
DESIGNED BY		
CALCULATED BY		
PLANNED BY		
CROSS SECTIONS - HARDING		
SCENIC HIGHWAY (HARDING TO SWAN) CORRIDOR		
BR		
MEYER ENGINEERS, LTD.		

