

General Information:

1. Contractor is responsible for furnishing all Labor, Materials, and Equipment needed to install the above 13 each landscape locations.
2. Contractor will install specified vegetation or equal after approved by the Agency.
3. All trash and waste removal will be the responsibility of the Contractor.
4. Traffic flow shall be maintained at all times.
5. Contractor and all employees will obey all traffic laws, speed limits, and signage.
6. Contractor will ensure no alcohol or illegal drugs are brought to the Agency.
7. Contractor will obey directions given by the Agency at all times.
8. Contractor will thoroughly clean project site at the end of each workday.
9. All workers shall be a U.S. Citizen or hold a valid passport with work visa.

1. Bldg. 1058-Cottage 220 sq. ft.

- a. Add Soil & Pine Straw as Needed Twice a Year
- b. Shaping of Shrubs as Needed Monthly
- c. Hand Weeding as Needed 40 times per year.
- d. Insect control on Beds as Needed Once a Month.
- e. Bed PRE-Emergent Herbicide as needed 3 times a year.
- f. Bed Fertilization Twice a Year (March and August).
- g. Bed post-emergent as needed every month.
- h. 36 each 4" Pot- Annual Color Twice a Year (March and September)

2. Bldg. 1241-West Tower 200 sq. ft.

- a. Add Soil & Pine Straw as Needed Twice a Year
- b. Shaping of Shrubs as Needed Monthly
- c. Hand Weeding as Needed 40 times per year.
- d. Insect control on Beds as Needed Once a Month.
- e. Bed PRE-Emergent Herbicide as needed 3 times a year.
- f. Bed Fertilization Twice a Year (March and August).
- g. Bed post-emergent as Needed every month
- h. 108 each 4" Pot-Annual Color Twice a Year (March and September)

3. Bldg. 5000-Gate Entrance Claiborne North 460 sq. ft.

- a. Add Soil & Pine Straw as Needed Twice a Year
- b. Shaping of Shrubs as Needed Monthly
- c. Hand Weeding as Needed 40 times per year.
- d. Insect control on Beds as Needed Once a Month.
- e. Bed PRE-Emergent Herbicide as needed 3 times a year.
- f. Bed Fertilization Twice a Year (March and August).
- g. Bed post-emergent as needed every month.
- h. 200 each 4" Pot- Annual Color. Twice a Year (March and September)

4. Bldg. 4900-Gate Entrance Claiborne South 460 sq. ft.
 - a. Add Soil & Pine Straw as Needed Twice a Year
 - b. Shaping of Shrubs as Needed Monthly
 - c. Hand Weeding as Needed 40 times per year.
 - d. Insect control on Beds as Needed Once a Month.
 - e. Bed PRE-Emergent Herbicide as needed 3 times a year.
 - f. Bed Fertilization Twice a Year (March and August).
 - g. Bed post-emergent as needed every month.
 - h. 200ea 4” Pot- Annual Color. Twice a Year (March and September)
5. Bldg. 4000-Gate Entrance St. Claude North 460 sq. ft.
 - a. Add Soil & Pine Straw as Needed Twice a Year
 - b. Shaping of Shrubs as Needed Monthly
 - c. Hand Weeding as Needed 40 times per year.
 - d. Insect control on Beds as Needed Once a Month.
 - e. Bed PRE-Emergent Herbicide as needed 3 times a year.
 - f. Bed Fertilization Twice a Year (March and August).
 - g. Bed post-emergent as needed every month.
 - h. 200 each 4” Pot- Annual Color. Twice a Year (March and September)
6. Bldg. 3000-Gate Entrance St. Claude South 460 sq. ft.
 - a. Add Soil & Pine Straw as Needed Twice a Year
 - b. Shaping of Shrubs as Needed Monthly
 - c. Hand Weeding as Needed 40 times per year.
 - d. Insect control on Beds as Needed Once a Month.
 - e. Bed PRE-Emergent Herbicide as needed 3 times a year.
 - f. Bed Fertilization Twice a Year (March and August).
 - g. Bed post-emergent as needed every month.
 - h. 200 each 4” Pot- Annual Color. Twice a Year (March and September)
7. Gate Entrance St. Claude Oval 675 sq. ft.
 - a. Add Soil & Pine Straw as Needed Twice a Year
 - b. Shaping of Shrubs as Needed Monthly
 - c. Hand Weeding as Needed 40 times per year.
 - d. Insect control on Beds as Needed Once a Month.
 - e. Bed PRE-Emergent Herbicide as needed 3 times a year.
 - f. Bed Fertilization Twice a Year (March and August).
 - g. Bed post-emergent as needed every month.

8. Bldg. 1065-Hufft Hall 160 sq. ft.
 - a. Add Soil & Pine Straw as Needed Twice a Year
 - b. Shaping of Shrubs as Needed Monthly
 - c. Hand Weeding as Needed 40 times per year.
 - d. Insect control on Beds as Needed Once a Month.
 - e. Bed PRE-Emergent Herbicide as needed 3 times a year.
 - f. Bed Fertilization Twice a Year (March and August).
 - g. Bed post-emergent as needed every month.
 - h. 72 each 4" Pot-Annual Color Twice a Year (March and September)
9. Bldg. 1111 AGO. 500 sq. ft.
 - a. Add Soil & Pine Straw as Needed Twice a Year
 - b. Shaping of Shrubs as Needed Monthly
 - c. Hand Weeding as Needed 40 times per year.
 - d. Insect control on Beds as Needed Once a Month.
 - e. Bed PRE-Emergent Herbicide as needed 3 times a year.
 - f. Bed Fertilization Twice a Year (March and August).
 - g. Bed post-emergent as needed every month.
 - h. 200 each 4" Pot-Annual Color. Twice a Year (March and September)
10. Bldg. 1101. Fleming Hall. 20 sq. ft.
 - a. Add Soil & Pine Straw as Needed Twice a Year
 - b. Shaping of Shrubs as Needed Monthly
 - c. Hand Weeding as Needed 40 times per year.
 - d. Insect control on Beds as Needed Once a Month.
 - e. Bed PRE-Emergent Herbicide as needed 3 times a year.
 - f. Bed Fertilization Twice a Year (March and August).
 - g. Bed post-emergent as needed every month.
 - h. 24 each 4" Pot-Annual Color Twice a year (March and September)
11. Minute Man Circle 1600 sq. ft.
 - a. Add Soil & Pine Straw as Needed Twice a Year
 - b. Shaping of Shrubs as Needed Monthly
 - c. Hand Weeding as Needed 40 times per year.
 - d. Insect control on Beds as Needed Once a Month.
 - e. Bed PRE-Emergent Herbicide as needed 3 times a year.
 - f. Bed Fertilization Twice a Year (March and August).
 - g. Bed post-emergent as needed every month.
 - h. 200 each 4" Pot-Annual Color. Twice a year (March and September)

12. Bldg. 4209 Museum Courtyard. 260 sq. ft.
 - a. Add Soil & Pine Straw as Needed Twice a Year
 - b. Shaping of Shrubs as Needed Monthly
 - c. Hand Weeding as Needed 40 times per year.
 - d. Insect control on Beds as Needed Once a Month.
 - e. Bed PRE-Emergent Herbicide as needed 3 times a year.
 - f. Bed Fertilization Twice a Year (March and August).
 - g. Bed post-emergent as needed every month.
 - h. 100 each 4" Pot-Annual Color. Twice a Year (March and September)

13. River Gate. 400 sq. ft.
 - a. Add Soil & Pine Straw as Needed Twice a Year
 - b. Shaping of Shrubs as Needed Monthly
 - c. Hand Weeding as Needed 40 times per year.
 - d. Insect control on Beds as Needed Once a Month.
 - e. Bed PRE-Emergent Herbicide as needed 3 times a year.
 - f. Bed Fertilization Twice a Year (March and August).
 - g. Bed post-emergent as needed every month.
 - h. 200 each 4" Pot-Annual Color. Twice a year (March and September)

Area-A



Bldg 1101

Area-A



Rivergate

Area-A



Rivergate

Area-A

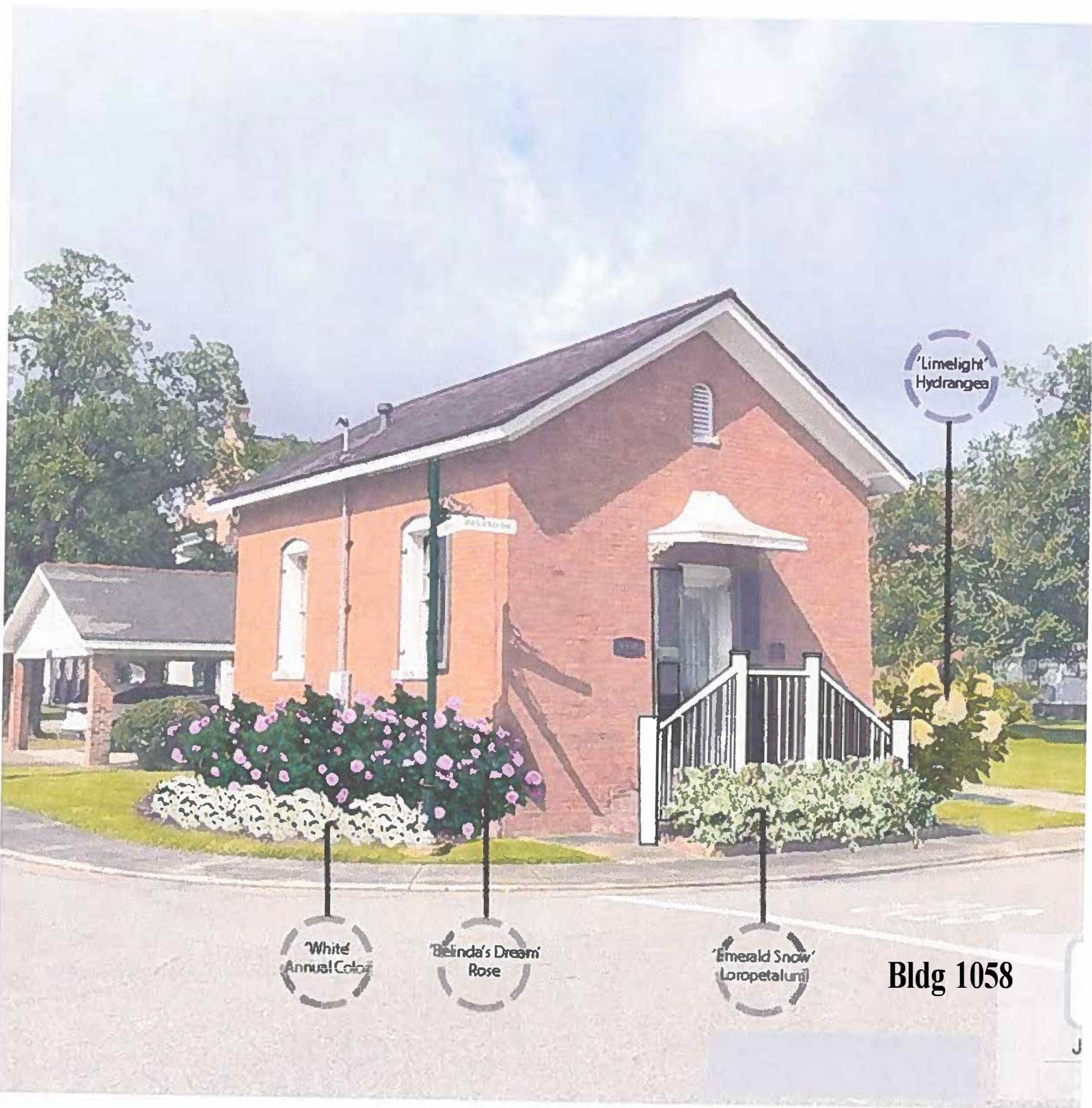

Area-A



Minute man circle

Area-A



BLDG 1065

Area-A

BLDG 1241



Area - A



Area-B



Area-B

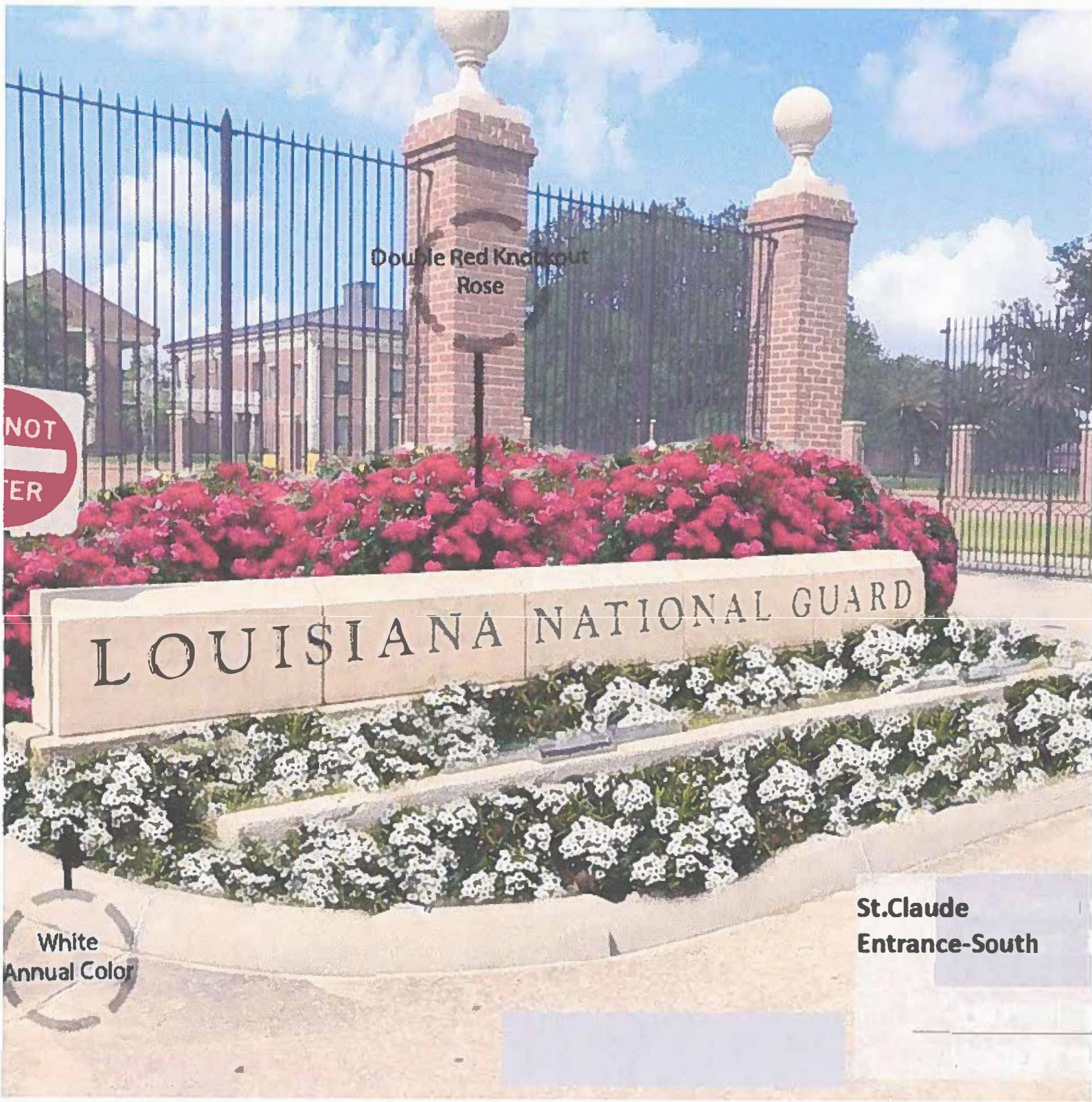

Double Red Knockout
Rose

NOT
ENTER

LOUISIANA NATIONAL GUARD

White
Annual Color

St. Claude
Entrance-South

Area - C

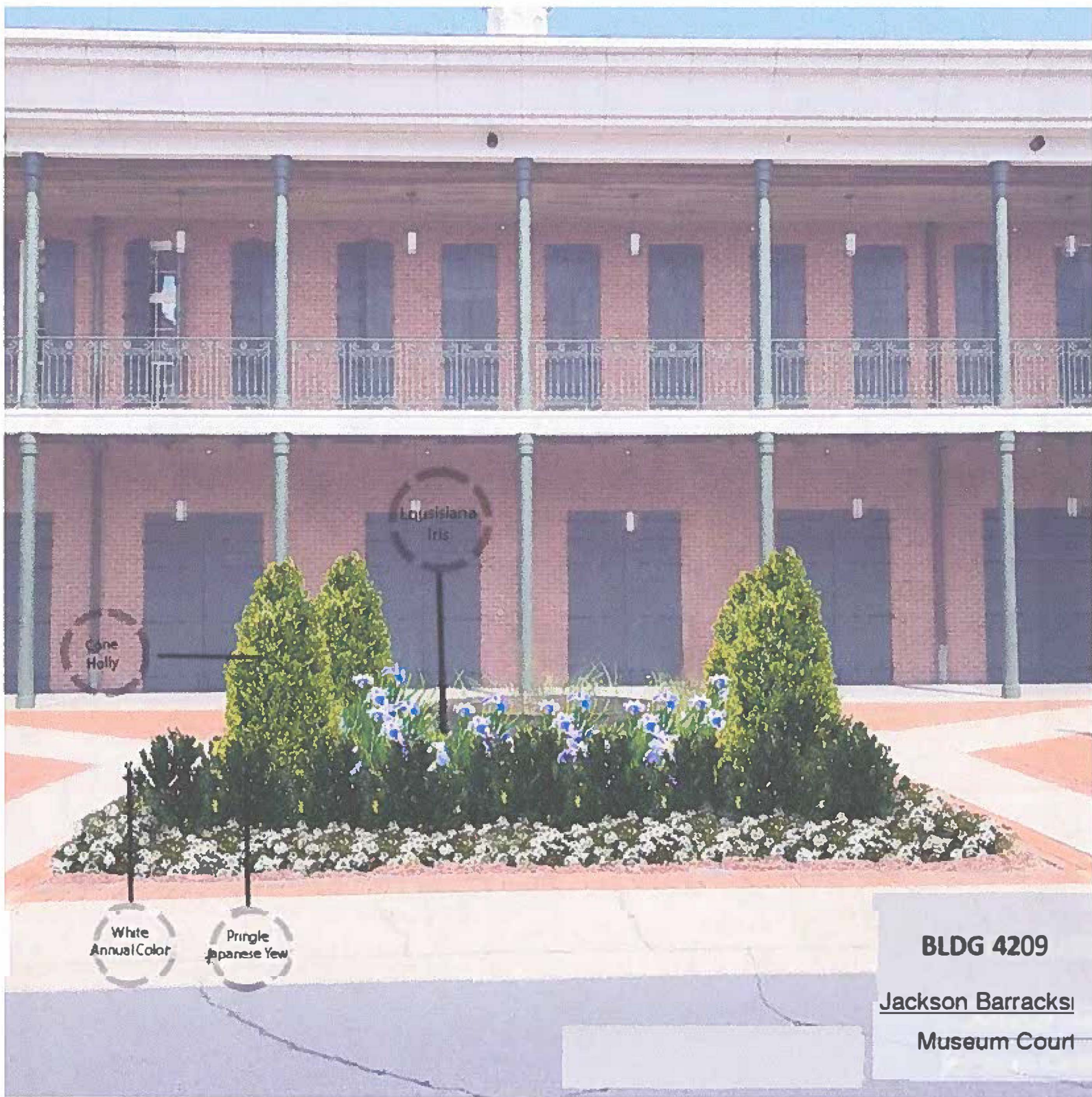

Area-C



Area-C



Area-D

