



**LOUISIANA STATE UNIVERSITY
HEALTH SCIENCES CENTER**

Air Filter Changing

ITB# 002881

Thursday, May 1, 2025 @ 2:00PM (central)

Vendor Name: _____

Total Bid Price from Bidders Price Sheet: _____

Invitation to Bid

LSUHSC New Orleans				BIDS WILL BE PUBLICLY OPENED: <div style="display: flex; justify-content: space-between;"> May 01, 2025 02:00 PM </div>	
VENDOR NO. : SOLICITATION : 002881 OPENING DATE : 05/01/2025		Return Sealed Bid to: Purchasing Department		BUYER : BUYER EMAIL : BUYER PHONE : DATE ISSUED : 04/03/2025 REQ. NO : FISCAL YEAR : 0	
Air Filter Changing					
To be Completed by Vendor:					
BUSINESS NAME _____					
ADDRESS _____					
TAX ID NUMBER _____					
<p>_____ % CASH DISCOUNT FOR PROMPT PAYMENT IF MADE WITHIN THIRTY 30 DAYS. CASH DISCOUNTS FOR LESS THAN 30 DAYS OR LESS THAN 1% WILL BE ACCEPTED, BUT WILL NOT BE CONSIDERED IN DETERMINING AWARDS. ON INDEFINITE QUANTITY TERM CONTRACTS, CASH DISCOUNTS WILL BE ACCEPTED AND TAKEN BUT WILL NOT BE CONSIDERED IN DETERMINING AWARDS.</p>					
<p>INSTRUCTION TO BIDDERS</p> <p>1. READ THE ENTIRE BID (INCLUDING ALL TERMS AND CONDITIONS AND SPECIFICATIONS).</p> <p style="margin-left: 20px;">DIVERSE SUPPLIER</p> <p style="margin-left: 20px;">(A) SUPPLIER UNDERSTANDS THAT LSU, AS THE STATE'S FLAGSHIP UNIVERSITY, HAS AN INTEREST IN PROVIDING ENTREPRENEURIAL OPPORTUNITIES TO DIVERSITY-OWNED BUSINESSES. THE UNIVERSITY IS DEDICATED TO PROMOTING THE GROWTH AND DEVELOPMENT OF MINORITY, WOMEN, AND SMALL AND HISTORICALLY UNDERUTILIZED BUSINESSES ("DIVERSE BUSINESSES") BY PROVIDING OPPORTUNITIES TO PARTICIPATE IN UNIVERSITY CONTRACTS.</p> <p style="margin-left: 20px;">(B) IN SUPPORT OF THIS COMMITMENT, THE SUPPLIER SHALL USE GOOD FAITH AND BEST EFFORTS TO PROVIDE OPPORTUNITIES TO DIVERSE BUSINESSES THAT ARE EITHER CERTIFIED BY THE STATE OR ANOTHER CERTIFYING AGENCY IN A DIVERSE CATEGORY, AS A SUBCONTRACTOR OR SUPPLIER UNDER THIS AGREEMENT.</p> <p style="margin-left: 20px;">(C) IF APPLICABLE, SUPPLIER SHALL PROVIDE LSU WITH A LIST OF DIVERSITY-OWNED BUSINESSES DURING EACH CONTRACT YEAR, THE LIST OF BUSINESSES SHOULD IDENTIFY:</p> <div style="margin-left: 40px;"> (1) THE NAME OF THE BUSINESS; (2) ITS PRINCIPAL OFFICE OR ADDRESS; (3) THE OWNER(S); AND (4) THE SERVICES OR GOODS THAT IT MAY PROVIDE OR SUPPLY AND THE VALUE OF THE GOODS OR SERVICES PROCURED FROM THE BUSINESSES INCLUDED ON SUPPLIER'S LIST. </div> <p style="margin-left: 20px;">(D) TO THE EXTENT THAT ANY FEDERAL OR STATE LAW, RULE, OR REGULATION WOULD REQUIRE THAT THIS SECTION BE MODIFIED OR VOIDED, THE PARTIES AGREE THAT SUCH PROVISION CAN BE AMENDED OR SEVERED FROM THE AGREEMENT WITHOUT AFFECTING ANY OF THE OTHER TERMS OF THE AGREEMENT.</p> <p>2. ALL BID PRICES MUST BE TYPED OR WRITTEN IN INK. ANY CORRECTIONS, ERASURES OR OTHER FORMS OF ALTERATION TO UNIT PRICES SHOULD BE INITIALIZED BY THE BIDDER.</p> <p>3. THIS BID IS TO BE MANUALLY SIGNED IN INK BY A PERSON AUTHORIZED TO BIND THE VENDOR (See No.9).</p>					
VENDOR PHONE NUMBER:		TITLE		DATE	
EMAIL ADDRESS:		NAME OF BIDDER (TYPED OR PRINTED)			
SIGNATURE OF AUTHORIZED BIDDER (MUST BE SIGNED)		NAME OF BIDDER (TYPED OR PRINTED)			

Invitation to Bid

STANDARD TERMS & CONDITIONS	Page 2 of 10
NUMBER : 002881 OPEN DATE : 05/01/2025 TIME: 02:00 PM	BIDDER:
<p>4. BID PRICES SHALL INCLUDE DELIVERY OF ALL ITEMS F.O.B. DESTINATION OR AS OTHERWISE PROVIDED. BIDS CONTAINING "PAYMENT IN ADVANCE" OR "C.O.D." REQUIREMENTS MAY BE REJECTED. PAYMENT IS TO BE MADE WITHIN 30 DAYS AFTER RECEIPT OF A PROPERLY EXECUTED INVOICE THAT IS APPROVED BY LSUHSC OR DELIVERY, WHICHEVER IS LATER.</p> <p>5. DESIRED DELIVERY: 10 DAYS AFTER RECEIPT OF ORDER, UNLESS SPECIFIED ELSEWHERE.</p> <p>6. TO ASSURE CONSIDERATION OF YOUR BID, SEE HEADER FOR RETURN INSTRUCTIONS. ALL BIDS AND ADDENDA SHOULD BE RETURNED IN AN ENVELOPE OR PACKAGE AND CLEARLY ENDORSED WITH THE BID OPENING DATE, BID OPENING TIME, BID NUMBER, AND BID TITLE. ALL REQUEST FOR QUOTATIONS AND ADDENDA SHOULD BE SUBMITTED VIA FAX, EMAIL OR PLACED IN AN ENVELOPE AND DELIVERED.</p> <p>7. BIDS SUBMITTED ARE SUBJECT TO PROVISIONS OF THE LAWS OF THE STATE OF LOUISIANA INCLUDING BUT NOT LIMITED TO L.R.S. 39:1551-1736; PURCHASING RULES AND REGULATIONS; EXECUTIVE ORDERS; STANDARD TERMS AND CONDITIONS; SPECIAL CONDITIONS; AND SPECIFICATIONS LISTED IN THIS SOLICITATION.</p> <p>PROHIBITION OF DISCRIMINATORY BOYCOTTS OF ISRAEL:</p> <p>IN ACCORDANCE WITH EXECUTIVE ORDER NUMBER JBE 2018-15, EFFECTIVE MAY 22, 2018, FOR ANY CONTRACT FOR \$100,000 OR MORE AND FOR ANY CONTRACTOR WITH FIVE OR MORE EMPLOYEES, CONTRACTOR, OR ANY SUBCONTRACTOR, SHALL CERTIFY IT IS NOT ENGAGING IN A BOYCOTT OF ISRAEL, AND SHALL, FOR THE DURATION OF THIS CONTRACT, REFRAIN FROM A BOYCOTT OF ISRAEL. THE STATE RESERVES THE RIGHT TO TERMINATE THIS CONTRACT IF THE CONTRACTOR, OR ANY SUBCONTRACTOR, ENGAGES IN A BOYCOTT OF ISRAEL DURING THE TERM OF THE CONTRACT.</p> <p>8. IMPORTANT:</p> <p>BY SIGNING THIS BID, THE BIDDER CERTIFIES COMPLIANCE WITH ALL INSTRUCTIONS TO BIDDERS, TERMS, CONDITIONS, AND SPECIFICATIONS AND FURTHER CERTIFIES THAT THIS BID IS MADE WITHOUT COLLUSION OR FRAUD. ALL BID INFORMATION SHALL BE MADE WITH INK OR TYPEWRITTEN.</p> <p>9. SIGNATURE AUTHORITY:</p> <p>SUBMIT EVIDENCE WITH THE BID OR UPON REQUEST</p> <p>R.S. 39:1594 (C) (4) EVIDENCE OF AGENCY, CORPORATE, OR PARTNERSHIP AUTHORITY SHALL BE REQUIRED FOR SUBMISSION OF A BID TO PURCHASING AGENCIES OF THE STATE OF LOUISIANA.</p> <p>THE AUTHORITY OF THE SIGNATURE OF THE PERSON SUBMITTING THE BID SHALL BE DEEMED SUFFICIENT AND ACCEPTABLE IF ANY OF THE FOLLOWING CONDITIONS ARE MET:</p> <p>(A) THE SIGNATURE ON THE BID IS THAT OF ANY CORPORATE OFFICER LISTED ON THE MOST CURRENT ANNUAL REPORT ON FILE WITH THE SECRETARY OF STATE, OR THE SIGNATURE ON THE BID IS THAT OF ANY MEMBER OF A PARTNERSHIP OR PARTNERSHIP IN COMMENDAM LISTED IN THE MOST CURRENT PARTNERSHIP RECORDS ON FILE WITH THE SECRETARY OF STATE.</p> <p>(B) THE SIGNATURE ON THE BID IS THAT OF AN AUTHORIZED REPRESENTATIVE OF THE CORPORATION, PARTNERSHIP, OR OTHER LEGAL ENTITY AND THE BIDDER SUBMITS OR PROVIDES UPON REQUEST A CORPORATE RESOLUTION, CERTIFICATION AS TO THE CORPORATE PRINCIPAL, OR OTHER DOCUMENTS INDICATING AUTHORITY WHICH ARE ACCEPTABLE TO THE PUBLIC ENTITY, INCLUDING REGISTRATION ON AN ELECTRONIC INTERNET DATABASE MAINTAINED BY THE PUBLIC ENTITY.</p> <p>(C) THE CORPORATION, PARTNERSHIP, OR OTHER LEGAL ENTITY HAS FILED IN THE APPROPRIATE RECORDS OF THE SECRETARY OF STATE IN WHICH THE PUBLIC ENTITY IS LOCATED, AN AFFIDAVIT, RESOLUTION, OR OTHER ACKNOWLEDGED OR</p>	

Invitation to Bid

STANDARD TERMS & CONDITIONS

Page 3 of 10

NUMBER : 002881
OPEN DATE : 05/01/2025 TIME: 02:00 PM

BIDDER:

AUTHENTIC DOCUMENT INDICATING THE NAMES OF ALL PARTIES AUTHORIZED TO SUBMIT BIDS FOR PUBLIC CONTRACTS. SUCH DOCUMENT ON FILE WITH THE SECRETARY OF STATE SHALL REMAIN IN EFFECT AND SHALL BE BINDING UPON THE PRINCIPAL UNTIL SPECIFICALLY RESCINDED AND CANCELED FROM THE RECORDS OF THE RESPECTIVE OFFICES.

IT IS ACCEPTABLE FOR THE SIGNATURE ON THE BID TO BE LISTED AS A VENDOR CONTACT ON LAPAC (LOUISIANA PROCUREMENT AND CONTRACT NETWORK)

10. INQUIRIES:

ADDRESS ALL INQUIRIES AND CORRESPONDENCE TO THE BUYER AT THE PHONE NUMBER AND ADDRESS SHOWN ABOVE.

11. BID FORMS:

ALL WRITTEN BIDS, UNLESS OTHERWISE PROVIDED FOR, MUST BE SUBMITTED ON, AND IN ACCORDANCE WITH FORMS PROVIDED AND PROPERLY SIGNED. BIDS SUBMITTED IN THE FOLLOWING MANNER WILL NOT BE ACCEPTED:

- A. BID CONTAINS NO SIGNATURE INDICATING INTENT TO BE BOUND
- B. BID FILLED OUT IN PENCIL; AND
- C. BID NOT SUBMITTED PER THE SOLICITATION DOCUMENT.

BIDS MUST BE RECEIVED AT THE ADDRESS SPECIFIED IN THE SOLICITATION PRIOR TO BID OPENING TIME IN ORDER TO BE CONSIDERED.

12. STANDARDS OR QUALITY:

ANY PRODUCT OR SERVICE BID SHALL CONFORM TO ALL APPLICABLE FEDERAL AND STATE LAWS AND REGULATIONS AND THE SPECIFICATIONS CONTAINED IN THE SOLICITATION. UNLESS OTHERWISE SPECIFIED IN THE SOLICITATION, ANY MANUFACTURER'S NAME, TRADE NAME, BRAND NAME, OR CATALOG NUMBER USED IN THE SPECIFICATION IS FOR THE PURPOSE OF DESCRIBING THE STANDARD OF QUALITY, PERFORMANCE, AND CHARACTERISTICS DESIRED AND IS NOT INTENDED TO LIMIT OR RESTRICT COMPETITION. BIDDER MUST SPECIFY THE BRAND AND MODEL NUMBER OF THE PRODUCT OFFERED IN HIS/HER BID. BIDS NOT SPECIFYING BRAND AND MODEL NUMBER SHALL BE CONSIDERED AS OFFERING THE EXACT PRODUCTS SPECIFIED IN THE SOLICITATION. LSUHSC RESERVES THE RIGHT TO INSPECT AND TEST THE DELIVERED ITEMS FOR COMPLIANCE WITH THE BID SPECIFICATIONS. IF THE ITEM FAILS TO MEET THE SPECIFICATIONS, THE COST OF TEST AND INSPECTION WILL BE PAID BY THE CONTRACTOR. IF THE ITEM IS IN COMPLIANCE, COST OF ALL TESTS WILL BE PAID BY LSUHSC.

13. DESCRIPTIVE INFORMATION:

BIDDERS PROPOSING AN EQUIVALENT BRAND OR MODEL SHOULD SUBMIT WITH THE BID, INFORMATION (SUCH AS ILLUSTRATIONS, DESCRIPTIVE LITERATURE, AND TECHNICAL DATA) SUFFICIENT FOR LSUHSC TO EVALUATE QUALITY, SUITABILITY, AND COMPLIANCE WITH THE SPECIFICATIONS IN THE SOLICITATION. FAILURE TO SUBMIT DESCRIPTIVE INFORMATION MAY CAUSE BID TO BE REJECTED. ANY CHANGE MADE TO A MANUFACTURER'S PUBLISHED SPECIFICATION SUBMITTED FOR A PRODUCT SHALL BE VERIFIABLE BY THE MANUFACTURER. IF ITEM(S) BID DO NOT FULLY COMPLY WITH SPECIFICATIONS (INCLUDING BRAND AND/OR PRODUCT NUMBER), BIDDER MUST STATE IN WHAT RESPECT ITEMS(S) DEVIATE. FAILURE TO NOTE EXCEPTIONS ON THE BID FORM WILL NOT RELIEVE THE SUCCESSFUL BIDDER(S) FROM SUPPLYING THE ACTUAL PRODUCTS REQUESTED.

14. BID OPENING:

BIDDERS MAY ATTEND THE BID OPENING, BUT NO INFORMATION OR OPINIONS CONCERNING THE ULTIMATE CONTRACT AWARD WILL BE GIVEN AT THE BID OPENING OR DURING THE EVALUATION PROCESS. BIDS MAY BE EXAMINED WITHIN 72 HOURS AFTER BID OPENING. INFORMATION PERTAINING TO COMPLETED FILES MAY BE SECURED BY VISITING LSUHSC DURING NORMAL

Invitation to Bid

STANDARD TERMS & CONDITIONS	Page 4 of 10
NUMBER : 002881 OPEN DATE : 05/01/2025 TIME: 02:00 PM	BIDDER:
<p>WORKING HOURS. WRITTEN BID TABULATIONS WILL NOT BE FURNISHED.</p> <p>15. AWARDS: AWARD WILL BE MADE TO THE LOWEST RESPONSIBLE AND RESPONSIVE BIDDER. LSUHSC RESERVES THE RIGHT TO AWARD ITEMS SEPARATELY, GROUPED, OR ON AN ALL OR NONE BASIS , AND TO REJECT ANY OR ALL BIDS AND WAIVE ANY INFORMALITIES.</p> <p>16. PRICES: UNLESS OTHERWISE SPECIFIED BY LSUHSC IN THE SOLICITATION, BID PRICES MUST BE COMPLETE, INCLUDING TRANSPORTATION PREPAID BY BIDDER TO DESTINATION AND FIRM FOR ACCEPTANCE FOR A MINIMUM OF 30 DAYS. IF ACCEPTED, PRICES MUST BE FIRM FOR THE CONTRACTUAL PERIOD. BIDS OTHER THAN F.O.B. DESTINATION MAY BE REJECTED. PRICES SHOULD BE QUOTED IN THE UNIT (EACH, BOX, CASE, ETC.) AS SPECIFIED IN THE SOLICITATION.</p> <p>17. TAXES: VENDOR IS RESPONSIBLE FOR INCLUDING ALL APPLICABLE TAXES IN THE BID PRICE. LSUHSC AGENCIES ARE EXEMPT FROM ALL STATE AND LOCAL SALES AND USE TAXES.</p> <p>18. NEW PRODUCTS: UNLESS SPECIFICALLY CALLED FOR IN THE SOLICITATION, ALL PRODUCTS FOR PURCHASE MUST BE NEW, NEVER PREVIOUSLY USED, AND THE CURRENT MODEL AND/OR PACKAGING. NO REMANUFACTURED, DEMONSTRATOR, USED OR IRREGULAR PRODUCT WILL BE CONSIDERED FOR PURCHASE UNLESS OTHERWISE SPECIFIED IN THE SOLICITATION. THE MANUFACTURER'S STANDARD WARRANTY WILL APPLY UNLESS OTHERWISE SPECIFIED IN THE SOLICITATION.</p> <p>19. CONTRACT RENEWALS: UPON AGREEMENT OF LSUHSC AND THE CONTRACTOR , A TERM CONTRACT MAY BE EXTENDED FOR 4 (FOUR) ADDITIONAL 12 MONTH PERIODS AT THE SAME PRICES, TERMS AND CONDITIONS. IN SUCH CASES, THE TOTAL CONTRACT TERM CANNOT EXCEED 60 MONTHS. RS 39:1615</p> <p>20. CONTRACT CANCELLATION: TERMINATION FOR NONCOMPLIANCE: LSUHSC HAS THE RIGHT TO CANCEL ANY CONTRACT, IN ACCORDANCE WITH PURCHASING RULES AND REGULATIONS, FOR CAUSE INCLUDING BUT NOT LIMITED TO THE FOLLOWING: (1) FAILURE TO DELIVER WITHIN THE TIME SPECIFIED IN THE CONTRACT; (2) FAILURE OF THE PRODUCT OR SERVICE TO MEET SPECIFICATIONS, CONFORM TO SAMPLE QUALITY OR TO BE DELIVERED IN GOOD CONDITION; (3) MISREPRESENTATION BY THE CONTRACTOR; (4) FRAUD, COLLUSION , CONSPIRACY OR OTHER UNLAWFUL MEANS OF OBTAINING ANY CONTRACT WITH THE STATE; (5) CONFLICT OF CONTRACT PROVISIONS WITH CONSTITUTIONAL OR STATUTORY PROVISIONS OF STATE OR FEDERAL LAW; (6) ANY OTHER BREACH OF CONTRACT. FURTHER, LSUHSC MAY TERMINATE THIS CONTRACT FOR CAUSE BASED UPON THE FAILURE OF THE CONTRACTOR TO COMPLY WITH THE TERMS AND/OR CONDITIONS OF THE CONTRACT; PROVIDED THAT LSUHSC SHALL GIVE THE CONTRACTOR WRITTEN NOTICE SPECIFYING THE FAILURE. IF WITHIN THIRTY (30) DAYS AFTER RECEIPT OF SUCH NOTICE, THE CONTRACTOR SHALL NOT HAVE EITHER CORRECTED SUCH FAILURE OR, IN THE CASE WHICH CANNOT BE CORRECTED IN THIRTY (30) DAYS, BEGUN IN GOOD FAITH TO CORRECT SAID FAILURE AND THEREAFTER PROCEEDED DILIGENTLY TO COMPLETE SUCH CORRECTION, THEN LSUHSC MAY, AT ITS OPTION, PLACE THE CONTRACTOR IN DEFAULT AND THE CONTRACT SHALL TERMINATE ON THE DATE</p>	

Invitation to Bid

STANDARD TERMS & CONDITIONS

Page 5 of 10

NUMBER : 002881
OPEN DATE : 05/01/2025 TIME: 02:00 PM

BIDDER:

SPECIFIED IN SUCH NOTICE. THE CONTRACTOR MAY EXERCISE ANY RIGHTS AVAILABLE TO IT UNDER LOUISIANA LAW TO TERMINATE FOR CAUSE UPON THE FAILURE OF LSUHSC TO COMPLY WITH THE TERMS AND CONDITIONS OF THIS CONTRACT; PROVIDED THAT THE CONTRACTOR SHALL GIVE LSUHSC WRITTEN NOTICE SPECIFYING LSUHSC'S FAILURE AND A REASONABLE OPPORTUNITY FOR LSUHSC TO CURE THE DEFECT

TERMINATION FOR CONVENIENCE:

LSUHSC MAY, AT ANY TIME, TERMINATE THE CONTRACT FOR THEIR CONVENIENCE AND WITHOUT CAUSE. UPON RECEIPT OF WRITTEN NOTICE FROM LSUHSC OF SUCH TERMINATION FOR THEIR CONVENIENCE, THE CONTRACTOR SHALL: CEASE OPERATIONS AS DIRECTED BY LSUHSC IN THE NOTICE; TAKE ACTIONS NECESSARY, OR THAT LSUHSC MAY DIRECT, FOR THE PROTECTION AND PRESERVATION OF THE WORK; AND EXCEPT FOR WORK DIRECTED TO BE PERFORMED PRIOR TO THE EFFECTIVE DATE OF TERMINATION STATED IN THE NOTICE, TERMINATE ALL EXISTING SUBCONTRACTS AND PURCHASE ORDERS AND ENTER INTO NO FURTHER SUBCONTRACTS AND PURCHASE ORDERS. IN CASE OF SUCH TERMINATION FOR LSUHSC'S CONVENIENCE, THE CONTRACTOR SHALL BE ENTITLED TO RECEIVE PAYMENT FOR WORK EXECUTED. LSUHSC SHALL NOT BE RESPONSIBLE OR OTHERWISE LIABLE FOR ANY DEMOBILIZATION COSTS OR INCIDENTAL OR CONSEQUENTIAL DAMAGES RESULTING FROM SUCH TERMINATION.

TERMINATION FOR NON-APPROPRIATION OF FUNDS:

THE CONTINUATION OF THIS CONTRACT IS CONTINGENT UPON THE APPROPRIATION OF FUNDS TO FULFILL THE REQUIREMENTS OF THE CONTRACT.

21. DEFAULT OF CONTRACT:

FAILURE TO DELIVER WITHIN THE TIME SPECIFIED IN THE BID WILL CONSTITUTE A DEFAULT AND MAY CAUSE CANCELLATION OF THE CONTRACT. WHERE THE UNIVERSITY HAS DETERMINED THE CONTRACTOR TO BE IN DEFAULT, THE UNIVERSITY RESERVES THE RIGHT TO PURCHASE ANY OR ALL PRODUCTS OR SERVICES COVERED BY THE CONTRACT ON THE OPEN MARKET AND TO CHARGE THE CONTRACTOR WITH COST IN EXCESS OF THE CONTRACT PRICE. UNTIL SUCH ASSESSED CHARGES HAVE BEEN PAID, NO SUBSEQUENT BID FROM THE DEFAULTING CONTRACTOR WILL BE CONSIDERED.

22. ORDER OF PRIORITY:

IN THE EVENT THERE IS A CONFLICT BETWEEN THE INSTRUCTIONS TO BIDDERS OR STANDARD CONDITIONS AND THE SPECIAL CONDITIONS, THE SPECIAL CONDITIONS SHALL GOVERN.

23. APPLICABLE LAW:

ALL CONTRACTS SHALL BE CONSTRUED IN ACCORDANCE WITH AND GOVERNED BY THE LAWS OF THE STATE OF LOUISIANA.

24. COMPLIANCE WITH CIVIL RIGHTS LAWS:

BY SUBMITTING AND SIGNING THIS BID, BIDDER AGREES TO ABIDE BY THE REQUIREMENTS OF THE FOLLOWING AS APPLICABLE: TITLE VI AND VII OF THE CIVIL RIGHTS ACT OF 1964, AS AMENDED BY THE EQUAL OPPORTUNITY ACT OF 1972, FEDERAL EXECUTIVE ORDER 11246, FEDERAL REHABILITATION ACT OF 1973, AS AMENDED, THE VETERAN'S READJUSTMENT ASSISTANCE ACT OF 1974, TITLE IX OF THE EDUCATION AMENDMENTS OF 1972, THE AGE ACT OF 1975, AND BIDDER AGREES TO ABIDE BY THE REQUIREMENTS OF THE AMERICANS WITH DISABILITIES ACT OF 1990. BIDDER AGREES NOT TO DISCRIMINATE IN ITS EMPLOYMENT PRACTICES AND WILL RENDER SERVICES UNDER ANY CONTRACT ENTERED INTO AS A RESULT OF THIS SOLICITATION WITHOUT REGARD TO RACE, COLOR, RELIGION, SEX, AGE, NATIONAL ORIGIN, POLITICAL AFFILIATION, DISABILITY, VETERAN STATUS, OR ANY OTHER NON-MERIT FACTOR. ANY ACT OF DISCRIMINATION COMMITTED BY BIDDER, OR FAILURE TO COMPLY WITH THESE STATUTORY OBLIGATIONS WHEN APPLICABLE, SHALL BE GROUNDS FOR TERMINATION OF ANY CONTRACT ENTERED INTO AS A RESULT OF THIS SOLICITATION.

Invitation to Bid

STANDARD TERMS & CONDITIONS

Page 6 of 10

NUMBER : 002881
OPEN DATE : 05/01/2025 TIME: 02:00 PM

BIDDER:

25. SPECIAL ACCOMMODATIONS:

ANY "QUALIFIED INDIVIDUAL WITH A DISABILITY" AS DEFINED BY THE AMERICANS WITH DISABILITIES ACT WHO HAS SUBMITTED A BID AND DESIRES TO ATTEND THE BID OPENING, MUST NOTIFY THIS OFFICE IN WRITING NOT LATER THAN SEVEN DAYS PRIOR TO THE BID OPENING DATE OF THEIR NEED FOR SPECIAL ACCOMMODATIONS. IF THE REQUEST CANNOT BE REASONABLY PROVIDED, THE INDIVIDUAL WILL BE INFORMED PRIOR TO THE BID OPENING.

26. INDEMNITY:

CONTRACTOR AGREES, UPON RECEIPT OF WRITTEN NOTICE OF A CLAIM OR ACTION, TO DEFEND THE CLAIM OR ACTION, OR TAKE OTHER APPROPRIATE MEASURE, TO INDEMNIFY, AND HOLD HARMLESS, LSUHSC, ITS OFFICERS, ITS AGENTS AND ITS EMPLOYEES FROM AND AGAINST ALL CLAIMS AND ACTIONS FOR BODILY INJURY, DEATH OR PROPERTY DAMAGES CAUSED BY THE FAULT OF THE CONTRACTOR, OFFICERS, ITS AGENTS, OR ITS EMPLOYEES. CONTRACTOR IS OBLIGATED TO INDEMNIFY ONLY TO THE EXTENT OF THE FAULT OF THE CONTRACTOR, ITS OFFICERS, ITS AGENTS, OR ITS EMPLOYEES. HOWEVER, THE CONTRACTOR SHALL HAVE NO OBLIGATION AS SET FORTH ABOVE WITH RESPECT TO ANY CLAIM OR ACTION FROM BODILY INJURY, DEATH OR PROPERTY DAMAGES ARISING OUT OF THE FAULT OF THE UNIVERSITY, ITS OFFICERS, ITS AGENTS OR ITS EMPLOYEES.

27. IN ACCORDANCE WITH THE PROVISIONS OF (RS 39:2192):

IN AWARDING CONTRACTS, ANY PUBLIC ENTITY IS AUTHORIZED TO REJECT THE LOWEST BID FROM, OR NOT AWARD THE CONTRACT TO, A BUSINESS IN WHICH ANY INDIVIDUAL WITH AN OWNERSHIP INTEREST OF FIVE PERCENT OR MORE HAS BEEN CONVICTED OF, OR HAS ENTERED A PLEA OF GUILTY OR NOLO CONTENDERE TO ANY STATE FELONY CRIME OR EQUIVALENT FEDERAL FELONY CRIME COMMITTED IN THE SOLICITATION OR EXECUTION OF A CONTRACT OR BID AWARDED UNDER THE LAWS GOVERNING PUBLIC CONTRACTS UNDER THE PROVISIONS OF CHAPTER 10 OF TITLE 38 OF THE LOUISIANA REVISED STATUTES OF 1950, PROFESSIONAL, PERSONAL, CONSULTING, AND SOCIAL SERVICES PROCUREMENT UNDER THE PROVISIONS OF CHAPTER 16 OF TITLE 39, OR THE LOUISIANA PROCUREMENT CODE UNDER THE PROVISIONS OF CHAPTER 17 OF TITLE 39.

28. CERTIFICATION OF NO SUSPENSION OR DEBARMENT:

BY SIGNING AND SUBMITTING THIS BID, THE BIDDER CERTIFIES THAT THEIR BUSINESS ENTITY, ANY SUBCONTRACTORS OR PRINCIPALS ARE NOT SUSPENDED OR DEBARRED BY EITHER THE DEPARTMENT OF HEALTH AND HUMAN SERVICES, OFFICE OF INSPECTOR GENERAL (OIG) OR THE GENERAL SERVICES ADMINISTRATION (GSA) IN ACCORDANCE WITH THE REQUIREMENTS IN "AUDIT REQUIREMENTS IN SUBPART F OF THE OFFICE OF MANAGEMENT AND BUDGET'S UNIFORM ADMINISTRATIVE REQUIREMENTS, COST PRINCIPLES AND AUDIT REQUIREMENTS FOR FEDERAL AWARDS."

A LIST OF PARTIES WHO HAVE BEEN SUSPENDED OR DEBARRED CAN BE VIEWED VIA THE INTERNET AT [HTTPS://SAM.GOV](https://SAM.GOV)

IF AT ANY TIME DURING THE TERM OF THE CONTRACT AWARDED AS A RESULT OF THIS INVITATION TO BID, THIS ENTITY OR ANY OF ITS EMPLOYEES OR SUBCONTRACTORS APPEARS ON EITHER LISTING, THIS ENTITY WILL NOTIFY THE CONTRACTING AGENCY, AND THE CONTRACT WILL BE TERMINATED. THE CONTRACTING AGENCY WILL NOT BE LIABLE FOR ANY DAMAGES RESULTING FROM SAID TERMINATION.

29. FEDERAL CLAUSES (IF APPLICABLE):

ANTI-KICKBACK CLAUSE. THE CONTRACTOR HEREBY AGREES TO ADHERE TO THE MANDATE DICTATED BY THE COPELAND "ANTI-KICKBACK" ACT WHICH PROVIDES THAT EACH CONTRACTOR OR SUB GUARANTEE SHALL BE PROHIBITED FROM INDUCING BY ANY MEANS, ANY PERSON EMPLOYED IN THE COMPLETION OF WORK, TO GIVE UP ANY PART OF THE COMPENSATION TO WHICH HE IS OTHERWISE ENTITLED.

Invitation to Bid

STANDARD TERMS & CONDITIONS

Page 7 of 10

NUMBER : 002881
OPEN DATE : 05/01/2025 TIME: 02:00 PM

BIDDER:

CLEAN AIR ACT:

THE CONTRACTOR HEREBY AGREES TO ADHERE TO THE PROVISIONS WHICH REQUIRE COMPLIANCE WITH ALL APPLICABLE STANDARDS, ORDERS OR REQUIREMENTS ISSUED UNDER SECTION 306 OF THE CLEAN WATER ACT, WHICH PROHIBITS THE USE UNDER NON-EXEMPT FEDERAL CONTRACTS, GRANTS, OR LOANS OF FACILITIES INCLUDED ON THE EPA LIST OF VIOLATING FACILITIES.

ENERGY POLICY AND CONSERVATION ACT:

THE CONTRACTOR HEREBY RECOGNIZES THE MANDATORY STANDARDS AND POLICIES RELATING TO ENERGY EFFICIENCY WHICH ARE CONTAINED IN THE STATE ENERGY CONSERVATION PLAN ISSUED IN COMPLIANCE WITH THE ENERGY POLICY AND CONSERVATION ACT (P.L. 94-163)

CLEAN WATER ACT:

THE CONTRACTOR HERBY AGREES TO ADHERE TO THE PROVISIONS WHICH REQUIRE COMPLIANCE WITH ALL APPLICABLE STANDARDS, ORDERS, OR REQUIREMENTS ISSUED UNDER SECTION 508 OF THE CLEAN WATER ACT WHICH PROHIBITS THE USE UNDER NON-EXEMPT FEDERAL CONTRACTS, GRANTS, OR LOANS OF FACILITIES INCLUDED ON THE EPA LIST OF VIOLATING FACILITIES.

ANTI-LOBBYING AND DEBARMENT ACT:

THE CONTRACTOR WILL BE EXPECTED TO COMPLY WITH FEDERAL STATUTES REQUIRED IN THE ANTI-LOBBYING ACT AND THE DEBARMENT ACT.

30. ADHERENCE TO JCAHO STANDARDS:

WHERE APPLICABLE, LSUHSC IS ACCREDITED BY THE JOINT COMMISSION ON ACCREDITATION OF HEALTHCARE ORGANIZATIONS AND AS SUCH ALL CONTRACTORS, SUBCONTRACTORS, AND VENDORS AGREE TO ADHERE TO THE APPLICABLE STANDARDS PROMULGATED BY THE COMMISSION

31. IN ACCORDANCE WITH LOUISIANA LAW, ALL CORPORATIONS (RS 12:163) AND LIMITED LIABILITY COMPANIES (RS 12:1308.2) MUST BE IN GOOD STANDING WITH THE LOUISIANA SECRETARY OF STATE IN ORDER TO HOLD A CONTRACT WITH THE STATE.

32. INTERPRETATION OF DOCUMENT:

ANY INTERPRETATION OF THE BID OR QUOTATION DOCUMENT WILL ONLY BE MADE BY AN ADDENDUM ISSUED IN WRITING BY THE PURCHASING DEPARTMENT. SUCH ADDENDUM WILL BE MAILED OR DELIVERED TO EACH PERSON RECEIVING A SET OF THE ORIGINAL BID OR QUOTATION DOCUMENTS. LSUHSC WILL NOT BE RESPONSIBLE FOR ANY OTHER EXPLANATION OR INTERPRETATION OF THE DOCUMENTS.

33. THIS SOLICITATION CONTAINS ALL TERMS AND CONDITIONS WITH RESPECT TO THE PURCHASE OF THE GOODS AND OR SERVICES SPECIFIED HEREIN. SUBMITTAL OF ANY CONTRARY TERMS AND CONDITIONS MAY CAUSE YOUR BID TO BE REJECTED. BY SIGNING AND SUBMITTING A BID, VENDOR AGREES THAT CONTRARY TERMS AND CONDITIONS WHICH MAY BE INCLUDED IN ITS BID ARE NULLIFIED AND AGREES THAT THIS CONTRACT SHALL BE CONSTRUED IN ACCORDANCE WITH THIS SOLICITATION.

34. VENDORS FORMS:

THE PURCHASE/RELEASE ORDER IS THE ONLY BINDING DOCUMENT TO BE ALLOWED AGAINST THIS CONTRACT. SIGNING OF VENDOR'S FORMS IS NOT ALLOWED.

Invitation to Bid

STANDARD TERMS & CONDITIONS	Page 8 of 10
NUMBER : 002881 OPEN DATE : 05/01/2025 TIME: 02:00 PM	BIDDER:

35. PUBLICIZING AWARDS:
 IN ACCORDANCE WITH L.A.C 34:I.535, UNSUCCESSFUL BIDDERS WILL BE NOTIFIED OF THE AWARD PROVIDED THEY SUBMIT WITH THEIR BID A SELF-ADDRESSED STAMPED ENVELOPE REQUESTING THIS INFORMATION.

36. PREFERENCE:
 IN ACCORDANCE WITH LOUISIANA REVISED STATUTES 39:1595, A PREFERENCE MAY BE ALLOWED FOR PRODUCTS MANUFACTURED, PRODUCED, GROWN, OR ASSEMBLED IN LOUISIANA OF EQUAL QUALITY. DO YOU CLAIM THIS PREFERENCE?

YES _____

SPECIFY THE LINE NUMBER (S) _____

SPECIFY LOCATION WITHIN LOUISIANA WHERE THIS PRODUCT IS MANUFACTURED, PRODUCED, GROWN OR ASSEMBLED _____

(NOTE: IF MORE SPACE IS REQUIRED, INCLUDE ON SEPARATE SHEET.)

DO YOU HAVE A LOUISIANA BUSINESS WORK FORCE? YES _____ NO _____

IF SO, DO YOU CERTIFY THAT AT LEAST FIFTY PERCENT (50%) OF YOUR LOUISIANA WORKFORCE IS COMPRISED OF LOUISIANA RESIDENTS?

YES _____ NO _____

FAILURE TO SPECIFY ABOVE INFORMATION MAY CAUSE ELIMINATION FROM PREFERENCES.

PREFERENCES SHALL NOT APPLY TO SERVICE CONTRACTS.

37. AUDIT OF RECORDS: THE STATE LEGISLATIVE AUDITOR, FEDERAL AUDITORS, AND INTERNAL AUDITORS OF THE STATE SHALL HAVE THE RIGHT TO INSPECT AND AUDIT ALL TIMEKEEPING AND EXPENSE RECORDS OF THE CONTRACTING ENTITY OR ANY SUBCONTRACTOR OF THE CONTRACTING ENTITY TO SUBSTANTIATE AMOUNTS INVOICED BY SUPPLIER WITH RESPECT TO THIS AGREEMENT. THE RIGHTS OF INSPECTION AND AUDIT SHALL COMMENCE AS OF THE DATE OF THIS AGREEMENT AND SHALL CONTINUE FOR A PERIOD OF FIVE (5) YEARS AFTER PROJECT ACCEPTANCE OR AS REQUIRED BY APPLICABLE STATE AND FEDERAL LAW. THE CONTRACTING ENTITY AND ANY SUBCONTRACTOR OF THE CONTRACTING ENTITY SHALL MAINTAIN ALL TIMEKEEPING AND EXPENSE RECORDS RELATED TO THIS AGREEMENT FOR THE ENUMERATED FIVE (5) YEAR PERIOD.

38. CONFIDENTIALITY: CONTRACTOR SHALL PROTECT FROM UNAUTHORIZED USE AND DISCLOSURE ALL INFORMATION RELATING TO THE STATE'S OPERATIONS AND DATA (E.G. FINANCIAL, STATISTICAL, PERSONAL, TECHNICAL, ETC.) THAT BECOMES AVAILABLE TO THE CONTRACTOR IN CARRYING OUT THIS CONTRACT. CONTRACTOR SHALL USE PROTECTING MEASURES THAT ARE THE SAME OR MORE EFFECTIVE THAN THOSE USED BY THE STATE. CONTRACTOR IS NOT REQUIRED TO PROTECT INFORMATION OR DATA THAT IS PUBLICLY AVAILABLE OUTSIDE THE SCOPE OF THIS CONTRACT; ALREADY RIGHTFULLY IN THE CONTRACTOR'S POSSESSION; INDEPENDENTLY DEVELOPED BY THE CONTRACTOR OUTSIDE THE SCOPE OF THIS CONTRACT; OR RIGHTFULLY OBTAINED FROM THIRD PARTIES.

39. CYBERSECURITY TRAINING: IN ACCORDANCE WITH LA. R.S. 42:1267(B)(3) AND THE STATE OF LOUISIANA'S INFORMATION SECURITY POLICY, IF THE CONTRACTOR, ANY OF ITS EMPLOYEES, AGENTS, OR SUBCONTRACTORS WILL HAVE ACCESS TO STATE GOVERNMENT INFORMATION TECHNOLOGY ASSETS, THE CONTRACTOR'S EMPLOYEES, AGENTS, OR SUBCONTRACTORS WITH SUCH ACCESS MUST COMPLETE CYBERSECURITY TRAINING ANNUALLY, AND THE CONTRACTOR MUST PRESENT EVIDENCE OF SUCH COMPLIANCE ANNUALLY AND UPON REQUEST. THE CONTRACTOR MAY USE THE CYBERSECURITY TRAINING COURSE OFFERED BY THE LOUISIANA DEPARTMENT OF STATE CIVIL SERVICE WITHOUT ADDITIONAL COST OR MAY USE ANY ALTERNATE COURSE APPROVED IN WRITING BY THE OFFICE OF TECHNOLOGY SERVICES.

Invitation to Bid

STANDARD TERMS & CONDITIONS	Page 9 of 10
NUMBER : 002881 OPEN DATE : 05/01/2025 TIME: 02:00 PM	BIDDER:
<p>FOR PURPOSES OF THIS SECTION, "ACCESS TO STATE GOVERNMENT INFORMATION TECHNOLOGY ASSETS" MEANS THE POSSESSION OF CREDENTIALS, EQUIPMENT, OR AUTHORIZATION TO ACCESS THE INTERNAL WORKINGS OF STATE INFORMATION TECHNOLOGY SYSTEMS OR NETWORKS. EXAMPLES WOULD INCLUDE BUT NOT BE LIMITED TO STATE-ISSUED LAPTOPS, VPN CREDENTIALS TO ACCESS THE STATE NETWORK, BADGING TO ACCESS THE STATE'S TELECOMMUNICATIONS CLOSETS OR SYSTEMS, OR PERMISSIONS TO MAINTAIN OR MODIFY IT SYSTEMS USED BY THE STATE. FINAL DETERMINATION OF SCOPE INCLUSIONS OR EXCLUSIONS RELATIVE TO ACCESS TO STATE GOVERNMENT INFORMATION TECHNOLOGY ASSETS WILL BE MADE BY THE OFFICE OF TECHNOLOGY SERVICES.</p>	

LSU Health Sciences Center – New Orleans

Air Filter Changing

Invitation to Bid # 002881

Deadline for bid submission will be May 1, 2025 @ 2:00PM (central)

There will be a mandatory pre-bid meeting on April 15, 2025 @ 10:00 AM

SECTION 1 – BIDDING AND CONTRACT DOCUMENTS

1.1 Definitions:

Bidder – a legal entity that submits an offer to sell to the Owner on a specified body of work. Generally where the term “Bidder” is used in the specifications, the indication is that the requirement or responsibility is associated with the bid submittal or other pre-award activities.

Supplier – vendor that performs the services as specified herein. The term “Supplier” can also be used in the specification as an inclusive term that references the Supplier and all persons, or other parties of interest acting on behalf of the Supplier in the performance of the contract as described in the specifications.

1.2 Interpretation of Documents and Prior Approvals:

If there is any doubt of the meaning of any part of the specifications, and/or desires approval of “equivalent” equipment they must submit to Patrick Defourneaux via e-mail at pdefou@lsuhsc.edu a written request for an interpretation or prior approval not later than 12pm (central) on April 18, 2025. A response will be made by addendum issued to each bidder receiving a set of the specifications. LSUHSC will not be responsible for any other explanations or interpretation of the specifications or proposed documents.

1.3 Pre-Bid Conference:

A **mandatory Pre-Bid Conference** will be held on **Tuesday, April 15, 2025, beginning at 10:00 AM at at Allied Health/School of Nursing Building, 1st floor, room 147 (Seminar Room 2), 1900 Gravier Street, New Orleans, LA 70112.** The purpose of the Pre-Bid Conference is to familiarize Bidders with the requirements and intent of the contract and to receive comments and information from interested Bidders. No questions will be accepted at the pre-bid meeting. All questions must be submitted in writing and will be answered via addendum.

Attendance at the Pre-Bid Conference is required in order to submit a bid and failure to attend will be grounds for rejection of the bid. Anyone arriving 15 minutes after the start of the meeting will be disqualified from the bid. A representative of LSUHSC will have a sign-in sheet to verify the site visit. All bidders must visit the site to determine the scope of the job.

No allowances for previously existing site conditions will be made after the bid. It is the responsibility of the bidder to thoroughly inspect the site to determine any and all factors, which will affect the bid.

Any revision of the Bidding Documents made as a result of the Pre-Bid Conference shall not be valid unless included in an addendum.

1.4 Bidder's Representation:

Each Bidder by his bid represents the following:

- Bidder has read and understands the Bidding Documents and his or her bid is made in accordance therewith.
- Bidder's bid is based solely upon the materials, systems and services described in the Bidding Documents as advertised and as modified by addenda.
- Bid is not based on any verbal instructions contrary to the Contract Documents and addenda

1.5 Bidding Procedure & Bid Submission:

Bidders must properly complete and sign Bid, including all required attestations and addenda. Any exceptions to the attached terms and conditions or the indemnification agreement shall be presented at the time of the bid submission. Note that any exceptions may result in a disqualified bid if the aforementioned exceptions are in conflict with state guidelines governing LSUHSC. Bids must be signed by a representative of your company authorized to enter into contracts on behalf of your organization in accordance with Louisiana R.S. 39:1594.

These documents must be included with the bid:

1. Signed Invitation to Bid Document
2. 3 References per Section 3.4.B
3. Completed Bidders Price Sheet
4. Supplier Quote to match
5. Certificate of Liability Insurance
6. Signed Attachment A: CERTIFICATION STATEMENT
7. Signed Attachment B: INDEMNIFICATION AGREEMENT
8. Signed Attachment C: EQUAL EMPLOYMENT OPPORTUNITY CLAUSE
9. Signed Attachment D: AFFIRMATIVE ACTION COMPLIANCE
10. Addenda requiring a signature (if any are issued)

All bids are due by 2:00 PM central, Thursday, May 1, 2025

at 433 Bolivar Street, Room 623 (Purchasing Department), New Orleans, LA 70112.

Late bids will not be accepted and will be returned unopened.

It is the bidder's responsibility to make sure bids are delivered before the bid opening.

Fax or e-mail bids will not be accepted.

Delays by mail, traffic, or any other reason will be at the bidders own risk.

Submitted sealed bids must be time stamped in our office before 2:00pm on the day listed above.

The bid package must be delivered at the Bidder's expense to:

Patrick Defourneaux
Procurement Analyst, LSU Health Sciences Center
433 Bolivar St.
6th Floor, Purchasing Dept - Room 623
New Orleans, LA 70112
Office phone: 504-568-2947
Email: pdefou@lsuhsc.edu

BIDS SHALL BE DELIVERED IN A SEALED ENVELOPE WITH THE BID NUMBER CLEARLY MARKED ON THE OUTSIDE OF THE ENVELOPE.

In accordance with R.S. 39:1581, Chapter 5, Section 521C of the Louisiana State Purchasing Rules and Regulations, when an error is made in extending total prices, the unit bid price will govern.

Award: LSUHSC-NO will award to the lowest responsive and responsible bidder based on the unit pricing of any and all items.

1.6 Calendar of Events:

Event

Date

Mandatory Pre-Bid Meeting 10am

April 15, 2025

Written Inquiry Deadline (12:00pm central)

April 18, 2025

Bid Submission Deadline (2:00pm central)

May 1, 2025

NOTE: LSUHSC reserves the right to amend and/or change this schedule of ITB activities, as it deems necessary.

1.7 Minimum Insurance Requirements:

Selected bidder(s) shall maintain the following minimum insurance coverage throughout the duration of the contract:

- Commercial General Liability: \$1,000,000 combined single limit per occurrence for bodily injury, personal injury and property damage.
- Automobile Liability: \$1,000,000 combined single limit per accident, for bodily injury and property damage.
- Workers Compensation and Employers Liability: Workers' Compensation limits as required by the Labor Code of the State of Louisiana and Employers Liability coverage. Exception: Employers liability limit is to be \$1,000,000 when work is to be over water and involves maritime exposure.

A Certificate of Liability Insurance must be provided with bid. For further insurance requirements and provisions, see Attachment E – Insurance Requirements.

1.8 Compliance with Applicable Laws and Regulations:

Supplier shall perform all requirements under this contract in strict observance of and in compliance with all applicable laws, regulations, ordinances, codes and any other legislative or statutory requirements. Supplier warrants the performance of services under this contract shall be fully compliant with the current requirements of the Occupational Safety and Health Act (OSHA) to include as it may be amended throughout the term of this contract. Supplier shall take precautions to insure work is performed in compliance with occupational safety standards. Supplier shall obtain all permits and licenses and pay all taxes, charges and fees necessary to perform the services under this contract.

1.9 Resolving Contract Disputes:

State statute requires that disputes arising under this contract not be resolved in a forum outside of Louisiana. Requiring contract disputes to be resolved in a forum outside of this state or requiring their interpretation to be governed by the laws of another jurisdiction, are inequitable and against the public policy of this state.

1.10 Late Payment Policy:

State statute RS 39:1695 requires that if a state agency fails to make any payment within 90 days of the due date, that agency shall pay, in addition to the payment, interest on the amount due at the rate established pursuant to Civil Code Article 2824 (B) (3) per year, from the 91st day after the due date.

ATTACHMENT A: CERTIFICATION STATEMENT

OFFICIAL CONTACT. The State requires that the Provider designate one person to receive all documents and the method in which the documents are best delivered. Identify the Contact name and fill in the information below: (Print Clearly):

Date: _____ Official Contact Name: _____

A. E-mail Address: _____

B. Facsimile Number with area code: (____) _____

C. US Mail Address: _____

D. Telephone Number: _____

Provider certifies that the above information is true and grants permission to the State or Agencies to contact the above named person or otherwise verify the information I have provided.

By its submission of this proposal and authorized signature below, Provider certifies that:

- (1) The information contained in its response to this RFQ is accurate;
- (2) Provider warrants that, to the best of his/her/its knowledge and belief, there are no relevant facts which could give rise to organizational conflicts of interest or that the Provider has disclosed all potential or actual organizational conflicts of interest. The Provider agrees that if it becomes the Selected Provider and an organizational conflict of interest with respect to this contract is then discovered, an immediate and full disclosure in writing shall be made to the LSUHSC-NO which shall include a description of the action which the Provider has taken or will take to avoid or mitigate such conflicts. In the event that the successful Provider knowingly failed to disclose a conflict, LSUHSC-NO may immediately terminate the contract for default. Provider certifies that its personnel, who perform work under this contract, have been informed of their obligations to report personal and organizational conflicts of interest to the Provider. The term of this prohibition shall endure for the entire period of this contract and for two (2) years thereafter.
- (3) Provider complies with each of the mandatory requirements listed in the RFQ and will meet or exceed the deliverables specified therein;
- (4) Provider accepts the procedures, contract terms and conditions, and all other administrative requirements set forth in this RFQ.
- (5) Provider's quote is valid for at least thirty (30) days from the date of Provider's signature below;
- (6) Proposer certifies and agrees that the following information is correct: In preparing its response, the Proposer has considered all proposals submitted from qualified, potential subcontractors and suppliers, and has not, in the solicitation, selection, or commercial treatment of any subcontractor or supplier, refused to transact or terminated business activities, or taken other actions intended to limit commercial relations, with a person or entity that is engaging in commercial transactions in Israel or Israeli-controlled territories, with the specific intent to accomplish a boycott or divestment of Israel. Proposer also has not retaliated against any person or other entity for reporting such refusal, termination, or commercially limiting actions. The State reserves the right to reject the response of the proposer if this certification is subsequently determined to be false, and to terminate any contract awarded based on such a false response.

Authorized Signature: _____

Typed or Printed Name: _____

Title: _____

Company Name: _____

Address: _____

City: _____ State: _____ Zip: _____

SIGNATURE of Provider's Authorized Representative

DATE

ATTACHMENT B - INDEMNIFICATION AGREEMENT

The Selected Provider/Subsupplier agrees to protect, defend, indemnify, save, and hold harmless LSUHSC-NO, State of Louisiana, all State Departments, Boards, and Commissions, officers, agents, servants, and employees, including volunteers, from and against any and all claims, demands, expense, and liability arising out of injury or death to any person or the damage, loss or destruction of any property which may occur or in any way grow out of any act or omission of Selected Provider/Subsupplier, its agents, servants, and employees or any and all costs, expense, and/or attorney fees incurred by Selected Provider/Subsupplier, as a result of any claims, demands, and/or causes of action except of those claims, demands, and/or causes of action arising out of the negligence of LSUHSC-NO, State of Louisiana, all State Departments, Boards, Commissions, its agents, representatives, and/or employees. Selected Provider/ Subsupplier agrees to investigate, handle, respond to, provide defense for and defend any such claim, demand, or suit at its sole expense and agrees to bear all other costs and expenses related thereto, even if any such claim, demand, or suit is groundless, false, or fraudulent.

LSUHSC-NO shall not be responsible or held liable for any injury or damage to persons or property resulting from the use, misuse, or failure of any equipment used by the Selected Provider or any of the Selected Provider's agents, servants, or employees, even if such equipment is furnished by LSUHSC-NO to the Selected Provider. The acceptance or use of any such equipment by the Selected Provider shall be construed to mean that the Selected Provider accepts full responsibility for, and agrees to indemnify and to defend LSUHSC-NO against any and all loss, liability, and claims for any injury or damage whatsoever resulting from the use, misuse, or failure of such equipment, whether such damage or injury is to an employee, agent, or servant, or the property of the Selected Provider, other suppliers or subsuppliers, LSUHSC-NO, or other persons.

Accepted by: Company _____
Name _____
Signature _____
Title _____
Date _____

Is Certificate of Insurance Attached? _____ Yes _____ No

ATTACHMENT C: EQUAL EMPLOYMENT OPPORTUNITY CLAUSE

As required by U.S. Labor Department, Office of Federal Contract Compliance, Section 60-1.4.

During the performance of this contract, the successful bidder (service provider or vendor) agrees as follows:

- (1) The Service provider will not discriminate against any employee or applicant for employment because of race, color, religion, sex, or national origin. The Service provider will take affirmative action to ensure that applicants are employed, and that employees are treated during employment, without regard to their race, color, religion, sex, or national origin. Such action shall include, but not be limited to the following: Employment, upgrading, demotion, or transfer, recruitment advertising, layoff or termination, rates of pay or other forms of compensation, and selection for training, including apprenticeship. The Service provider agrees to post in conspicuous places, available to employees and applicants for employment, notices to be provided by the contracting offer setting forth the provision of this non-discrimination clause.
- (2) The Service provider will, in all solicitations or advertisements for employees placed by or on behalf of the Service provider, state that all qualified applicants will receive consideration for employment without regard to race, color, religion, sex or national origin.
- (3) The Service provider will send to each labor union or representative of workers with which he has a collective bargaining agreement or other contract or understanding, a notice to be provided by the agency contracting officer, advising the labor union or workers' representative of the Service provider's commitments under section 202 of Executive Order 11246 of September 24, 1965, and shall post copies of the notice in conspicuous places available to employees and applicants for employment.
- (4) The Service provider will comply with all provisions of Executive Order 11246 of September 24, 1965, and of the rules, regulations, and relevant orders of the Secretary of Labor.
- (5) The Service provider will furnish all information and reports required by Executive Order 11246 of September 24, 1965, and by the rules, regulations, and orders of the Secretary of Labor, or pursuant thereto, and will permit access of his books, records, and accounts by the contracting agency and the Secretary of Labor for purposes of investigation to ascertain compliance with such rules, regulations, and orders.
- (6) In the event of the Service provider's noncompliance with the non-discrimination clauses of this contract or with any of such rules, regulations, or orders, this contract may be canceled, terminated or suspended in whole or in part and the Service provider may be declared ineligible for further Government contracts in accordance with procedures authorized in Executive Order 11246 of September 24, 1965, and such other sanctions may be imposed and remedies invoked as provided in Executive Order 11246 of September 24, 1965, or by rule, regulation, or order of the Secretary of Labor, or as otherwise provided by law.
- (7) The Service provider will include the provisions of paragraphs (1) through (7) in every subcontract or purchase order unless exempted by rules, regulations, or orders of the Secretary of Labor issued pursuant to section 204 of Executive Order 11246 of September 24, 1965, so that such provisions will be binding upon each subservice provider or vendor. The Service provider will take such action with respect to any subcontract or purchase order as the contracting agency may use direct as a means of enforcing such provisions including sanctions for noncompliance: Provided, however, that in the event the Service provider becomes involved in, or is threatened with, litigation with the subservice provider or vendor as a result of such direction by the contracting agency, the Service provider may request the United States to enter into such litigation to protect the interests of the United States.

Assurance

The bidder (offeror or applicant) assures Board of Supervisors of Louisiana State University and Agricultural and Mechanical College that he does not and will not maintain or provide for his employees any segregated facilities at any of his establishments, and that he does not and will not permit his employees to perform their services at any location, under his control, where segregated facilities are maintained. The bidder (offeror or applicant) understands that the phrase "segregated facilities" includes facilities which are in fact segregated on a basis of race, color, creed, or national origin, because of habit, local custom, or otherwise. The bidder (offeror or applicant) understands and agrees that maintaining or providing segregated facilities for his employees or permitting his employees to perform their services at any locations, under his control, where segregated facilities are maintained is a violation of the equal opportunity clause required by Executive Order 11246 of September 24, 1965.

The bidder (offeror or applicant) further understands and agrees that a breach of the assurance herein contained subjects him to the provisions of Orders of the Secretary of Labor dated May 9, 1967, and the provisions of Orders of the Secretary of Labor dated May 9, 1967, and the provisions of equal opportunity clause enumerated in contract between Board of Supervisors of Louisiana State University and Agricultural and Mechanical College and bidder (offeror or applicant).

Whoever knowingly and willfully makes any false, fictitious, or fraudulent representation may be liable to criminal prosecution under 18 U.S.C. Section 1001.

Vendor Signature _____ (must be signed by an authorized Executive Official)

Name & Title : _____

Date: _____

ATTACHMENT D: AFFIRMATIVE ACTION COMPLIANCE

(a) **REQUIREMENTS OF PROGRAMS.** In accordance with Section 60-1.4 of Chapter 60 of Title 41 of the Code of Federal Regulations, as amended, the Seller shall develop and shall require each of its lower-tier subservice providers hereunder who has 50 or more employees and a subcontract of \$50,000 or more to develop a written affirmative action compliance program for each of its establishments. A necessary prerequisite to the development of a satisfactory affirmative action program is the identification and analysis of problem areas inherent in minority employment and an evaluation of opportunities of utilization of minority group personnel. The Seller's and each of its nonexempt lower-tier subservice provider's programs shall provide in detail for specific steps to guarantee equal employment opportunity keyed to the problems and needs of members of minority groups, including, when there are deficiencies, the development of specific goals and timetables for the prompt achievement of full and equal employment opportunity. The Seller and each of its nonexempt lower-tier subservice providers shall include in his affirmative action compliance program a table of job classifications. This table should include but not be limited to job titles, principal duties (and auxiliary duties if any), rates of pay, and where more than one rate of pay applies (because of length of time in job or other factors), the applicable rates. The affirmative action compliance program shall be signed by an executive official of the Seller or lower-tier subservice provider as the case may be.

(b) **UTILIZATION EVALUATION.** The evaluation of utilization of minority group personnel shall include the following:

- (1) An analysis of minority group representation in all job categories.
- (2) An analysis of hiring practices for the past year, including recruitment sources and testing, to determine whether equal employment opportunity is being afforded in all job categories.
- (3) An analysis of upgrading, transfer and promotion for the past year to determine whether equal employment opportunity is being afforded.

(c) **MAINTENANCE OF PROGRAMS.** Within 120 days from the commencement of the applicable purchase order of the lower-tier subcontract hereunder, the Seller and each nonexempt lower-tier subcontract hereunder shall maintain a copy of separate affirmative action compliance programs for each establishment, including evaluations of utilization of minority group personnel and the job classification tables, at each local office responsible for the personnel matters of such establishment. An affirmative action compliance program shall be part of the manpower and training plans for each new establishment and shall be developed and made available prior to the staffing of such establishment. A report of the results of such program shall be compiled annually and the program shall be updated at that time. This information shall be made available to representative of the agency or director upon request and the Seller's and each nonexempt lower-tier subservice provider's affirmative action program and the results it produces shall be evaluated as part of compliance review activities.

Vendor Signature _____ (must be signed by an authorized Executive Official)

Name & Title : _____

Date: _____

ATTACHMENT E – INSURANCE REQUIREMENTS

INSURANCE REQUIREMENTS FOR SUPPLIERS

Supplier shall procure and maintain for the duration of the contract insurance against claims for injuries to persons or damages to property which may arise from or in connection with the performance of the work hereunder by the Supplier, his agents, representatives, employees, or subsuppliers.

A. MINIMUM SCOPE OF INSURANCE

Coverage shall be at least as broad as:

1. Insurance Services Office form number GL 002 (Ed. 1/73) covering Comprehensive General Liability and Insurance Services Office form number GL 0404 covering Broad Form Comprehensive General Liability; or Insurance Services Office Commercial General Liability coverage (occurrence form CG 0001). **"Claims Made" form is unacceptable. The "occurrence form" shall not have a "sunset clause".**
2. Insurance Services Office form number CA 0001 (Ed. 1/78) covering Automobile Liability, code 1 "any auto" and endorsement CA 0025.
3. Workers' Compensation Insurance as required by the Labor Code of the State of Louisiana, including Employers Liability insurance.

B. MINIMUM LIMITS OF INSURANCE

Supplier shall maintain limits no less than:

1. Commercial General Liability: \$1,000,000 combined single limit per occurrence for bodily injury, personal injury and property damage (or higher limits depending on size of contract).
2. Automobile Liability: \$1,000,000 combined single limit per accident, for bodily injury and property damage.
3. Workers Compensation and Employers Liability: Worker's Compensation limits as required by the Labor Code of the State of Louisiana and Statutory Employers Liability limits. Exception: Employers liability limit is to be \$1,000,000 when work is to be over water and involves maritime exposure.

C. DEDUCTIBLES AND SELF-INSURED RETENTIONS

Any deductibles or self-insured retention's must be declared to and approved by the University. At the option of the University, either: the insurer shall reduce or eliminate such deductibles or self-insured retention's as respects the University, its officers, officials, employees and volunteers; or the Supplier shall procure a bond guaranteeing payment of losses and related investigations, claim administration and defense expenses.

D. OTHER INSURANCE PROVISIONS

The policies are to contain, or be endorsed to contain, the following provisions:

1. General Liability and Automobile Liability Coverage
 - a. The University, its officers, officials, employees, Boards and Commissions and volunteers are to be added as "additional insured" as respects liability arising out of activities performed by or on behalf of the Supplier; products and completed operations of the Supplier, premises owned, occupied, or used by the Supplier. The coverage shall contain no special limitations on the scope of protection afforded to the University, its officers, officials, employees or volunteers. It is understood that the business auto policy under "Who is an Insured" automatically provides liability coverage in favor of the University.
 - b. The Supplier's Insurance coverage shall be primary insurance as respects the University, its officers, officials, employees and volunteers. Any insurance or self-insurance maintained by the University, its officers, officials, employees or volunteers shall be excess of the Supplier's insurance and shall not contribute with it.
 - c. Any failure to comply with reporting provisions of the policy shall not affect coverage provided to the University, its officers, officials, employees, Boards and Commissions, or volunteers.
 - d. The Supplier's insurance shall apply separately to each insured against whom claim is made or suit is brought, except with respect to the limits of the insurer's liability.
2. Worker's Compensation and Employers Liability Coverage

The insurer shall agree to waive all rights of subrogation against the University, its officers, officials, employees and volunteers for losses arising from work performed by the Supplier for the University.
3. All Coverage's

Each insurance policy required by this clause shall be endorsed to state that coverage shall not be suspended, voided, canceled by either party, reduced in coverage or in limits except after thirty (30) days' prior written notice by certified mail, return receipt requested, has been given to the University.

E. ACCEPTABILITY OF INSURERS

Insurance is to be placed with insurers with an A.M. Best's rating of no less than A-:VI. This requirement will be waived for workers' compensation coverage only for those suppliers whose workers' compensation coverage is placed with companies who participate in the State of Louisiana Workers' Compensation Assigned Risk Pool.

F. VERIFICATION OF COVERAGE

Supplier shall furnish the University with certificates of insurance effecting coverage required. The certificate for each insurance policy is to be signed by a person authorized by that insurer to bind coverage on its behalf. The University reserves the right to require complete, certified copies of all required insurance policies, at any time.

ATTACHMENT F – Request For Supplier Diversity Certifications

Louisiana State University is committed to fostering innovation and entrepreneurship through the use of diverse suppliers and the goal of the diversity initiative is to identify, align, strengthen and connect with diverse suppliers.

If your company holds a small business and or supplier diversity certification(s) please email them to me for inclusion in our supplier database. Examples are listed below.

AbilityOne: formerly Javits-Wagner-O'Day or JWOD

Creates jobs and training opportunities for people who are blind or who have other severe disabilities. Javits-Wagner-O'Day Act of 1971, 41 U.S.C. 46-48c, the AbilityOne Program is a mandatory source of supply for Federal employees

Disadvantaged Business Enterprise: DBE

The US Department of Transportation offers the certification for small socially and economically disadvantaged businesses.

Disabled Veteran Owned Small Business: DVOSB

Emerging Business Enterprise: EBE

Lesbian, Gay, Bisexual and Transgender-Owned Business: LGBTBE

Minority-Owned Business Enterprise: MBE

Certified by LA Minority Supplier Development Council; National Minority Supplier Development Council; other certification entities

Small Business Enterprise: SBE

Small Disadvantaged business: SDB

Certified by the Federal Small Business Association

Service- Connected Disabled Veteran-Owned Entrepreneurship: SDVB

Certified by the Louisiana Economic Development office

Small & Emerging Business Development program: SEBD

Certified by the Louisiana Economic Development office

Small Entrepreneurship/ Hudson Initiative: SE

Certified by the Louisiana Economic Development office

Veteran Owned Small Business: VOSB

Veteran Initiative/Veteran Owned Small Entrepreneurship : VSE

Certified by the Louisiana Economic Development office

Woman-Owned Business Enterprise: WBE

Certified by the Women's Business Enterprise National Council, Women's Business Enterprise Council South; other certification entities

SECTION 2 – GENERAL INFORMATION

2.1 SERVICE PROVIDER EQUIPMENT, TOOLS & SUPPLIES

- A. The total bid price for the services specified herein shall include all costs to the Service Provider for furnishing all equipment (Service Provider–owned and/or rental), tools and supplies necessary to provide the air filter changing services as described in these specifications.
- B. All equipment, tools and supplies used must be capable of performing all operations in accordance with specifications.
 - 1. All tools and equipment belonging to the Service Provider will not be left unattended in a public area for any time for any reason.
 - a. All tools and equipment will be removed from the work area when not occupied.
 - b. The tools and equipment may be neatly stored in a secure location only if such a location is identified by the designated LSUHSC-NO representative.
- C. All tools, equipment and vehicles used on and around LSUHSC-NO property shall be of a suitable type and construction, safe in use, properly maintained and shall conform to all applicable federal, state and local regulations governing the operation of such tools, equipment and vehicles.
 - 1. The Service Provider shall ensure all manufacturer equipped guards, shields, deflectors, safety switches, seat belts, harnesses and other safety features are in place and functional at all times equipment is in use.
 - 2. The Service Provider will further ensure that all replacement materials and all installation methods meet all original manufacturer's specifications.
 - 3. LSUHSC-NO reserves the right to inspect any and all tools, equipment and vehicles to verify compliance with regulations and the specifications defined within this document.
 - 4. The Service Provider will be instructed to remove from the LSUHSC-NO property any tools, equipment or vehicles found to be insufficient to safely perform this work.

2.2 MATERIAL SAFETY DATA SHEETS

- A. Prior to starting, the Service Provider must provide Safety Data Sheets (SDS) for all potentially hazardous products to be provided by the Service Provider and used on site.

2.3 SAFETY

- A. All work will be conducted in accordance with all current OSHA and other applicable federal, state and local regulations. The Service Provider will also

comply with the LSUHSC-NO Service Provider Safety Guidebook and the policies it references. The guidebook can be found at <http://www.is.lsuhs.edu/safety/pdf/csg.pdf>. The Service Provider will be required to sign a form acknowledging receipt of, and compliance with, the guidebook.

- B. No part of this work shall be performed at any location in any manner which may endanger the health, safety or welfare of the public, faculty, staff, students or Service Provider employees now or in the future.
 - 1. Work shall be done in such a manner so as to create a safe working and walking environment for occupants in or adjacent to the work area.
 - 2. Work shall be done in a manner as to be of little disruption to campus occupants.
 - 3. Work shall be done in a manner that does not compromise the security of the work area or the occupants.
 - 4. Means, methods, techniques, sequencing, etc. are the sole responsibility of the Service Provider.
- C. When working above any area where people might cross below workers:
 - 1. Service Provider must neatly and professionally cordon off area(s) using commercially-produced barricade equipment (e.g. no buckets, wood sawhorses, wood stakes) and post professionally-fabricated signs (e.g. no hand written/stenciled or spray painted signs) for indicating the area(s) is/are closed to pedestrian traffic.
 - 2. Signs must be of sufficient size with specific wording to clearly indicate that work is occurring above.
 - 3. Should barricading alone prove ineffectual in keeping pedestrians from entering these closed areas, Service Provider must post an employee to direct pedestrians around the work area.
- D. Service Provider personnel will possess and use any and all relevant personal protective equipment (PPE) while engaging in work on the LSUHSC-NO property.
 - 1. Such equipment may include fall protection equipment, eye and hearing protection, and may include specialized clothing and footwear if conditions warrant.
 - 2. Should the Service Provider furnish reflective safety vests, all vests worn by Service Provider personnel will be uniform in appearance.
- E. Failure to adhere to any or all safety requirements could result in the assessment of monetary penalties (see Section 2.15) or possibly the cancellation of the entire service contract.

2.4 LAWS, CODES, ORDINANCES, LICENSES AND CERTIFICATIONS

- A. Any requirement of this specification which conflicts with or is in violation of any government rule, ordinance, regulation, etc. shall be void. The Service Provider shall notify the designated LSUHSC-NO representative immediately of any such requirement found in this specification.
- B. Service Provider personnel shall, throughout the course of all work, comply with all rules, ordinances, regulations, etc. set forth by agencies having jurisdiction, which apply to the work site, the Service Provider, and/or the Service Provider's employees.
- C. All Service Provider employees requiring a license or certification by the State of Louisiana, Orleans Parish and/or the City of New Orleans to perform any duties specified herein must provide documented proof to show such license or certification is current at the outset of this service contract and each year thereafter at the annual renewal of the service contract.

2.5 DAMAGE

- A. The Service Provider will be responsible for all repair/replacement costs associated with any damage to LSUHSC-NO buildings, building contents, exterior infrastructure, equipment, vehicles or landscaping incurred due to negligent actions by Service Provider personnel.
- B. The Service Provider will immediately notify the designated LSUHSC-NO representative when damage of any kind occurs.
- C. Claims of damage to private property or vehicles adjoining LSUHSC-NO property or private vehicles located on LSUHSC-NO property will be resolved directly by the Service Provider and the owner of the private property or vehicle.
 - 1. LSUHSC-NO will not act in any way as an intermediary between the two parties.

2.6 PERSONNEL

- A. The bid prices submitted for the services specified herein shall include all costs to the Service Provider for furnishing personnel to perform air filter changing services on the LSUHSC-NO campuses.
- B. The Service Provider shall have in their employ, or under their control, sufficient qualified and competent personnel to perform all tasks promptly and in accordance with service contract specifications.
- C. The Service Provider shall utilize, on this service contract, only workers that are skilled in the tasks to which they are assigned.
 - 1. The Service Provider warrants to LSUHSC-NO that the workers used on the job are regularly employed by the service provider company or the Sub-Service Provider's company or companies.

- D. LSUHSC-NO reserves the right to examine the Service Provider's past payroll records and those of any Sub-Service Provider to determine whether the employees being used on the service contract are regularly employed.
- E. LSUHSC-NO reserves the right to question the use of an employee whom LSUHSC-NO feels is unskilled or untrained on a task that requires a skill.
- F. LSUHSC-NO retains the right to require the Service Provider to remove a Service Provider employee or employees as LSUHSC-NO may deem necessary.
 - 1. Reasons for this request may be, but are not limited to: poor work performance, incompetence, carelessness, disruptive or otherwise objectionable behavior.
 - 2. Service Provider crews will be working on tobacco-free campuses (no cigarettes, cigars, pipe tobacco, chewing tobacco, snuff, etc.).
 - a. The Service Provider will be required to immediately remove any Service Provider employee from any LSUHSC-NO property who violates the no-tobacco rule.
 - 3. The Service Provider will be required to immediately remove any Service Provider employee from any LSUHSC-NO property who reports to the site manifesting evidence of being under the influence of alcohol or illegal drugs.
 - 4. A request to remove a Service Provider employee is in no way a call for dismissal – it is just a request for the individual to be reassigned away from LSUHSC-NO properties.
 - 5. If the Service Provider is requested to replace any employee, any time lost on the job shall be the responsibility of the Service Provider and shall not be an acceptable reason for requesting extensions of the completion deadline or tasks assigned under this service contract.
- G. Service Provider employees assigned to this contract shall not cause work stoppage or delays on other contracts awarded to the Service Provider for work on LSUHSC-NO properties.
- H. The service provider shall ensure their employees are TB tested and show proof of passing TB test every 6 months.

2.7 SUPERVISION

- A. The Service Provider shall provide all supervision on-site to coordinate and inspect work.
- B. There will be a supervisor or point-of-contact (working foreman is acceptable) readily available to the designated LSUHSC-NO representative when work is being performed.

1. The Service Provider on-site supervisor / foreman shall check-in with designated LSUHSC-NO representative daily (in person or by telephone) prior to starting work.
2. The on-site supervisor / foreman will also contact the designated LSUHSC-NO representative for inspection after completing the work or leaving for the day.

2.8 PERFORMANCE

- A. Work will be performed during both regularly-scheduled daytime working hours and pre-arranged evening/Saturday hours in coordination with the designated LSUHSC-NO representative.
- B. LSUHSC-NO requires quality work performed in a competent manner.
 1. All Service Provider non-supervisory workers shall be required to perform all relevant tasks without direction by LSUHSC-NO personnel.
- C. LSUHSC-NO will be the sole judge concerning the merits of services(s) provided in accordance with specifications set forth in this document, or if it is determined the Service Provider is operating in violation of federal, state and local applicable laws and ordinances.
 1. No latitude will be given for failure to perform properly.
- D. The Service Provider will provide replacement or additional personnel at no additional cost to correct any substandard work performed by assigned Service Provider personnel within five (5) working days after notification by the designated LSUHSC-NO representative.
- E. Failure to correct substandard work to the satisfaction of the designated LSUHSC-NO representative after the five (5) working day notice may result in monetary penalties (see section 2.15) or even the cancellation of this service contract.
- F. The Service Provider will respond within two (2) working days of notification to a request for a quote for new work to LSUHSC-NO representative and provide a quote within 5 working days of original notification.

2.9 IDENTIFICATION

- A. The Service Provider will provide LSUHSC-NO specific information (Appendix A) for all personnel at the start of the service contract to facilitate the issuance of LSUHSC-NO identification badges.
- B. Service Provider personnel will always be in a uniform displaying the company logo at all times while on LSUHSC-NO property.
- C. Service Provider personnel must prominently display their LSUHSC-NO identification badge at all times while inside any LSUHSC-NO facility.

- D. The Service Provider will immediately retrieve and return to LSUHSC-NO identification badges for personnel that have been permanently removed from LSUHSC-NO properties or terminated from employment, and all badges at the conclusion of the service contract.

2.10 CLEANUP

- A. Service Provider personnel will be responsible for the thorough cleanup and removal of all debris in all areas where work was performed before leaving LSUHSC-NO property at the end of a work shift.

2.11 WASTE

- A. The Service Provider shall not permit the accumulation of trash and/or waste materials at the work site and is responsible for the proper disposal of all waste generated by this work.
 - 1. Unless otherwise stated elsewhere in these specifications, all waste products of any kind shall be removed from all LSUHSC-NO work locations daily and disposed of in the designated waste disposal container in accordance with all applicable federal, state and local laws and regulations.
- B. LSUHSC-NO will provide access to one specific roll off open top solid waste container (NOT other temporary containers belonging to other Service Providers) on each campus for waste generated on-site by the air filter changing services process.
- C. The use of LSUHSC-NO trash compactors, or trash containers other than the one designated container, is strictly forbidden.
 - 1. A \$1000 penalty will be assessed against the total cost of the job if debris generated by this service contract is found in LSUHSC-NO trash compactors or containers other than the one designated container.
 - 2. In addition, any violation of these conditions will result in the Service Provider being required to remove ALL future waste products of any kind from all LSUHSC-NO locations and disposed of off campus in accordance with all applicable federal, state and local laws and regulations.

2.12 USE OF PROPERTY

- A. There will be no office space provided to the Service Provider.
- B. Parking for Service Providers and Service Provider personnel is not available anywhere on the LSUHSC-NO Downtown Campus under any circumstances.
 - 1. Service Provider and Service Provider employee vehicles are required to park on the public street or in off-site commercial parking lots at the Service Provider's expense.

- C. Parking for Service Providers and Service Provider personnel is available at the School of Dentistry Campus free of charge.
- D. See Appendix B for location maps.

2.13 WORK LOCATION MANAGEMENT

- A. The Service Provider shall:
 - 1. Maintain safe pedestrian passage within and around work areas.
 - 2. Provide temporary protection to prevent movement of materials or debris to adjacent areas (where applicable).
 - a. Should the area beyond the work zone(s) become contaminated with any type of debris, coating, film, hazing, mist or dust as a consequence of this service; the Service Provider will clean and decontaminate these areas at no additional cost, to the satisfaction of the designated LSUHSC-NO representative.
 - 3. Promptly have repaired any incidental damage to infrastructure or moveable equipment, at no additional cost to LSUHSC-NO.

2.14 PAYMENTS

- A. The Service Provider shall only submit itemized invoices with lines that directly correspond to the lines on the LSUHSC-NO Purchase Order(s).
 - 1. As the Purchase Order(s) may have separate lines for identical work that is located at separate locations – Downtown Campus and School of Dentistry Campus – invoices cannot contain amounts that are the combined costs for the same work at the different locations.
 - 2. If the Purchase Order(s) list(s) the Quantity as twelve (12) months for service that is ongoing throughout the service contract year, the Service Provider may not combine multiple month payments onto one invoice (in order to only invoice quarterly, for example).
 - a. If a Service Provider prefers to invoice less often, this must be communicated to, and agreed to by, the designated LSUHSC-NO representative between the time the bid is awarded and the Purchase Order issued.
 - b. Once the Purchase Order has been issued, payment frequency must conform to the frequency listed on the Purchase Order.
 - c. For service that is only scheduled for specific times throughout the service contract year (quarterly and/or annual service, for example), the Purchase Order will show the Quantity as equal to the number of service visits that correspond to these specific times and invoicing will occur only after each of these service visits are complete.

- (1) If the Purchase Order includes both monthly and specific timed service visits, invoices may not combine both and spread the costs for the specific timed service visits over the entire service contract year.
- (2) If the Service Provider prefers to spread all charges throughout the service contract year regardless of service visit frequency, this must be communicated to, and agreed to by, the designated LSUHSC-NO representative between the time the bid is awarded and the Purchase Order issued.

B. Invoices are to be submitted to either:

1. Via USPS mail to:

LSUHSC New Orleans
Accounts Payable
433 Bolivar Street
New Orleans, LA 70112

OR

2. Via E-mail to: noacctacctpays@lsuhsc.edu

C. No notice of completion, delivery memo, invoice or other document will be signed, or approvals of any type given for any part of the job or delivery of any equipment or materials, except by the designated LSUHSC-NO representative.

2.15 DEFAULT

- A. When the designated LSUHSC-NO representative becomes aware of an issue with either non-performance or non-compliance with the provisions as set forth in these specifications, the LSUHSC-NO representative will set a face-to-face meeting with the designated representative of the Service Provider within three (3) business days to discuss the issue, to mutually agree on a resolution to the discrepancy and to agree on a reasonable set target date for the issue to be corrected.
- B. If the same issue has not been resolved to the satisfaction of the designated LSUHSC-NO representative by this agreed upon set target date, the LSUHSC-NO representative will arrange a 2nd face-to-face meeting with the designated representative of the Service Provider within three (3) business days to again discuss the issue, to mutually agree on a resolution to the discrepancy and to agree on a reasonable 2nd set target date for the issue to be corrected.
- C. Should this 2nd discussion fail to resolve the issue by the 2nd agreed upon set target date, the designated LSUHSC-NO representative will send an electronic notification to the Service Provider that the non-performance and/or non-compliance issue must now automatically be corrected within three (3) business days from the date this notification is sent (not received).

1. Failure by the Service Provider to read the written notification in a timely manner or failure of the Service Provider's E-mail system to deliver the message will not extend the 3-day deadline.
- D. Should the two discussions between the Service Provider and the designated LSUHSC-NO representative plus the 3-day electronic notice fail to resolve the issue with non-performance or non-compliance with the provisions as set forth in these specifications, then LSUHSC-NO may seek remedy through liquidated damages as opposed to service contract cancellation and the following monetary penalties would then apply:
 1. 1st Offense – \$200 plus withholding any outstanding payments due
 2. 2nd Offense – \$500 plus withholding any outstanding payments due
 3. 3rd Offense – \$1000 plus withholding any outstanding payments due
 4. Service contract Cancellation
- E. The LSUHSC-NO designated representative will evaluate non-performance and/or non-compliance issues on a case-by-case basis and waive the levying of any damages in those instances where the failure to meet standards is determined to be beyond the Service Provider's control.

SECTION 3 – GENERAL CONDITIONS

3.1 SUMMARY

- A. The LSU Health Sciences Center – New Orleans (LSUHSC-NO) is seeking an air filter changing services Service Provider to perform air filter changing services per a set schedule.
 1. The Service Provider shall furnish all labor, materials and equipment necessary to deliver these services.
- B. Except where noted, in addition to all labor, materials, tools and equipment, the Service Provider shall also provide any and all permits, insurance, transportation and/or other items required to provide the services outlined in these specifications.
- C. The service contract period for this agreement will be twelve (12) months.
 1. Upon mutual agreement by both parties, the service contract can be renewed for four (4) additional twelve (12) month periods, with the total term of the service contract not to exceed sixty (60) months.

3.2 EXISTING CONDITIONS, EXAMINATION OF SITE

- A. By the act of submitting a bid on this work, the Service Provider shall be considered to have examined all buildings and these specifications and to be

thoroughly familiarized with the scope of the required work and the existing conditions of all air filter locations listed.

- B. Should drawings be provided by LSUHSC-NO indicating the location and dimensions of spaces, they are intended only as a guide to the Service Provider – the Service Provider is responsible for inspecting and field verifying all dimensions.
- C. When a discrepancy or ambiguity arises between the written specifications and any drawings, the written specifications shall govern.
- D. Prior to the start of any work under this service contract, the Service Provider and the designated LSUHSC-NO representative shall together make a thorough examination of the current conditions at all locations listed in these specifications.

3.3 SERVICE LOCATIONS

- A. The address for each of the buildings covered under this contract is listed below:

Allied Health & Nursing Building (AHSON)	1900 Gravier Street
Clinical Education Building (CEB or 1542)	1542 Tulane Avenue
Dr. Mervin L. Trail Clinical Sciences Research Building (CSRB)	533 Bolivar Street
Gravier Street Parking Garage	1661 Gravier Street
Human Development Center (HDC)	411 S. Prieur Street
Lions / LSU Clinics Building	2020 Gravier Street
Medical Education Building (MEB)	1901 Perdido Street
Residence Hall	1900 Perdido Street
Resource Center Building (RCB)	433 Bolivar Street
Roman Street Parking Garage	425 S. Roman Street
School of Dentistry (Dental)	1100 Florida Avenue
Seton Building	478 S. Johnson Street
Center for Advanced Learning and Simulation (CALS)	2021 Perdido Street
Delgado Building	450 S. Claiborne Avenue

- B. LSUHSC-NO reserves the right to add or remove a building from the list of service locations when deemed necessary by the University.
 - 1. LSUHSC-NO will notify the Service Provider in writing 30 calendar days in advance of any changes.
 - 2. The designated LSUHSC-NO representative will request a quote from the Service Provider when planning the addition of a location to the service contract.

3.4 BIDDER PROVISIONS

- A. Bidders are to quote their specific prices to furnish all labor, materials, equipment and expertise necessary to perform air filter changing services for a period beginning on or about April 1, 2025 and ending one (1) year after that date.
- B. The successful bidder must supply with bid submission three (3) client references including contact person name, address and phone number from three

organizations of similar size and complexity to LSUHSC-NO that are currently providing similar work to bidder.

- C. The bid award will be all or none. All prices on successful bid price sheet will become the fixed service contract prices to furnish all labor, materials, equipment and expertise necessary to accomplish the work described in these specifications for the duration of this service contract.
- D. The use of the word "Service Provider" shall be interpreted to be the firm or corporation that is the successful bidder and has been designated the exclusive provider of the services described herein by LSUHSC-NO.
 - 1. The successful bidder will be required to accept a purchase order from LSUHSC-NO to serve as a service contract in strict accordance with these specifications for services.
 - 2. The service contract will be administered by the designated LSUHSC-NO representative.

3.5 DESIGNATED LSUHSC-NO REPRESENTATIVE

- A. Coordinate with the designated LSUHSC-NO Preventive Maintenance Representative each time prior to performing the scheduled air filter changing services.
- B. Following award of this bid, the primary designated LSUHSC-NO representative is Preventive Maintenance Facility Assistant Maintenance Manager B Conrad Kennedy. Conrad Kennedy can be contacted via phone at 504-568-8155 or fax at 504-568-7223. Please do not contact this individual regarding the bid process.

Mail should be addressed to:
Conrad Kennedy, Facility Assistant Maintenance Manager B
LSU Health Sciences Center
Department of Facility Services
1901 Perdido Street, Room 2220
New Orleans, LA 70112

- C. Following award of this bid, should the Facility Assistant Maintenance Manager B be unavailable, the Assistant Director of Facility Services should be contacted with any service contract-related questions or issues via phone at (504) 568-8995.

3.6 PERSONNEL, EMPLOYMENT PRACTICES AND STAFFING

- A. Prior to implementation of this service contract, representatives from LSUHSC-NO and the Service Provider will hold a meeting to introduce each group of representatives to the other. At a minimum, this meeting is to be attended by:
 - 1. A main point of contact from the Service Provider's sales or management staff for all concerns beyond notification for routine work.

- a. This individual shall routinely review and inspect operations, consult with LSUHSC-NO on current and future service programs and act with full authority on the Service Provider's behalf in any and all matters pertaining to the specifications of this service contract.
 - b. Though not required to attend, the name and contact information for a backup to the main point of contact must be provided.
 - c. The main point of contact will provide a telephone number, fax number, E-mail address, business cell phone number and normal working hours of themselves and their backup.
2. A main point of contact for the Service Provider responsible for scheduling service. Though not required to attend, the name of a backup to the scheduling point of contact must be provided.
 3. The designated LSUHSC-NO representative and any individuals authorized as backup to the designated LSUHSC-NO representative.

3.7 COORDINATION OF WORK

- A. The Service Provider will be responsible for coordinating the work of all trades provided under this service contract.
- B. The Service Provider shall provide all supervision on-site to coordinate and inspect work.
- C. There will be an on-site supervisor or point-of-contact on campus at all times and readily available to the designated LSUHSC-NO representative when work is being performed.
- D. Daily Check In/Out
 1. The Service Provider on-site supervisor or point-of-contact shall check-in with designated LSUHSC-NO representative or designee daily prior to starting work.
 2. On-site supervisor or point-of-contact will contact the designated LSUHSC-NO representative or designee for inspection or to provide an update report after completing the daily work schedule.
- E. LSUHSC-NO is a twenty-four (24) hours a day, three hundred and sixty-five (365) days a year operation.
 1. The designated LSUHSC-NO representative must approve any work scheduling that will interfere with the normal operation of the facility or its personnel.
- F. Personnel relations of employees on the Service Provider's payroll shall solely be the Service Provider's responsibility.
 1. The Service Provider shall comply with all applicable government regulations related to the employment and compensation of personnel.

- G. All tasks are to be performed in a workmanlike manner, in accordance with industry standards and acceptable trade practices for all trades involved.

3.8 SERVICE CONTRACT CHANGES

- A. After the bid has been awarded, no changes will be made to any part of the service contract without:
 - 1. A written proposal from the Service Provider describing the potential changes with a complete breakdown of all material and hours, and the individual cost of each; and,
 - 2. A subsequent written approval from the designated LSUHSC-NO representative and an authorized representative from the Purchasing Department.

3.9 DOCUMENTATION

- A. No notice of completion, delivery memo, invoice or other document will be signed, or approvals of any type given, for any part of the job or delivery of any equipment or materials, except by the designated LSUHSC-NO representative(s), secondary contact or designee.
- B. A pre-prepared service ticket must be provided to the designated LSUHSC-NO representative(s), secondary contact or designee at the completion of each service visit – annual service or repair service (all notations on this form by the service technician must legible and with clear details).

3.10 SERVICE IMPLICATIONS

- A. Items not expressly set forth but which are reasonably implied or necessary for the proper performance of this work shall be included.

SECTION 4 – GENERAL PROJECT REQUIREMENTS

4.1 QUALITY ASSURANCE

- A. The Service Provider shall:
 - 1. Submit copies of inspection reports, notices and similar documents to the designated LSUHSC-NO representative (where applicable).
 - a. Legible (typed) electronic copies of reports are required to be transmitted to LSUHSC-NO within forty eight (48) hours of the completion of on-site work.
 - 2. Handle and store materials in strict accordance with manufacturer's instructions.

3. Submit all pertinent information to the designated LSUHSC-NO representative regarding any Sub-Service Provider for approval prior to using any Sub-Service Provider for the first time at LSUHSC-NO.
4. All normal precautions associated with air filter changing must also be taken to protect the safety of the building, its occupants and the Service Provider's staff.

4.2 SCHEDULING WORK

- A. After agreeing to the schedule for the upcoming service by both parties, revisions may only be made by mutual consent of both the Service Provider and the LSUHSC-NO designated representative.
- B. Work Hours:
 1. Almost all locations (including roof access) are available for service from 8:00 a.m. to 4:30 p.m. Monday through Friday.
 2. The exceptions are the Residence Hall and Sister Stanislaus Memorial Hall buildings that must be scheduled after 9:00 a.m. and complete by 4:30 p.m.
- C. Consecutive Work Days – Once started, work shall continue on consecutive work days until complete unless pre-approved by the designated LSUHSC-NO representative.
- D. Total Work Time – Work must be complete, to the satisfaction of the designated LSUHSC-NO representative, by the target date agreed upon when the work is first scheduled.
- E. The target date may be extended but only by approval of the designated LSUHSC-NO representative.
- F. All shutdowns of systems will be coordinated with the LSUHSC-NO representative and appropriate requests, Outage Request and Hot Work Requests, will be made a minimum of five (5) work days prior to the start of the work.

4.3 RESCHEDULING WORK

- A. Once scheduled, the start of the work can be rescheduled only once for reasons other than weather related (should a declared evacuation of the area or a decision by the LSUHSC-NO Chancellor to officially close the LSUHSC-NO campus due to a severe weather event or other emergency, the Service Provider shall not schedule personnel to report to either LSUHSC-NO campus until officials at all levels have deemed the area safe).
- B. Rescheduled work must begin no later than five work days after the original scheduled start date.

- C. The Service Provider shall notify the designated LSUHSC-NO representative of any delays in writing at least 48 hours before the originally agreed upon start date to allow the designated LSUHSC-NO representative time to notify the campus community.

4.4 WORK PROGRESSION

- A. Once work has commenced, work must progress on consecutive work days until complete.
- B. Exceptions to this rule include:
 - 1. Work is disrupted due to circumstances beyond the control of the Service Provider (weather, LSUHSC-NO causes a delay, etc. – should a declared evacuation of the area or a decision by the LSUHSC-NO Chancellor to officially close the LSUHSC-NO campus due to a severe weather event or other emergency, the Service Provider shall not schedule personnel to report to either LSUHSC-NO campus until officials at all levels have deemed the area safe);
 - 2. A work schedule showing non-consecutive work days was pre-approved by the designated LSUHSC-NO representative; or
 - 3. The nature of the work being performed requires a break or breaks to allow a process to complete (drying, curing, setting, etc.) before proceeding.
- C. The designated LSUHSC-NO representative may allow other exceptions on a case-by-case basis but will be the final authority of any such requests.

SECTION 5 – SCOPE OF WORK

5.1 MATERIALS

- A. Filters will be provided by LSUHSC-NO and will be stored at the Downtown Campus.

5.2 CHANGING FILTERS

- A. Room ceiling supply air grilles with filters.
 - 1. Laboratory 20" x 20" x 1" filters are to be changed monthly for the Medical Education Building, Trail Clinical Science Research Building, Lions / LSU Clinics Building, and the Center for Advanced Learning and Simulation.
 - 2. Office 20" x 20" x 1" filters are to be changed once annually for the Medical Education Building, Trail Clinical Science Research Building, Lions / LSU Clinics Building, and the Center for Advanced Learning and Simulation.
- B. All 2" and 4" filters are to be changed on a 6-week rotational basis and should take about one week to complete.

- C. All other filters are to be changed on an 18-week rotational basis and should take about two weeks to complete.
- D. Install all materials according to manufacturer's specifications.
- E. Write the date of installation on each filter.
- F. Air Handler Units (AHUs)
 - 1. The Service Provider will NEVER turn off an AHU.
 - a. AHUs will be required to be turned off for filter changes.
 - b. LSUHSC-NO will be responsible for turning off AHUs when necessary.
 - c. The Service Provider will coordinate with LSUHSC -NO on when to turn off and turn on AHUs.
 - 2. With the exception of two AHUs located on the roof of the Medical Education Building, air handler units are located in mechanical rooms.
 - 3. A mechanical room key will be issued to the Service Provider – access to other locations, especially all restricted areas and all Student Housing residence spaces, will be provided by LSUHSC-NO personnel.
- G. Fan Coil Units (FCUs) are typically out in the open or flush with suspended ceilings with visible access panels.
- H. Document and report immediately to the designated LSUHSC-NO representative any missing or damaged spacers, access panels, or other parts; the Service Provider may be held responsible otherwise.
- I. The Service Provider is responsible for all damages related to the filter sections, except pre-existing damages that have been reported to and verified by the designated LSUHSC-NO representative prior to beginning work.
- J. There shall be no gaps between filters and no other gaps or openings that will allow air to bypass the filters.

APPENDIX A

**SERVICE PROVIDER
ID BADGE
APPLICATION**

**LSUHSC – SERVICE PROVIDER ID BADGE
REQUEST FORM**

DEPARTMENT: FACILITY SERVICES

COMPANY: _____

NAME: _____

SOCIAL SECURITY NUMBER (LAST 4 DIGITS ONLY): ____ ____ ____ ____

DATE OF BIRTH: ____/____/____

FULL HOME ADDRESS (incl. zip): _____

BIRTHPLACE (city & state): _____

JOB TITLE: _____

WORK TELEPHONE NUMBER: _____

**LSUHSC – SERVICE PROVIDER ID BADGE
REQUEST FORM**

DEPARTMENT: FACILITY SERVICES

COMPANY: _____

NAME: _____

SOCIAL SECURITY NUMBER (LAST 4 DIGITS ONLY): ____ ____ ____ ____

DATE OF BIRTH: ____/____/____

FULL HOME ADDRESS (incl. zip): _____

BIRTHPLACE (city & state): _____

JOB TITLE: _____

WORK TELEPHONE NUMBER: _____

APPENDIX B

CAMPUS MAPS

DOWNTOWN CAMPUS BUILDING LIST

(<https://www.lsuhs.edu/maps/downtown.aspx>)

- | | |
|--|---|
| <p>(1) <u>Clinical Education Building</u>
1542 Tulane Avenue</p> <p>(2) <u>Residence Hall</u>
1900 Perdido Street</p> <p>(3) <u>Medical Education Building</u>
1901 Perdido Street</p> <p>(4) <u>Allied Health / Nursing Building</u>
1900 Gravier Street</p> <p>(5) <u>Human Development Center</u>
411 South Prieur Street</p> <p>(6) <u>Central Plant (Main)</u>
1903 Gravier Street</p> <p>(7) <u>Resource Center Building</u>
433 Bolivar Street</p> <p>(8) <u>Lions / LSU Clinics Building</u>
2020 Gravier Street</p> <p>(9) <u>Dr. Mervin L. Trail Clinical Sci. Research Bldg.</u>
533 Bolivar Street</p> | <p>(10) <u>Sister Stanislaus Memorial Hall</u>
450A South Claiborne Avenue</p> <p>(12) <u>Center for Advanced Learning & Simulation</u>
2021 Perdido Street</p> <p>(18) <u>Seton Building (NO LONGER PART OF UMC)</u>
2025 Gravier Street</p> <p>(19) <u>Center for Advanced Learning & Simulation</u>
<u>Central Plant</u>
2101 Gravier Street</p> <p>(29) <u>Gravier Street Parking Garage</u>
1661 Gravier Street</p> <p>(30) <u>Roman Street Parking Garage</u>
425 S. Roman Street</p> <p>(35) <u>East Campus Standby Power System</u>
1900 Gravier Street</p> <p>(NA) <u>Walk-To-Wellness</u>
Gravier Street (Bld. # 18 to Bld. # 29)</p> |
|--|---|

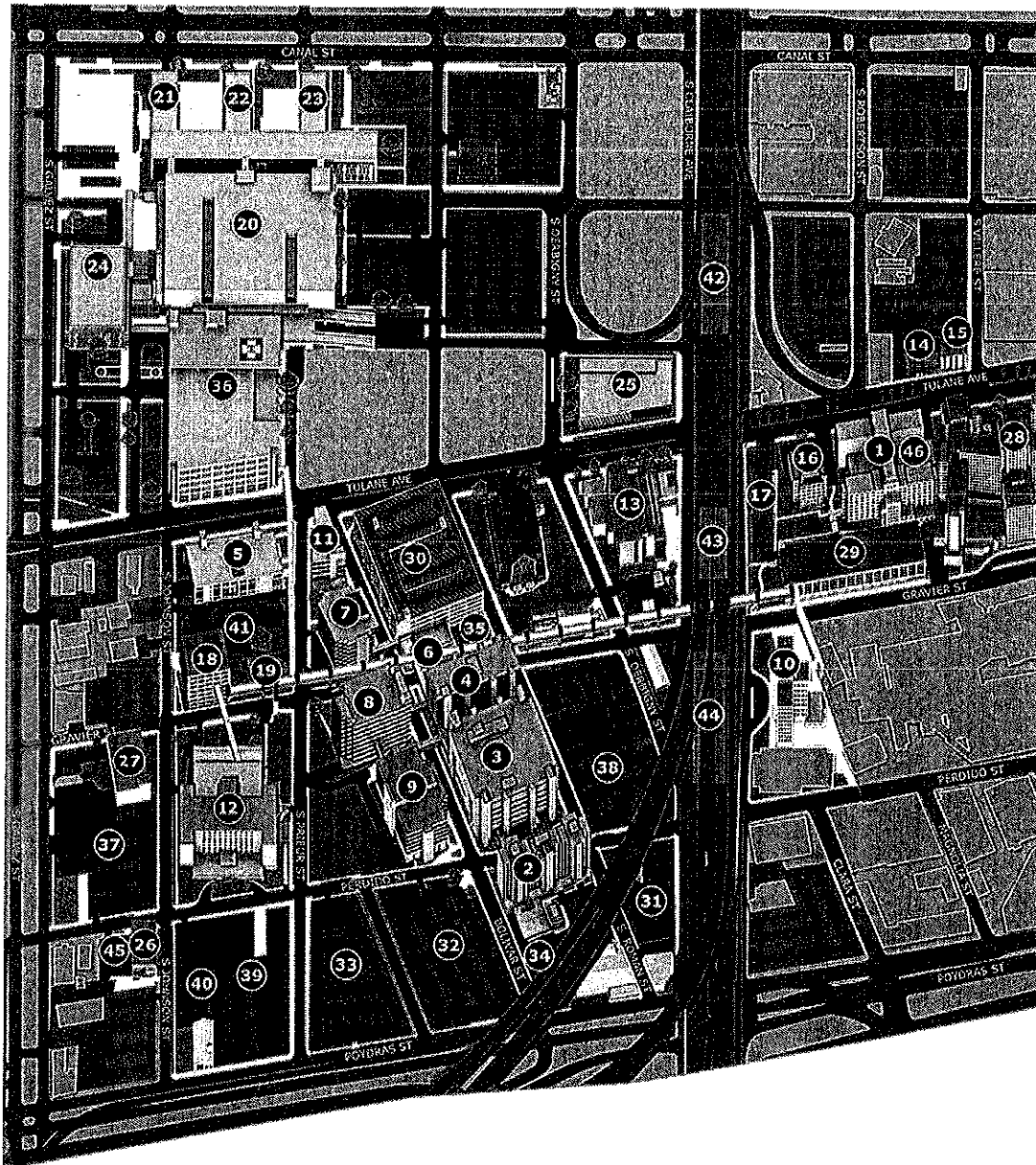

LEGEND



LSUHSC



University
Medical
Center (NIC)



Parking

SCHOOL OF DENTISTRY CAMPUS BUILDING LIST

(<https://www.lsuhsd.edu/maps/dental.aspx>)

- (1) School of Dentistry – Administration Building (Admin)
1100 Florida Avenue
- (2) School of Dentistry – Dr. Allen A. Copping Advanced Clinical Care & Clinical Research Building (Annex)
1100 Florida Avenue
- (3) School of Dentistry – Clinic Building (Clinic)
1100 Florida Avenue
- (4) School of Dentistry – Inter-Professional Primary Care Clinic (PCC)
1100 Florida Avenue
- (5) School of Dentistry – Power Plant
1100 Florida Avenue

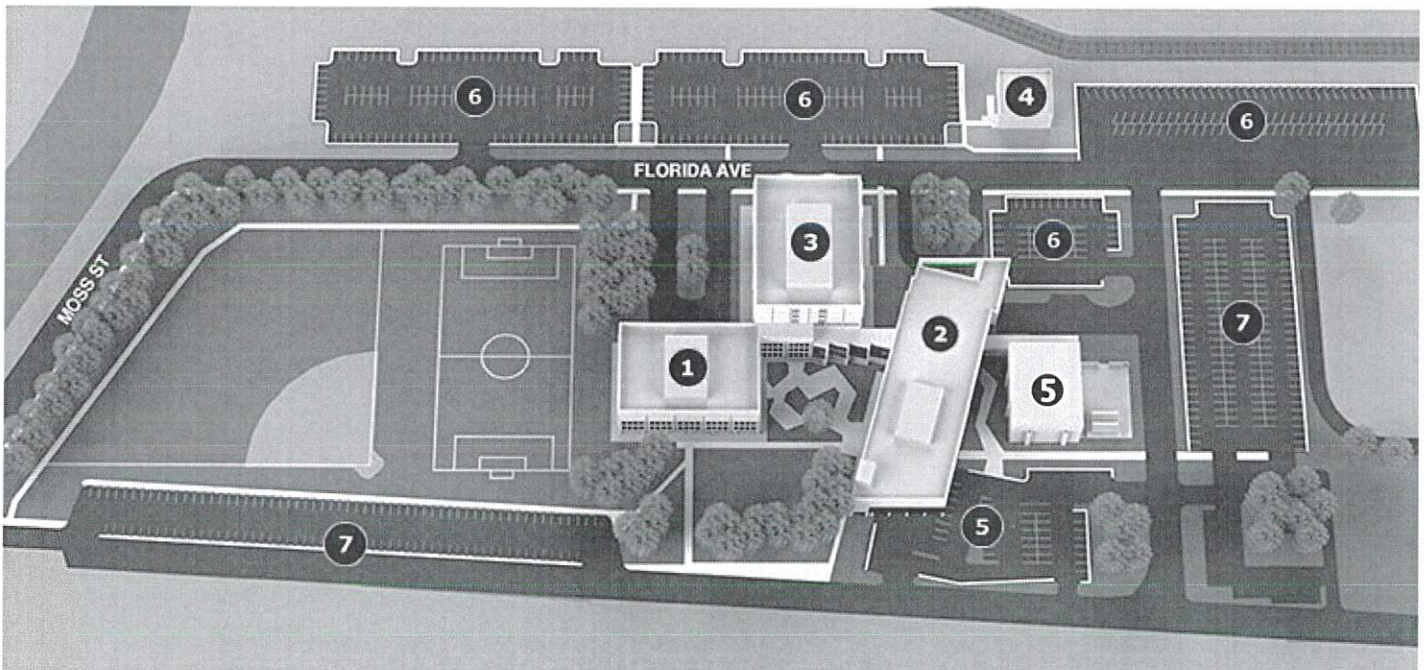

FILTERS FOR ALLIED HEALTH / NURSING

Type	Room #	Qty	Size	Unit Price	Extended Price
AHU-N-2-A	202	6	16x25x2		
AHU-N-2-B	202	6	16x25x2		
AHU-N-3-A	306	6	16x25x2		
AHU-N-3-B	306	6	16x25x2		
AHU-N-3-C	322	8	16x25x2		
AHU-N-3-D	322	6	16x25x2		
AHU-N-3-E	322	6	16x25x2		
AHU-N-4-A	405	8	16x25x2		
AHU-N-4-B	405	6	16x25x2		
AHU-N-4-C	433	8	16x25x2		
AHU-N-4-D	433	6	16x25x2		
AHU-N-5-A	501-C	5	16x20x2		
AHU-N-5-A	501-C	1	20x20x2		
AHU-N-5-A	501-C	1	16x25x2		
AHU-N-5-B	501-C	2	16x25x2		
AHU-N-5-B	501-C	2	20x20x2		
AHU-N-5-B	501-C	1	16x20x2		
AHU-N-5-C	507	3	20x20x2		
AHU-N-5-C	507	2	16x20x2		
AHU-N-5-C	507	1	16x25x2		
AHU-N-5-D	507	4	16x25x2		
AHU-N-6-A	605	8	16x25x2		
AHU-N-6-B	605	6	16x25x2		
AHU-N-6-C	631	8	16x25x2		
AHU-N-6-D	631	6	16x25x2		
AHU-N-7-A	706	8	16x25x2		
AHU-N-7-B	706	6	16x25x2		
AHU-N-7-C	730	8	16x25x2		
AHU-N-7-D	730	6	16x25x2		
AHU-N-8-A	804	8	16x25x2		
AHU-N-8-B	804	6	16x25x2		
AHU-N-8-C	831	8	16x25x2		
AHU-N-8-D	831	6	16x25x2		
AHU-N-9-A	905	8	16x25x2		
AHU-N-9-B	905	6	16x25x2		
AHU-N-9-C	945	8	16x25x2		
AHU-N-9-D	945	6	16x25x2		
AHU-N-10-A	1006	7	16x20x2		
AHU-N-10-A	1006	7	16x25x2		
AHU-N-10-B	1025	7	16x20x2		
AHU-N-10-B	1025	7	16x25x2		
FAN COIL - ELEVATOR	Roof	1	20x16x2		
FAN COIL - ELEVATOR	Roof	2	20x32x2		
				TOTAL	

FILTERS FOR CLINICAL EDUCATION

Type	Room #	Qty	Size	Unit Price	Extended Price
AHU - Library	123-W	3	16x20x2		
AHU - Library	123-W	3	20x20x2		
AHU 1-C-1	113	12	20x25x2		
AHU 6	10th Floor	15	16x20x2		
AHU 6	10th Floor	5	16x25x2		
AHU 8C3	10th Floor	10	20x20x2		
AHU B	119	6	16x20x2		
AHU B	119	1	20x20x2		
AHU C	235	1	16x25x2		
AHU C	235	2	20x25x2		
AHU D	235	1	24x24x2		
AHU10	10th Floor	6	12x24x2		
AHU10	10th Floor	8	24x24x2		
AUD AHU	Between 2nd & 3rd Floor	1	12x24x2		
AUD AHU	Between 2nd & 3rd Floor	4	20x25x2		
ELEVATOR FAN COIL	10th Floor	2	20x20x1		
Fan Coil - Office	728	1	10 1/4 x 43 3/4 x 1		
Fan Coil - Office	741B	2	10 1/4 x 43 3/4 x 1		
Fan Coil - Office	753	1	10 1/4 x 68 x 1		
Fan Coil - Office	754	1	10 1/4 x 68 x 1		
Fan Coil - Office	354	1	10 3/4 x 31 3/4 x 1		
Fan Coil - Office	617	1	10 3/4 x 32 x 1		
Fan Coil - Office	617	1	10 3/4 x 32 x 1		
Fan Coil - Office	619	1	10 3/4 x 32 x 1		
Fan Coil - Office	639	1	10 3/4 x 32 x 1		
Fan Coil - Office	650	1	10 3/4 x 32 x 1		
Fan Coil - Office	656	1	10 3/4 x 32 x 1		
Fan Coil - Office	656	1	10 3/4 x 32 x 1		
Fan Coil - Office	657	1	10 3/4 x 32 x 1		
Fan Coil - Office	658	1	10 3/4 x 32 x 1		
Fan Coil - Office	619	1	10 3/4 x 32 x 1		
Fan Coil - Office	719 - 1A	1	10 3/4 x 32 x 1		
Fan Coil - Office	720A	1	10 3/4 x 32 x 1		
Fan Coil - Office	721A	1	10 3/4 x 32 x 1		
Fan Coil - Office	718A	1	10 3/4 x 32 x 1		
Fan Coil - Office	227	1	10 3/4 x 32 x1		
Fan Coil - Office	228	1	10 3/4 x 32 x1		
Fan Coil - Office	229	1	10 3/4 x 32 x1		
Fan Coil - Office	230	1	10 3/4 x 32 x1		
Fan Coil - Office	231	1	10 3/4 x 32 x1		
Fan Coil - Office	236	1	10 3/4 x 32 x1		
Fan Coil - Office	237	1	10 3/4 x 32 x1		
Fan Coil - Office	238A	1	10 3/4 x 32 x1		
Fan Coil - Office	240A	1	10 3/4 x 32 x1		
Fan Coil - Office	240	1	10 3/4 x 32 x1		
Fan Coil - Office	240	1	10 3/4 x 32 x1		

FILTERS FOR CLINICAL EDUCATION

Type	Room #	Qty	Size	Unit Price	Extended Price
Fan Coil - Office	241	1	10 3/4 x 32 x1		
Fan Coil - Office	242A	1	10 3/4 x 32 x1		
Fan Coil - Office	419	1	10 3/4 x 32 x1		
Fan Coil - Office	420A	1	10 3/4 x 32 x1		
Fan Coil - Office	422B	1	10 3/4 x 32 x1		
Fan Coil - Office	422C	1	10 3/4 x 32 x1		
Fan Coil - Office	422F	1	10 3/4 x 32 x1		
Fan Coil - Office	425A	1	10 3/4 x 32 x1		
Fan Coil - Office	453	1	10 3/4 x 32 x1		
Fan Coil - Office	416 -2	1	10 3/4 x 32 x1		
Fan Coil - Office	454	1	10 3/4 x 32 x1		
Fan Coil - Office	456B	1	10 3/4 x 32 x1		
Fan Coil - Office	456C	1	10 3/4 x 32 x1		
Fan Coil - Office	A427	1	10 3/4 x 32 x1		
Fan Coil - Office	458A	1	10 3/4 x 32 x1		
Fan Coil - Office	514A	1	10 3/4 x 32 x1		
Fan Coil - Office	517	1	10 3/4 x 32 x1		
Fan Coil - Office	519	1	10 3/4 x 32 x1		
Fan Coil - Office	728	1	10 3/4 x 35 3/4 x 1		
Fan Coil - Office	741B	1	10 3/4 x 35 3/4 x 1		
Fan Coil - Office	741	1	10 3/4 x 43 3/4 x 1		
Fan Coil - Office	319 B	1	10 x 31 3/4 x 1		
Fan Coil - Office	320	1	10 x 31 3/4 x 1		
Fan Coil - Office	322	1	10 x 31 3/4 x 1		
Fan Coil - Office	323	1	10 x 31 3/4 x 1		
Fan Coil - Office	325A	1	10 x 31 3/4 x 1		
Fan Coil - Office	331C	1	10 x 31 3/4 x 1		
Fan Coil - Office	639	1	10 x 36 x 1		
Fan Coil - Office	729	3	10 x 36 x 1		
Fan Coil - Office	635	1	10 x 43 3/4 x 1		
Fan Coil - Office	635	1	10 x 43 3/4 x 1		
Fan Coil - Office	634	1	10 x 43 3/4 x 1		
Fan Coil - Office	633	1	10 x 43 3/4 x 1		
Fan Coil - Office	624	3	10 x 43 3/4 x 1		
Fan Coil - Office	630	1	10 x 43 3/4 x 1		
Fan Coil - Office	741	1	10 x 43 3/4 x 1		
Fan Coil - Office	749	1	10 x 43 3/4 x 1		
Fan Coil - Office	750	1	10 x 43 3/4 x 1		
Fan Coil - Office	751	1	10 x 43 3/4 x 1		
Fan Coil - Office	756-1	1	10 x 43 3/4 x 1		
Fan Coil - Office	757A	1	10 x 43 3/4 x 1		
Fan Coil - Office	758A	1	10 x 43 3/4 x 1		
Fan Coil - Office	759	1	10 x 43 3/4 x 1		
Fan Coil - Office	761A	1	10 x 43 3/4 x 1		
Fan Coil - Office	729	1	10 x 43 3/4 x 1		
Fan Coil - Office	630	1	10 x 52 x 1		
Fan Coil - Office	555	1	7 1/2 x 29 x 1		
Fan Coil - Office	556 A	1	7 1/2 x 29 x 1		
Fan Coil - Office	556B	1	7 1/2 x 29 x 1		

FILTERS FOR CLINICAL EDUCATION

Type	Room #	Qty	Size	Unit Price	Extended Price
Fan Coil - Office	763A	1	7 1/4 x 29 x 1		
Fan Coil - Office	719A	1	7 1/4 x 29 x 1		
Fan Coil - Office	514	1	7 1/4 x 29 x1		
Fan Coil - Office	515	1	7 1/4 x 29 x1		
Fan Coil - Office	516	1	7 1/4 x 29 x1		
Fan Coil - Office	762A	1	7 1/4 x 29 x1		
Fan Coil - Office	331D	1	7 1/4 x 43 x 1/2		
Fan Coil - Office	333	1	7 1/4 x 43 x 1/2		
Fan Coil - Office	334	1	7 1/4 x 43 x 1/2		
Fan Coil - Office	335	1	7 1/4 x 43 x 1/2		
Fan Coil - Office	336B	1	7 1/4 x 43 x 1/2		
Fan Coil - Office	336	1	7 1/4 x 43 x 1/2		
Fan Coil - Office	337	1	7 1/4 x 43 x 1/2		
Fan Coil - Office	328	1	7 1/4 x 43 x 1/2		
Fan Coil - Office	339	1	7 1/4 x 43 x 1/2		
Fan Coil - Office	340	1	7 1/4 x 43 x 1/2		
Fan Coil - Office	342	1	7 1/4 x 43 x 1/2		
Fan Coil - Office	357A	1	7 3/8 x 29 x 1/2		
Fan Coil - Office	615	1	7 x 21 3/4 x 1		
Fan Coil - Office	763B	1	7 x 28 x 1		
Fan Coil - Office	545	1	8 1/2 x 42 1/2 x 1		
Fan Coil - Office	547	1	8 1/2 x 42 1/2 x 1		
Fan Coil - Office	579	1	8 1/2 x 42 1/2 x 1		
Fan Coil - Office	550	1	8 1/2 x 42 1/2 x 1		
Fan Coil - Office	551	1	8 1/2 x 42 1/2 x 1		
Fan Coil - Office	552	1	8 1/2 x 42 1/2 x 1		
Fan Coil - Office	554A	1	8 1/2 x 42 1/2 x 1		
Fan Coil - Office	431	1	8 1/2 x 28 1/2 x 1		
Fan Coil - Office	434	1	8 1/2 x 42 1/2 x 1		
Fan Coil - Office	233	1	8 1/4 x 36 1/4 x 1		
Fan Coil - Office	520A	1	8 1/4 x 57 1/4 x 1		
Fan Coil - Office	615	1	8 x 29 x 1		
Fan Coil - Office	659	1	8 x 29 x 1		
Fan Coil - Office	543	1	8 x 29 x1		
Fan Coil - Office	346	1	8 x 31 x 1/2		
Fan Coil - Office	346	1	8 x 31 x 1/2		
Fan Coil - Office	343	1	8 x 31 x 1/2		
Fan Coil - Office	348	1	8 x 31 x 1/2		
Fan Coil - Office	349	1	8 x 31 x 1/2		
Fan Coil - Office	350	1	8 x 31 x 1/2		
Fan Coil - Office	351	1	8 x 31 x 1/2		
Fan Coil - Office	330	1	8 x 31 x 1/2		
Fan Coil - Office	535	1	8 x 41 1/4 x 1		
Fan Coil - Office	523	1	8 x 42 x 1		
Fan Coil - Office	524	2	8 x 42 x 1		
Fan Coil - Office	536	1	8 x 42 x 1		
Fan Coil - Office	537	1	8 x 42 x 1		
Fan Coil - Office	539	1	8 x 42 x 1		
Fan Coil - Office	541	1	8 x 42 x 1		

FILTERS FOR CLINICAL EDUCATION

Type	Room #	Qty	Size	Unit Price	Extended Price
Fan Coil - Office	543	1	8 x 42 x 1		
Fan Coil - Office	542	2	8 x 42 x 1		
Fan Coil - Office	616	1	8 x 43 x 1/2		
Fan Coil - Office	524	1	8 x 57 x 1		
Fan Coil - Office	540	1	8 x 58 x 1		
Fan Coil - Office	534	1	8 x 29 x 1		
Fan Coil - Office	436	1	9 1/2 x 30 1/2 x 1		
Fan Coil - Office	449	1	9 1/2 x 30 1/2 x 1		
Fan Coil - Office	242B	1	9 1/2 x 42 1/2 x 1		
Fan Coil - Office	242	1	9 1/2 x 42 1/2 x 1		
Fan Coil - Office	422G	1	9 1/2 x 42 1/2 x 1		
Fan Coil - Office	435	1	9 1/2 x 42 1/2 x 1		
Fan Coil - Office	437A	1	9 1/2 x 42 1/2 x 1		
Fan Coil - Office	438A	1	9 1/2 x 42 1/2 x 1		
Fan Coil - Office	440	1	9 1/2 x 42 1/2 x 1		
Fan Coil - Office	441	1	9 1/2 x 42 1/2 x 1		
Fan Coil - Office	447	1	9 1/2 x 42 1/2 x 1		
Fan Coil - Office	429	1	9 1/2 x 44 1/2 x 1		
Fan Coil - Office	446	1	9 1/2 x 46 1/2 x 1		
Fan Coil - Office	430	1	9 1/2 x 58 x 1		
Fan Coil - Office	435	1	9 1/2 x 58 x 1		
Fan Coil - Office	433	1	9 1/2 x 68 1/2 x 1		
Fan Coil - Office	444	1	9 1/2 x 68 1/2 x 1		
Fan Coil - Office	445	1	9 1/2 x 68 1/2 x 1		
Fan Coil - Office	442	1	9 1/2 x 84 1/2 x 1		
Fan Coil - Office	319 C	1	9 3/4 x 41 x 1/2		
				TOTAL	

FILTERS FOR TRAIL CLINICAL SCIENCE RESEARCH

Type	Room #	Qty	Size	Unit Price	Extended Price
AHU - S-1-1	114	12	20x24x2		
AHU - S-1-1A	114	12	20x24x2		
AHU - S-1-2	138	6	16x24x2		
AHU - S-2-1	211	8	24x24x2		
AHU - S-2-2	252	12	20x24x2		
AHU - S-3-1	320	12	20x24x2		
AHU - S-3-2	354	8	24x24x2		
AHU - S-3-3	354	1	16x24x2		
AHU - S-3-3	354	1	20x24x2		
AHU - S-4-1	411	15	20x20x2		
AHU - S-4-2	450	18	20x20x2		
AHU - S-5-1	515	12	20x24x2		
AHU - S-5-2	554	15	20x20x2		
AHU - S-6-1	619	12	20x24x2		
AHU - S-6-2	653	8	24x24x2		
AHU - S-7-1	710	15	20x20x2		
AHU - S-7-2	744	12	20x24x2		
AHU - 16A	370	3	12X24X2		
AHU - 16A	370	2	16X20X2		
AHU - 16A	370	6	20x20x2		
AHU - 16B	370	3	12X24X2		
AHU - 16B	370	2	16X20X2		
AHU - 16B	370	6	20x20x2		
AHU - 17A	385	4	16x25x2		
AHU - 17A	385	3	20x25x2		
AHU - 17B	385	4	16x25x2		
AHU - 17B	385	3	20x25x2		
AHU - 18A	570	6	16X20X2		
AHU - 18B	570	6	16x20x2		
AHU - 19A	570	2	20X20X2		
AHU - 19A	570	4	20X24X2		
AHU - 19B	570	2	20X20X2		
AHU - 19B	570	4	20X24X2		
AHU - 20A	583	2	20X20X2		
AHU - 20A	583	4	20X24X2		
AHU - 20B	583	2	20X20X2		
AHU - 20B	583	4	20X24X2		
AHU - 21A	583	6	16x20x2		
AHU - 21B	583	6	16x20x2		
AHU - 22A	669	6	16x20x2		
AHU - 22B	669	6	16x20x2		
AHU - 23A	684	6	16x20x2		
AHU - 23B	684	6	16x20x2		
AHU - 24A	756	6	16x20x2		
AHU - 24B	756	6	16x20x2		
AHU - 25A	767	6	16x20x2		
AHU - 25B	767	6	16x20x2		
FAN COIL - ELEVATOR	R04 (Roof)	1	24x24x1		
FAN COIL - ELEVATOR	R05 (Roof)	1	24x24x1		

FILTERS FOR TRAIL CLINICAL SCIENCE RESEARCH

Type	Room #	Qty	Size	Unit Price	Extended Price
FAN COIL - ELEVATOR	R01 (Roof)	1	24x24x1		
Outside Air Filter	211A	24	24x24x2		
Outside Air Filter	354A	24	24x24x2		
Outside Air Filter	411A	24	24x24x2		
Outside Air Filter	450A	24	24x24x2		
Outside Air Filter	515A	24	24x24x2		
Outside Air Filter	653A	24	24x24x2		
Outside Air Filter	619A	24	24x24x2		
Outside Air Filter	710A	24	24x24x2		
Outside Air Filter	744A	24	24x24x2		
SUPPLY AIR GRILL	301	4	24 x 24 x 1		
SUPPLY AIR GRILL	304	2	20 x 20 x 1		
SUPPLY AIR GRILL	307	2	20 x 20 x 1		
SUPPLY AIR GRILL	311	4	24 x 24 x 1		
SUPPLY AIR GRILL	312	4	20 x 20 x 1		
SUPPLY AIR GRILL	315	4	20 x 20 x 1		
SUPPLY AIR GRILL	317	2	20 x 20 x 1		
SUPPLY AIR GRILL	318	2	24 x 24 x 1		
SUPPLY AIR GRILL	331	12	20 x 20 x 1		
SUPPLY AIR GRILL	332	2	20 x 20 x 1		
SUPPLY AIR GRILL	339	2	24 x 24 x 1		
SUPPLY AIR GRILL	343	1	24 x 24 x 1		
SUPPLY AIR GRILL	346	1	24 x 24 x 1		
SUPPLY AIR GRILL	357	4	20 x 20 x 1		
SUPPLY AIR GRILL	361	8	20 x 20 x 1		
SUPPLY AIR GRILL	362	8	20 x 20 x 1		
SUPPLY AIR GRILL	404	3	20 x 20 x 1		
SUPPLY AIR GRILL	405	3	20 x 20 x 1		
SUPPLY AIR GRILL	407	3	20 x 20 x 1		
SUPPLY AIR GRILL	410	4	20 x 20 x 1		
SUPPLY AIR GRILL	412	2	20 x 20 x 1		
SUPPLY AIR GRILL	414	3	20 x 20 x 1		
SUPPLY AIR GRILL	420	4	24 x 24 x 1		
SUPPLY AIR GRILL	421	2	20 x 20 x 1		
SUPPLY AIR GRILL	423	4	20 x 20 x 1		
SUPPLY AIR GRILL	425	2	20 x 20 x 1		
SUPPLY AIR GRILL	426	4	20 x 20 x 1		
SUPPLY AIR GRILL	426B	4	20 x 20 x 1		
SUPPLY AIR GRILL	432	2	20 x 20 x 1		
SUPPLY AIR GRILL	433	1	20 x 20 x 1		
SUPPLY AIR GRILL	434	2	24 x 24 x 1		
SUPPLY AIR GRILL	528	4	24 x 24 x 2		
SUPPLY AIR GRILL	533	2	24 x 24 x 2		
SUPPLY AIR GRILL	543	1	20 x 20 x 1		
SUPPLY AIR GRILL	546	2	20 x 20 x 1		
SUPPLY AIR GRILL	550	1	20 x 20 x 1		
SUPPLY AIR GRILL	551	3	20 x 20 x 1		
SUPPLY AIR GRILL	552	2	20 x 20 x 1		

FILTERS FOR TRAIL CLINICAL SCIENCE RESEARCH

Type	Room #	Qty	Size	Unit Price	Extended Price
SUPPLY AIR GRILL	555	2	20 x 20 x 1		
SUPPLY AIR GRILL	556	6	20 x 20 x 1		
SUPPLY AIR GRILL	566A	4	24 x 24 x 1		
SUPPLY AIR GRILL	566B	2	24 x 24 x 1		
SUPPLY AIR GRILL	566C	1	24 x 24 x 1		
SUPPLY AIR GRILL	566E	2	24 x 24 x 1		
SUPPLY AIR GRILL	609	1	24 x 24 x 1		
SUPPLY AIR GRILL	614	2	20 x 20 x 1		
SUPPLY AIR GRILL	616	2	20 x 20 x 1		
SUPPLY AIR GRILL	626	4	20 x 20 x 1		
SUPPLY AIR GRILL	634	6	20 x 20 x 1		
SUPPLY AIR GRILL	643	4	20 x 20 x 1		
SUPPLY AIR GRILL	646	4	20 x 20 x 1		
SUPPLY AIR GRILL	649	2	20 x 20 x 1		
SUPPLY AIR GRILL	651A	2	20 x 20 x 1		
SUPPLY AIR GRILL	654	4	20 x 20 x 1		
SUPPLY AIR GRILL	655	2	20 x 20 x 1		
SUPPLY AIR GRILL	656	4	20 x 20 x 1		
SUPPLY AIR GRILL	659	4	20 x 20 x 1		
SUPPLY AIR GRILL	707	4	20 x 20 x 1		
SUPPLY AIR GRILL	708	2	20 x 20 x 1		
SUPPLY AIR GRILL	709	4	20 x 20 x 1		
SUPPLY AIR GRILL	711	4	20 x 20 x 1		
SUPPLY AIR GRILL	713	2	20 x 20 x 1		
SUPPLY AIR GRILL	714	4	20 x 20 x 1		
SUPPLY AIR GRILL	715	2	20 x 20 x 1		
SUPPLY AIR GRILL	716	2	20 x 20 x 1		
SUPPLY AIR GRILL	717	2	20 x 20 x 1		
SUPPLY AIR GRILL	718	4	20 x 20 x 1		
SUPPLY AIR GRILL	722	4	20 x 20 x 2		
SUPPLY AIR GRILL	724	4	20 x 20 x 1		
SUPPLY AIR GRILL	726	4	20 x 20 x 1		
SUPPLY AIR GRILL	728	4	20 x 20 x 1		
SUPPLY AIR GRILL	729	4	20 x 20 x 1		
SUPPLY AIR GRILL	736	4	20 x 20 x 2		
SUPPLY AIR GRILL	737	2	20 x 20 x 3		
SUPPLY AIR GRILL	738	2	20 x 20 x 1		
SUPPLY AIR GRILL	740	6	20 x 20 x 1		
SUPPLY AIR GRILL	741	4	20 x 20 x 1		
SUPPLY AIR GRILL	742	4	20 x 20 x 1		
SUPPLY AIR GRILL	745	2	20 x 20 x 1		
SUPPLY AIR GRILL	746	2	20 x 20 x 1		
SUPPLY AIR GRILL	747	4	20 x 20 x 1		
SUPPLY AIR GRILL	749	6	20 x 20 x 1		
				TOTAL	

FILTERS FOR SCHOOL OF DENTISTRY

Type	Room #	Qty	Size	Unit Price	Extended Price
AHU - E-2-A	2302	8	24 x 24 x 2		
AHU - E-2-A	2302	2	12 x 24 x 2		
AHU 1-1	RECEIVING	2	24 x 24 x 2		
AHU 1-2	MAINT. SHOP	2	24 x 24 x 2		
AHU 1-3	BEHIND POLICE	4	20 x 24 x 2		
AHU -E-2-B	2329	8	24 x 24 x 2		
AHU -E-2-B	2329	2	12 x 24 x 2		
AHU -E-3-A	3302	8	24 x 24 x 2		
AHU -E-3-A	3302	2	16 x 20 x 2		
AHU -E-3-B	3329	6	24 x 24 x 2		
AHU -E-3-B	3329	2	12 x 24 x 2		
AHU -E-3-B-2	3329	4	16 x 25 x 2		
AHU -E-4-A	4302	8	24 x 24 x 2		
AHU -E-4-B	4329F	8	24 x 24 x 2		
AHU -E-4-B	4329F	2	12 x 24 x 2		
AHU -E-5-A	5302	8	24 x 24 x 2		
AHU -E-5-A	5302	2	12 x 24 x 2		
AHU -E-5-B	5324	8	24 x 24 x 2		
AHU -E-5-B	5324	2	12 x 24 x 2		
AHU -E-6-A	6302	4	20 x 24 x 2		
AHU -E-6-A	6302	4	20 x 20 x 2		
AHU -E-6-B	6320	2	20 x 20 x 2		
AHU -E-6-B	6320	6	20 x 20 x 2		
AHU -E-6-C	6405	3	20 x 20 x 2		
AHU -E-6-D	6409	1	20 x 25 x 2		
AHU -E-6-E	6411	2	16 x 20 x 2		
AHU -E-7-A	7302	4	12 x 24 x 2		
AHU -E-7-A	7302	4	20 x 24 x 2		
AHU -E-7-B	7324	8	24 x 24 x 2		
AHU -E-7-B	7324	2	12 x 24 x 2		
AHU -E-7-C	7407	6	16 x 20 x 2		
AHU -E-7-C	7407	2	16 x 25 x 2		
AHU -E-7-D	7406	6	16 x 25 x 2		
AHU -E-8-A	9th FLOOR	3	24 x 24 x 2		
AHU -E-8-A	9th FLOOR	9	20 x 24 x 2		
AHU -E-8-B	9th FLOOR	12	20 x 24 x 2		
AHU -E-8-C	9th FLOOR	3	12 x 24 x 2		
AHU -E-8-C	9th FLOOR	9	24 x 24 x 2		
AHU -E-8-D	9th FLOOR	6	20 x 24 x 2		
AHU -E-8-D	9th FLOOR	12	12 x 24 x 2		
AHU -E-8-D	9th FLOOR	3	24 x 24 x 2		
AHU -EL-2-A	ADMIN 2110	8	20 x 20 x 2		
AHU -EL-2-B	ADMIN 2214	21	16 x 20 x 2		
AHU -EL-3-A	ADMIN 2110	18	16 x 20 x 2		
AHU -EL-3-A	ADMIN 2110	3	20 x 20 x 2		
AHU -EL-3-B	ADMIN 2214	10	16 x 25 x 2		
AHU -EL-4-A	ADMIN 4109 B	6	16 x 25 x 2		
AHU -EL-4-B	ADMIN 4109 B	6	16 x 25 x 2		
AHU -EL-4-C	ADMIN 4206	2	16 x 20 x 2		

FILTERS FOR SCHOOL OF DENTISTRY

Type	Room #	Qty	Size	Unit Price	Extended Price
AHU -EL-4-C	ADMIN 4206	4	16 x 25 x 2		
AHU -EL-4-D	ADMIN 4206	6	16 x 20 x 2		
FAN COIL - 3RD FLOOR STERILIZER	3RD FLOOR sterilizer room	2	20 x 20 x 2		
FAN COIL - BASEMENT	ELEVATOR ROOM	6	20 x 24 x 2		
FAN COIL - ELEVATOR	ADMIN ROOF	2	16 x 25 x 2		
FAN COIL - ELEVATOR	CLINIC ROOF	2	16 x 25 x 2		
FAN COIL - LOBBY	SIDE DOORS	1	14 x 25 x 1		
LIEBERT - 4TH FLOOR	4th FLOOR CLINIC	2	28-1/2 x 28-1/2 x 4		
AHU 1L ADMIN BUILDING MERV 13	1st FLOOR OUTSIDE	4	20 x 24 x 12		
AHU 1L ADMIN BUILDING MERV 13	1st FLOOR OUTSIDE	4	24 x 24 x 12		
AHU 1L ADMIN BUILDING MERV 13	1st FLOOR OUTSIDE	3	12 x 24 x 12		
AHU 8A CLINIC BUILDING MERV 13	PENTHOUSE	3	12 x 24 x 12		
AHU 8A CLINIC BUILDING MERV 13	PENTHOUSE	8	20 x 20 x 12		
AHU 8B CLINIC BUILDING MERV 13	PENTHOUSE	3	12 x 24 x 12		
AHU 8B CLINIC BUILDING MERV 13	PENTHOUSE	8	20 x 20 x 12		
AHU 8C CLINIC BUILDING MERV 13	PENTHOUSE	6	20 x 24 x 12		
AHU 8D CLINIC BUILDING MERV 13	PENTHOUSE	6	20 x 24 x 12		
AHU 7A CLINIC BUILDING MERV 13	7302	6	20 x 24 x 12		
AHU 7B CLINIC BUILDING MERV 13	7324	3	12 x 24 x 12		
AHU 7B CLINIC BUILDING MERV 13	7324	8	20 x 20 x 12		
AHU 7C CLINIC BUILDING MERV 13	7324	2	12 x 24 x 12		
AHU 7C CLINIC BUILDING MERV 13	7324	1	20 x 24 x 12		
AHU 7C CLINIC BUILDING MERV 13	7324	2	24 x 24 x 12		
AHU 7D CLINIC BUILDING MERV 13	7324	2	12 x 24 x 12		
AHU 7D CLINIC BUILDING MERV 13	7324	1	20 x 24 x 12		
AHU 7D CLINIC BUILDING MERV 13	7324	2	24 x 24 x 12		
AHU 6A CLINIC BUILDING MERV 13	6302	9	20 x 20 x 12		

FILTERS FOR SCHOOL OF DENTISTRY

Type	Room #	Qty	Size	Unit Price	Extended Price
AHU 6A CLINIC BUILDING MERV 13	6302	3	20 x 24 x 12		
AHU 6B CLINIC BUILDING MERV 13	6320	9	20 x 20 x 12		
AHU 6B CLINIC BUILDING MERV 13	6320	3	20 x 24 x 12		
AHU 5A CLINIC BUILDING MERV 13	5302	9	20 x 20 x 12		
AHU 5A CLINIC BUILDING MERV 13	5302	3	20 x 24 x 12		
AHU 5B CLINIC BUILDING MERV 13	5320	9	20 x 20 x 12		
AHU 5B CLINIC BUILDING MERV 13	5320	3	20 x 24 x 12		
AHU 4A CLINIC BUILDING MERV 13	4302	3	12 x 24 x 12		
AHU 4A CLINIC BUILDING MERV 13	4302	8	20 x 20 x 12		
AHU 4B CLINIC BUILDING MERV 13	4329F	3	12 x 24 x 12		
AHU 4B CLINIC BUILDING MERV 13	4329F	8	20 x 20 x 12		
AHU 3A CLINIC BUILDING MERV 13	3302	9	20 x 20 x 12		
AHU 3A CLINIC BUILDING MERV 13	3302	3	20 x 24 x 12		
AHU 3B CLINIC BUILDING MERV 13	3357	3	20 x 24 x 12		
AHU 3B CLINIC BUILDING MERV 13	3357	9	20 x 20 x 12		
AHU 2A CLINIC BUILDING MERV 13	2302	9	20 x 20 x 12		
AHU 2A CLINIC BUILDING MERV 13	2302	3	20 x 24 x 12		
AHU 2B CLINIC BUILDING MERV 13	2312R	9	20 x 20 x 12		
AHU 2B CLINIC BUILDING MERV 13	2312R	3	20 x 24 x 12		
AHU-R1	ANNEX PENTHOUSE	32	12 X 24 X 2		
AHU-R2	ANNEX PENTHOUSE	32	12 X 24 X 2		
AHU-31	ANNEX 3518	8	16 X 20 X 2		
AHU-31	ANNEX 3518	12	24 X 24 X 2		
AHU-32	ANNEX 2511	2	12 X 24 X 2		
AHU-32	ANNEX 2511	1	20 X 24 X 2		

FILTERS FOR SCHOOL OF DENTISTRY

Type	Room #	Qty	Size	Unit Price	Extended Price
AHU-R1 ANNEX BUILDING MERV 14	PENTHOUSE	12	20 X 24 X 12		
AHU-R2 ANNEX BUILDING MERV 14	PENTHOUSE	12	20 X 24 X 12		
AHU-31 ANNEX BUILDING MERV 14	3518	9	20 X 24 X 12		
AHU-31 ANNEX BUILDING MERV 14	3518	3	20 X 20 X 12		
AHU-21 ANNEX BUILDING MERV 14	2522	12	20 X 20 X 12		
				TOTAL	

FILTERS FOR SETON

Type	Room #	Qty	Size	Unit Price	Extended Price
M-2	Mechanical Room Level 2	3	16x24x4		
M-2	Mechanical Room Level 2	9	20x24x4		
Fresh Air	Penthouse	6	12x24x2		
Fresh Air	Penthouse	36	24x24x2		
				TOTAL	

FILTERS FOR HUMAN DEVELOPMENT

Type	Room #	Qty	Size	Unit Price	Extended Price
AHU	103	4	24X20X2		
AHU	103	8	16x20x2		
AHU	132-B	12	24X20X2		
AHU	132-B	6	16x20x2		
AHU	205	8	24X24X2		
AHU	205	8	24X20X2		
AHU	240	30	12X24X2		
AHU	305	8	24X24X2		
AHU	361-B	8	24X24X2		
AHU	361-B	4	24X20X2		
AHU	408	30	12X24X2		
AHU	455-B	8	24X24X2		
				TOTAL	

FILTERS FOR LIONS / LSU CLINICS

Type	Room #	Qty	Size	Unit Price	Extended Price
AHU - L-1-5	120	4	20 x 25 x 2		
AHU - L-2-1	262-C	10	16 x 20 x 2		
AHU - L-2-2	249	12	16 x 20 x 2		
AHU - L-2-3	249	2	16 x 25 x 2		
AHU - L-2-3	249	2	16 x 20 x 2		
AHU - L-3-1	303	6	16 x 20 x 2		
AHU - L-3-2	303	4	16 x 25 x 2		
AHU - L-3-2	303	4	16 x 20 x 2		
AHU - L-3-3	335-C	2	16 x 25 x 2		
AHU - L-3-3	335-C	2	16 x 20 x 2		
AHU - L-3-4	335-C	6	16 x 25 x 2		
AHU - L-3-4	335-C	2	16 x 20 x 2		
AHU - L-4-1	428	6	16 x 25 x 2		
AHU - L-4-2	428	10	16 x 20 x 2		
AHU - L-4-3	426	6	16 x 25 x 2		
AHU - L-4-4	426	4	16 x 25 x 2		
AHU - L-4-4	426	2	16 x 20 x 2		
AHU - L-5-1	505	2	16 x 25 x 2		
AHU - L-5-1	505	2	16 x 20 x 2		
AHU - L-5-2	505	6	16 x 25 x 2		
AHU - L-5-3	556	2	20 x 16 x 2		
AHU - L-5-3	556	2	16 x 25 x 2		
AHU - L-5-4	556	6	16 x 25 x 2		
AHU - L-6-1	607	2	16 x 20 x 2		
AHU - L-6-1	607	2	16 x 25 x 2		
AHU - L-6-2	607	6	16 x 20 x 2		
AHU - L-7-1	779	8	20 x 24 x 2		
AHU - L-7-2	739	12	16 x 20 x 2		
AHU - L-8-3	837	12	20 x 25 x 2		
AHU - L-8-4	825	12	16 x 20 x 2		
AHU - L-8-4	825	8	20 x 24 x 2		
AHU - L-9-5	947	18	20 x 20 x 2		
AHU - L-9-6	934	12	16 x 20 x 2		
AHU - L-9-7	934	12	16 x 20 x 2		
AHU - L-9-8	Roof	4	20 x 25 x 2		
AHU - L-OA-1	303	12	16 x 20 x 2		
AHU - L-OA-2	335-C	12	16 x 20 x 2		
AHU - L-OA-3	262-C	7	16 x 20 x 2		
AHU - L-OA-3	262-C	4	20 x 24 x 2		
AHU - L-OA-4	426	4	16 x 25 x 2		
AHU - L-OA-4	426	4	16 x 20 x 2		
FAN COIL - ELEVATOR	1-4 (Roof)	1	60 x 10 x 1		
FAN COIL - ELEVATOR	FR Roof	1	60 x 10 x 1		
SUPPLY AIR GRILL	324	1	20 x 20 x 1		
SUPPLY AIR GRILL	326	4	20 x 20 x 1		
SUPPLY AIR GRILL	807	3	20 x 20 x 1		
SUPPLY AIR GRILL	811	2	20 x 20 x 1		
SUPPLY AIR GRILL	815	2	20 x 20 x 1		

FILTERS FOR LIONS / LSU CLINICS

Type	Room #	Qty	Size	Unit Price	Extended Price
SUPPLY AIR GRILL	816	4	20 x 20 x 1		
SUPPLY AIR GRILL	817	2	20 x 20 x 1		
SUPPLY AIR GRILL	818A	1	20 x 20 x 1		
SUPPLY AIR GRILL	820	2	20 x 20 x 1		
SUPPLY AIR GRILL	823	2	20 x 20 x 1		
SUPPLY AIR GRILL	826	4	20 x 20 x 1		
SUPPLY AIR GRILL	827	1	20 x 20 x 1		
SUPPLY AIR GRILL	829	5	20 x 20 x 1		
SUPPLY AIR GRILL	833	8	20 x 20 x 1		
SUPPLY AIR GRILL	934	6	20 x 20 x 1		
SUPPLY AIR GRILL	939	3	20 x 20 x 1		
SUPPLY AIR GRILL	942	4	20 x 20 x 1		
SUPPLY AIR GRILL	944	4	20 x 20 x 1		
SUPPLY AIR GRILL	945	4	20 x 20 x 1		
				TOTAL	

FILTERS FOR MEDICAL EDUCATION

Type	Room #	Qty	Size	Unit Price	Extended Price
AHU 2A	2213A	6	20 x 24 x 2		
AHU 2A	2213A	1	48 IN. WIDE x 20 FT. LONG		
AHU 2B	2103	15	12 x 24 x 2		
AHU 2C	2219	2	20 x 24 x 2		
AHU 2C	2219	4	24 x 24 x 2		
AHU 2D	2109	8	16 x 20 x 2		
AHU 3A	3216	12	20 x 24 x 2		
AHU 3B	3101B	18	16 x 25 x 2		
AHU 3C	3227	36	16 x 20 x 2		
AHU 3D	3204	24	20 x 24 x 2		
AHU 3D	3204	4	16 x 20 x 2		
AHU 4A	4116	36	16 x 20 x 2		
AHU 4B	4105	36	16 x 20 x 2		
AHU 4C	4228	36	16 x 20 x 2		
AHU 4D	4206	40	12 x 24 x 2		
AHU 5A	5135	40	12 x 24 x 2		
AHU 5B	5152	36	16 x 20 x 2		
AHU 5C	5245	36	16 x 20 x 2		
AHU 5D	5261	36	16 x 20 x 2		
AHU 6A	6137	50	12 x 24 x 2		
AHU 6B	6153	40	12 x 24 x 2		
AHU 6C	6242	6	16 x 20 x 2		
AHU 6C	6242	24	20 x 24 x 2		
AHU 6D	6257	6	16 x 20 x 2		
AHU 6D	6257	24	20 x 24 x 2		
AHU 7A	7141	40	12 x 24 x 2		
AHU 7B	7157	40	12 x 24 x 2		
AHU 7C	7251	40	12 x 24 x 2		
AHU 7D	7266	36	16 x 20 x 2		
AHU RTU#1	roof	8	16 x 20 x 2		
AHU RTU#1	roof	4	20 x 24 x 2		
AHU RTU#2	roof	8	16 x 20 x 2		
AHU RTU#2	roof	4	20 x 24 x 2		
ELEVATOR FAN COIL	6-7 (Roof)	2	20 x 20 x 1		
ELEVATOR FAN COIL	8 (Roof)	2	20 x 20 x 1		
ELEVATOR FAN COIL	1-4 (Roof)	2	20 x 20 x 1		
SUPPLY AIR GRILL	3205 T3	2	20 x 20 x 1		
SUPPLY AIR GRILL	5110	7	20 x 20 x 1		
SUPPLY AIR GRILL	5116	6	20 x 20 x 1		
SUPPLY AIR GRILL	5119	6	20 x 20 x 1		
SUPPLY AIR GRILL	5127	2	20 x 20 x 1		
SUPPLY AIR GRILL	5127A	3	20 x 20 x 1		
SUPPLY AIR GRILL	5128	3	20 x 20 x 1		
SUPPLY AIR GRILL	5132	7	20 x 20 x 1		
SUPPLY AIR GRILL	5132B	2	20 x 20 x 1		
SUPPLY AIR GRILL	5154	9	20 x 20 x 1		

FILTERS FOR MEDICAL EDUCATION

Type	Room #	Qty	Size	Unit Price	Extended Price
SUPPLY AIR GRILL	5219	10	20 x 20 x 1		
SUPPLY AIR GRILL	5219A	3	20 x 20 x 1		
SUPPLY AIR GRILL	5225	4	20 x 20 x 1		
SUPPLY AIR GRILL	5228	4	20 x 20 x 1		
SUPPLY AIR GRILL	5234	5	20 x 20 x 1		
SUPPLY AIR GRILL	5236	2	20 x 20 x 1		
SUPPLY AIR GRILL	5238	10	20 x 20 x 1		
SUPPLY AIR GRILL	5238A	2	20 x 20 x 1		
SUPPLY AIR GRILL	5240	1	20 x 20 x 1		
SUPPLY AIR GRILL	5241	1	20 x 20 x 1		
SUPPLY AIR GRILL	5243	1	20 x 20 x 1		
SUPPLY AIR GRILL	5246	4	20 x 20 x 1		
SUPPLY AIR GRILL	5247	2	20 x 20 x 1		
SUPPLY AIR GRILL	5251	4	20 x 20 x 1		
SUPPLY AIR GRILL	5254	1	20 x 20 x 1		
SUPPLY AIR GRILL	5255	3	20 x 20 x 1		
SUPPLY AIR GRILL	5258	16	20 x 20 x 1		
SUPPLY AIR GRILL	5259	14	20 x 20 x 1		
SUPPLY AIR GRILL	5259c	6	20 x 20 x 1		
SUPPLY AIR GRILL	5261	6	20 x 20 x 1		
SUPPLY AIR GRILL	5264A	1	20 x 20 x 1		
SUPPLY AIR GRILL	6103	2	20 x 20 x 1		
SUPPLY AIR GRILL	6103A	2	20 x 20 x 1		
SUPPLY AIR GRILL	6103B	2	20 x 20 x 1		
SUPPLY AIR GRILL	6108	4	20 x 20 x 1		
SUPPLY AIR GRILL	6109	5	20 x 20 x 1		
SUPPLY AIR GRILL	6109B	1	20 x 20 x 1		
SUPPLY AIR GRILL	6113	6	20 x 20 x 1		
SUPPLY AIR GRILL	6114	1	20 x 20 x 1		
SUPPLY AIR GRILL	6117A	2	20 x 20 x 1		
SUPPLY AIR GRILL	6120	1	20 x 20 x 1		
SUPPLY AIR GRILL	6121	4	20 x 20 x 1		
SUPPLY AIR GRILL	6122	1	20 x 20 x 1		
SUPPLY AIR GRILL	6123	3	20 x 20 x 1		
SUPPLY AIR GRILL	6123B	1	20 x 20 x 1		
SUPPLY AIR GRILL	6123D	1	20 x 20 x 1		
SUPPLY AIR GRILL	6123E	1	20 x 20 x 1		
SUPPLY AIR GRILL	6123F	1	20 x 20 x 1		
SUPPLY AIR GRILL	6124	1	20 x 20 x 1		
SUPPLY AIR GRILL	6124A	1	20 x 20 x 1		
SUPPLY AIR GRILL	6124B	1	20 x 20 x 1		
SUPPLY AIR GRILL	6124C	1	20 x 20 x 1		
SUPPLY AIR GRILL	6126	5	20 x 20 x 1		
SUPPLY AIR GRILL	6127A	1	20 x 20 x 1		
SUPPLY AIR GRILL	6129	4	20 x 20 x 1		
SUPPLY AIR GRILL	6129A	2	20 x 20 x 1		
SUPPLY AIR GRILL	6130	4	20 x 20 x 1		

FILTERS FOR MEDICAL EDUCATION

Type	Room #	Qty	Size	Unit Price	Extended Price
SUPPLY AIR GRILL	6132	2	20 x 20 x 1		
SUPPLY AIR GRILL	6132A	2	20 x 20 x 1		
SUPPLY AIR GRILL	6132B	1	20 x 20 x 1		
SUPPLY AIR GRILL	6133	6	20 x 20 x 1		
SUPPLY AIR GRILL	6133A	1	20 x 20 x 1		
SUPPLY AIR GRILL	6133B	1	20 x 20 x 1		
SUPPLY AIR GRILL	6136	4	20 x 20 x 1		
SUPPLY AIR GRILL	6142	5	20 x 20 x 1		
SUPPLY AIR GRILL	6143	6	20 x 20 x 1		
SUPPLY AIR GRILL	6146	2	20 x 20 x 1		
SUPPLY AIR GRILL	6148	4	20 x 20 x 1		
SUPPLY AIR GRILL	6149	4	20 x 20 x 1		
SUPPLY AIR GRILL	6152	6	20 x 20 x 1		
SUPPLY AIR GRILL	6154	4	20 x 20 x 1		
SUPPLY AIR GRILL	6156	6	20 x 20 x 1		
SUPPLY AIR GRILL	6208	4	20 x 20 x 1		
SUPPLY AIR GRILL	6209	7	20 x 20 x 1		
SUPPLY AIR GRILL	6211	3	20 x 20 x 1		
SUPPLY AIR GRILL	6221	3	20 x 20 x 1		
SUPPLY AIR GRILL	6222B	4	20 x 20 x 1		
SUPPLY AIR GRILL	6226A	3	20 x 20 x 1		
SUPPLY AIR GRILL	6226B	3	20 x 20 x 1		
SUPPLY AIR GRILL	6228	5	20 x 20 x 1		
SUPPLY AIR GRILL	6230	2	20 x 20 x 1		
SUPPLY AIR GRILL	6241	1	20 x 20 x 1		
SUPPLY AIR GRILL	6241A	2	20 x 20 x 1		
SUPPLY AIR GRILL	6247	4	20 x 20 x 1		
SUPPLY AIR GRILL	6256	2	20 x 20 x 1		
SUPPLY AIR GRILL	7101	6	20 x 20 x 1		
SUPPLY AIR GRILL	7113	4	20 x 20 x 1		
SUPPLY AIR GRILL	7115	2	20 x 20 x 1		
SUPPLY AIR GRILL	7116	3	20 x 20 x 1		
SUPPLY AIR GRILL	7118	5	20 x 20 x 1		
SUPPLY AIR GRILL	7119	6	20 x 20 x 1		
SUPPLY AIR GRILL	7122	4	20 x 20 x 1		
SUPPLY AIR GRILL	7123	4	20 x 20 x 1		
SUPPLY AIR GRILL	7174	6	20 x 20 x 1		
SUPPLY AIR GRILL	7147	4	20 x 20 x 1		
SUPPLY AIR GRILL	7148	4	20 x 20 x 1		
SUPPLY AIR GRILL	7158	4	20 x 20 x 1		
SUPPLY AIR GRILL	7160	4	20 x 20 x 1		
SUPPLY AIR GRILL	7211	4	20 x 20 x 1		
SUPPLY AIR GRILL	7214	4	20 x 20 x 1		
SUPPLY AIR GRILL	7222	4	20 x 20 x 1		
SUPPLY AIR GRILL	7225	4	20 x 20 x 1		
SUPPLY AIR GRILL	7226	2	20 x 20 x 1		
SUPPLY AIR GRILL	7226A	1	20 x 20 x 1		

FILTERS FOR MEDICAL EDUCATION

Type	Room #	Qty	Size	Unit Price	Extended Price
SUPPLY AIR GRILL	7239	4	20 x 20 x 1		
SUPPLY AIR GRILL	7247	2	20 x 20 x 1		
SUPPLY AIR GRILL	7226B	2	20 x 20 x 1		
SUPPLY AIR GRILL	7248	1	20 x 20 x 1		
SUPPLY AIR GRILL	7249	1	20 x 20 x 1		
SUPPLY AIR GRILL	7256	4	20 x 20 x 1		
SUPPLY AIR GRILL	7257	4	20 x 20 x 1		
SUPPLY AIR GRILL	7260	7	20 x 20 x 1		
SUPPLY AIR GRILL	7264	4	20 x 20 x 1		
SUPPLY AIR GRILL	7273	4	20 x 20 x 1		
				TOTAL	

FILTERS FOR RESIDENCE HALL

Type	Room #	Qty	Size	Unit Price	Extended Price
AHU 1	2nd floor	6	16x20x2		
AHU 2	2nd floor	2	16x20x2		
AHU 2	2nd floor	2	16x25x2		
AHU 3	2nd floor	2	16x20x2		
AHU 3	2nd floor	2	16x25x2		
AHU 4	2nd floor	3	16x25x2		
AHU 5	2nd floor	2	20x20x2		
AHU 6	2nd floor	3	16x20x2		
AHU 6	2nd floor	3	20x20x2		
AHU 7	11th floor B-tower	3	16x25x2		
ELEVATOR FAN COIL	P-B (penthouse)	1	12x24x1		
ELEVATOR FAN COIL	P-A (penthouse)	1	12x24x1		
ELEVATOR FAN COIL	P-C (penthouse)	1	12x24x1		
Fan Coil - Dorm Room	C1002	1	11 5/8 x 11 5/8 x 1		
Fan Coil - Dorm Room	C1003	1	11 5/8 x 11 5/8 x 1		
Fan Coil - Dorm Room	C1004	1	11 5/8 x 11 5/8 x 1		
Fan Coil - Dorm Room	C1005	1	11 5/8 x 11 5/8 x 1		
Fan Coil - Dorm Room	C1006	1	11 5/8 x 11 5/8 x 1		
Fan Coil - Dorm Room	C1009	1	11 5/8 x 11 5/8 x 1		
Fan Coil - Dorm Room	C1010	1	11 5/8 x 11 5/8 x 1		
Fan Coil - Dorm Room	C1011	1	11 5/8 x 11 5/8 x 1		
Fan Coil - Dorm Room	C1012	1	11 5/8 x 11 5/8 x 1		
Fan Coil - Dorm Room	C1001	1	11 5/8 x 11 5/8 x 1		
Fan Coil - Dorm Room	A36	1	11 5/8 x 17 5/8 x 1		
Fan Coil - Dorm Room	A35	1	11 5/8 x 17 5/8 x 1		
Fan Coil - Dorm Room	A33	1	11 5/8 x 17 5/8 x 1		
Fan Coil - Dorm Room	A32	1	11 5/8 x 17 5/8 x 1		
Fan Coil - Dorm Room	A47	1	11 5/8 x 17 5/8 x 1		
Fan Coil - Dorm Room	A43	1	11 5/8 x 17 5/8 x 1		
Fan Coil - Dorm Room	A46	1	11 5/8 x 17 5/8 x 1		
Fan Coil - Dorm Room	A58	1	11 5/8 x 17 5/8 x 1		
Fan Coil - Dorm Room	A53	1	11 5/8 x 17 5/8 x 1		
Fan Coil - Dorm Room	A54	1	11 5/8 x 17 5/8 x 1		
Fan Coil - Dorm Room	A57	1	11 5/8 x 17 5/8 x 1		
Fan Coil - Dorm Room	A68	1	11 5/8 x 17 5/8 x 1		
Fan Coil - Dorm Room	A63	1	11 5/8 x 17 5/8 x 1		
Fan Coil - Dorm Room	A64	1	11 5/8 x 17 5/8 x 1		
Fan Coil - Dorm Room	A67	1	11 5/8 x 17 5/8 x 1		
Fan Coil - Dorm Room	A78	1	11 5/8 x 17 5/8 x 1		
Fan Coil - Dorm Room	A73	1	11 5/8 x 17 5/8 x 1		
Fan Coil - Dorm Room	A74	1	11 5/8 x 17 5/8 x 1		
Fan Coil - Dorm Room	A77	1	11 5/8 x 17 5/8 x 1		
Fan Coil - Dorm Room	A88	1	11 5/8 x 17 5/8 x 1		
Fan Coil - Dorm Room	A83	1	11 5/8 x 17 5/8 x 1		
Fan Coil - Dorm Room	A84	1	11 5/8 x 17 5/8 x 1		
Fan Coil - Dorm Room	A87	1	11 5/8 x 17 5/8 x 1		
Fan Coil - Dorm Room	A98	1	11 5/8 x 17 5/8 x 1		

FILTERS FOR RESIDENCE HALL

Type	Room #	Qty	Size	Unit Price	Extended Price
Fan Coil - Dorm Room	A93	1	11 5/8 x 17 5/8 x 1		
Fan Coil - Dorm Room	A94	1	11 5/8 x 17 5/8 x 1		
Fan Coil - Dorm Room	A97	1	11 5/8 x 17 5/8 x 1		
Fan Coil - Dorm Room	B36	1	11 5/8 x 17 5/8 x 1		
Fan Coil - Dorm Room	B35	1	11 5/8 x 17 5/8 x 1		
Fan Coil - Dorm Room	B33	1	11 5/8 x 17 5/8 x 1		
Fan Coil - Dorm Room	B32	1	11 5/8 x 17 5/8 x 1		
Fan Coil - Dorm Room	B46	1	11 5/8 x 17 5/8 x 1		
Fan Coil - Dorm Room	B42	1	11 5/8 x 17 5/8 x 1		
Fan Coil - Dorm Room	B43	1	11 5/8 x 17 5/8 x 1		
Fan Coil - Dorm Room	B45	1	11 5/8 x 17 5/8 x 1		
Fan Coil - Dorm Room	B58	1	11 5/8 x 17 5/8 x 1		
Fan Coil - Dorm Room	B53	1	11 5/8 x 17 5/8 x 1		
Fan Coil - Dorm Room	B54	1	11 5/8 x 17 5/8 x 1		
Fan Coil - Dorm Room	B57	1	11 5/8 x 17 5/8 x 1		
Fan Coil - Dorm Room	B66	1	11 5/8 x 17 5/8 x 1		
Fan Coil - Dorm Room	B62	1	11 5/8 x 17 5/8 x 1		
Fan Coil - Dorm Room	B63	1	11 5/8 x 17 5/8 x 1		
Fan Coil - Dorm Room	B65	1	11 5/8 x 17 5/8 x 1		
Fan Coil - Dorm Room	B78	1	11 5/8 x 17 5/8 x 1		
Fan Coil - Dorm Room	B73	1	11 5/8 x 17 5/8 x 1		
Fan Coil - Dorm Room	B74	1	11 5/8 x 17 5/8 x 1		
Fan Coil - Dorm Room	B77	1	11 5/8 x 17 5/8 x 1		
Fan Coil - Dorm Room	B88	1	11 5/8 x 17 5/8 x 1		
Fan Coil - Dorm Room	B83	1	11 5/8 x 17 5/8 x 1		
Fan Coil - Dorm Room	B84	1	11 5/8 x 17 5/8 x 1		
Fan Coil - Dorm Room	B87	1	11 5/8 x 17 5/8 x 1		
Fan Coil - Dorm Room	B98	1	11 5/8 x 17 5/8 x 1		
Fan Coil - Dorm Room	B93	1	11 5/8 x 17 5/8 x 1		
Fan Coil - Dorm Room	B94	1	11 5/8 x 17 5/8 x 1		
Fan Coil - Dorm Room	B97	1	11 5/8 x 17 5/8 x 1		
Fan Coil - Dorm Room	B98	1	11 5/8 x 17 5/8 x 1		
Fan Coil - Dorm Room	B93	1	11 5/8 x 17 5/8 x 1		
Fan Coil - Dorm Room	B94	1	11 5/8 x 17 5/8 x 1		
Fan Coil - Dorm Room	B97	1	11 5/8 x 17 5/8 x 1		
Fan Coil - Dorm Room	B1007	1	11 5/8 x 17 5/8 x 1		
Fan Coil - Dorm Room	B1008	1	11 5/8 x 17 5/8 x 1		
Fan Coil - Dorm Room	B1003	1	11 5/8 x 17 5/8 x 1		
Fan Coil - Dorm Room	B1004	1	11 5/8 x 17 5/8 x 1		
Fan Coil - Dorm Room	C32	1	11 5/8 x 17 5/8 x 1		
Fan Coil - Dorm Room	C33	1	11 5/8 x 17 5/8 x 1		
Fan Coil - Dorm Room	C35	1	11 5/8 x 17 5/8 x 1		
Fan Coil - Dorm Room	C36	1	11 5/8 x 17 5/8 x 1		
Fan Coil - Dorm Room	C47	1	11 5/8 x 17 5/8 x 1		
Fan Coil - Dorm Room	C46	1	11 5/8 x 17 5/8 x 1		
Fan Coil - Dorm Room	C43	1	11 5/8 x 17 5/8 x 1		
Fan Coil - Dorm Room	C42	1	11 5/8 x 17 5/8 x 1		

FILTERS FOR RESIDENCE HALL

Type	Room #	Qty	Size	Unit Price	Extended Price
Fan Coil - Dorm Room	C53	1	11 5/8 x 17 5/8 x 1		
Fan Coil - Dorm Room	C54	1	11 5/8 x 17 5/8 x 1		
Fan Coil - Dorm Room	C57	1	11 5/8 x 17 5/8 x 1		
Fan Coil - Dorm Room	C58	1	11 5/8 x 17 5/8 x 1		
Fan Coil - Dorm Room	C68	1	11 5/8 x 17 5/8 x 1		
Fan Coil - Dorm Room	C67	1	11 5/8 x 17 5/8 x 1		
Fan Coil - Dorm Room	C64	1	11 5/8 x 17 5/8 x 1		
Fan Coil - Dorm Room	C63	1	11 5/8 x 17 5/8 x 1		
Fan Coil - Dorm Room	C73	1	11 5/8 x 17 5/8 x 1		
Fan Coil - Dorm Room	C74	1	11 5/8 x 17 5/8 x 1		
Fan Coil - Dorm Room	C77	1	11 5/8 x 17 5/8 x 1		
Fan Coil - Dorm Room	C78	1	11 5/8 x 17 5/8 x 1		
Fan Coil - Dorm Room	C83	1	11 5/8 x 17 5/8 x 1		
Fan Coil - Dorm Room	C84	1	11 5/8 x 17 5/8 x 1		
Fan Coil - Dorm Room	C87	1	11 5/8 x 17 5/8 x 1		
Fan Coil - Dorm Room	C88	1	11 5/8 x 17 5/8 x 1		
Fan Coil - Dorm Room	C93	1	11 5/8 x 17 5/8 x 1		
Fan Coil - Dorm Room	C94	1	11 5/8 x 17 5/8 x 1		
Fan Coil - Dorm Room	C97	1	11 5/8 x 17 5/8 x 1		
Fan Coil - Dorm Room	C98	1	11 5/8 x 17 5/8 x 1		
Fan Coil - Dorm Room	A31	1	11 5/8 x 23 5/8 x 1		
Fan Coil - Dorm Room	A34	1	11 5/8 x 23 5/8 x 1		
Fan Coil - Dorm Room	A41	1	11 5/8 x 23 5/8 x 1		
Fan Coil - Dorm Room	A42	1	11 5/8 x 23 5/8 x 1		
Fan Coil - Dorm Room	A44	1	11 5/8 x 23 5/8 x 1		
Fan Coil - Dorm Room	A51	1	11 5/8 x 23 5/8 x 1		
Fan Coil - Dorm Room	A52	1	11 5/8 x 23 5/8 x 1		
Fan Coil - Dorm Room	A55	1	11 5/8 x 23 5/8 x 1		
Fan Coil - Dorm Room	A56	1	11 5/8 x 23 5/8 x 1		
Fan Coil - Dorm Room	A61	1	11 5/8 x 23 5/8 x 1		
Fan Coil - Dorm Room	A62	1	11 5/8 x 23 5/8 x 1		
Fan Coil - Dorm Room	A65	1	11 5/8 x 23 5/8 x 1		
Fan Coil - Dorm Room	A66	1	11 5/8 x 23 5/8 x 1		
Fan Coil - Dorm Room	A71	1	11 5/8 x 23 5/8 x 1		
Fan Coil - Dorm Room	A72	1	11 5/8 x 23 5/8 x 1		
Fan Coil - Dorm Room	A75	1	11 5/8 x 23 5/8 x 1		
Fan Coil - Dorm Room	A76	1	11 5/8 x 23 5/8 x 1		
Fan Coil - Dorm Room	A81	1	11 5/8 x 23 5/8 x 1		
Fan Coil - Dorm Room	A82	1	11 5/8 x 23 5/8 x 1		
Fan Coil - Dorm Room	A85	1	11 5/8 x 23 5/8 x 1		
Fan Coil - Dorm Room	A86	1	11 5/8 x 23 5/8 x 1		
Fan Coil - Dorm Room	A91	1	11 5/8 x 23 5/8 x 1		
Fan Coil - Dorm Room	A92	1	11 5/8 x 23 5/8 x 1		
Fan Coil - Dorm Room	A95	1	11 5/8 x 23 5/8 x 1		
Fan Coil - Dorm Room	A96	1	11 5/8 x 23 5/8 x 1		
Fan Coil - Dorm Room	KITCHEN	1	11 5/8 x 23 5/8 x 1		
Fan Coil - Dorm Room	A1007	1	11 5/8 x 23 5/8 x 1		

FILTERS FOR RESIDENCE HALL

Type	Room #	Qty	Size	Unit Price	Extended Price
Fan Coil - Dorm Room	B31	1	11 5/8 x 23 5/8 x 1		
Fan Coil - Dorm Room	B34	1	11 5/8 x 23 5/8 x 1		
Fan Coil - Dorm Room	B41	1	11 5/8 x 23 5/8 x 1		
Fan Coil - Dorm Room	B44	1	11 5/8 x 23 5/8 x 1		
Fan Coil - Dorm Room	B51	1	11 5/8 x 23 5/8 x 1		
Fan Coil - Dorm Room	B52	1	11 5/8 x 23 5/8 x 1		
Fan Coil - Dorm Room	B55	1	11 5/8 x 23 5/8 x 1		
Fan Coil - Dorm Room	B56	1	11 5/8 x 23 5/8 x 1		
Fan Coil - Dorm Room	B61	1	11 5/8 x 23 5/8 x 1		
Fan Coil - Dorm Room	B64	1	11 5/8 x 23 5/8 x 1		
Fan Coil - Dorm Room	B71	1	11 5/8 x 23 5/8 x 1		
Fan Coil - Dorm Room	B72	1	11 5/8 x 23 5/8 x 1		
Fan Coil - Dorm Room	B75	1	11 5/8 x 23 5/8 x 1		
Fan Coil - Dorm Room	B76	1	11 5/8 x 23 5/8 x 1		
Fan Coil - Dorm Room	B81	1	11 5/8 x 23 5/8 x 1		
Fan Coil - Dorm Room	B82	1	11 5/8 x 23 5/8 x 1		
Fan Coil - Dorm Room	B85	1	11 5/8 x 23 5/8 x 1		
Fan Coil - Dorm Room	B86	1	11 5/8 x 23 5/8 x 1		
Fan Coil - Dorm Room	B91	1	11 5/8 x 23 5/8 x 1		
Fan Coil - Dorm Room	B92	1	11 5/8 x 23 5/8 x 1		
Fan Coil - Dorm Room	B95	1	11 5/8 x 23 5/8 x 1		
Fan Coil - Dorm Room	B96	1	11 5/8 x 23 5/8 x 1		
Fan Coil - Dorm Room	B91	1	11 5/8 x 23 5/8 x 1		
Fan Coil - Dorm Room	B92	1	11 5/8 x 23 5/8 x 1		
Fan Coil - Dorm Room	B95	1	11 5/8 x 23 5/8 x 1		
Fan Coil - Dorm Room	B96	1	11 5/8 x 23 5/8 x 1		
Fan Coil - Dorm Room	B1006	1	11 5/8 x 23 5/8 x 1		
Fan Coil - Dorm Room	B1001	1	11 5/8 x 23 5/8 x 1		
Fan Coil - Dorm Room	B1002	1	11 5/8 x 23 5/8 x 1		
Fan Coil - Dorm Room	B1005	1	11 5/8 x 23 5/8 x 1		
Fan Coil - Dorm Room	C34	1	11 5/8 x 23 5/8 x 1		
Fan Coil - Dorm Room	C31	1	11 5/8 x 23 5/8 x 1		
Fan Coil - Dorm Room	C41	1	11 5/8 x 23 5/8 x 1		
Fan Coil - Dorm Room	C45	1	11 5/8 x 23 5/8 x 1		
Fan Coil - Dorm Room	C44	1	11 5/8 x 23 5/8 x 1		
Fan Coil - Dorm Room	C52	1	11 5/8 x 23 5/8 x 1		
Fan Coil - Dorm Room	C55	1	11 5/8 x 23 5/8 x 1		
Fan Coil - Dorm Room	C56	1	11 5/8 x 23 5/8 x 1		
Fan Coil - Dorm Room	C51	1	11 5/8 x 23 5/8 x 1		
Fan Coil - Dorm Room	C61	1	11 5/8 x 23 5/8 x 1		
Fan Coil - Dorm Room	C66	1	11 5/8 x 23 5/8 x 1		
Fan Coil - Dorm Room	C65	1	11 5/8 x 23 5/8 x 1		
Fan Coil - Dorm Room	C62	1	11 5/8 x 23 5/8 x 1		
Fan Coil - Dorm Room	C72	1	11 5/8 x 23 5/8 x 1		
Fan Coil - Dorm Room	C75	1	11 5/8 x 23 5/8 x 1		
Fan Coil - Dorm Room	C76	1	11 5/8 x 23 5/8 x 1		
Fan Coil - Dorm Room	C71	1	11 5/8 x 23 5/8 x 1		

FILTERS FOR RESIDENCE HALL

Type	Room #	Qty	Size	Unit Price	Extended Price
Fan Coil - Dorm Room	C82	1	115/8 x 235/8 x 1		
Fan Coil - Dorm Room	C85	1	115/8 x 235/8 x 1		
Fan Coil - Dorm Room	C86	1	115/8 x 235/8 x 1		
Fan Coil - Dorm Room	C81	1	115/8 x 235/8 x 1		
Fan Coil - Dorm Room	C92	1	115/8 x 235/8 x 1		
Fan Coil - Dorm Room	C95	1	115/8 x 235/8 x 1		
Fan Coil - Dorm Room	C96	1	115/8 x 235/8 x 1		
Fan Coil - Dorm Room	C91	1	115/8 x 235/8 x 1		
Fan Coil - Dorm Room	C1007	1	115/8 x 235/8 x 1		
Fan Coil - Dorm Room	C1008	1	115/8 x 235/8 x 1		
Fan Coil - Dorm Room	A1010	1	115/8 x 115/8 x 1		
Fan Coil - Dorm Room	A1011	1	115/8 x 115/8 x 1		
Fan Coil - Dorm Room	A1001	1	115/8 x 115/8 x 1		
Fan Coil - Dorm Room	A1002	1	115/8 x 115/8 x 1		
Fan Coil - Dorm Room	A1003	1	115/8 x 115/8 x 1		
Fan Coil - Dorm Room	A1004	1	115/8 x 115/8 x 1		
Fan Coil - Dorm Room	A1005	1	115/8 x 115/8 x 1		
Fan Coil - Dorm Room	A1006	1	115/8 x 115/8 x 1		
Fan Coil - Dorm Room	A1008	1	115/8 x 115/8 x 1		
Fan Coil - Dorm Room	A1009	1	115/8 x 115/8 x 1		
Fan Coil - Office	A1107	1	115/8 x 235/8 x 1		
Fan Coil - Office	A1110	1	115/8 x 115/8 x 1		
Fan Coil - Office	A1111	1	115/8 x 115/8 x 1		
Fan Coil - Office	A1101	1	115/8 x 115/8 x 1		
Fan Coil - Office	A1102	1	115/8 x 115/8 x 1		
Fan Coil - Office	12203	1	115/8 x 115/8 x 1		
Fan Coil - Office	A1104	1	115/8 x 115/8 x 1		
Fan Coil - Office	A1105	1	115/8 x 115/8 x 1		
Fan Coil - Office	A1106	1	115/8 x 115/8 x 1		
Fan Coil - Office	A1108	1	115/8 x 115/8 x 1		
Fan Coil - Office	A1109	1	115/8 x 115/8 x 1		
				TOTAL	

FILTERS FOR RESOURCE CENTER

5					
Type	Room #	Qty	Size	Unit Price	Extended Price
AHU - R-2-1	207-A	2	24x24x2		
AHU - R-2-1	207-A	2	12x24x2		
AHU - R-2-2	207-A	2	24x24x2		
AHU - R-2-2	207-A	2	12x24x2		
AHU - R-2-3	207-A	2	24x24x2		
AHU - R-2-3	207-A	3	12x24x2		
AHU - R-2-4	Pump Rm	2	20x20x2		
AHU - R-3-1	303-A	2	24x24x2		
AHU - R-3-1	303-A	2	12x24x2		
AHU - R-3-2	303-A	2	24x24x2		
AHU - R-3-2	303-A	2	12x24x2		
AHU - R-3-3	303-A	2	20x16x2		
AHU - R-3-3	303-A	1	16x25x2		
AHU - R-3-4	303-A	3	16x25x2		
AHU - R-3-5	303-A	1	16x16x2		
AHU - R-3-5	303-A	1	16x20x2		
AHU - R-4-1	403-A	2	24x24x2		
AHU - R-4-1	403-A	2	12x24x2		
AHU - R-4-2	403-A	2	24x24x2		
AHU - R-4-2	403-A	2	12x24x2		
AHU - R-4-3	403-A	3	16x25x2		
AHU - R-4-4	403-A	2	20x20x2		
AHU - R-5-1	501-C1	2	24x24x2		
AHU - R-5-1	501-C1	2	12x24x2		
AHU - R-5-2	501-C1	2	24x24x2		
AHU - R-5-2	501-C1	3	12x24x2		
AHU - R-5-3	501-C1	3	16x24x2		
AHU - R-5-4	501-C1	3	16x24x2		
AHU - R-6-1	613-A	2	24x24x2		
AHU - R-6-1	613-A	3	12x24x2		
AHU - R-6-2	613-A	2	24x24x2		
AHU - R-6-2	613-A	3	12x24x2		
AHU - R-6-3	613-A	3	16x25x2		
AHU - R-6-4	613-A	3	16x25x2		
AHU - R-7-1	719-B1	2	24x24x2		
AHU - R-7-1	719-B1	1	12x24x2		
AHU - R-7-2	719-B1	2	24x24x2		
AHU - R-7-2	719-B1	3	12x24x2		
AHU - R-7-3	719-B1	3	16x24x2		
AHU - R-7-4	719-B1	2	24x24x2		
AHU - R-7-4	719-B1	2	12x24x2		
AHU - R-8-1	817-A	2	24x24x2		
AHU - R-8-1	817-A	2	12x24x3		
AHU - R-8-2	817-A	2	24x24x2		
AHU - R-8-2	817-A	3	12x24x3		
AHU - R-8-3	817-A	2	16x20x2		
AHU - R-8-4	817-A	6	20x25x2		

FILTERS FOR RESOURCE CENTER

5					
Type	Room #	Qty	Size	Unit Price	Extended Price
AHU - R-9-1	PENTHOUSE	6	16x20x2		
AHU - R-9-2	PENTHOUSE	6	16x20x2		
AHU - R-9-3	PENTHOUSE	6	16x20x2		
AHU - R-9-4	PENTHOUSE	2	16x20x2		
AHU - R-9-5	PENTHOUSE	2	16x20x2		
ELEVATOR FAN COIL	1-4 (Roof)	3	16x20x2		
				TOTAL	

CENTER FOR ADVANCE LEARNING & SIMULATION

Type	Room #	Qty	Size	Unit Price	Extended Price
AHU - 1-1	3020	4	16 x 25 x 2		
AHU - 1-1	3020	3	20 x 25 x 2		
AHU - 1-2	3020	3	12 x 24 x 2		
AHU - 1-2	3020	2	16 x 20 x 2		
AHU - 1-2	3020	3	12 x 24 x 2		
AHU - 1-2	3020	15	24 x 24 x 2		
AHU - 1-2	3020	6	20 x 24 x 2		
AHU - 1-3	3020	3	12 x 24 x 2		
AHU - 1-3	3020	2	16 x 20 x 2		
AHU - 1-3	3020	6	20 x 20 x 2		
AHU - 1-4	3020	1	16 x 20 x 2		
AHU - 1-4	3020	3	16 x 25 x 2		
AHU - 1-4	3020	8	20 x 24 x 2		
AHU - 1-5	3020	1	16 x 20 x 2		
AHU - 1-5	3020	3	16 x 25 x 2		
AHU - 1-5	3020	8	20 x 24 x 2		
AHU - 2-1	3020	3	12 x 24 x 2		
AHU - 2-1	3020	15	24 x 24 x 2		
AHU - 4-1	4101	1	16 x 20 x 2		
AHU - 4-1	4101	4	16 x 25 x 2		
AHU - 4-1	4101	12	20 x 25 x 2		
AHU - 4-2	4101	1	16 x 20 x 2		
AHU - 4-2	4101	4	16 x 25 x 2		
AHU - 4-2	4101	12	20 x 25 x 2		
AHU - 5-1	5000	4	16 x 20 x 2		
AHU - 5-1	5000	1	16 x 25 x 2		
AHU - 5-1	5000	8	20 x 20 x 2		
AHU - 5-1	5000	2	20 x 25 x 2		
ERU - R -1	5000A - Roof	24	20 X 20 X 2		
ERU - R -1	5000A - Roof	16	20 X 24 X 2		
ERU - R -2	5000A - Roof	24	20 X 20 X 2		
ERU - R -2	5000A - Roof	16	20 X 24 X 2		
AHU - 6-1	6000	4	16 x 20 x 2		
AHU - 6-1	6000	1	16 x 25 x 2		
AHU - 6-1	6000	8	20 x 20 x 2		
AHU - 6-1	6000	2	20 x 25 x 2		

AHU - 7-1	7000	4	16 x 20 x 2		
AHU - 7-1	7000	1	16 x 25 x 2		
AHU - 7-1	7000	8	20 x 20 x 2		
AHU - 7-1	7000	2	20 x 25 x 2		
AHU - 8-1	8000	4	16 x 20 x 2		
AHU - 8-1	8000	1	16 x 25 x 2		
AHU - 8-1	8000	8	20 x 20 x 2		
AHU - 8-1	8000	2	20 x 25 x 2		
1-10	1304	8	20 X 20 X 2		
B1	Basement	20	20 X 24 X 2		
1-1	Basement	8	20 X 24 X 2		
1-2	Basement	8	20 X 20 X 2		
B-6	Basement	12	20 x 24 x 2		
B1	Basement	4	15.5 X 24 X 2		
1-1	Basement	4	12 X 24 X 2		
1-2	Basement	8	20 x 24 x 2		
ERU - R -2	4TH FLR ROOF	12	20 X 20 X 12		
ERU - R -2	4TH FLR ROOF	8	20 X 24 X 12		
				TOTAL	

FILTERS FOR DELGADO BUILDING

Type	Room #	Qty	Size	Unit Price	Extended Price
AHU - 5-1	101	2	16x25x2		
AHU - 5-1	101	2	16x20x2		
AHU - 3-1	308	15	24x24x4		
AHU - 4-1	434	15	24x24x4		
AHU - 5-1	534	15	24x24x4		
AHU - 6-1	642	15	24x24x4		
AHU - LP-2	LP-2	20	24x24x4		
AHU - 8-1	801A	1	18x25x1		
AHU - 8-2	801B	1	18x25x1		
				TOTAL	

FILTERS FOR STANISLAUS HALL

Type	Room #	Qty	Size	Unit Price	Extended Price
AHU-11A	11th floor	4	16x25x4		
AHU-11B	11th floor	4	16x25x4		
AHU-11C	11th floor	2	20x24x4		
AHU-144A	1st floor	8	20x24x4		
AHU-144B	1st floor	2	20x24x4		
AHU-305	305	2	20x20x4		
AHU-316	316	2	20x20x4		
AHU-324	324	2	20x20x4		
AHU-331	331	2	20x20x4		
AHU-338	338	2	20x20x4		
AHU-347	347	2	20x20x4		
AHU-405	405	2	20x20x4		
AHU-414	414	2	20x20x4		
AHU-419	419	2	20x20x4		
AHU-429	429	2	20x20x4		
AHU-433	433	2	20x20x4		
AHU-438	438	2	20x20x4		
ELEVATOR FAN COIL	Entergy Garage Roof	1	10x50x1		
ELEVATOR FAN COIL	Roof	3	10x59x1		
Fan Coil - Custodial Closet	552	1	10x33x1		
Fan Coil - Custodial Closet	652	1	10x33x1		
Fan Coil - Custodial Closet	752	1	10x33x1		
Fan Coil - Custodial Closet	852	1	10x33x1		
Fan Coil - Custodial Closet	952	1	10x33x1		
Fan Coil - Custodial Closet	1052	1	10x33x1		
Fan Coil - Dorm Room	528	1	16.25x26.75x1		
Fan Coil - Dorm Room	526	1	16.25x26.75x1		
Fan Coil - Dorm Room	524	1	16.25x26.75x1		
Fan Coil - Dorm Room	522	1	16.25x26.75x1		
Fan Coil - Dorm Room	628	1	16.25x26.75x1		
Fan Coil - Dorm Room	626	1	16.25x26.75x1		
Fan Coil - Dorm Room	624	1	16.25x26.75x1		
Fan Coil - Dorm Room	622	1	16.25x26.75x1		
Fan Coil - Dorm Room	728	1	16.25x26.75x1		
Fan Coil - Dorm Room	726	1	16.25x26.75x1		
Fan Coil - Dorm Room	724	1	16.25x26.75x1		
Fan Coil - Dorm Room	722	1	16.25x26.75x1		
Fan Coil - Dorm Room	828	1	16.25x26.75x1		
Fan Coil - Dorm Room	826	1	16.25x26.75x1		
Fan Coil - Dorm Room	824	1	16.25x26.75x1		
Fan Coil - Dorm Room	822	1	16.25x26.75x1		

FILTERS FOR STANISLAUS HALL

Type	Room #	Qty	Size	Unit Price	Extended Price
Fan Coil - Dorm Room	928	1	16.25x26.75x1		
Fan Coil - Dorm Room	926	1	16.25x26.75x1		
Fan Coil - Dorm Room	924	1	16.25x26.75x1		
Fan Coil - Dorm Room	922	1	16.25x26.75x1		
Fan Coil - Dorm Room	1024	1	16.25x26.75x1		
Fan Coil - Dorm Room	1026	1	16.25x26.75x1		
Fan Coil - Dorm Room	1022	1	16.25x26.75x1		
Fan Coil - Dorm Room	1028	1	16.25x26.75x1		
Fan Coil - Dorm Room	508	1	20x20x1		
Fan Coil - Dorm Room	557	1	20x20x1		
Fan Coil - Dorm Room	553	1	20x20x1		
Fan Coil - Dorm Room	552	1	20x20x1		
Fan Coil - Dorm Room	546	1	20x20x1		
Fan Coil - Dorm Room	543	1	20x20x1		
Fan Coil - Dorm Room	542	1	20x20x1		
Fan Coil - Dorm Room	539	1	20x20x1		
Fan Coil - Dorm Room	535	1	20x20x1		
Fan Coil - Dorm Room	533	1	20x20x1		
Fan Coil - Dorm Room	532	1	20x20x1		
Fan Coil - Dorm Room	529	1	20x20x1		
Fan Coil - Dorm Room	521	1	20x20x1		
Fan Coil - Dorm Room	518	1	20x20x1		
Fan Coil - Dorm Room	517	1	20x20x1		
Fan Coil - Dorm Room	514	1	20x20x1		
Fan Coil - Dorm Room	565	1	20x20x1		
Fan Coil - Dorm Room	563	1	20x20x1		
Fan Coil - Dorm Room	562	1	20x20x1		
Fan Coil - Dorm Room	559	1	20x20x1		
Fan Coil - Dorm Room	665	2	20x20x1		
Fan Coil - Dorm Room	663	2	20x20x1		
Fan Coil - Dorm Room	662	2	20x20x1		
Fan Coil - Dorm Room	659	1	20x20x1		
Fan Coil - Dorm Room	657	1	20x20x1		
Fan Coil - Dorm Room	653	1	20x20x1		
Fan Coil - Dorm Room	652	1	20x20x1		
Fan Coil - Dorm Room	646	1	20x20x1		
Fan Coil - Dorm Room	643	1	20x20x1		
Fan Coil - Dorm Room	642	1	20x20x1		
Fan Coil - Dorm Room	639	1	20x20x1		
Fan Coil - Dorm Room	633	1	20x20x1		
Fan Coil - Dorm Room	632	1	20x20x1		
Fan Coil - Dorm Room	629	1	20x20x1		
Fan Coil - Dorm Room	625	2	20x20x1		
Fan Coil - Dorm Room	621	1	20x20x1		
Fan Coil - Dorm Room	618	1	20x20x1		
Fan Coil - Dorm Room	617	1	20x20x1		
Fan Coil - Dorm Room	614	1	20x20x1		

FILTERS FOR STANISLAUS HALL

Type	Room #	Qty	Size	Unit Price	Extended Price
Fan Coil - Dorm Room	765	2	20x20x1		
Fan Coil - Dorm Room	763	2	20x20x1		
Fan Coil - Dorm Room	762	1	20x20x1		
Fan Coil - Dorm Room	759	1	20x20x1		
Fan Coil - Dorm Room	757	1	20x20x1		
Fan Coil - Dorm Room	753	1	20x20x1		
Fan Coil - Dorm Room	752	1	20x20x1		
Fan Coil - Dorm Room	747	1	20x20x1		
Fan Coil - Dorm Room	746	1	20x20x1		
Fan Coil - Dorm Room	743	1	20x20x1		
Fan Coil - Dorm Room	742	1	20x20x1		
Fan Coil - Dorm Room	735	1	20x20x1		
Fan Coil - Dorm Room	733	1	20x20x1		
Fan Coil - Dorm Room	732	1	20x20x1		
Fan Coil - Dorm Room	729	1	20x20x1		
Fan Coil - Dorm Room	721	1	20x20x1		
Fan Coil - Dorm Room	718	1	20x20x1		
Fan Coil - Dorm Room	717	1	20x20x1		
Fan Coil - Dorm Room	714	1	20x20x1		
Fan Coil - Dorm Room	711	1	20x20x1		
Fan Coil - Dorm Room	708	1	20x20x1		
Fan Coil - Dorm Room	865	2	20x20x1		
Fan Coil - Dorm Room	863	2	20x20x1		
Fan Coil - Dorm Room	862	1	20x20x1		
Fan Coil - Dorm Room	859	1	20x20x1		
Fan Coil - Dorm Room	857	1	20x20x1		
Fan Coil - Dorm Room	853	1	20x20x1		
Fan Coil - Dorm Room	846	1	20x20x1		
Fan Coil - Dorm Room	843	1	20x20x1		
Fan Coil - Dorm Room	839	1	20x20x1		
Fan Coil - Dorm Room	835	1	20x20x1		
Fan Coil - Dorm Room	833	1	20x20x1		
Fan Coil - Dorm Room	832	1	20x20x1		
Fan Coil - Dorm Room	829	1	20x20x1		
Fan Coil - Dorm Room	821	1	20x20x1		
Fan Coil - Dorm Room	818	1	20x20x1		
Fan Coil - Dorm Room	817	1	20x20x1		
Fan Coil - Dorm Room	814	1	20x20x1		
Fan Coil - Dorm Room	811	1	20x20x1		
Fan Coil - Dorm Room	808	1	20x20x1		
Fan Coil - Dorm Room	965	2	20x20x1		
Fan Coil - Dorm Room	963	2	20x20x1		
Fan Coil - Dorm Room	962	1	20x20x1		
Fan Coil - Dorm Room	959	1	20x20x1		
Fan Coil - Dorm Room	957	1	20x20x1		
Fan Coil - Dorm Room	953	1	20x20x1		
Fan Coil - Dorm Room	946	1	20x20x1		

FILTERS FOR STANISLAUS HALL

Type	Room #	Qty	Size	Unit Price	Extended Price
Fan Coil - Dorm Room	943	1	20x20x1		
Fan Coil - Dorm Room	942	1	20x20x1		
Fan Coil - Dorm Room	939	1	20x20x1		
Fan Coil - Dorm Room	935	1	20x20x1		
Fan Coil - Dorm Room	933	1	20x20x1		
Fan Coil - Dorm Room	932	1	20x20x1		
Fan Coil - Dorm Room	929	1	20x20x1		
Fan Coil - Dorm Room	921	1	20x20x1		
Fan Coil - Dorm Room	918	1	20x20x1		
Fan Coil - Dorm Room	917	1	20x20x1		
Fan Coil - Dorm Room	914	1	20x20x1		
Fan Coil - Dorm Room	911	1	20x20x1		
Fan Coil - Dorm Room	908	1	20x20x1		
Fan Coil - Dorm Room	1065	2	20x20x1		
Fan Coil - Dorm Room	1063	2	20x20x1		
Fan Coil - Dorm Room	1062	2	20x20x1		
Fan Coil - Dorm Room	1059	2	20x20x1		
Fan Coil - Dorm Room	1057	2	20x20x1		
Fan Coil - Dorm Room	1053	1	20x20x1		
Fan Coil - Dorm Room	1046	1	20x20x1		
Fan Coil - Dorm Room	1043	1	20x20x1		
Fan Coil - Dorm Room	1042	1	20x20x1		
Fan Coil - Dorm Room	1039	1	20x20x1		
Fan Coil - Dorm Room	1035	1	20x20x1		
Fan Coil - Dorm Room	1033	1	20x20x1		
Fan Coil - Dorm Room	1032	1	20x20x1		
Fan Coil - Dorm Room	1029	1	20x20x1		
Fan Coil - Dorm Room	1021	1	20x20x1		
Fan Coil - Dorm Room	1018	1	20x20x1		
Fan Coil - Dorm Room	1017	1	20x20x1		
Fan Coil - Dorm Room	1014	1	20x20x1		
Fan Coil - Dorm Room	1011	1	20x20x1		
Fan Coil - Dorm Room	1008	1	20x20x1		
Fan Coil - Dorm Room	1007	1	20x20x1		
Fan Coil - Dorm Room	1005	1	20x20x1		
Fan Coil - Hallway	2nd Floor	2	10x59x1		
Fan Coil - Hallway	2nd Floor	2	10x63x1		
Fan Coil - Hallway	5th Floor	2	20x20x1		
Fan Coil - Hallway	6th Floor	3	20x20x1		
Fan Coil - Hallway	7th Floor	3	20x20x1		
Fan Coil - Hallway	8th Floor	3	20x20x1		
Fan Coil - Hallway	9th Floor	3	20x20x1		
Fan Coil - Hallway	10th Floor	3	20x20x1		
Fan Coil - Lounge	525	2	20x20x1		
Fan Coil - Lounge	725	2	20x20x1		
Fan Coil - Lounge	825	2	20x20x1		
Fan Coil - Lounge	925	2	20x20x1		

FILTERS FOR STANISLAUS HALL

Type	Room #	Qty	Size	Unit Price	Extended Price
Fan Coil - Lounge	1025	2	20x20x1		
Fan Coil - Office	244	1	14x25x1		
Fan Coil - Walkway	Walkway 2nd floor	2	9.5x48x1		
Fan Coil - Walkway	Walkway 2nd floor	2	9.5x60x1		
				TOTAL	

Maintenance for Roman St Garage 2nd floor

Type	Room #	Qty	Size	Unit Price
FCU	MECHANICAL	1	12X24X1	
			TOTAL	

MAINTENANCE FOR GRAVIER GARAGE PENT HOUSE

Type	Room #	Qty	Size	Extended Price
FCU	PENT HOUSE	1	16X20X2	
			TOTAL	

Grand Total	
-------------	--