

**CITY OF BATON ROUGE  
PARISH OF EAST BATON ROUGE**

May 7, 2025

**ADDENDUM NO. 4**

**TO: ALL BIDDERS**

**SUBJECT: JONES CREEK ROAD EXTENSION CLEARING AND EARTHWORK  
AIRLINE HWY. TO TIGER BEND RD.**

**CITY-PARISH PROJECT No. 12-CS-HC-0060A**

**ORIGINAL BID DATE: TUESDAY, APRIL 29, 2025 at 2:00 p.m.**

**ADDENDUM NO. 2 REVISED BID DATE: TUESDAY, MAY 6, 2025 at 2:00 p.m.**

**ADDENDUM NO. 3 REVISED BID DATE: TUESDAY, MAY 13, 2025 at 2:00 p.m.**

The following revisions shall be incorporated in and take precedence over any conflicting part of the original contract documents.

**PART 1. UNIFORM CONSTRUCTION BID FORMS**

**UNIFORM CONSTRUCTION BID FORMS**

Replace Uniform Construction Bid Forms pages 1 of 7 thru 7 of 7 with the attached Uniform Construction Bid Forms pages 1 of 7 thru 7 of 7. Revised 5/7/25. (Attachment C)

**PART 2. SPECIAL PROVISIONS AND CONTRACT DOCUMENTS**

**UNIFORM CONSTRUCTION BID FORMS**

Replace Uniform Construction Bid Forms pages 1 of 7 thru 7 of 7 with the attached Uniform Construction Bid Forms pages 1 of 7 thru 7 of 7. Revised 5/7/25. (Attachment D)

**FINAL PLANS**

**SHEET 2**

Replace Plan Sheet 2, entitled Summary of Estimated Quantities, with the attached Plan Sheet 2. Revised 4/30/2025. (Attachment B).

**SHEET 2a**

Replace Plan Sheet 2a, entitled Summary Tables, with the attached Plan Sheet 2a. Revised 4/30/2025. (Attachment B).

**SHEET 31**

Replace Plan Sheet 31, entitled STR. 401 RCB Extension, with the attached Plan Sheet 31. Revised 4/30/25. (Attachment B).

**RESPONSES TO BIDDER QUESTIONS**

**QUESTION 1:**

- a) Is the intent for the contractor to remove any surcharge material in this contract?
- b) If the contractor is directed to remove embankment material at any time, will this be paid as General Excavation?



RESPONSE:

- a) No, the surcharge material is to remain in place.
- b) Removal of excess surcharge material is addressed in Contract Special Provision Section 203-10(b).

**QUESTION 2:**

The plan notes and specifications do not address payment for work done past the estimated settlement period. Please advise on additional payment past the 9 month period.

RESPONSE:

Refer to Specifications Section 203 and plans notes related to surcharge.

**QUESTION 3:**

Are there any restrictions on when the storm drain can be installed?

RESPONSE:

None.

**QUESTION 4:**

The schedule of items, summary of drainage structures, and plan sheet 31 show 10'x8' RCB at 308 LF. Plan sheet 24, shows 380 LF. It appears that 380 LF is the correct amount. Please advise.

RESPONSE:

See revised plan sheets included in this addendum.

**QUESTION 5:**

Will days be charged to the project during the 9 months surcharge period?

RESPONSE:

Yes.

**UNIFORM CONSTRUCTION BID FORMS**

With reference to Page UCBF 1 of 4, the Bidder shall indicate receipt of this Addendum in the space provided. Failure to indicate receipt of this Addendum may be cause for the bid to be rejected.

For online [www.centralbidding.com](http://www.centralbidding.com) bidders: An acknowledgment of this addendum will be prompted by the Expedite bidding program prior to formally submitting the bid. Technical addendums may have been created on the Central Bidding website for any changes made due to errors of input of schedule of bid items. The technical addendums might not be numbered the same as paper copy addendums that DPW issues to contractors who have picked up plans directly from them. Contractor should be aware that the technical addendums must be acknowledged when submitting the bid.

**APPROVED:**

A handwritten signature in blue ink, appearing to read "Daniel Rosenquist", followed by the word "for." in a cursive script.

Daniel Rosenquist, P.E.

Chief Design & Construction Engineer



SUMMARY OF ESTIMATED QUANTITIES			
ITEM NO.	DESCRIPTION	UNIT	QUANTITY
2010200	CLEARING AND GRUBBING	ACRE	55.8
2020100	REMOVAL OF STRUCTURES AND OBSTRUCTIONS	LUMP	1
2020101	REMOVAL OF STRUCTURE AND FOUNDATION (14866 TIGER BEND RD)	EACH	2
2020102	REMOVAL OF STRUCTURE AND FOUNDATION (7170 BARINGER RD)	EACH	1
2020301	REMOVAL OF CONCRETE REVETMENT	SY	2,092
2020600	REMOVAL OF CONCRETE WALKS AND DRIVES	SY	1,668
2020902	SAW CUT SURFACES - CONCRETE	LF	86
2030100	GENERAL EXCAVATION	CY	141,526
2030200	EMBANKMENT	CY	150,940
6010100	CLASS 6A4000 CONCRETE	CY	61.77
6010500	REINFORCING STEEL	LB	5,910
7010115	15" STORM DRAIN PIPE	LF	16
7010118	18" STORM DRAIN PIPE	LF	8
7010242	42" REINFORCED CONCRETE PIPE	LF	638
7010423	9' X 5' REINFORCED CONCRETE BOX CULVERT	LF	140
7010431	10' X 8' REINFORCED CONCRETE BOX CULVERT	LF	380
7020310	RETICULINE GRATE INLET (CPS 702-15) (FRAME AND GRATE ONLY)	EACH	1
7020311	GRATE INLET (702-20)	EACH	4
7040504	4" CAST-IN-PLACE CONCRETE REVETMENT	SY	121.1
7040506	6" CAST-IN-PLACE CONCRETE REVETMENT	SY	527.6
7050202	30-LB. RIPRAP	CY	223.4
7050203	55-LB. RIPRAP	CY	169.6
8028100	PLUG AND ABANDON SEWER PIPE (CAP EACH END)	LUMP	1
817003Q	36" TRENCHED CASING INCLUDING CARRIER PIPE	LF	214
9020105	5-FT. CHAIN LINK FENCE	LF	2,628
9020303	3-FT. CHAIN LINK GATE, 5-FT. HEIGHT	EACH	4
9030200	TEMPORARY HAY BALES	EACH	80
9030400	TEMPORARY SEDIMENT CHECKDAMS (STONE)	EACH	1
9030500	TEMPORARY SILT FENCING	LF	22,782
9030800	SEED	LB	309
9030900	FERTILIZER	LB	10,304
9031000	WATER	MGAL	249
9031300	FIBER MULCH	SY	49,872
9031400	EROSION CONTROL MAT	SY	128
9031600	STORM WATER POLLUTION PREVENTION PLAN	LUMP	1
9050100	TEMPORARY SIGNS AND BARRICADES	LUMP	1
9090100	MOBILIZATION	LUMP	1
9900001	TEMPORARY STONE CONSTRUCTION ENTRANCE	EACH	4
9900004	PAYMENT ADJUSTMENT (FUELS AND ASPHALT CEMENTS)	DOLLAR	56,900
9900014	SETTLEMENT PLATE INSTALLATION AND MONITORING	EACH	7

GENERAL NOTES

1. CONTRACTOR SHALL PROVIDE, ERECT, AND MAINTAIN ALL NECESSARY BARRICADES, SUITABLE LIGHTS, AND DANGER SIGNALS AND SHALL TAKE ALL THE NECESSARY PRECAUTIONS FOR THE PROTECTION OF WORK AND SAFETY OF THE GENERAL PUBLIC. ALL SAFETY LIGHTING AND MARKING SHALL MEET OR EXCEED THE REQUIREMENTS AS DESCRIBED IN THE "MANUAL ON UNIFORM TRAFFIC CONTROL DEVICES" PUBLISHED BY THE FEDERAL HIGHWAY ADMINISTRATION.
2. ALL TREES, SHRUBS, ETC. LOCATED WITHIN THE REQ'D. R/W SHALL BE REMOVED. ALL COST SHALL BE INCLUDED IN THE ITEM BID FOR CLEARING AND GRUBBING (ITEM NO. 2010200). THE CONTRACTOR SHALL NOTIFY THE ADJACENT PROPERTY OWNER 14 DAYS PRIOR TO REMOVAL OF TREES, SHRUBS, ETC.
3. REMOVAL OF EXISTING FENCE AND REMOVAL OF CONCRETE BOX CULVERT/RETAINING WALL SHALL BE INCLUDED IN THE ITEM BID FOR REMOVAL OF STRUCTURES AND OBSTRUCTIONS (ITEM NO. 2020100).
4. ALL EXISTING DRIVES ARE TO REMAIN UNLESS SPECIFICALLY NOTED TO BE REMOVED.
5. FOR BEDDING AND BACKFILL DETAILS FOR STORM DRAIN PIPE AND RCB CULVERTS, SEE STD. PLAN 701-01.
6. STORM DRAIN PIPE SHALL BE REINFORCED CONCRETE PIPE (RCP) OR RIBBED POLYVINYL CHLORIDE PIPE (RPVCP).
7. ALL AREAS WITH PLACED EMBANKMENT AS WELL AS DITCHES SHALL RECEIVE SEEDING, FERTILIZATION, WATER AND MULCH PER SECTION 903-3.2.
8. EMBANKMENT IS AS PER SPECIAL PROVISION SECTION 203. HEADERS SHALL BE CONSTRUCTED PER SECTION 203-7(c). A 12" PLASTIC SOIL BLANKET SHALL BE CONSTRUCTED ON TOP OF FILL EMBANKMENT AS PER SECTION 203-7(e)(1).
9. CONTRACTOR TO PROVIDE POSITIVE DRAINAGE THROUGHOUT CONSTRUCTION. ANY TEMPORARY DRAINAGE PIPE OR STRUCTURES TO BE PROVIDED AT NO DIRECT PAY.



04-30-2025

BR

CITY OF BATON ROUGE  
OFFICE OF EAST BATON ROUGE

WAGGONER

SUMMARY OF  
ESTIMATED QUANTITIES

JONES CREEK RD (AIRLINE – TIGER BEND)

MOVEBR

4/30/25

4/22/25

4/22/25

REVISED 7010431

REVISED TO ADD NOTE 9

REVISION DESCRIPTION

ADF

ADF

BY

DESIGNED  
CHECKED

FARR  
AUCOIN

Detailed  
CHECKED

CORTIZ  
AUCOIN

DATE

JAN. 2025

SHEET

1 OF 1

PARISH

EAST BATON ROUGE

C.P. PROJECT

12 – CS – HC – 0060A

STATE PROJECT

SHEET NUMBER

2



EARTHWORK			
STATION	STATION	GENERAL EXCAVATION	EMBANKMENT
		CUYD	CUYD
60+95.0	81+00.0	979	65,621
81+00.0	94+50.0	18,927 *	81,361
200+56.0	203+55.0	0	3,958
DETENTION POND		121,620	0
TOTAL		141,526	150,940

\* - INCLUDES 1454 CU.YDS. OF UNSUITABLE MATERIAL

SAWCUTTING			
STATION	DESCRIPTION	SIDE C/L	LENGTH
			FEET
203+27	PROFIT REVETMENT	RT/LT	80
204+64	SIDEWALK - 7170 BARINGER RD	RT/LT	6
TOTAL			86

STATION	STATION	SIDE OF C/L	DESCRIPTION	5-FT. CHAIN LINK FENCE	3-FT. CHAIN LINK GATE, 5-FT. HEIGHT
				LNFT	EACH
64+84	79+80	LT	DETENTION POND / KIMBLE PROPERTY	2157	
90+99	92+29	RT	TIGER BEND @ CONCRETE CANAL LINING	300	
203+09	203+45	LT	PROFIT @ RCB / CONC. CANAL	95	
203+10	203+46	RT	PROFIT @ RCB / CONC. CANAL	76	
203+10		LT/RT	PROFIT @ RCB / CONC. CANAL		2
203+46		LT/RT	PROFIT @ RCB / CONC. CANAL		2
TOTAL				2,628	4

REVETMENT						
STATION	STATION	DESCRIPTION	REMOVAL OF CONCRETE REVETMENT	4" C.I.P. CONCRETE REVETMENT	6" C.I.P. CONCRETE REVETMENT	30-LB RIP RAP
			SQYD	SQYD	SQYD	CUYD
65+60		DITCH OUTFALL @ POND				24.5
73+80		STRUCTURE 799a POND INLET				4.5
78+37	80+44	LEFT TOE SLOPE REVETMENT				194.4
90+30	93+64	EXISTING CONC. CANAL LINING	1,670			
90+99	91+49	RIP RAP CANAL TRANSITION				169.6
91+49	92+30	CONCRETE CANAL LINING		93.8	423.1	
203+28		EXISTING CONC. CANAL LINING	422			
203+28		CONCRETE CANAL LINING TRANSITION (LT & RT)		27.3	104.5	
TOTAL			2,092	121.1	527.6	223.4

SUMMARY OF DRAINAGE STRUCTURES

STRUCTURE NUMBER	STATION	SIDE OF C/L	DESCRIPTION	PLAN	TYPE	CONCRETE JUNCTION BOX	STORM DRAIN PIPE (TYPE 3 JTS.)			RETICULINE GRATE INLET (FRAME AND GRATE ONLY)	RCB			
						702-20	15"	18"	42"		10' X 8'	9' X 5'	CONCRETE	REBAR
						EACH	LNFT	LNFT	LNFT		LNFT	LNFT	CUYD	LB
799a	73+77	LT	POND INLET STRUCTURE							1			13.15	2,194
799	74+64	LT	42" X 172' STORM DRAIN PIPE		RCP				172					
798	75+50	LT	CONCRETE JUNCTION BOX	1	702-20	JB	1							
797	76+14	LT	42" X 150' STORM DRAIN PIPE		RCP				150					
242	76+78	LT	CONCRETE JUNCTION BOX	1	702-20	JB	1							
237	76+72	LT	18" X 8' STORM DRAIN PIPE		SDP			8						
239	76+84	LT	15" X 8' STORM DRAIN PIPE		SDP		8							
401	92+99	RT	(2) 10' X 8' REINFORCED CONCRETE BOX CULVERT EXT. WITH HEADWALL		RCB					2	380		22.20	1,536
243	200+66	CL	42" X 174' STORM DRAIN PIPE		RCP				174					
244	201+55	LT	CONCRETE JUNCTION BOX	1	702-20	JB	1							
245	202+17	LT	42" X 96' STORM DRAIN PIPE		RCP				96					
705	202+74	LT	CONCRETE JUNCTION BOX	1	702-20	JB	1							
703	202+74	LT	15" X 8' STORM DRAIN PIPE		SDP		8							
706	202+98	LT	42" X 46' STORM DRAIN PIPE		RCP				46					
700	203+28	CL	(2) 9' X 5' REINFORCED CONCRETE BOX CULVERTS WITH HEADWALL		RCB							140	26.42	2,180
PROJECT TOTAL						4	16	8	638	1	380	140	61.77	5,910

Δ - BACKFILL MATERIAL TO BE BACKFILL SAND FOR ENTIRE LENGTH.

REMOVAL OF WALKS AND DRIVES

DESCRIPTION	AREA	REMOVAL OF CONCRETE WALKS AND DRIVES
	SQFT	SQYD
DRIVE - 14866 TIGER BEND RD	13397	1489
WALK - 7170 BARINGER RD.	308	34
DRIVE - 7170 BARINGER RD.	1307	145
TOTAL		1668



SHEET NUMBER2a

EAST BATON ROUCE

PARISH

C.F. PROJECT12-CS-HC-0060A

STATE PROJECT

DESIGNEDAUCOIN FARR

CHECKEDCORTAZ FARR

DATEJAN. 2025

SHEET1 OF 1

ADFA

ADFA

BY

4/30/25

4/22/25

NO.

DATE

REVISION DESCRIPTION

REVISED STRUCTURE 401 QUANTITY

REVISED SUMMARY OF DRAIN. STRUCTURES

MOVEBR

SUMMARY TABLES

JONES CREEK RD (AIRLINE-TIGER BEND)

BR

CITY OF BATON ROUGE

WAGGONER



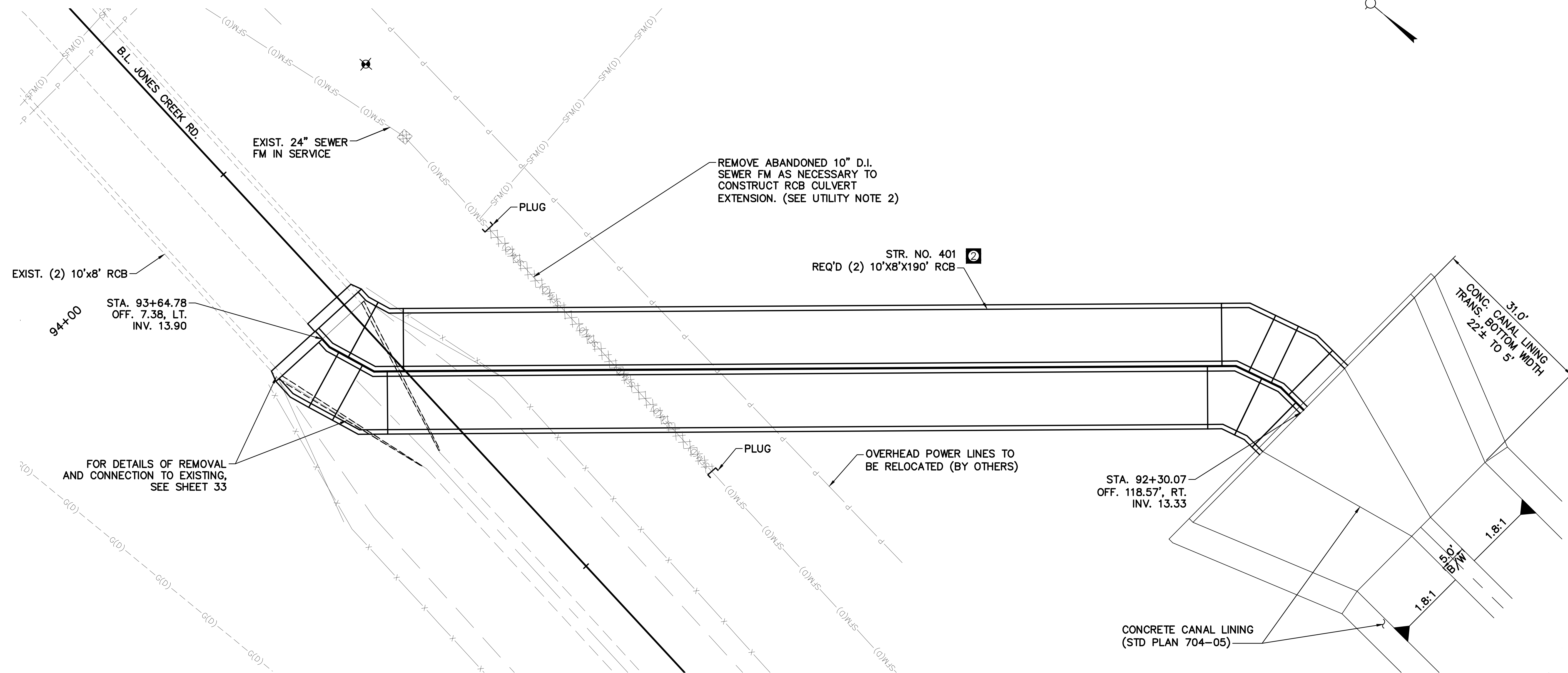

CONSTRUCTION NOTES:

1. FOR DETAILS OF RCB AND HEADWALL SEE SHEET 34.
2. FOR BEDDING DETAIL, SEE EBR STD. PLAN 701-01.
3. HEADWALL TO ONLY BE CONSTRUCTED ABOVE RCB BARRELS.
4. FOR DETAILS OF YEAR PLATE TO BE CONSTRUCTED ON HEADWALL, SEE EBR STD. PLAN 601-04.
5. RCB EXTENSION (PRECAST OR CAST IN PLACE) SHALL BE PAID PER LINEAR FOOT, MEASURED ALONG C.L. CULVERT.
6. HEADWALL, RETAINING WALL AND FOOTINGS TO BE PAID FOR AS STRUCTURAL CONCRETE CLASS 6A4000 AND DEFORMED REINFORCING STEEL.
7. FOR PRECAST BOX INSTALLATION SEE SHEET 36.
8. CONTRACTOR IS TO MAINTAIN DRAINAGE THROUGHOUT CONSTRUCTION. THE EXISTING OUTFALL CHANNEL IS TO REMAIN UNTIL RCB EXTENSION AND REALIGNED CHANNEL ARE OPERATIONAL.

UTILITY NOTE:

1. UTILITY LOCATIONS SHOWN ON ANY SHEET ARE APPROXIMATE AND ARE SHOWN FOR INFORMATIONAL PURPOSES ONLY. OTHER UTILITIES MAY EXIST IN THE AREA. THE CONTRACTOR IS REQUIRED TO CONTACT LOUISIANA ONE CALL BEFORE DIGGING. SEE SHEET 1a.
2. REMOVE APPROXIMATELY 60 FT. OF EXISTING, ABANDONED SEWER FORCE MAIN. INSTALL MECHANICAL PLUG AT BOTH ENDS. WORK TO BE PAID UNDER ITEM 8028100.

— REMOVE ABANDONED 10" D.I.  
SEWER FM AS NECESSARY TO  
CONSTRUCT RCB CULVERT  
EXTENSION. (SEE UTILITY NOTE 2)

STR. NO. 401  
REQ'D (2) 10'X8'X190' RCB

STA. 92+30.07 -  
OFF. 118.57', RT.  
INV. 13.33

CONCRETE CANAL LINING  
(STD PLAN 704-05)——

LAYOUT  
SCALE: 1" = 10'

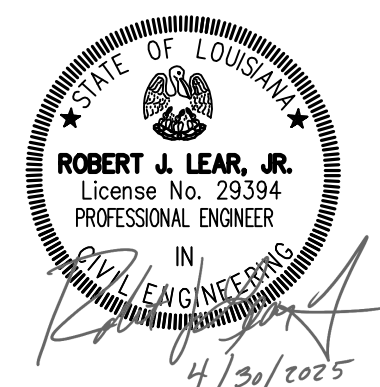

	 CITY OF BATON ROUGE <small>PARTIAL OF EAST BAYOU ROUGE</small>	STR. 401 RCB EXTENSION		<div style="display: flex; justify-content: space-between;"> <div>NO.</div> <div>DATE</div> <div>DESCRIPTION</div> <div>BY</div> </div> <div>② 4/30/25 REVISED STRUCTURE 401</div>	DESIGNED CHECKED	LEAR BANKSTON	PARISH	EAST BATON ROUGE	SHEET NUMBER	31
					DETAILED CHECKED	CORTEZ BANKSTON	C.P. PROJECT	12-CS-HC-0060A		
					DATE	JAN. 2025	STATE			
					ADF	1 OF 2	PROJECT			



**UNIT PRICE FORM**

**To: CITY OF BATON ROUGE**  
**PARISH OF EAST BATON ROUGE**  
**DEPARTMENT OF PUBLIC WORKS**

**BID FOR: JONES CREEK RD EXTENSION (AIRLINE-TIGER BEND)**  
**CLEARING AND EARTHWORK**

**Project Number: 12-CS-HC-0060A**

<i>Description:</i> <b>Clearing and Grubbing</b>				
REF. NO.	QUANTITY	UNIT OF MEASURE	UNIT PRICE	UNIT PRICE EXTENSION (Quantity X Unit Price)
<b>2010200</b>	<b>55.8</b>	<b>ACRE</b>	\$ _____ . _____	\$ _____ . _____
<i>Description:</i> <b>Removal of Structures and Obstructions</b>				
REF. NO.	QUANTITY	UNIT OF MEASURE	UNIT PRICE	UNIT PRICE EXTENSION (Quantity X Unit Price)
<b>2020100</b>	<b>1</b>	<b>LUMP</b>	\$ _____ . _____	\$ _____ . _____
<i>Description:</i> <b>Removal of Structures and Foundation (14866 Tiger Bend Rd)</b>				
REF. NO.	QUANTITY	UNIT OF MEASURE	UNIT PRICE	UNIT PRICE EXTENSION (Quantity X Unit Price)
<b>2020101</b>	<b>2</b>	<b>EACH</b>	\$ _____ . _____	\$ _____ . _____
<i>Description:</i> <b>Removal of Structures and Foundation (7170 Baringer Rd)</b>				
REF. NO.	QUANTITY	UNIT OF MEASURE	UNIT PRICE	UNIT PRICE EXTENSION (Quantity X Unit Price)
<b>2020102</b>	<b>1</b>	<b>EACH</b>	\$ _____ . _____	\$ _____ . _____
<i>Description:</i> <b>Removal of Concrete Revetment</b>				
REF. NO.	QUANTITY	UNIT OF MEASURE	UNIT PRICE	UNIT PRICE EXTENSION (Quantity X Unit Price)
<b>2020301</b>	<b>2092</b>	<b>SY</b>	\$ _____ . _____	\$ _____ . _____
<i>Description:</i> <b>Removal of Concrete Walks and Drives</b>				
REF. NO.	QUANTITY	UNIT OF MEASURE	UNIT PRICE	UNIT PRICE EXTENSION (Quantity X Unit Price)
<b>2020600</b>	<b>1668</b>	<b>SY</b>	\$ _____ . _____	\$ _____ . _____



**UNIT PRICE FORM**

To: CITY OF BATON ROUGE  
PARISH OF EAST BATON ROUGE  
DEPARTMENT OF PUBLIC WORKS

BID FOR: JONES CREEK RD EXTENSION (AIRLINE-TIGER BEND)  
CLEARING AND EARTHWORK

Project Number: 12-CS-HC-0060A

<i>Description:</i> <b>Saw Cut Surfaces - Concrete</b>				
REF. NO.	QUANTITY	UNIT OF MEASURE	UNIT PRICE	UNIT PRICE EXTENSION (Quantity X Unit Price)
<b>2020902</b>	<b>86</b>	<b>LF</b>	\$ _____.	\$ _____.
<i>Description:</i> <b>General Excavation</b>				
REF. NO.	QUANTITY	UNIT OF MEASURE	UNIT PRICE	UNIT PRICE EXTENSION (Quantity X Unit Price)
<b>2030100</b>	<b>141526</b>	<b>CY</b>	\$ _____.	\$ _____.
<i>Description:</i> <b>Embankment</b>				
REF. NO.	QUANTITY	UNIT OF MEASURE	UNIT PRICE	UNIT PRICE EXTENSION (Quantity X Unit Price)
<b>2030200</b>	<b>150940</b>	<b>CY</b>	\$ _____.	\$ _____.
<i>Description:</i> <b>Class 6A4000 Concrete</b>				
REF. NO.	QUANTITY	UNIT OF MEASURE	UNIT PRICE	UNIT PRICE EXTENSION (Quantity X Unit Price)
<b>6010100</b>	<b>61.77</b>	<b>CY</b>	\$ _____.	\$ _____.
<i>Description:</i> <b>Reinforcing Steel</b>				
REF. NO.	QUANTITY	UNIT OF MEASURE	UNIT PRICE	UNIT PRICE EXTENSION (Quantity X Unit Price)
<b>6010500</b>	<b>5910</b>	<b>LB</b>	\$ _____.	\$ _____.
<i>Description:</i> <b>15" Storm Drain Pipe</b>				
REF. NO.	QUANTITY	UNIT OF MEASURE	UNIT PRICE	UNIT PRICE EXTENSION (Quantity X Unit Price)
<b>7010115</b>	<b>16</b>	<b>LF</b>	\$ _____.	\$ _____.



**UNIT PRICE FORM**

**To: CITY OF BATON ROUGE**  
**PARISH OF EAST BATON ROUGE**  
**DEPARTMENT OF PUBLIC WORKS**

**BID FOR: JONES CREEK RD EXTENSION (AIRLINE-TIGER BEND)**  
**CLEARING AND EARTHWORK**

**Project Number: 12-CS-HC-0060A**

<i>Description:</i> <b>18" Storm Drain Pipe</b>				
REF. NO.	QUANTITY	UNIT OF MEASURE	UNIT PRICE	UNIT PRICE EXTENSION (Quantity X Unit Price)
<b>7010118</b>	<b>8</b>	<b>LF</b>	\$ _____.	\$ _____.
<i>Description:</i> <b>42" Reinforced Concrete Pipe</b>				
REF. NO.	QUANTITY	UNIT OF MEASURE	UNIT PRICE	UNIT PRICE EXTENSION (Quantity X Unit Price)
<b>7010242</b>	<b>638</b>	<b>LF</b>	\$ _____.	\$ _____.
<i>Description:</i> <b>9' x 5' Reinforced Concrete Box Culvert</b>				
REF. NO.	QUANTITY	UNIT OF MEASURE	UNIT PRICE	UNIT PRICE EXTENSION (Quantity X Unit Price)
<b>7010423</b>	<b>140</b>	<b>LF</b>	\$ _____.	\$ _____.
<i>Description:</i> <b>10' x 8' Reinforced Concrete Box Culvert</b>				
REF. NO.	QUANTITY	UNIT OF MEASURE	UNIT PRICE	UNIT PRICE EXTENSION (Quantity X Unit Price)
<b>7010431</b>	<b>380</b>	<b>LF</b>	\$ _____.	\$ _____.
<i>Description:</i> <b>Reticuline Grate Inlet (CPS 702-15) (Frame and Grate Only)</b>				
REF. NO.	QUANTITY	UNIT OF MEASURE	UNIT PRICE	UNIT PRICE EXTENSION (Quantity X Unit Price)
<b>7020310</b>	<b>1</b>	<b>EACH</b>	\$ _____.	\$ _____.
<i>Description:</i> <b>Grate Inlet (702-20)</b>				
REF. NO.	QUANTITY	UNIT OF MEASURE	UNIT PRICE	UNIT PRICE EXTENSION (Quantity X Unit Price)
<b>7020311</b>	<b>4</b>	<b>EACH</b>	\$ _____.	\$ _____.



**UNIT PRICE FORM**

**To: CITY OF BATON ROUGE**  
**PARISH OF EAST BATON ROUGE**  
**DEPARTMENT OF PUBLIC WORKS**

**BID FOR: JONES CREEK RD EXTENSION (AIRLINE-TIGER BEND)**  
**CLEARING AND EARTHWORK**

**Project Number: 12-CS-HC-0060A**

<i>Description:</i> <b>4" Cast-in-Place Concrete Revetment</b>				
REF. NO.	QUANTITY	UNIT OF MEASURE	UNIT PRICE	UNIT PRICE EXTENSION (Quantity X Unit Price)
<b>7040504</b>	<b>121.1</b>	<b>SY</b>	\$ _____.	\$ _____.
<i>Description:</i> <b>6" Cast-in-Place Concrete Revetment</b>				
REF. NO.	QUANTITY	UNIT OF MEASURE	UNIT PRICE	UNIT PRICE EXTENSION (Quantity X Unit Price)
<b>7040506</b>	<b>527.6</b>	<b>SY</b>	\$ _____.	\$ _____.
<i>Description:</i> <b>30-lb Riprap</b>				
REF. NO.	QUANTITY	UNIT OF MEASURE	UNIT PRICE	UNIT PRICE EXTENSION (Quantity X Unit Price)
<b>7050202</b>	<b>223.4</b>	<b>CY</b>	\$ _____.	\$ _____.
<i>Description:</i> <b>55-lb. Riprap</b>				
REF. NO.	QUANTITY	UNIT OF MEASURE	UNIT PRICE	UNIT PRICE EXTENSION (Quantity X Unit Price)
<b>7050203</b>	<b>169.6</b>	<b>CY</b>	\$ _____.	\$ _____.
<i>Description:</i> <b>Plug and Abandon Sewer Pipe (cap each end)</b>				
REF. NO.	QUANTITY	UNIT OF MEASURE	UNIT PRICE	UNIT PRICE EXTENSION (Quantity X Unit Price)
<b>8028100</b>	<b>1</b>	<b>LUMP</b>	\$ _____.	\$ _____.
<i>Description:</i> <b>36" Trenched Casing Including Carrier Pipe</b>				
REF. NO.	QUANTITY	UNIT OF MEASURE	UNIT PRICE	UNIT PRICE EXTENSION (Quantity X Unit Price)
<b>817003Q</b>	<b>214</b>	<b>LF</b>	\$ _____.	\$ _____.



**UNIT PRICE FORM**

**To: CITY OF BATON ROUGE**  
**PARISH OF EAST BATON ROUGE**  
**DEPARTMENT OF PUBLIC WORKS**

**BID FOR: JONES CREEK RD EXTENSION (AIRLINE-TIGER BEND)**  
**CLEARING AND EARTHWORK**

**Project Number: 12-CS-HC-0060A**

<i>Description:</i> <b>5-Ft. Chain Link Fence</b>				
REF. NO.	QUANTITY	UNIT OF MEASURE	UNIT PRICE	UNIT PRICE EXTENSION (Quantity X Unit Price)
<b>9020105</b>	<b>2628</b>	<b>LF</b>	\$ _____.	\$ _____.
<i>Description:</i> <b>3-ft. Chain Link Gate, 5-Ft. Height</b>				
REF. NO.	QUANTITY	UNIT OF MEASURE	UNIT PRICE	UNIT PRICE EXTENSION (Quantity X Unit Price)
<b>9020303</b>	<b>4</b>	<b>EACH</b>	\$ _____.	\$ _____.
<i>Description:</i> <b>Temporary Hay Bales</b>				
REF. NO.	QUANTITY	UNIT OF MEASURE	UNIT PRICE	UNIT PRICE EXTENSION (Quantity X Unit Price)
<b>9030200</b>	<b>80</b>	<b>EACH</b>	\$ _____.	\$ _____.
<i>Description:</i> <b>Temporary Sediment Check Dams (Stone)</b>				
REF. NO.	QUANTITY	UNIT OF MEASURE	UNIT PRICE	UNIT PRICE EXTENSION (Quantity X Unit Price)
<b>9030400</b>	<b>1</b>	<b>EACH</b>	\$ _____.	\$ _____.
<i>Description:</i> <b>Temporary Silt Fencing</b>				
REF. NO.	QUANTITY	UNIT OF MEASURE	UNIT PRICE	UNIT PRICE EXTENSION (Quantity X Unit Price)
<b>9030500</b>	<b>22782</b>	<b>LF</b>	\$ _____.	\$ _____.
<i>Description:</i> <b>Seed</b>				
REF. NO.	QUANTITY	UNIT OF MEASURE	UNIT PRICE	UNIT PRICE EXTENSION (Quantity X Unit Price)
<b>9030800</b>	<b>309</b>	<b>LB</b>	\$ _____.	\$ _____.



**UNIT PRICE FORM**

**To: CITY OF BATON ROUGE**  
**PARISH OF EAST BATON ROUGE**  
**DEPARTMENT OF PUBLIC WORKS**

**BID FOR: JONES CREEK RD EXTENSION (AIRLINE-TIGER BEND)**  
**CLEARING AND EARTHWORK**

**Project Number: 12-CS-HC-0060A**

<i>Description:</i> <b>Fertilizer</b>				
REF. NO.	QUANTITY	UNIT OF MEASURE	UNIT PRICE	UNIT PRICE EXTENSION (Quantity X Unit Price)
<b>9030900</b>	<b>10304</b>	<b>LB</b>	\$ _____ . _____	\$ _____ . _____
<i>Description:</i> <b>Water</b>				
REF. NO.	QUANTITY	UNIT OF MEASURE	UNIT PRICE	UNIT PRICE EXTENSION (Quantity X Unit Price)
<b>9031000</b>	<b>249</b>	<b>MGAL</b>	\$ _____ . _____	\$ _____ . _____
<i>Description:</i> <b>Fiber Mulch</b>				
REF. NO.	QUANTITY	UNIT OF MEASURE	UNIT PRICE	UNIT PRICE EXTENSION (Quantity X Unit Price)
<b>9031300</b>	<b>49872</b>	<b>SY</b>	\$ _____ . _____	\$ _____ . _____
<i>Description:</i> <b>Erosion Control Mat</b>				
REF. NO.	QUANTITY	UNIT OF MEASURE	UNIT PRICE	UNIT PRICE EXTENSION (Quantity X Unit Price)
<b>9031400</b>	<b>128</b>	<b>SY</b>	\$ _____ . _____	\$ _____ . _____
<i>Description:</i> <b>Storm Water Pollution Prevention Plan</b>				
REF. NO.	QUANTITY	UNIT OF MEASURE	UNIT PRICE	UNIT PRICE EXTENSION (Quantity X Unit Price)
<b>9031600</b>	<b>1</b>	<b>LUMP</b>	\$ _____ . _____	\$ _____ . _____
<i>Description:</i> <b>Temporary Signs and Barricades</b>				
REF. NO.	QUANTITY	UNIT OF MEASURE	UNIT PRICE	UNIT PRICE EXTENSION (Quantity X Unit Price)
<b>9050100</b>	<b>1</b>	<b>LUMP</b>	\$ _____ . _____	\$ _____ . _____



**UNIT PRICE FORM**

**To: CITY OF BATON ROUGE**  
**PARISH OF EAST BATON ROUGE**  
**DEPARTMENT OF PUBLIC WORKS**

**BID FOR: JONES CREEK RD EXTENSION (AIRLINE-TIGER BEND)**  
**CLEARING AND EARTHWORK**

**Project Number: 12-CS-HC-0060A**

<i>Description:</i> <b>Mobilization</b>				
REF. NO.	QUANTITY	UNIT OF MEASURE	UNIT PRICE	UNIT PRICE EXTENSION (Quantity X Unit Price)
<b>9090100</b>	<b>1</b>	<b>LUMP</b>	\$ _____ . _____	\$ _____ . _____
<i>Description:</i> <b>Temporary Stone Construction Entrance</b>				
REF. NO.	QUANTITY	UNIT OF MEASURE	UNIT PRICE	UNIT PRICE EXTENSION (Quantity X Unit Price)
<b>9900001</b>	<b>4</b>	<b>EACH</b>	\$ _____ . _____	\$ _____ . _____
<i>Description:</i> <b>Payment Adjustment (Fuels and Asphalt Cements)</b>				
REF. NO.	QUANTITY	UNIT OF MEASURE	UNIT PRICE	UNIT PRICE EXTENSION (Quantity X Unit Price)
<b>9900004</b>	<b>56900</b>	<b>DOL</b>	\$ _____ . _____	\$ _____ . _____
<i>Description:</i> <b>Settlement Plate Installation and Monitoring</b>				
REF. NO.	QUANTITY	UNIT OF MEASURE	UNIT PRICE	UNIT PRICE EXTENSION (Quantity X Unit Price)
<b>9900014</b>	<b>7</b>	<b>EACH</b>	\$ _____ . _____	\$ _____ . _____



**UNIT PRICE FORM**

To: CITY OF BATON ROUGE  
 PARISH OF EAST BATON ROUGE  
 DEPARTMENT OF PUBLIC WORKS

BID FOR: JONES CREEK RD EXTENSION (AIRLINE-TIGER BEND)  
 CLEARING AND EARTHWORK

Project Number: 12-CS-HC-0060A

<i>Description:</i> <b>Clearing and Grubbing</b>				
REF. NO.	QUANTITY	UNIT OF MEASURE	UNIT PRICE	UNIT PRICE EXTENSION (Quantity X Unit Price)
2010200	55.8	ACRE	\$ _____	\$ _____
<i>Description:</i> <b>Removal of Structures and Obstructions</b>				
REF. NO.	QUANTITY	UNIT OF MEASURE	UNIT PRICE	UNIT PRICE EXTENSION (Quantity X Unit Price)
2020100	1	LUMP	\$ _____	\$ _____
<i>Description:</i> <b>Removal of Structures and Foundation (14866 Tiger Bend Rd)</b>				
REF. NO.	QUANTITY	UNIT OF MEASURE	UNIT PRICE	UNIT PRICE EXTENSION (Quantity X Unit Price)
2020101	2	EACH	\$ _____	\$ _____
<i>Description:</i> <b>Removal of Structures and Foundation (7170 Baringer Rd)</b>				
REF. NO.	QUANTITY	UNIT OF MEASURE	UNIT PRICE	UNIT PRICE EXTENSION (Quantity X Unit Price)
2020102	1	EACH	\$ _____	\$ _____
<i>Description:</i> <b>Removal of Concrete Revetment</b>				
REF. NO.	QUANTITY	UNIT OF MEASURE	UNIT PRICE	UNIT PRICE EXTENSION (Quantity X Unit Price)
2020301	2092	SY	\$ _____	\$ _____
<i>Description:</i> <b>Removal of Concrete Walks and Drives</b>				
REF. NO.	QUANTITY	UNIT OF MEASURE	UNIT PRICE	UNIT PRICE EXTENSION (Quantity X Unit Price)
2020600	1668	SY	\$ _____	\$ _____



**UNIT PRICE FORM**

To: CITY OF BATON ROUGE  
PARISH OF EAST BATON ROUGE  
DEPARTMENT OF PUBLIC WORKS

BID FOR: JONES CREEK RD EXTENSION (AIRLINE-TIGER BEND)  
CLEARING AND EARTHWORK

Project Number: 12-CS-HC-0060A

<i>Description:</i> <b>Saw Cut Surfaces - Concrete</b>				
REF. NO.	QUANTITY	UNIT OF MEASURE	UNIT PRICE	UNIT PRICE EXTENSION (Quantity X Unit Price)
<b>2020902</b>	<b>86</b>	<b>LF</b>	\$ _____	\$ _____
<i>Description:</i> <b>General Excavation</b>				
REF. NO.	QUANTITY	UNIT OF MEASURE	UNIT PRICE	UNIT PRICE EXTENSION (Quantity X Unit Price)
<b>2030100</b>	<b>141526</b>	<b>CY</b>	\$ _____	\$ _____
<i>Description:</i> <b>Embankment</b>				
REF. NO.	QUANTITY	UNIT OF MEASURE	UNIT PRICE	UNIT PRICE EXTENSION (Quantity X Unit Price)
<b>2030200</b>	<b>150940</b>	<b>CY</b>	\$ _____	\$ _____
<i>Description:</i> <b>Class 6A4000 Concrete</b>				
REF. NO.	QUANTITY	UNIT OF MEASURE	UNIT PRICE	UNIT PRICE EXTENSION (Quantity X Unit Price)
<b>6010100</b>	<b>61.77</b>	<b>CY</b>	\$ _____	\$ _____
<i>Description:</i> <b>Reinforcing Steel</b>				
REF. NO.	QUANTITY	UNIT OF MEASURE	UNIT PRICE	UNIT PRICE EXTENSION (Quantity X Unit Price)
<b>6010500</b>	<b>5910</b>	<b>LB</b>	\$ _____	\$ _____
<i>Description:</i> <b>15" Storm Drain Pipe</b>				
REF. NO.	QUANTITY	UNIT OF MEASURE	UNIT PRICE	UNIT PRICE EXTENSION (Quantity X Unit Price)
<b>7010115</b>	<b>16</b>	<b>LF</b>	\$ _____	\$ _____



**UNIT PRICE FORM**

To: CITY OF BATON ROUGE  
PARISH OF EAST BATON ROUGE  
DEPARTMENT OF PUBLIC WORKS

BID FOR: JONES CREEK RD EXTENSION (AIRLINE-TIGER BEND)  
CLEARING AND EARTHWORK

Project Number: 12-CS-HC-0060A

<i>Description:</i> <b>18" Storm Drain Pipe</b>				
REF. NO.	QUANTITY	UNIT OF MEASURE	UNIT PRICE	UNIT PRICE EXTENSION (Quantity X Unit Price)
<b>7010118</b>	<b>8</b>	<b>LF</b>	\$ _____	\$ _____
<i>Description:</i> <b>42" Reinforced Concrete Pipe</b>				
REF. NO.	QUANTITY	UNIT OF MEASURE	UNIT PRICE	UNIT PRICE EXTENSION (Quantity X Unit Price)
<b>7010242</b>	<b>638</b>	<b>LF</b>	\$ _____	\$ _____
<i>Description:</i> <b>9' x 5' Reinforced Concrete Box Culvert</b>				
REF. NO.	QUANTITY	UNIT OF MEASURE	UNIT PRICE	UNIT PRICE EXTENSION (Quantity X Unit Price)
<b>7010423</b>	<b>140</b>	<b>LF</b>	\$ _____	\$ _____
<i>Description:</i> <b>10' x 8' Reinforced Concrete Box Culvert</b>				
REF. NO.	QUANTITY	UNIT OF MEASURE	UNIT PRICE	UNIT PRICE EXTENSION (Quantity X Unit Price)
<b>7010431</b>	<b>380</b>	<b>LF</b>	\$ _____	\$ _____
<i>Description:</i> <b>Reticuline Grate Inlet (CPS 702-15) (Frame and Grate Only)</b>				
REF. NO.	QUANTITY	UNIT OF MEASURE	UNIT PRICE	UNIT PRICE EXTENSION (Quantity X Unit Price)
<b>7020310</b>	<b>1</b>	<b>EACH</b>	\$ _____	\$ _____
<i>Description:</i> <b>Grate Inlet (702-20)</b>				
REF. NO.	QUANTITY	UNIT OF MEASURE	UNIT PRICE	UNIT PRICE EXTENSION (Quantity X Unit Price)
<b>7020311</b>	<b>4</b>	<b>EACH</b>	\$ _____	\$ _____



**UNIT PRICE FORM**

To: CITY OF BATON ROUGE  
PARISH OF EAST BATON ROUGE  
DEPARTMENT OF PUBLIC WORKS

BID FOR: JONES CREEK RD EXTENSION (AIRLINE-TIGER BEND)  
CLEARING AND EARTHWORK

Project Number: 12-CS-HC-0060A

<i>Description:</i> 4" Cast-in-Place Concrete Revetment				
REF. NO.	QUANTITY	UNIT OF MEASURE	UNIT PRICE	UNIT PRICE EXTENSION (Quantity X Unit Price)
7040504	121.1	SY	\$ _____	\$ _____
<i>Description:</i> 6" Cast-in-Place Concrete Revetment				
REF. NO.	QUANTITY	UNIT OF MEASURE	UNIT PRICE	UNIT PRICE EXTENSION (Quantity X Unit Price)
7040506	527.6	SY	\$ _____	\$ _____
<i>Description:</i> 30-lb Riprap				
REF. NO.	QUANTITY	UNIT OF MEASURE	UNIT PRICE	UNIT PRICE EXTENSION (Quantity X Unit Price)
7050202	223.4	CY	\$ _____	\$ _____
<i>Description:</i> 55-lb. Riprap				
REF. NO.	QUANTITY	UNIT OF MEASURE	UNIT PRICE	UNIT PRICE EXTENSION (Quantity X Unit Price)
7050203	169.6	CY	\$ _____	\$ _____
<i>Description:</i> Plug and Abandon Sewer Pipe (cap each end)				
REF. NO.	QUANTITY	UNIT OF MEASURE	UNIT PRICE	UNIT PRICE EXTENSION (Quantity X Unit Price)
8028100	1	LUMP	\$ _____	\$ _____
<i>Description:</i> 36" Trenched Casing Including Carrier Pipe				
REF. NO.	QUANTITY	UNIT OF MEASURE	UNIT PRICE	UNIT PRICE EXTENSION (Quantity X Unit Price)
817003Q	214	LF	\$ _____	\$ _____



**UNIT PRICE FORM**

To: CITY OF BATON ROUGE  
PARISH OF EAST BATON ROUGE  
DEPARTMENT OF PUBLIC WORKS

BID FOR: JONES CREEK RD EXTENSION (AIRLINE-TIGER BEND)  
CLEARING AND EARTHWORK

Project Number: 12-CS-HC-0060A

<i>Description:</i> <b>5-Ft. Chain Link Fence</b>				
REF. NO.	QUANTITY	UNIT OF MEASURE	UNIT PRICE	UNIT PRICE EXTENSION (Quantity X Unit Price)
9020105	2628	LF	\$ _____.	\$ _____.
<i>Description:</i> <b>3-ft. Chain Link Gate, 5-Ft. Height</b>				
REF. NO.	QUANTITY	UNIT OF MEASURE	UNIT PRICE	UNIT PRICE EXTENSION (Quantity X Unit Price)
9020303	4	EACH	\$ _____.	\$ _____.
<i>Description:</i> <b>Temporary Hay Bales</b>				
REF. NO.	QUANTITY	UNIT OF MEASURE	UNIT PRICE	UNIT PRICE EXTENSION (Quantity X Unit Price)
9030200	80	EACH	\$ _____.	\$ _____.
<i>Description:</i> <b>Temporary Sediment Check Dams (Stone)</b>				
REF. NO.	QUANTITY	UNIT OF MEASURE	UNIT PRICE	UNIT PRICE EXTENSION (Quantity X Unit Price)
9030400	1	EACH	\$ _____.	\$ _____.
<i>Description:</i> <b>Temporary Silt Fencing</b>				
REF. NO.	QUANTITY	UNIT OF MEASURE	UNIT PRICE	UNIT PRICE EXTENSION (Quantity X Unit Price)
9030500	22782	LF	\$ _____.	\$ _____.
<i>Description:</i> <b>Seed</b>				
REF. NO.	QUANTITY	UNIT OF MEASURE	UNIT PRICE	UNIT PRICE EXTENSION (Quantity X Unit Price)
9030800	309	LB	\$ _____.	\$ _____.



**UNIT PRICE FORM**

To: CITY OF BATON ROUGE  
PARISH OF EAST BATON ROUGE  
DEPARTMENT OF PUBLIC WORKS

BID FOR: JONES CREEK RD EXTENSION (AIRLINE-TIGER BEND)  
CLEARING AND EARTHWORK

Project Number: 12-CS-HC-0060A

<i>Description:</i> <b>Fertilizer</b>				
REF. NO.	QUANTITY	UNIT OF MEASURE	UNIT PRICE	UNIT PRICE EXTENSION (Quantity X Unit Price)
9030900	10304	LB	\$ _____.	\$ _____.
<i>Description:</i> <b>Water</b>				
REF. NO.	QUANTITY	UNIT OF MEASURE	UNIT PRICE	UNIT PRICE EXTENSION (Quantity X Unit Price)
9031000	249	MGAL	\$ _____.	\$ _____.
<i>Description:</i> <b>Fiber Mulch</b>				
REF. NO.	QUANTITY	UNIT OF MEASURE	UNIT PRICE	UNIT PRICE EXTENSION (Quantity X Unit Price)
9031300	49872	SY	\$ _____.	\$ _____.
<i>Description:</i> <b>Erosion Control Mat</b>				
REF. NO.	QUANTITY	UNIT OF MEASURE	UNIT PRICE	UNIT PRICE EXTENSION (Quantity X Unit Price)
9031400	128	SY	\$ _____.	\$ _____.
<i>Description:</i> <b>Storm Water Pollution Prevention Plan</b>				
REF. NO.	QUANTITY	UNIT OF MEASURE	UNIT PRICE	UNIT PRICE EXTENSION (Quantity X Unit Price)
9031600	1	LUMP	\$ _____.	\$ _____.
<i>Description:</i> <b>Temporary Signs and Barricades</b>				
REF. NO.	QUANTITY	UNIT OF MEASURE	UNIT PRICE	UNIT PRICE EXTENSION (Quantity X Unit Price)
9050100	1	LUMP	\$ _____.	\$ _____.



**UNIT PRICE FORM**

To: CITY OF BATON ROUGE  
 PARISH OF EAST BATON ROUGE  
 DEPARTMENT OF PUBLIC WORKS

BID FOR: JONES CREEK RD EXTENSION (AIRLINE-TIGER BEND)  
 CLEARING AND EARTHWORK

Project Number: 12-CS-HC-0060A

<i>Description:</i> <b>Mobilization</b>				
REF. NO.	QUANTITY	UNIT OF MEASURE	UNIT PRICE	UNIT PRICE EXTENSION (Quantity X Unit Price)
9090100	1	LUMP	\$ _____	\$ _____
<i>Description:</i> <b>Temporary Stone Construction Entrance</b>				
REF. NO.	QUANTITY	UNIT OF MEASURE	UNIT PRICE	UNIT PRICE EXTENSION (Quantity X Unit Price)
9900001	4	EACH	\$ _____	\$ _____
<i>Description:</i> <b>Payment Adjustment (Fuels and Asphalt Cements)</b>				
REF. NO.	QUANTITY	UNIT OF MEASURE	UNIT PRICE	UNIT PRICE EXTENSION (Quantity X Unit Price)
9900004	56900	DOL	\$ _____	\$ _____
<i>Description:</i> <b>Settlement Plate Installation and Monitoring</b>				
REF. NO.	QUANTITY	UNIT OF MEASURE	UNIT PRICE	UNIT PRICE EXTENSION (Quantity X Unit Price)
9900014	7	EACH	\$ _____	\$ _____