















APPENDIX A

DAMAGE DIAGRAMS

Legend

	Water-impacted walls
	Mold-impacted walls
	Water-impacted ceilings
	Mold-impacted ceilings
	Impacted flooring
	Impacted furniture, fixtures, and equipment (FFE)
	Pre-existing damages on walls
	Pre-existing damages on ceilings
	Walls removed prior to assessment.
	Ceilings or floors removed prior to assessment.
	Establish containment for remediation
	Remove all interior finishes throughout identified areas.
	Shaded areas not accessible during assessment.
	CBP or fire impacted walls
	CBP or fire impacted ceilings
	Cleaning of all exposed surfaces

Damage Diagrams

Louisiana Office of Risk Management
 #16 Dormitory
 5445 Point Clair Road
 Carville, LA 70721

Claim No.: 4A2310TKFSM-0001

EFI File No.:

032.03513

Inspector(s):

B. Hebert

Inspection Date:

November 17, 2023

4A2310TKFSM0001



Damages Code Key

Where applicable, each protocol line item will be assigned a damage code corresponding to the appropriate remedial action recommended by EFI. Each code will consist of three (3) digits which will indicate the following:

1st Digit: The first digit indicates either removal or cleaning of the substrate.

2nd Digit: The second digit identifies the location of the substrate (i.e. ceiling, soffit, wall, baseboard, or flooring)

3rd Digit: The third digit will indicate the type of substrate and will correspond with the scope of work provided in the substrate code table on the following slide.

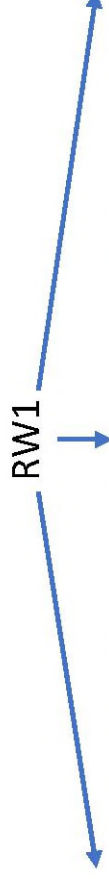

1 st Digit	2 nd Digit	3 rd Digit
R – Removal C – Cleaning D – Drying	C – Ceiling M – Millwork S – Soffit W – Wall B – Baseboard	F – Flooring X – Contents H – HVAC A – All Finishes E – Exposed Surfaces
		Corresponds to the indicated # on the Substrate Table

- Ex. RW1 Remove wall, gypsum board
- RC2 Remove ceiling, drop ceiling tile
- CF4 Clean flooring, carpet
- RA20 Remove all finishes, except.....(list exceptions)
- CE20 Clean all exposed surfaces

Damage Diagrams

Louisiana Office of Risk Management
 #16 Dormitory
 5445 Point Clair Road
 Carville, LA 70721

Claim No.: 4A2310TKFSM-0001

1-10-2024

EFI File No.:

032.03513

Inspector(s):

B. Hebert

Inspection Date:

November 17, 2023

4A2310TKFSM0001



6020240110051058

Key: **Applicable** **Not Applicable for this project**

Substrate Codes

1	Gypsum Board	R	Remove gypsum board, as indicated. Remove all fasteners, coverings, wall cavity insulation, and if necessary, baseboards directly associated with removed gypsum board. Inspect wall cavity studs for additional water and/or mold damages. If necessary, sand visible dark staining observed on wood studs. Remove any bulk dust and debris within the wall cavity and clean via HEPA vacuum and wiping with an EPA-registered biocide compatible with the remaining substrates.
		C	Clean indicated area by HEPA vacuuming followed by wiping with an EPA-registered biocide. If present, inspect behind any wall covering to confirm there are not additional damages. Ensure area dries to the appropriate standard.
2	Ceiling Tile	R	Remove and discard impacted ceiling tiles, as noted (Quantity indicated on diagram provided).
		C	Not applicable.
3	Wood, Plywood, or Oriented Strand Board (OSB)	R	Remove wood substrate, as indicated. Inspect underlying surface for additional water and/or mold damages. Clean exposed surfaces with a HEPA vacuum and wiping with an EPA-registered biocide compatible with the remaining substrates.
		C	Sand visible dark staining observed in the indicated area. Clean wood with a HEPA vacuum and wiping with an EPA-registered biocide compatible with the remaining substrates.
4	Carpet	R	Remove carpet, as indicated. Inspect underlying surface and tack strips for additional water and/or mold damages. Clean exposed surfaces with a HEPA vacuum and wiping with an EPA-registered biocide compatible with the remaining substrates.
		C	HEPA vacuum the indicated area followed by cleaning via hot water extraction. Ensure carpet is appropriately dried.
5	Vinyl, Linoleum, or Rubber	R	Remove vinyl, as indicated. Inspect underlying surface for additional water and/or mold damages. Clean exposed surfaces with a HEPA vacuum and wiping with an EPA-registered biocide compatible with the remaining substrates.
		C	Clean vinyl with an EPA registered biocide.
6	Plaster	R	Remove plaster as indicated. Remove all fasteners, coverings, wall cavity insulation, and if necessary, baseboards directly associated with removed plaster. Inspect wall cavity studs for additional water and/or mold damages. If necessary, sand visible dark staining observed on wood studs. Remove any bulk dust and debris within the wall cavity and clean via HEPA vacuum and wiping with an EPA-registered biocide compatible with the remaining substrates.
		C	Clean indicated area by HEPA vacuuming followed by wiping with an EPA-registered biocide. If present, inspect behind any wall covering to confirm there are not additional damages. Ensure area dries to the appropriate standard.

Damage Diagrams

Louisiana Office of Risk Management
#16 Dormitory
5445 Point Clair Road
Carville, LA 70721

Claim No.: 4A2310TKFSM-0001

EFI File No.:

032.03513

Inspector(s):

B. Hebert

Inspection Date:

November 17, 2023

4A2310TKFSM0001



Substrate Codes

Not Applicable for this project

Key: **Applicable**

7	Concrete, Stone, Brick, or Concrete Masonry Unit (CMU)	R	Remove impacted substrate, as indicated in the protocol, including all associated stone, mortar, and loose debris.
		C	Clean substrate with HEPA vacuum followed by wipe with an EPA registered biocide.
8	HVAC System/ Ducting	R	Remove impacted ducting and/or air handling unit, as indicated, including all associated insulation, foil, gaskets, and fasteners.
		C	Clean impacted hard duct and/or air handling unit as indicated in accordance with NADCA protocols.
9	Contents/ Fixtures	R	Remove and dispose of impacted contents as detailed within the protocol.
		C	Clean impacted contents based as indicated in the protocol.
10	Gypcrete	R	Remove impacted gypcrete and loose debris, where indicated in the protocol, followed by cleaning the underlying subfloor with a HEPA vacuum and wiping with an EPA registered biocide.
		C	Clean gypcrete with HEPA vacuum followed by wipe with an EPA registered biocide.
11	Ceramic or Glass Tile	R	Remove impacted tile and associated adhesive followed by cleaning the underlying substrate with a HEPA vacuum and wiping with an EPA registered biocide. Inspect the underlying substrate for additional damages and structural integrity, if necessary.
		C	Clean tile substrate with HEPA vacuum followed by wipe with an EPA registered biocide. Ensure underlying substrate is adequately dried.
12	Marble	R	Remove marble slab intact, if possible, and inspect underlying substrate for additional damages. If the slab is salvageable, clean marble slab with a HEPA vacuum and an EPA registered biocide.
		C	Clean marble substrate with HEPA vacuum followed by wipe with an EPA registered biocide. Ensure underlying substrate is adequately dried.

Damage Diagrams

Louisiana Office of Risk Management
 #16 Dormitory
 5445 Point Clair Road
 Carville, LA 70721

Claim No.: 4A2310TKFSM-0001

1-10-2024

EFI File No.:

032.03513

Inspector(s):

B. Hebert

Inspection Date:

November 17, 2023

4A2310TKFSM0001



6020240110051058

Substrate Codes

Not Applicable for this project

Key: **Applicable**

Key:	Applicable	Not Applicable for this project	Substrate Codes
14	Fiberglass-reinforced polymer (FRP) panels	R	Remove FRP wall covering as indicated, including all fasteners. Inspect underlying substrate for additional water and/or mold damages. Additional recommendations may be necessary to address underlying substrate.
		C	Clean indicated area by HEPA vacuuming followed by wiping with an EPA-registered biocide. If present, inspect behind any wall covering to confirm there are not additional damages. Ensure area dries to the appropriate standard.
15	Metal	R	Remove metal components intact, if possible, and inspect underlying substrate for additional damages. If the metal components are salvageable, clean the metal with a HEPA vacuum and an EPA registered biocide.
		C	Clean metal components with HEPA vacuum followed by wipe with an EPA registered biocide. Ensure underlying substrate is adequately dried.
16	Cork	R	Remove impacted cork material and loose debris, where indicated in the protocol, followed by cleaning the underlying substrate with a HEPA vacuum and wiping with an EPA registered biocide.
		C	Not applicable.
17	Cellulose and Fiberglass (Fibrous) Insulation	R	Remove impacted insulation material, as described in the protocol. HEPA vacuum all loose debris and wipe the remaining non-porous substrates, if present, with an EPA registered biocide.
		C	Not applicable.
18	Spray Foam or Foam Board Insulation	R	Remove impacted insulation material, as described in the protocol. HEPA vacuum all loose debris and wipe the remaining non-porous substrates, if present, with an EPA registered biocide.
		C	Ensure material is structurally intact and clean material with a HEPA vacuum followed by a light wiping with a clean rag dampened with an EPA registered biocide.
19	Fireproofing	R	Remove impacted fireproofing, as described in the protocol. HEPA vacuum all loose debris and wipe the remaining non-porous substrates, if present, with an EPA registered biocide.
		C	Not applicable.
20	All Interior Finishes	C	Clean all exposed surfaces within the area identified. HEPA vacuum and clean with an EPA registered biocide that is compatible with the material being cleaned. Refer to manufacturer specifications as needed to determine compatibility. Refer to the substrate table for appropriate cleaning methods for a given substrate (i.e., concrete, tile, metal, etc.).
		R	Remove all impacted finishes throughout identified areas down to the base framing and subfloor. This includes walls, ceilings, flooring, fixtures, cabinets, furnishings, and insulation. Following removal activities, HEPA vacuum all loose debris and wipe the remaining substrates with an EPA registered biocide. Ensure wood materials achieve a dry standard, <17% on wood moisture equivalent (WME) scale. Refer to substrate cleaning codes where flooring layers are deemed salvageable.

Damage Diagrams

Louisiana Office of Risk Management
 #16 Dormitory
 5445 Point Clair Road
 Carville, LA 70721

Claim No.: 4A2310TKFSM-0001

EFI File No.:

032.03513

Inspector(s):

B. Hebert

Inspection Date:

November 17, 2023

4A2310TKFSM0001



#16 Dormitory

Damage Diagrams

Louisiana Office of Risk Management
#16 Dormitory
5445 Point Clair Road
Carville, LA 70721
Claim No.: 4A2310TKFSM-0001

EFI File No.:

032.03513

Inspector(s):

B. Hebert

Inspection Date:

November 17, 2023

4A2310TKFSM0001



224

- A. Laminate flooring removed
- B. FRP removed
- C. Baseboards removed

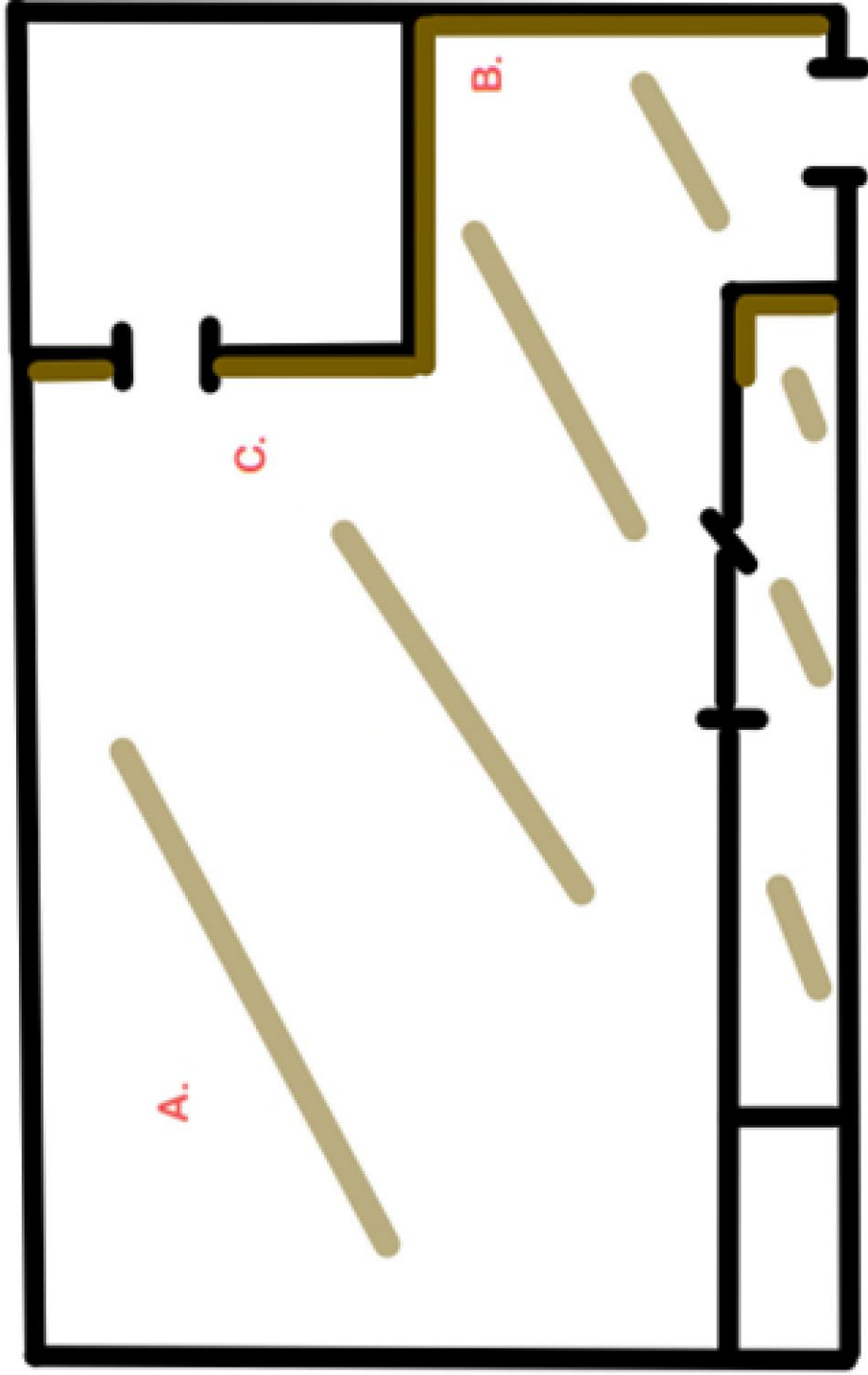

Damage Diagrams
Louisiana Office of Risk Management
#16 Dormitory
5445 Point Clair Road
Carville, LA 70721
Claim No.: 4A2310TKFSM-0001

EFI File No.:

032.03513

Inspector(s):

B. Hebert

Inspection Date:

November 17, 2023

4A2310TKFSM0001



No damages observed at time of EFI investigation

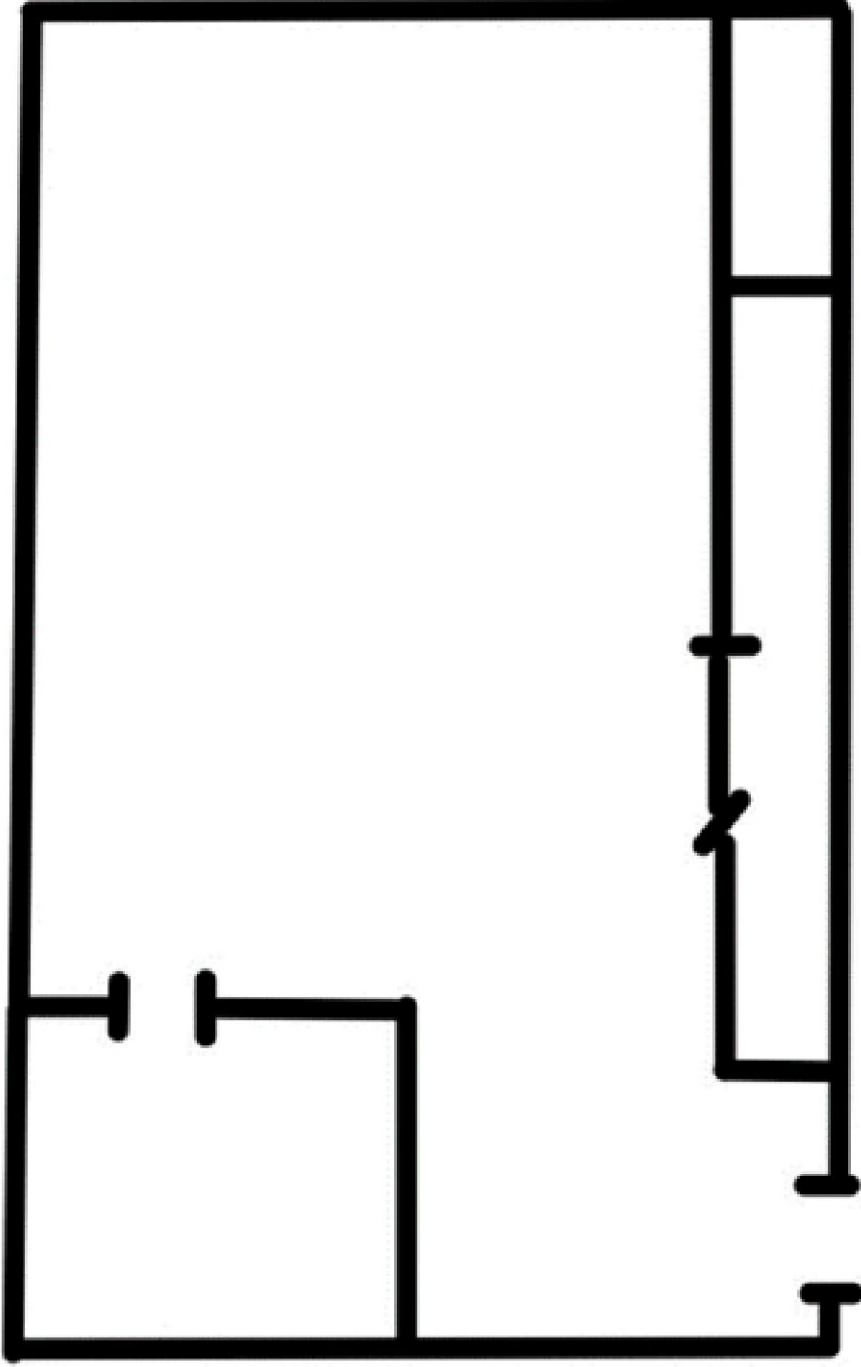

Damage Diagrams

Louisiana Office of Risk Management
#16 Dormitory
5445 Point Clair Road
Carville, LA 70721

Claim No.: 4A2310TKFSM-0001

EFI File No.:

032.03513

Inspector(s):

B. Hebert

Inspection Date:

November 17, 2023

4A2310TKFSM0001



216

- A. Laminate flooring removed
- B. Baseboards removed

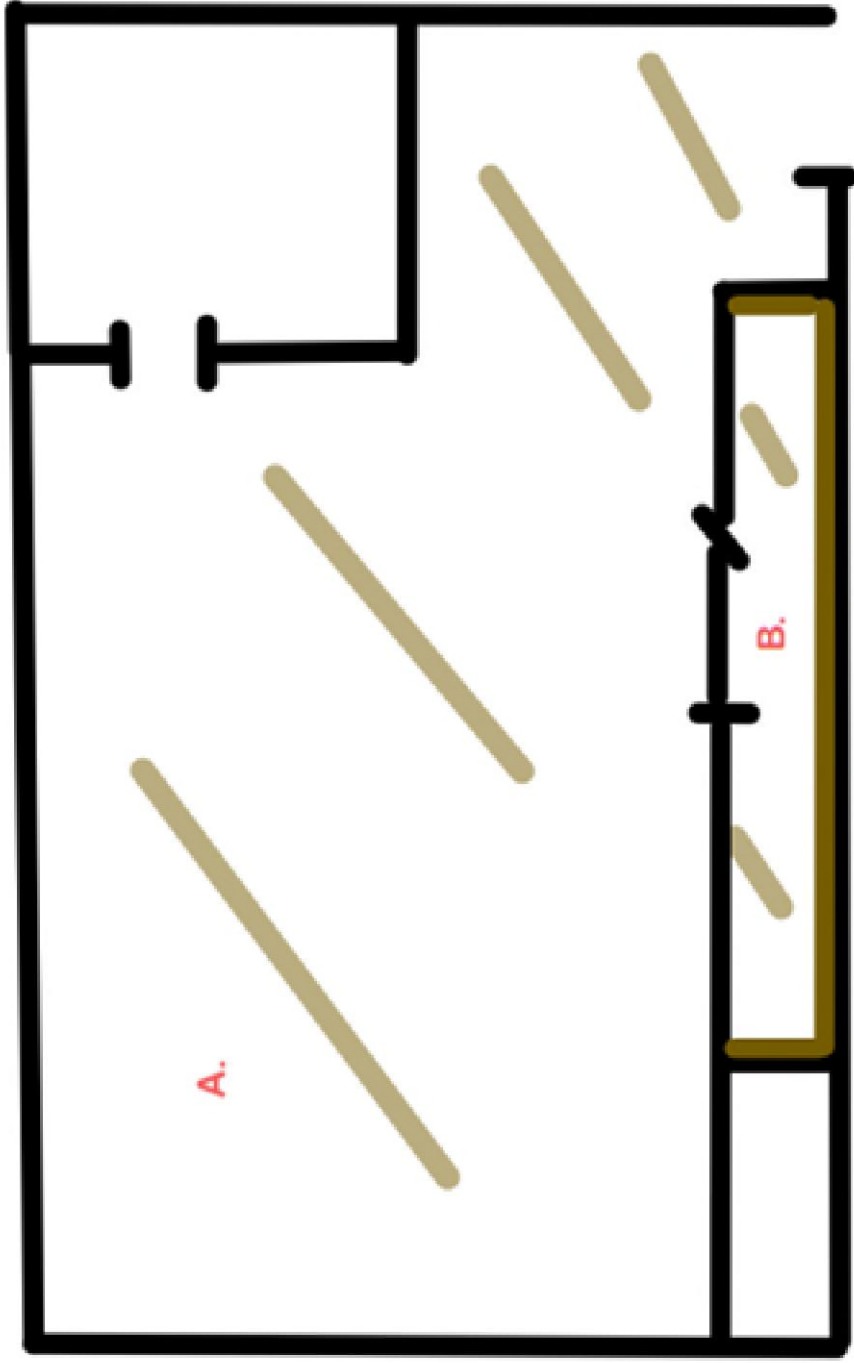

Damage Diagrams

Louisiana Office of Risk Management
#16 Dormitory
5445 Point Clair Road
Carville, LA 70721
Claim No.: 4A2310TKFSM-0001

EFI File No.:

032.03513

Inspector(s):

B. Hebert

Inspection Date:

November 17, 2023

210

1. DW6: Dry plaster wall

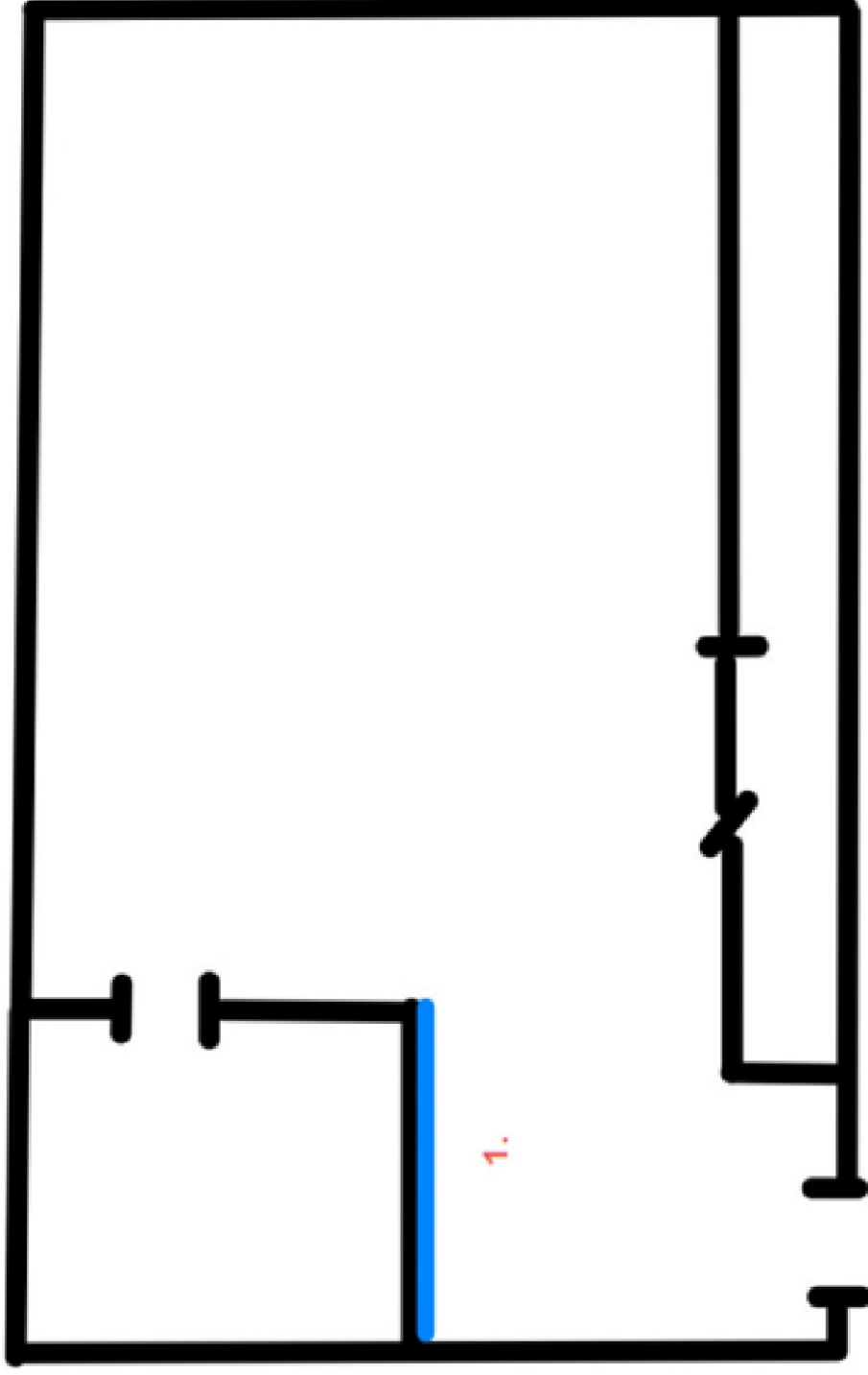

Damage Diagrams

Louisiana Office of Risk Management
#16 Dormitory
5445 Point Clair Road
Carville, LA 70721
Claim No.: 4A2310TKFSM-0001

EFI File No.:

032.03513

Inspector(s):

B. Hebert

Inspection Date:

November 17, 2023

4A2310TKFSM0001



116

- A. Hole removed in wall
- B. Laminate flooring removed
- C. Baseboards removed

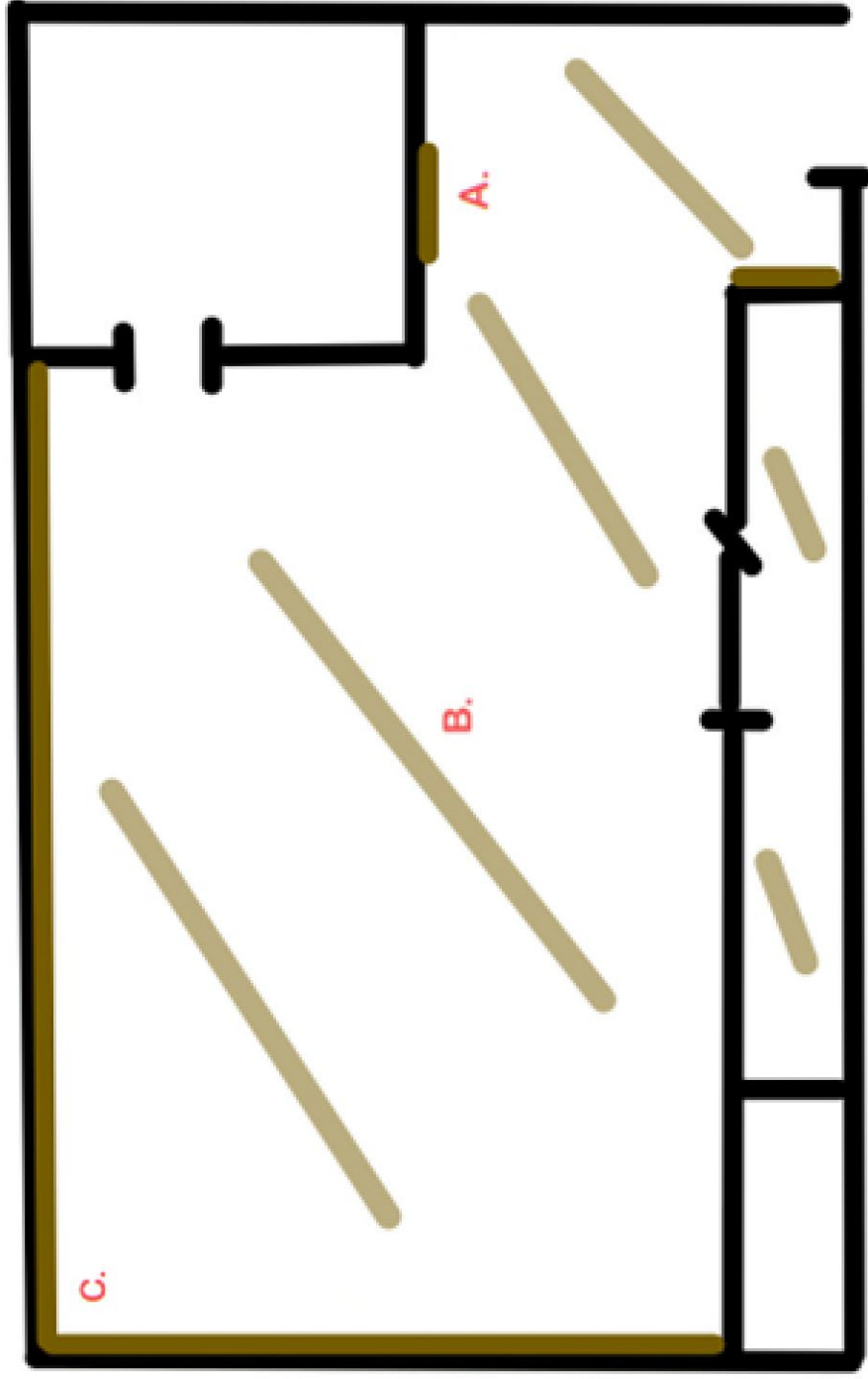

Damage Diagrams

Louisiana Office of Risk Management
#16 Dormitory
5445 Point Clair Road
Carville, LA 70721
Claim No.: 4A2310TKFSM-0001

EFI File No.:

032.03513

Inspector(s):

B. Hebert

Inspection Date:

November 17, 2023

4A2310TKFSM0001



110

A. Baseboards removed

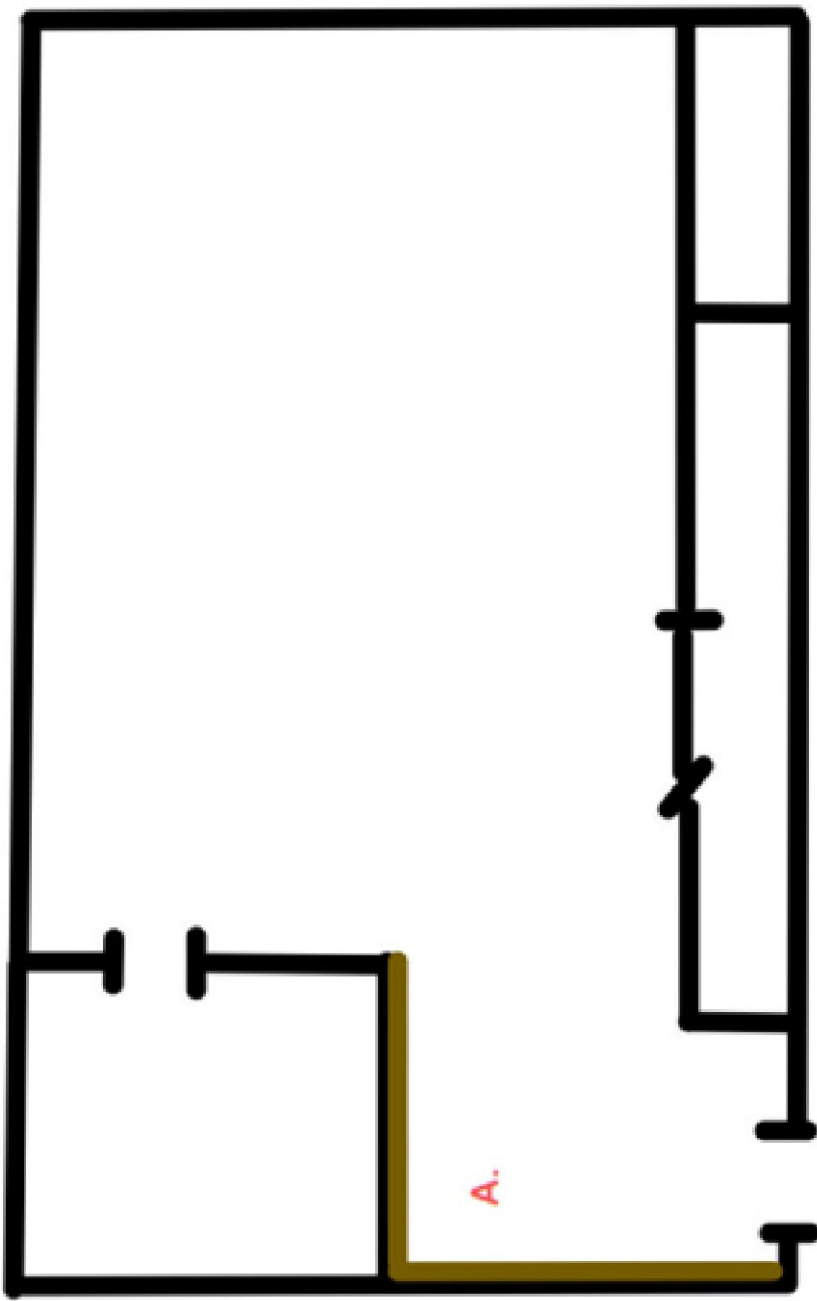

Damage Diagrams

Louisiana Office of Risk Management
#16 Dormitory
5445 Point Clair Road
Carville, LA 70721
Claim No.: 4A2310TKFSM-0001

EFI File No.:

032.03513

Inspector(s):

B. Hebert

Inspection Date:

November 17, 2023

4A2310TKFSM0001

