



ST. TAMMANY PARISH

MICHAEL B. COOPER
PARISH PRESIDENT

August 8, 2024

Please find the following addendum to the below mentioned BID.

Addendum No.: 3

Bid # 24-29-2

Project Name: Davis Canal Restoration

Bid Due Date: Tuesday, August 13, 2024

GENERAL INFORMATION:

Receipt of this addendum shall be acknowledged by inserting its number in the space provided on the proposal.

1. Approved Equal – Sheet Pile AZ32-750 (Attached)

QUESTIONS & ANSWERS:

Question 1. In lieu of a concrete cap, can the consideration of steel C channel cap be utilized? The reasoning is due to the logistical challenges to getting concrete to the site.

Answer 1. Contractor may install steel channel cap in lieu of concrete pile cap. See Detail 1/SK-01, Steel Cap at Steel Sheet Pile Wall on the attached Sheet No. SK-01 for more information.

Question 2. For the power line crossing over the canal, is that a line that can be terminated or temporarily de-energized for construction operations due to its low heights?

Answer 2. CLECO is aware of the issue and is currently investigating solutions. Contractor to coordinate with CLECO. Any costs associated with the de-energization will be covered by St. Tammany Parish.

Question 3. Can sheet piles AZ30-750 or AZ32-750 (Grade 60) be used in lieu of the specified PZ-40?

Answer 3. Sheet pile AZ32-750 is approved and can be used in lieu of the PZ-40. AZ30-750 is not approved.



ST. TAMMANY PARISH

MICHAEL B. COOPER
PARISH PRESIDENT

ATTACHMENTS:

1. Sheet No. SK-01, Detail No. 1/SK-01 Steel Cap at Steel Sheet Pile Wall
2. Sheet Pile AZ32-750

<< End of Addendum #3 >>

project no.	20-2135
drawn	TJO
checked	DPO
date	08-07-2024
revised	

Meyer Engineers, Ltd.
A. Thompson Holdings Company
4937 Hearst Street, Suite 1B
Metairie, Louisiana 70001
504.885.9892 (o)
www.meyer-esl.com

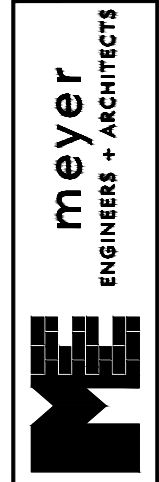

C CHANNEL CAP DETAIL
DAVIS LANDING CANAL RESTORATION
ST. TAMMANY PARISH
SLIDELL, LA

sheet no.
SK-01
of 1 sheets

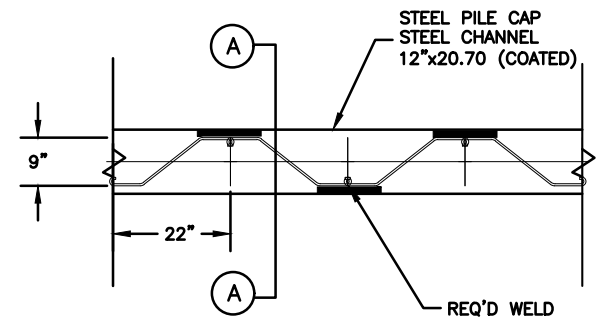

PLAN VIEW

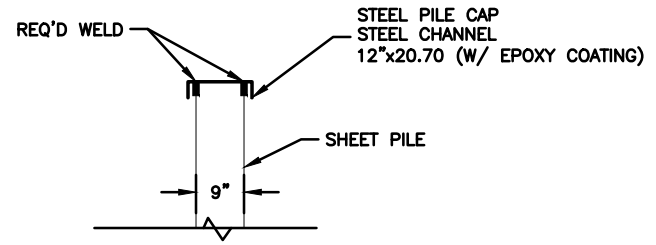

SECTION A

1
SK-01

STEEL CAP AT STEEL SHEET PILE WALL

N.T.S.

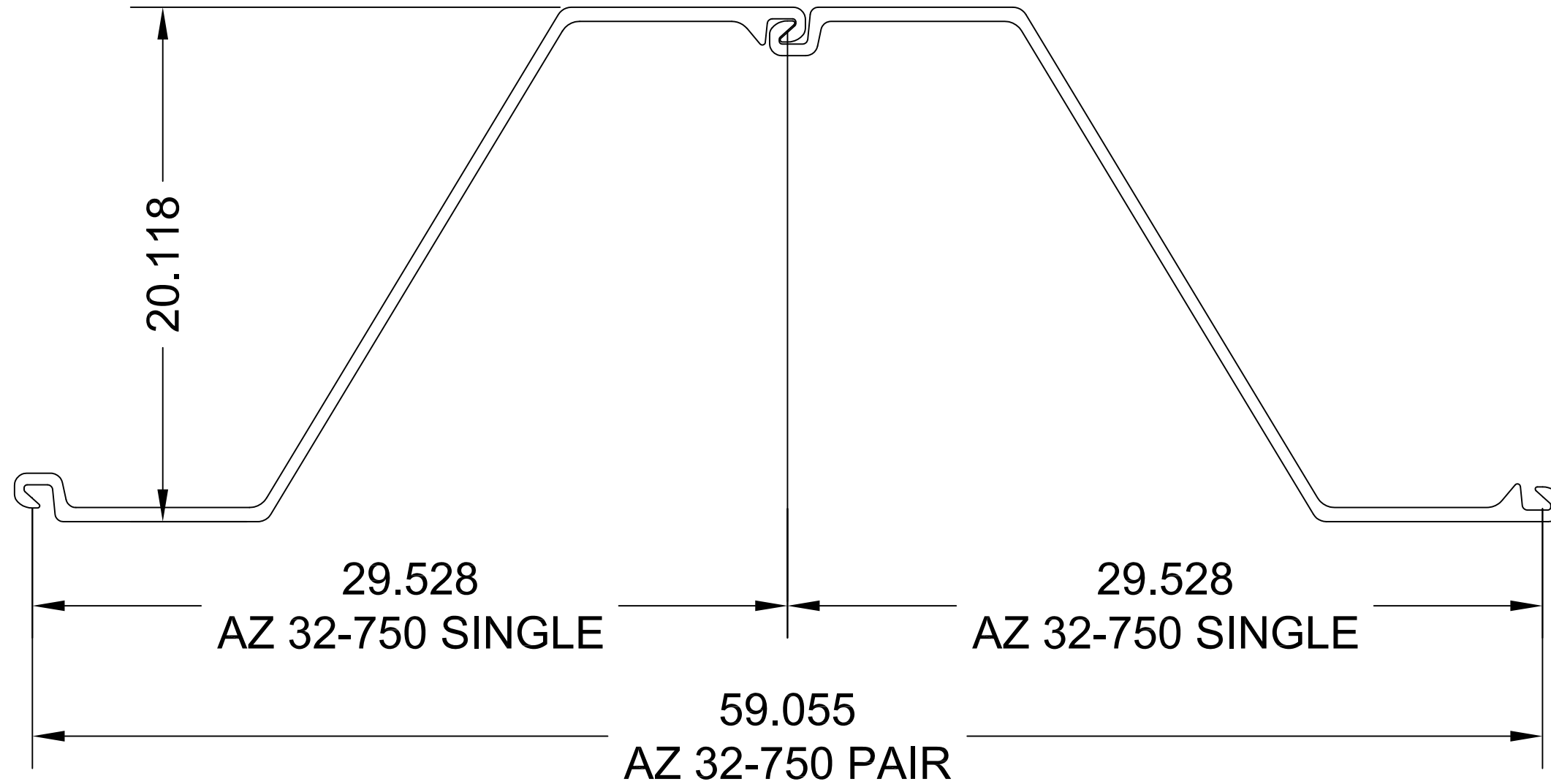

SECTION			THICKNESS		Cross Sec Area (A)	WEIGHT		SECTION MODULUS		COATING AREA		
	Width (w)	Height (h)	Flange (t _f)	Web (t _w)		Single Pile	Wall Area	Elastic	Plastic	Moment of Inertia	Both Sides	Wall Surface
	in mm	in mm	in mm	in mm		lb/ft kg/m	lb/ft kg/m	in /ft cm /m	in /ft cm /m	in / ft cm /m	ft /ft of single m /m	ft /ft m /m
AZ 32-750	29.53 750.0	20.12 511.0	0.551 14.00	0.472 12.00	9.37 198.3	78.44 116.70	31.88 155.60	59.5 3200	69.2 3720	599.0 81800	6.93 2.11	1.41 1.41

General Notes

DRAWINGS ARE FOR LAYOUT PURPOSES ONLY. ENGINEERING IS NOT TO BE INTENDED NOR IMPLIED. DRAWINGS ARE BASED ON DIMENSIONS SUPPLIED FROM CONTRACTOR. ACTUAL DIMENSIONS MAY VARY DUE TO MILL TOLERANCES AND DRIVING PRACTICES. LAYOUT DRAWINGS ARE SUBJECT TO CUSTOMER REVIEW & ACCEPTANCE. J.D. FIELDS & CO., INC. CANNOT BE HELD RESPONSIBLE OR LIABLE FOR THESE SUBMITTALS. THIS DRAWING & THE INFORMATION IT CONTAINS ARE THE PROPERTY OF J.D. FIELDS & CO., INC. IT IS NOT TO BE COPIED, NOR IS THE INFORMATION CONTAINED TO BE USED WITHOUT PRIOR APPROVAL FROM J.D. FIELDS & CO., INC.

Drafted by: A.D.



No.	Revision/Issue	Date
0	Released for Approval	02/03/23

Firm Name and Address

J.D. Fields & Co., Inc.
2727 Allen Parkway
Suite 2000
Houston, TX, 77019
(281)-558-7199

Project Name and Address

AZ 32-750

Project	Sheet
Date 02/03/23	J-1
Scale N.T.S.	