



ST. TAMMANY PARISH
MICHAEL B. COOPER
PARISH PRESIDENT



May 25, 2023

Please find the following addendum to the below-mentioned BID.

Addendum No.: 1

Bid#: 23-27-2

Project Name: STAC PHASE IV – BEAUTIFICATION LANDSCAPE WORK

Bid Due Date: Thursday, June 8, 2023 @ 2:00 p.m.

GENERAL INFORMATION:

- A.** Do not break these documents into parts or sub-parts. Each contracting entity shall be responsible for all the work related to their trades wherever it may be shown within the contract documents package.
- B.** The scope of the work for contractors, subcontractors, material suppliers, etc., cannot be determined by examining partial sets of documents. The entire set of drawings and specifications must be reviewed to ascertain the scope of work for each project element.
- C.** Mandatory Pre-Bid Sign-In-Sheet is attached.
- D.** Contractor will procure and pay for Testing Services. A testing laboratory shall be retained by the Contractor and approved by St. Tammany Parish Department of Engineering. Testing shall be performed in accordance with LADOTD Requirements and a sampling plan, to be submitted by the Contractor for approval, is required. A summary of all tests performed, similar to the DOTD 2059 report, is required at the end of the project.
- E.** All work shall reference Louisiana Standard Specifications for Roads and Bridges 2016 edition and latest revisions.



ST. TAMMANY PARISH

MICHAEL B. COOPER
PARISH PRESIDENT

- F.** Please remove Section 04- Louisiana Uniform Public Work Bid Form and Louisiana Uniform Public Work Bid Form - Unit Price Form and replace with Section 04-Louisiana Uniform Public Work Bid Form (Revised) and Louisiana Uniform Public Work Bid Form - Unit Price Form (Revised). The forms have been revised to provide description of Alternative No. 1. Responses must be submitted on Revised forms.
- G.** Contractor shall submit all questions concerning plans and specifications to procurement@stpgov.org . Questions shall be submitted in writing by 2:00 p.m. on May 30th, 2023.

QUESTIONS & ANSWERS:

Question 1: Given the Scope of Work and Title of the Bid Project, will a contractor with a Municipal and Public Works Construction and/or Landscape, Grading and Beautification license be allowed to submit as a Prime Bidder?

Answer 1: Contractors shall be licensed in Heavy Construction. STPG consultant specializing in federally funded projects designated this project as Heavy Construction Classification. Landscaping Contractors are allowed to perform work on this project as a subcontractor to the licensed Heavy Construction Contractor.

Question 2: Item #5 in the Instructions to Bidders states the Contract Time is “150”. Please clarify if this is intended to mean Calendar Days or Working Days.

Answer 2: The contract time is 150 Calendar Days. Please be aware of SP. 33 which explains how the contract time is handled when planting is prohibited due to being outside of the planting season. Also note SP. 38 which defines inclement weather days and how they are recorded within the contract.

Question 3: Please provide clarification on location(s) for the required Unit price item 203-10-00100 (Cleaning Existing Ditches). There are no callouts for this item on any of the plans.



ST. TAMMANY PARISH

MICHAEL B. COOPER
PARISH PRESIDENT

Answer 3: The Unit Price Item 203-10-00100 is a contingency item to be used at discretion of the Project Engineer as needed. Typical Ditch cleaning shall be based on 1.22 CY per LF of ditch assuming ditch dimensions are 2 ft bottom with 3 to 1 slope sides and maximum depths of 3 feet. In the event the ditch is deeper or wider than the assumed dimension, linear footage of ditch will be prorated to accommodate the increased excavation volume. This item will also be used for any new ditches if necessary.

Question 4: Please provide clarification for the Monument luminaire connection. Will there already be power ran onsite to the monument(s) location(s)? Are the “others” to provide electrical connection for the Luminaire lights since they are providing all other electrical work? Please clarify monument locations.

Answer 4: The Contractor will need to coordinate connecting to the WST electrical service that is currently powering the existing streetlights at this location. See sheets L7.00 and L2.03 for notes and details regarding the monuments.

Question 5: Please provide clarification for Unit Price Item S-004 (Environmental Protection). What should be included in this item as it would be repetitive according to items 204-02-00100 (Temp Hay/Straw Bales) and 204-06-00100 (Temp Silt Fencing)? Would it only include SWPPP Plan?

Answer 5: See Special Provisions Section 11 details on Item S-004. All cost associated with devising a SWPPP and obtaining and maintaining necessary permits; including design, labor and equipment or materials required.

Question 6: There seems to be no planting details within the plan set. Will these be given?

Answer 6: See sheet L7.00 which indicates State Detail LD-01 is to be used. LD-01 is attached for reference.

Question 7: Will St. Tammany Parish allow Item Catch Basin (CB-01) to be installed as brick catch basins.

Answer 7: The Parish will allow the Contractor to install catch basins as brick Catch basins. Brick Catch Basin Detail is attached.



ST. TAMMANY PARISH

MICHAEL B. COOPER
PARISH PRESIDENT

Question 8: This project calls for Thermoplastic striping, can TBL Durables be considered an acceptable substitution?

Answer 8: The product TBL Durables does not meet DOTD specifications and is not on the approved materials list. Therefore, it will not be considered for substitution.

ATTACHMENTS:

- Mandatory Pre-bid meeting Sign-in Sheet (1 page)
- LaDOTD Planting Detail LD-01 (1 page)
- CB-01 (Brick Option) Detail (1 page)
- Section 04- Louisiana Uniform Public Work Bid Form (Revised) and Louisiana Uniform Public Work Bid Form - Unit Price Form (Revised) (13 pages)

End of Addendum # 1

STPG - Building B
 3rd Floor Conference Room
 21490 Koop Drive
 Mandeville, LA 70448

Mandatory Pre-Bid Sign In Sheet
 STAC Phase IV - Beautification Landscape Work

May 22, 2023
 2:00 PM

	Name	Company	Email	Phone	Time In	Time Out
1	Eric Kocken	RCLC	ekocken@rclcons-1.com	225-938-3995	13:50	14:15
2	John Gray	Procivil construction	Patrick@procivilconstruction.com	504-250-1823	13:50	2:15
3	Brandon Himel	Byron E. Talbot	bsanchez@byronetalbot.com	985-447-5764	1:54 PM	2:13 PM
4	Sadie Jenkins	Byron E Talbot	↓	↓	↓	2:13 PM
5	Clyde Garlick	Gulf Breeze Landscaping, LLC	Clyde.gulfbreeze@gbwllc.com	228-627-6090	1:57 pm	2:14 pm
6	Will Essell	Meliora Landscape Group	will@melioralandscape.com	(985) 264-9306	13:50	14:15
7	Mike Warborough	Warner Construction	Mike.warner@warnercon.com	985-5993	13:59	14:15
8	Brandon Luteman	Meliora Landscape Group	brandon@melioralandscape.com	985-320-9978	1:50	2:15
9	Jamer Smith	Rotolo Consultants Inc	Jsmith@rotoloconsultants.com	225-270-5290	2:00	2:15
10	Brett Lewis	Rotolo Consultants Inc	blewis@rotoloconsultants.com	985-643-2427	2:00	2:15
11	Ethan Valjain	Wolf Group construction Gulfstream Environmental DBA	wolfgroupconstruction@gmail.com	504-715-8015	2:00	2:15
12	Rebecca Miller	STPG	rmiller@stpgov.org	985-898-2539	2:00	2:15
13	Truman D. Sharp, III	STPG	tdsharp@stpgov.org	985-898-2552	2:00	2:15
	Frank Ziemer	RCL consultants	fziemmer@rclconsultants.com	985-727-4449	1:55	2:15

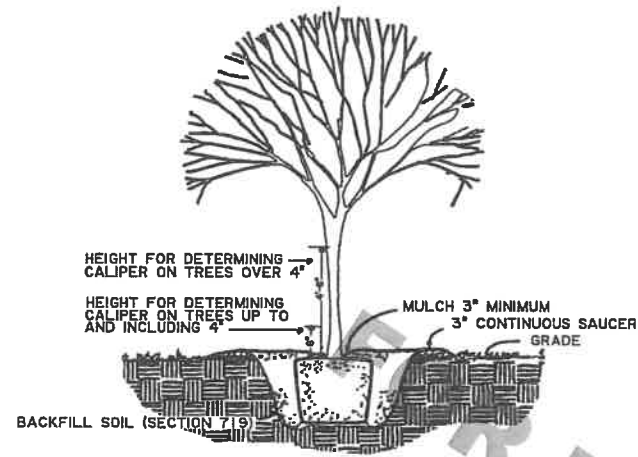

INDIVIDUAL TREE PLANTING DETAIL 1
NTS LD-1

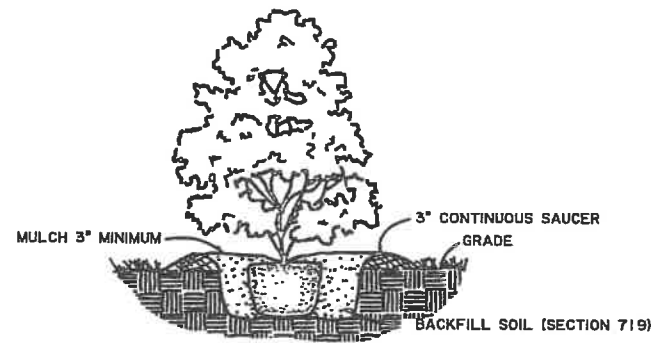

INDIVIDUAL SHRUB PLANTING DETAIL 2
NTS LD-1

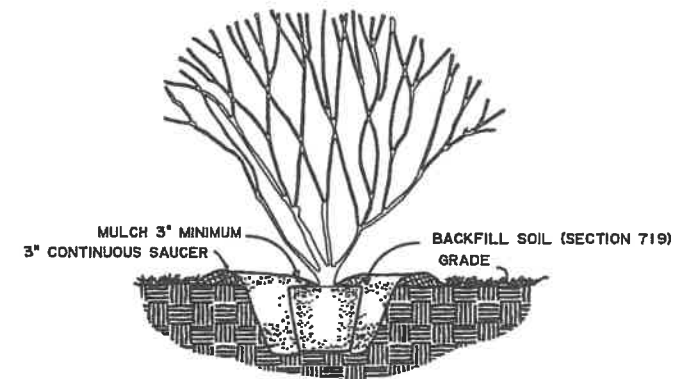

(Multi-trunk) TREE PLANTING DETAIL 3
NTS LD-1

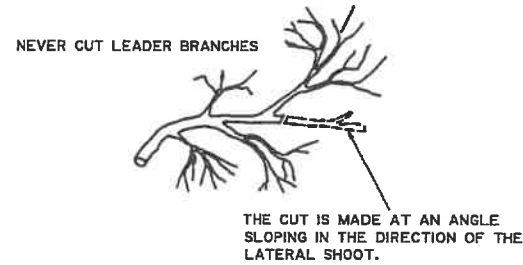

NOTES:

ROWS OR GROUPS OF SHRUBS OR TREES, SHALL HAVE A CONTINUOUS SAUCER ALONG THE PERIMETER OF THE PLANTING. THE COST OF THE MULCH TO COVER THE AREA SHALL BE FIGURED UNDER ITEM 719-02-00*00 AND NOT IN THE COST OF THE PLANTS.

MULCH REQUIRED IN INDIVIDUAL TREE AND SHRUB PLANTINGS SHALL BE INCLUDED IN THE COST OF THE PLANT.

BACKFILL SOIL (SECTION 719) REQUIRED FOR INDIVIDUAL TREE AND SHRUB PLANTINGS SHALL BE INCLUDED IN THE COST OF THE PLANT. STAKING SHALL BE INCLUDED IN THE COST OF THE PLANT.

DETAILS SHOWN ON THIS SHEET ARE TYPICAL. MULTIPLE SITUATIONS CAN OCCUR THAT MAY NOT BE SHOWN ON THIS SHEET. PROPOSED VEGETATION SHALL BE LOCATED ON PLANS ACCORDING TO HORIZONTAL AND VERTICAL CLEARANCE DISTANCE FOUND IN THE (ENGLISH DESIGN STANDARDS). SIGHT DISTANCES AND VEGETATION MANAGEMENT TYPICAL SECTIONS ARE DESCRIBED IN THE "POLICY FOR ROADSIDE VEGETATION MANAGEMENT". THESE DOCUMENTS CAN BE ACCESSED AT WWW.DOTD.LA.GOV.

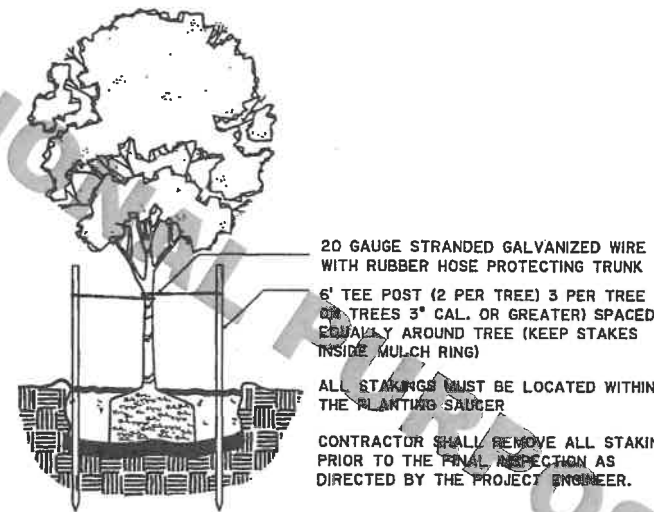

TREE STAKING DETAIL 4
NTS LD-1

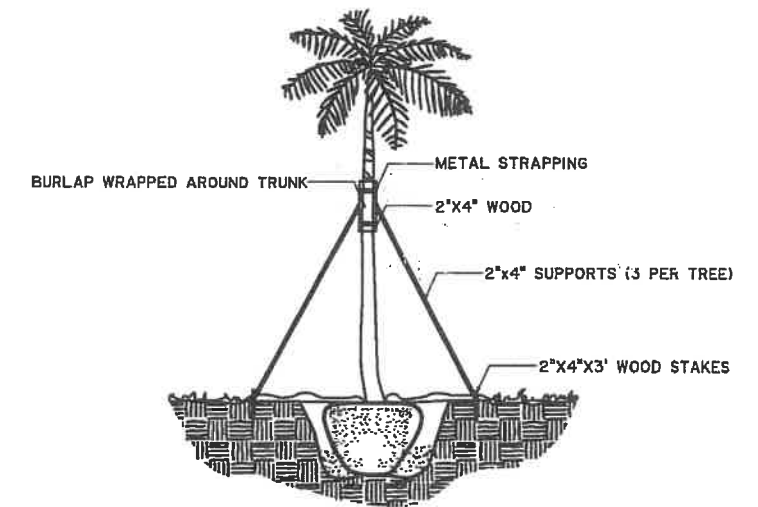

PALM STAKING DETAIL 5
NTS LD-1

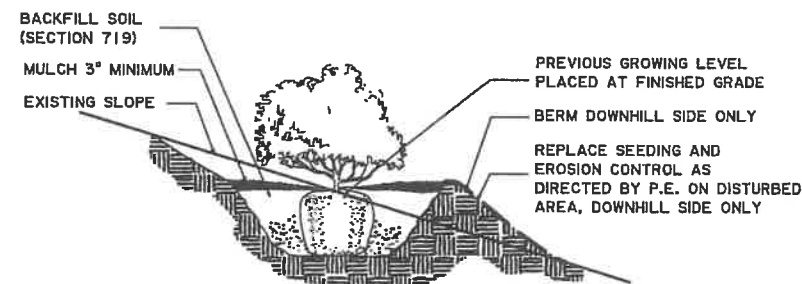

SLOPE PLANTING DETAIL 6
NTS LD-1

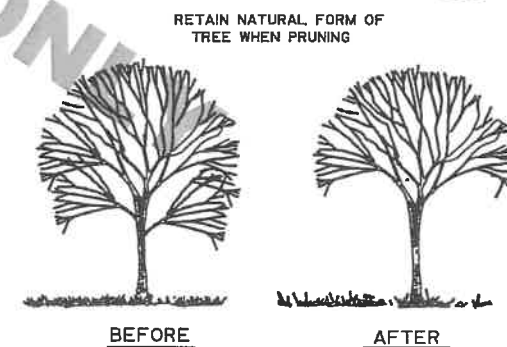

TREE PRUNING DETAIL 7
NTS LD-1

SHEET NUMBER	
PARTIAL	
FEDERAL PROJECT	
STATE PROJECT	
DESIGNED	
CHECKED	
DATE	2011
DRAWN	
CHECKED	
R/D	
DATE	2011
SHEET	
BY	
REVISION DESCRIPTION	
NO.	
DATE	
NO.	
PLANTING DETAILS	LD - 01
LANDSCAPE DESIGN	

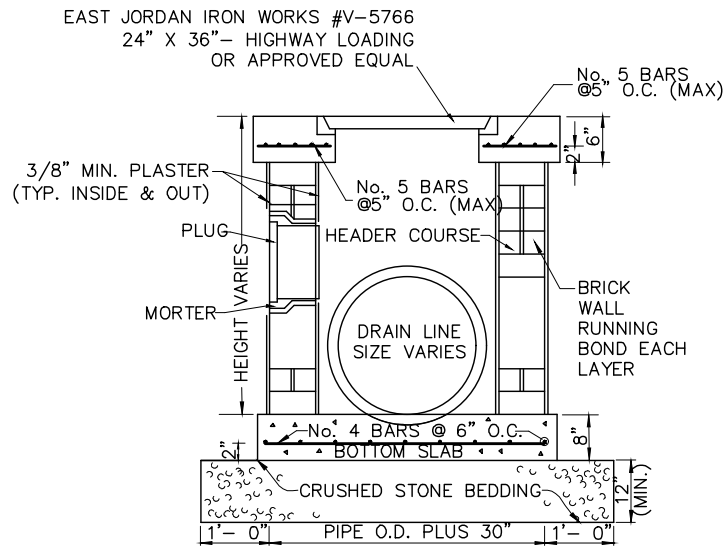

DRAIN INLET DETAIL

N.T.S.

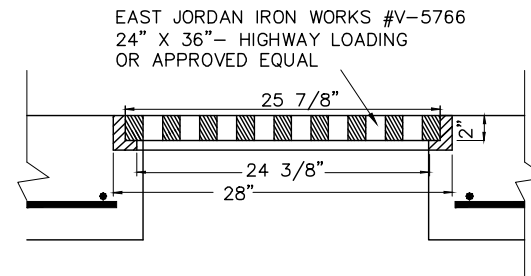

FRAME AND GRATE DETAIL

N.T.S.

24" x 36" DRAIN INLET DETAIL

N.T.S.

DRAIN INLETS NOTES:

1. DRAIN INLET WALLS TO BE 8" BRICK OR PRECAST CB-01 EQUIVALENT FROM LADOTD APPROVED SUPPLIER/MATERIALS LIST.

CB-01 (BRICK OPTION)

Section 04

LOUISIANA UNIFORM PUBLIC WORK BID FORM (REVISED)

TO: St. Tammany Parish Government
21454 Koop Dr., Suite 2F
Mandeville, La 70471

(Owner to provide name and address of owner)

BID FOR: STAC Phase IV-Beautification Landscape Work

BID No. 23-27-2

(Owner to provide name of project and other identifying information.)

The undersigned bidder hereby declares and represents that she/he; a) has carefully examined and understands the Bidding Documents, b) has not received, relied on, or based his bid on any verbal instructions contrary to the Bidding Documents or any addenda, c) has personally inspected and is familiar with the project site, and hereby proposes to provide all labor, materials, tools, appliances and facilities as required to perform, in a workmanlike manner, all work and services for the construction and completion of the referenced project, all in strict accordance with the Bidding Documents prepared by: Richard C. Lambert Consultants, LLC and dated: 01-31-2023.

(Owner to provide name of entity preparing bidding documents.)

Bidders must acknowledge all addenda. The Bidder acknowledges receipt of the following ADDENDA: (Enter the number the Designer has assigned to each of the addenda that the Bidder is acknowledging)

TOTAL BASE BID: For all work required by the Bidding Documents (including any and all unit prices designated "Base Bid" * but not alternates) the sum of:

Dollars (\$)

ALTERNATES: For any and all work required by the Bidding Documents for Alternates including any and all unit prices designated as alternates in the unit price description.

Alternate No. 1 (Concrete Pavers on 8" Thick Concrete and associated work (Add)) for the lump sum of: Dollars (\$)

Alternate No. 2 (Owner to provide description of alternate and state whether add or deduct) for the lump sum of: N/A Dollars (\$)

Alternate No. 3 (Owner to provide description of alternate and state whether add or deduct) for the lump sum of: N/A Dollars (\$)

NAME OF BIDDER:

ADDRESS OF BIDDER:

LOUISIANA CONTRACTOR'S LICENSE NUMBER:

NAME OF AUTHORIZED SIGNATORY OF BIDDER:

TITLE OF AUTHORIZED SIGNATORY OF BIDDER:

SIGNATURE OF AUTHORIZED SIGNATORY OF BIDDER **:

EMAIL:

DATE:

THE FOLLOWING ITEMS ARE TO BE INCLUDED WITH THE SUBMISSION OF THIS LOUISIANA UNIFORM PUBLIC WORK BID FORM:

* The Unit Price Form shall be used if the contract includes unit prices. Otherwise it is not required and need not be included with the form. The number of unit prices that may be included is not limited and additional sheets may be included if needed.

** A CORPORATE RESOLUTION OR WRITTEN EVIDENCE of the authority of the person signing the bid for the public work as prescribed by LA R.S. 38:2212(B)(5).

BID SECURITY in the form of a bid bond, certified check or cashier's check as prescribed by LA R.S. 38:2218(A) attached to and made a part of this bid.

*** W-9 - If a vendor has not done business with the Parish, the vendor should submit an updated W-9 with their response.

LOUISIANA UNIFORM PUBLIC WORK BID FORM UNIT PRICE FORM (REVISED)

TO:

St. Tammany Parish Government

21454 Koop Drive, Suite 2F

Mandeville, LA. 70471

(OWNER TO PROVIDE NAME AND ADDRESS OF OWNER)

BID FOR:

STAC PHASE IV - Beautification Landscape Work

PARISH PROJECT No.: EN18000102

BID NO. 23-27-2

(OWNER TO PROVIDE PROJECT NAME & OTHER IDENTIFYING INFO)

UNIT PRICES: This form shall be used for any & all work required by the Bidding Documents & described as unit prices. Amounts shall be stated in figures & only in figures.

Description: <input checked="" type="checkbox"/> BASE BID OR <input type="checkbox"/> ALT # REMOVAL OF STRUCTURES AND OBSTRUCTIONS				
REF NO.:	QUANTITY	UNIT OF MEASURE	UNIT PRICE	UNIT PRICE EXTENSION (Quantity times unit price)
202-01-00100	1	LUMP SUM		
Description: <input checked="" type="checkbox"/> BASE BID OR <input type="checkbox"/> ALT # REMOVAL OF CONCRETE WALKS AND DRIVES				
REF NO.:	QUANTITY	UNIT OF MEASURE	UNIT PRICE	UNIT PRICE EXTENSION (Quantity times unit price)
202-02-06100	58.7	SQ. YD.		
Description: <input checked="" type="checkbox"/> BASE BID OR <input type="checkbox"/> ALT # REMOVAL OF CURBS (CONCRETE)				
REF NO.:	QUANTITY	UNIT OF MEASURE	UNIT PRICE	UNIT PRICE EXTENSION (Quantity times unit price)
202-02-06140	246	LIN. FT.		
Description: <input checked="" type="checkbox"/> BASE BID OR <input type="checkbox"/> ALT # RELOCATION OF SIGN				
REF NO.:	QUANTITY	UNIT OF MEASURE	UNIT PRICE	UNIT PRICE EXTENSION (Quantity times unit price)
202-03-38000	2	EACH		

Wording for "description" is to be provided by the Owner. All Quantities Estimated. The Contractor will be paid based upon actual quantities as verified by the Owner.

UNIT PRICES: This form shall be used for any & all work required by the Bidding Documents & described as unit prices. Amounts shall be stated in figures & only in figures.

Description: <input checked="" type="checkbox"/> BASE BID OR <input type="checkbox"/> ALT # EXCAVATION AND EMBANKMENT				
REF NO.:	QUANTITY	UNIT OF MEASURE	UNIT PRICE	UNIT PRICE EXTENSION (Quantity times unit price)
203-05-00100	1	LUMP SUM		
Description: <input checked="" type="checkbox"/> BASE BID OR <input type="checkbox"/> ALT # CLEANING EXISTING DITCHES				
REF NO.:	QUANTITY	UNIT OF MEASURE	UNIT PRICE	UNIT PRICE EXTENSION (Quantity times unit price)
203-10-00100	130	LIN. FT.		
Description: <input checked="" type="checkbox"/> BASE BID OR <input type="checkbox"/> ALT # TEMPORARY HAY OR STRAW BALES				
REF NO.:	QUANTITY	UNIT OF MEASURE	UNIT PRICE	UNIT PRICE EXTENSION (Quantity times unit price)
204-02-00100	12	EACH		
Description: <input checked="" type="checkbox"/> BASE BID OR <input type="checkbox"/> ALT # TEMPORARY SILT FENCING				
REF NO.:	QUANTITY	UNIT OF MEASURE	UNIT PRICE	UNIT PRICE EXTENSION (Quantity times unit price)
204-06-00100	460	LIN. FT.		
Description: <input checked="" type="checkbox"/> BASE BID OR <input type="checkbox"/> ALT # CLEANING AND SEALING RANDOM CRACKS				
REF NO.:	QUANTITY	UNIT OF MEASURE	UNIT PRICE	UNIT PRICE EXTENSION (Quantity times unit price)
602-03-00100	680.5	LIN. FT.		
Description: <input checked="" type="checkbox"/> BASE BID OR <input type="checkbox"/> ALT # CATCH BASINS (CB-01)				
REF NO.:	QUANTITY	UNIT OF MEASURE	UNIT PRICE	UNIT PRICE EXTENSION (Quantity times unit price)
702-03-00100	3	EACH		

Wording for "description" is to be provided by the Owner. All Quantities Estimated. The Contractor will be paid based upon actual quantities as verified by the Owner.

UNIT PRICES: This form shall be used for any & all work required by the Bidding Documents & described as unit prices. Amounts shall be stated in figures & only in figures.

Description: <input checked="" type="checkbox"/> BASE BID OR <input type="checkbox"/> ALT # CONCRETE WALK (5" THICK)				
REF NO.:	QUANTITY	UNIT OF MEASURE	UNIT PRICE	UNIT PRICE EXTENSION (Quantity times unit price)
706-01-00200	57.4	SQ. YD.		
Description: <input checked="" type="checkbox"/> BASE BID OR <input type="checkbox"/> ALT # CONCRETE WALK (8" THICK)				
REF NO.:	QUANTITY	UNIT OF MEASURE	UNIT PRICE	UNIT PRICE EXTENSION (Quantity times unit price)
706-01-00300	12	SQ. YD.		
Description: <input checked="" type="checkbox"/> BASE BID OR <input type="checkbox"/> ALT # INCIDENTAL CONCRETE PAVING (5" THICK)				
REF NO.:	QUANTITY	UNIT OF MEASURE	UNIT PRICE	UNIT PRICE EXTENSION (Quantity times unit price)
706-03-00200	39	SQ. YD.		
Description: <input checked="" type="checkbox"/> BASE BID OR <input type="checkbox"/> ALT # CONCRETE BARRIER CURB				
REF NO.:	QUANTITY	UNIT OF MEASURE	UNIT PRICE	UNIT PRICE EXTENSION (Quantity times unit price)
707-01-00200	876	LIN. FT.		
Description: <input checked="" type="checkbox"/> BASE BID OR <input type="checkbox"/> ALT # TEMPORARY SIGNS AND BARRICADES				
REF NO.:	QUANTITY	UNIT OF MEASURE	UNIT PRICE	UNIT PRICE EXTENSION (Quantity times unit price)
713-01-00100	1	LUMP SUM		
Description: <input checked="" type="checkbox"/> BASE BID OR <input type="checkbox"/> ALT # SLAB SODDING (BERMUDA GRASS)				
REF NO.:	QUANTITY	UNIT OF MEASURE	UNIT PRICE	UNIT PRICE EXTENSION (Quantity times unit price)
714-01-00100	10,343.00	SQ. YD.		

Wording for "description" is to be provided by the Owner. All Quantities Estimated. The Contractor will be paid based upon actual quantities as verified by the Owner.

UNIT PRICES: This form shall be used for any & all work required by the Bidding Documents & described as unit prices. Amounts shall be stated in figures & only in figures.

Description:	<input checked="" type="checkbox"/> BASE BID	OR	<input type="checkbox"/> ALT #	AGRICULTURAL LIME	
REF NO.:	QUANTITY	UNIT OF MEASURE	UNIT PRICE	UNIT PRICE EXTENSION (Quantity times unit price)	
718-02-00100	3	TON			
Description:	<input checked="" type="checkbox"/> BASE BID	OR	<input type="checkbox"/> ALT #	PLANT (TREE) (CONTAINER) (1" CAL) (CATALPA BIGNONIOIDES/SOUTHERN CATALPA)	
REF NO.:	QUANTITY	UNIT OF MEASURE	UNIT PRICE	UNIT PRICE EXTENSION (Quantity times unit price)	
719-01-02000	7	EACH			
Description:	<input checked="" type="checkbox"/> BASE BID	OR	<input type="checkbox"/> ALT #	PLANT (TREE) (CONTAINER) (1.5" CAL) (MAGNOLIA VIRGINIANA/SWEET BAY)	
REF NO.:	QUANTITY	UNIT OF MEASURE	UNIT PRICE	UNIT PRICE EXTENSION (Quantity times unit price)	
719-01-02020	16	EACH			
Description:	<input checked="" type="checkbox"/> BASE BID	OR	<input type="checkbox"/> ALT #	PLANT (TREE) (CONTAINER) (2" CAL) (ACER RUBRUM/RED MAPLE)	
REF NO.:	QUANTITY	UNIT OF MEASURE	UNIT PRICE	UNIT PRICE EXTENSION (Quantity times unit price)	
719-01-02040-A	29	EACH			
Description:	<input checked="" type="checkbox"/> BASE BID	OR	<input type="checkbox"/> ALT #	PLANT (TREE) (CONTAINER) (2" CAL) (CHIONANTHUS VIRGINICUS/WHITE FRINGETREE)	
REF NO.:	QUANTITY	UNIT OF MEASURE	UNIT PRICE	UNIT PRICE EXTENSION (Quantity times unit price)	
719-01-02040-B	25	EACH			
Description:	<input checked="" type="checkbox"/> BASE BID	OR	<input type="checkbox"/> ALT #	PLANT (TREE) (CONTAINER) (2" CAL) (ILEX CASSINE/DAHOON HOLLY)	
REF NO.:	QUANTITY	UNIT OF MEASURE	UNIT PRICE	UNIT PRICE EXTENSION (Quantity times unit price)	
719-01-02040-C	33	EACH			

Wording for "description" is to be provided by the Owner. All Quantities Estimated. The Contractor will be paid based upon actual quantities as verified by the Owner.

UNIT PRICES: This form shall be used for any & all work required by the Bidding Documents & described as unit prices. Amounts shall be stated in figures & only in figures.

Description: <input checked="" type="checkbox"/> BASE BID OR <input type="checkbox"/> ALT # PLANT (TREE) (CONTAINER) (2.5" CAL) (QUERCUS VIRGINIANA/SOUTHERN LIVE OAK)				
REF NO.:	QUANTITY	UNIT OF MEASURE	UNIT PRICE	UNIT PRICE EXTENSION (Quantity times unit price)
719-01-02060-A	3	EACH		
Description: <input checked="" type="checkbox"/> BASE BID OR <input type="checkbox"/> ALT # PLANT (TREE) (CONTAINER) (2.5" CAL) (TAXODIUM ASCENDENS/POND CYPRESS)				
REF NO.:	QUANTITY	UNIT OF MEASURE	UNIT PRICE	UNIT PRICE EXTENSION (Quantity times unit price)
719-01-02060-B	32	EACH		
Description: <input checked="" type="checkbox"/> BASE BID OR <input type="checkbox"/> ALT # PLANT (TREE) (CONTAINER) (2.5" CAL) (PINUS PALUSTRIS/LONGLEAF PINE)				
REF NO.:	QUANTITY	UNIT OF MEASURE	UNIT PRICE	UNIT PRICE EXTENSION (Quantity times unit price)
719-01-02060-C	39	EACH		
Description: <input checked="" type="checkbox"/> BASE BID OR <input type="checkbox"/> ALT # PLANT (PLANT) (CONTAINER) (1 GALLON) (EUPATORIUM COELESTINUM/BLUE MIST FLOWER)				
REF NO.:	QUANTITY	UNIT OF MEASURE	UNIT PRICE	UNIT PRICE EXTENSION (Quantity times unit price)
719-01-06020-A	617	EACH		
Description: <input checked="" type="checkbox"/> BASE BID OR <input type="checkbox"/> ALT # PLANT (PLANT) (CONTAINER) (1 GALLON) (HYMENOCALLIS LIRISOME/SPIDER LILY)				
REF NO.:	QUANTITY	UNIT OF MEASURE	UNIT PRICE	UNIT PRICE EXTENSION (Quantity times unit price)
719-01-06020-B	102	EACH		
Description: <input checked="" type="checkbox"/> BASE BID OR <input type="checkbox"/> ALT # PLANT (PLANT) (CONTAINER) (1 GALLON) (IRIS VIRGINICA/BLUE FLAG IRIS)				
REF NO.:	QUANTITY	UNIT OF MEASURE	UNIT PRICE	UNIT PRICE EXTENSION (Quantity times unit price)
719-01-06020-C	1,086	EACH		

Wording for "description" is to be provided by the Owner. All Quantities Estimated. The Contractor will be paid based upon actual quantities as verified by the Owner.

UNIT PRICES: This form shall be used for any & all work required by the Bidding Documents & described as unit prices. Amounts shall be stated in figures & only in figures.

Description:	<input checked="" type="checkbox"/> BASE BID OR <input type="checkbox"/> ALT # PLANT (PLANT) (CONTAINER) (1 GALLON) (LIPPIA NODIFLORA/TURKEY TANGLE FOGFRUIT)			
REF NO.:	QUANTITY	UNIT OF MEASURE	UNIT PRICE	UNIT PRICE EXTENSION (Quantity times unit price)
719-01-06020-D	2,253	EACH		
Description:	<input checked="" type="checkbox"/> BASE BID OR <input type="checkbox"/> ALT # PLANT (PLANT) (CONTAINER) (1 GALLON) (RUDBECKIA FULGIDA 'GOLDSTRUM'/BLACK-EYED SUSAN)			
REF NO.:	QUANTITY	UNIT OF MEASURE	UNIT PRICE	UNIT PRICE EXTENSION (Quantity times unit price)
719-01-06020-E	783	EACH		
Description:	<input checked="" type="checkbox"/> BASE BID OR <input type="checkbox"/> ALT # PLANT (PLANT) (CONTAINER) (1 GALLON) (STOKESIA LAEVIS/STOKES ASTER)			
REF NO.:	QUANTITY	UNIT OF MEASURE	UNIT PRICE	UNIT PRICE EXTENSION (Quantity times unit price)
719-01-06020-F	830	EACH.		
Description:	<input checked="" type="checkbox"/> BASE BID OR <input type="checkbox"/> ALT # PLANT (PLANT) (CONTAINER) (3 GALLON) (CLETHRA ALNIFOLIA/SUMMERSWEET CLETHRA)			
REF NO.:	QUANTITY	UNIT OF MEASURE	UNIT PRICE	UNIT PRICE EXTENSION (Quantity times unit price)
719-01-06060-A	75	EACH		
Description:	<input checked="" type="checkbox"/> BASE BID OR <input type="checkbox"/> ALT # PLANT (PLANT) (CONTAINER) (3 GALLON) (CEPHALANTHUS OCCIDENTALIS/BUTTONBUSH)			
REF NO.:	QUANTITY	UNIT OF MEASURE	UNIT PRICE	UNIT PRICE EXTENSION (Quantity times unit price)
719-01-06060-B	30	EACH		
Description:	<input checked="" type="checkbox"/> BASE BID OR <input type="checkbox"/> ALT # PLANT (PLANT) (CONTAINER) (3 GALLON) (DISTYLIIUM VINTAGE JADE/VINTAGE JADE DISTYLIIUM)			
REF NO.:	QUANTITY	UNIT OF MEASURE	UNIT PRICE	UNIT PRICE EXTENSION (Quantity times unit price)
719-01-06060-C	309	EACH		

Wording for "description" is to be provided by the Owner. All Quantities Estimated. The Contractor will be paid based upon actual quantities as verified by the Owner.

UNIT PRICES: This form shall be used for any & all work required by the Bidding Documents & described as unit prices. Amounts shall be stated in figures & only in figures.

Description: <input checked="" type="checkbox"/> BASE BID OR <input type="checkbox"/> ALT # PLANT (PLANT) (CONTAINER) (3 GALLON) (LOROPETALUM CHINENSE "PURPLE DIAMOND"/LOROPETALUM)				
REF NO.:	QUANTITY	UNIT OF MEASURE	UNIT PRICE	UNIT PRICE EXTENSION (Quantity times unit price)
719-01-06060-D	56	EACH		
Description: <input checked="" type="checkbox"/> BASE BID OR <input type="checkbox"/> ALT # PLANT (PLANT) (CONTAINER) (3 GALLON) (MUHLENBERGIA CAPILLARIS/PINK MUHLY)				
REF NO.:	QUANTITY	UNIT OF MEASURE	UNIT PRICE	UNIT PRICE EXTENSION (Quantity times unit price)
719-01-06060-E	209	EACH		
Description: <input checked="" type="checkbox"/> BASE BID OR <input type="checkbox"/> ALT # PLANT (PLANT) (CONTAINER) (3 GAL.) (PANICUM VIRGATUM 'DALLAS BLUES'/DALLAS BLUE SWITCH GRASS)				
REF NO.:	QUANTITY	UNIT OF MEASURE	UNIT PRICE	UNIT PRICE EXTENSION (Quantity times unit price)
719-01-06060-F	405	EACH		
Description: <input checked="" type="checkbox"/> BASE BID OR <input type="checkbox"/> ALT # PLANT (PLANT) (CONTAINER) (5 GALLON) (SABAL MINOR/DWARF PALMETTO)				
REF NO.:	QUANTITY	UNIT OF MEASURE	UNIT PRICE	UNIT PRICE EXTENSION (Quantity times unit price)
719-01-06080	166	EACH		
Description: <input checked="" type="checkbox"/> BASE BID OR <input type="checkbox"/> ALT # PLANT (PLANT) (CONTAINER) (10 GALLON) (RHUS COPALLINUM/WINGED SUMAC)				
REF NO.:	QUANTITY	UNIT OF MEASURE	UNIT PRICE	UNIT PRICE EXTENSION (Quantity times unit price)
719-01-06120	45	EACH		
Description: <input checked="" type="checkbox"/> BASE BID OR <input type="checkbox"/> ALT # TOP DRESSING MULCH (3" DEPTH) (SHREDDED HARDWOOD MULCH)				
REF NO.:	QUANTITY	UNIT OF MEASURE	UNIT PRICE	UNIT PRICE EXTENSION (Quantity times unit price)
719-02-00100	4,171	SQ. YD.		

Wording for "description" is to be provided by the Owner. All Quantities Estimated. The Contractor will be paid based upon actual quantities as verified by the Owner.

UNIT PRICES: This form shall be used for any & all work required by the Bidding Documents & described as unit prices. Amounts shall be stated in figures & only in figures.

Description: <input checked="" type="checkbox"/> BASE BID OR <input type="checkbox"/> ALT # BED PREPARATION (11" MIN. DEPTH)				
REF NO.:	QUANTITY	UNIT OF MEASURE	UNIT PRICE	UNIT PRICE EXTENSION (Quantity times unit price)
719-03-00300	4,171	SQ. YD.		
Description: <input checked="" type="checkbox"/> BASE BID OR <input type="checkbox"/> ALT # MOBILIZATION				
REF NO.:	QUANTITY	UNIT OF MEASURE	UNIT PRICE	UNIT PRICE EXTENSION (Quantity times unit price)
727-01-00100	1	LUMP SUM		
Description: <input checked="" type="checkbox"/> BASE BID OR <input type="checkbox"/> ALT # LUMINAIRE				
REF NO.:	QUANTITY	UNIT OF MEASURE	UNIT PRICE	UNIT PRICE EXTENSION (Quantity times unit price)
730-07-10000	4	EACH		
Description: <input checked="" type="checkbox"/> BASE BID OR <input type="checkbox"/> ALT # REFLECTORIZED RAISED PAVEMENT MARKERS (CLASS IV)				
REF NO.:	QUANTITY	UNIT OF MEASURE	UNIT PRICE	UNIT PRICE EXTENSION (Quantity times unit price)
731-02-00100	4	EACH		
Description: <input checked="" type="checkbox"/> BASE BID OR <input type="checkbox"/> ALT # PLASTIC PAVEMENT STRIPING (4" WIDTH) (THERMOPLASTIC 90 MIL) (WHITE)				
REF NO.:	QUANTITY	UNIT OF MEASURE	UNIT PRICE	UNIT PRICE EXTENSION (Quantity times unit price)
732-01-01000-A	211	LIN. FT.		
Description: <input checked="" type="checkbox"/> BASE BID OR <input type="checkbox"/> ALT # PLASTIC PAVEMENT STRIPING (4" WIDTH) (THERMOPLASTIC 90 MIL) (YELLOW)				
REF NO.:	QUANTITY	UNIT OF MEASURE	UNIT PRICE	UNIT PRICE EXTENSION (Quantity times unit price)
732-01-01000-B	784	LIN. FT.		

Wording for "description" is to be provided by the Owner. All Quantities Estimated. The Contractor will be paid based upon actual quantities as verified by the Owner.

UNIT PRICES: This form shall be used for any & all work required by the Bidding Documents & described as unit prices. Amounts shall be stated in figures & only in figures.

Description: <input checked="" type="checkbox"/> BASE BID OR <input type="checkbox"/> ALT # PLASTIC PAVEMENT STRIPING (8" WIDTH) (THERMOPLASTIC 90 MIL) (YELLOW)				
REF NO.:	QUANTITY	UNIT OF MEASURE	UNIT PRICE	UNIT PRICE EXTENSION (Quantity times unit price)
732-01-01040	368	LIN. FT.		
Description: <input checked="" type="checkbox"/> BASE BID OR <input type="checkbox"/> ALT # PLASTIC PAVEMENT STRIPING (DOTTED LINE) (8" WIDTH) (3'L) (THERMO. 90 MIL) (W)				
REF NO.:	QUANTITY	UNIT OF MEASURE	UNIT PRICE	UNIT PRICE EXTENSION (Quantity times unit price)
732-03-02040	20	LIN. FT.		
Description: <input checked="" type="checkbox"/> BASE BID OR <input type="checkbox"/> ALT # PLASTIC PAVEMENT LEGENDS AND SYMBOLS (ARROW- STRAIGHT)				
REF NO.:	QUANTITY	UNIT OF MEASURE	UNIT PRICE	UNIT PRICE EXTENSION (Quantity times unit price)
732-04-01020	11	EACH		
Description: <input checked="" type="checkbox"/> BASE BID OR <input type="checkbox"/> ALT # PLASTIC PAVEMENT LEGENDS AND SYMBOLS (ARROW-DOUBLE)				
REF NO.:	QUANTITY	UNIT OF MEASURE	UNIT PRICE	UNIT PRICE EXTENSION (Quantity times unit price)
732-04-01040	2	EACH		
Description: <input checked="" type="checkbox"/> BASE BID OR <input type="checkbox"/> ALT # PLASTIC PAVEMENT LEGENDS AND SYMBOLS (ARROW-LEFT TURN)				
REF NO.:	QUANTITY	UNIT OF MEASURE	UNIT PRICE	UNIT PRICE EXTENSION (Quantity times unit price)
732-04-01080	1	EACH		
Description: <input checked="" type="checkbox"/> BASE BID OR <input type="checkbox"/> ALT # PLASTIC PAVEMENT LEGENDS AND SYMBOLS (TYPE LTC)				
REF NO.:	QUANTITY	UNIT OF MEASURE	UNIT PRICE	UNIT PRICE EXTENSION (Quantity times unit price)
732-04-01131	1	EACH		

Wording for "description" is to be provided by the Owner. All Quantities Estimated. The Contractor will be paid based upon actual quantities as verified by the Owner.

UNIT PRICES: This form shall be used for any & all work required by the Bidding Documents & described as unit prices. Amounts shall be stated in figures & only in figures.

Description: <input checked="" type="checkbox"/> BASE BID OR <input type="checkbox"/> ALT # PLASTIC PAVEMENT LEGENDS AND SYMBOLS (NO PARKING)				
REF NO.:	QUANTITY	UNIT OF MEASURE	UNIT PRICE	UNIT PRICE EXTENSION (Quantity times unit price)
732-04-02020	1	EACH		
Description: <input checked="" type="checkbox"/> BASE BID OR <input type="checkbox"/> ALT # CONSTRUCTION LAYOUT				
REF NO.:	QUANTITY	UNIT OF MEASURE	UNIT PRICE	UNIT PRICE EXTENSION (Quantity times unit price)
740-01-00100	1	LUMP SUM		
Description: <input checked="" type="checkbox"/> BASE BID OR <input type="checkbox"/> ALT # ADJUST CATCH BASIN TOP OF CASTINGS				
REF NO.:	QUANTITY	UNIT OF MEASURE	UNIT PRICE	UNIT PRICE EXTENSION (Quantity times unit price)
S-001	2	EACH		
Description: <input checked="" type="checkbox"/> BASE BID OR <input type="checkbox"/> ALT # TRENCH DRAIN (4" PERFORATED PIPE)				
REF NO.:	QUANTITY	UNIT OF MEASURE	UNIT PRICE	UNIT PRICE EXTENSION (Quantity times unit price)
S-002	229	LIN. FT.		
Description: <input checked="" type="checkbox"/> BASE BID OR <input type="checkbox"/> ALT # DIRECTIONAL DRILL 6" HDPE DRAIN PIPE				
REF NO.:	QUANTITY	UNIT OF MEASURE	UNIT PRICE	UNIT PRICE EXTENSION (Quantity times unit price)
S-003	82	LIN. FT.		
Description: <input checked="" type="checkbox"/> BASE BID OR <input type="checkbox"/> ALT # ENVIRONMENTAL PROTECTION				
REF NO.:	QUANTITY	UNIT OF MEASURE	UNIT PRICE	UNIT PRICE EXTENSION (Quantity times unit price)
S-004	1	LUMP SUM		

Wording for "description" is to be provided by the Owner. All Quantities Estimated. The Contractor will be paid based upon actual quantities as verified by the Owner.

UNIT PRICES: This form shall be used for any & all work required by the Bidding Documents & described as unit prices. Amounts shall be stated in figures & only in figures.

Description: <input checked="" type="checkbox"/> BASE BID OR <input type="checkbox"/> ALT # TRUNCATED DOME PAVERS ON 5" THICK CONCRETE				
REF NO.:	QUANTITY	UNIT OF MEASURE	UNIT PRICE	UNIT PRICE EXTENSION (Quantity times unit price)
S-005	144	SQ. FT.		
Description: <input checked="" type="checkbox"/> BASE BID OR <input type="checkbox"/> ALT # MONUMENT SIGN				
REF NO.:	QUANTITY	UNIT OF MEASURE	UNIT PRICE	UNIT PRICE EXTENSION (Quantity times unit price)
S-006	2	EACH		
Description: <input checked="" type="checkbox"/> BASE BID OR <input type="checkbox"/> ALT # BENCHES				
REF NO.:	QUANTITY	UNIT OF MEASURE	UNIT PRICE	UNIT PRICE EXTENSION (Quantity times unit price)
S-007	12	EACH		
Description: <input checked="" type="checkbox"/> BASE BID OR <input type="checkbox"/> ALT # TRASH RECEPTACLE				
REF NO.:	QUANTITY	UNIT OF MEASURE	UNIT PRICE	UNIT PRICE EXTENSION (Quantity times unit price)
S-008	6	EACH		
Description: <input checked="" type="checkbox"/> BASE BID OR <input type="checkbox"/> ALT # IRRIGATION SYSTEM				
REF NO.:	QUANTITY	UNIT OF MEASURE	UNIT PRICE	UNIT PRICE EXTENSION (Quantity times unit price)
S-009	1	LUMP SUM		
Description: <input checked="" type="checkbox"/> BASE BID OR <input type="checkbox"/> ALT # WHEEL STOPS (6')				
REF NO.:	QUANTITY	UNIT OF MEASURE	UNIT PRICE	UNIT PRICE EXTENSION (Quantity times unit price)
S-010	3	EACH		

Wording for "description" is to be provided by the Owner. All Quantities Estimated. The Contractor will be paid based upon actual quantities as verified by the Owner.

ALTERNATIVE NO.1

UNIT PRICES: This form shall be used for any & all work required by the Bidding Documents & described as unit prices. Amounts shall be stated in figures & only in figures.

Description:	<input type="checkbox"/> BASE BID OR <input checked="" type="checkbox"/> ALT # <u>NO. 1</u> EXCAVATION AND EMBANKMENT			
REF NO.:	QUANTITY	UNIT OF MEASURE	UNIT PRICE	UNIT PRICE EXTENSION (Quantity times unit price)
203-05-00100	1	LUMP SUM		
Description:	<input type="checkbox"/> BASE BID OR <input checked="" type="checkbox"/> ALT # <u>NO. 1</u> CONCRETE PAVERS ON 8" THICK CONCRETE			
REF NO.:	QUANTITY	UNIT OF MEASURE	UNIT PRICE	UNIT PRICE EXTENSION (Quantity times unit price)
S-011	772	SQ. FT.		